

SPEAKMAN COMPANY

SE-914-T Installation, Maintenance & Operation Instructions

DESCRIPTION

Stay-open ball valve for vertical and horizontal installation.

SPECIFICATIONS

VALVE: 3/4" NPT Female Polished Chrome Brass, Stay-Open Ball Valve.

ACTIVATOR: Cast Brass Lever Handle.

INLET: 3/4" NPT Female.

OUTLET: 3/4" NPT Female.

SHIPPING WEIGHT: 2 lb.

OPTIONS

◇ AL1 (Air Horn Alarm)	◇ AL2-C1D2 (Electrical Alarm / Haz. Area)
◇ AL2 (Electrical Alarm)	◇ AL3-C1D2 (Electrical Alarm / Haz. Area)
◇ AL3 (Electrical Alarm)	◇ FLW (Flow Switch)

INSTALLATION

Assemble valve to a horizontal or vertical water supply that has an uninterrupted source of potable water. Use pipe sealant on all joints. Failure to use potable water can result in emergency units producing impure or contaminated water causing possible further injury.

OPERATION

This shower is activated by pulling downward on the lever handle. The valve will continue to discharge water until the handle is manually pushed up to the off position.

TESTING PROGRAM

The American National Standards Institute (ANSI) states that all safety emergency equipment shall be activated on a weekly basis to flush the line and verify proper operation. Speakman Company furnishes a testing record tag (91-0635) with each unit. On this tag the date of inspection and the inspectors initials should be noted.

MAINTENANCE

Should you need parts to repair this unit, please reference the parts list below for correct part numbers. Before any maintenance is done ***be sure to shut the water supply off***

WARNING: Use only genuine Speakman parts when repairing or replacing components. To order parts call 1-800-537-2107.

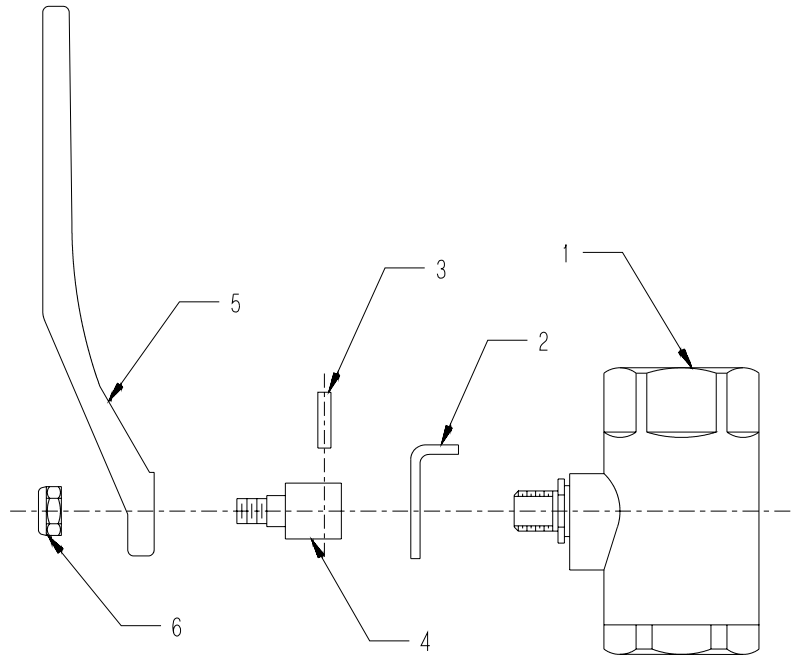

SE-914-T REPLACEMENT/REPAIR PARTS

<u>ITEM</u>	<u>PART/GROUP #</u>	<u>DESCRIPTION</u>
1	20-0845-PC	3/4" Ball Valve
2	04-0467-SS	S/S Handle Stop for 1" Ball Valve
3	51-0057	Spring Pin
4	03-0477-RCP	Spindle Extension
5	04-0363-RCP	Cast Brass Handle
6	01-0684-MO	1/4-20 S/S Nut

FLOW DATA

VALVE:

FLOW PRESSURE PSI (BAR)	30 (2.07)
FLOW RATE GPM (LPM)	30 (114)

Note: All units meet existing ANSI Z358.1 Standards and OSHA Rules. Product improvements may cause specification and dimensional changes without notice.

NOTE: This unit should be connected to an uninterrupted source of potable water, with a minimum flowing pressure of 20 PSI and a maximum static pressure of 125 PSI.

SPEAKMAN®
 PO Box 191 Wilmington, DE 19899 Phone: 800-537-2107 Fax: 800-977-2747
 Visit us on the web at www.speakmancompany.com