

CHICAGO FAUCETS



2100 SOUTH CLEARWATER DRIVE
DES PLAINES, ILLINOIS 60018-5999

Last As Long As The Building

FITTING NO.

1888

SUBMITTED MODEL NO.

JOB NAME

ITEM NO.

SUBMITTED AS SHOWN

SUBMITTED AS NOTED

SEE ATTACHED FOR
SUBMITTED MODIFICATION

IS ASSUMED FOR USE OF SUPERCEDED OR VOIDED DATA.

RUBBER WASHER USED
ONLY WITH SHEET
METAL SINK TOPS.

1/2" NPSM COUPLING
NUT FOR 3/8" OR 1/2"
FLEXIBLE RISER.

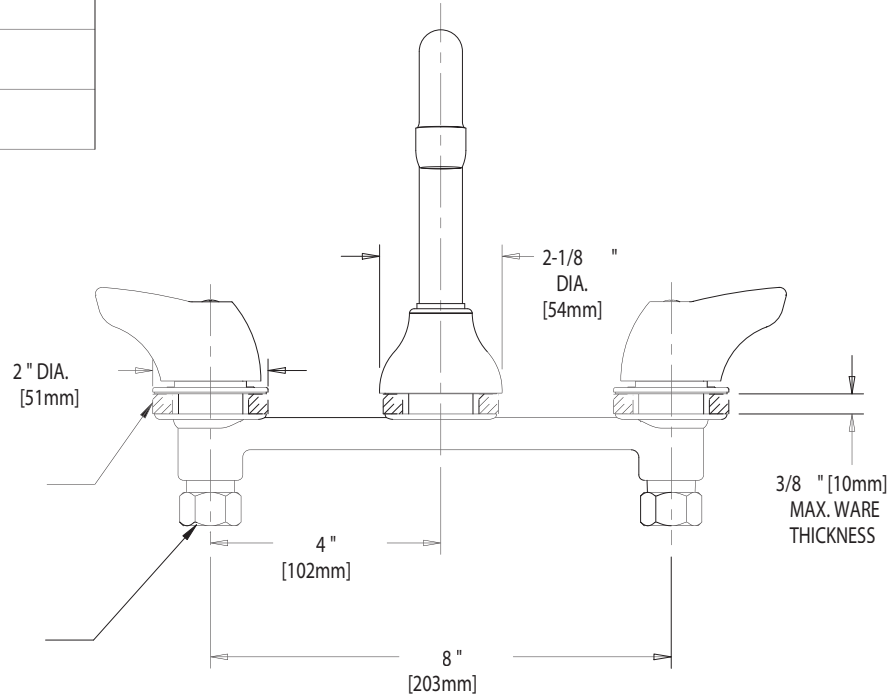

FRONT VIEW

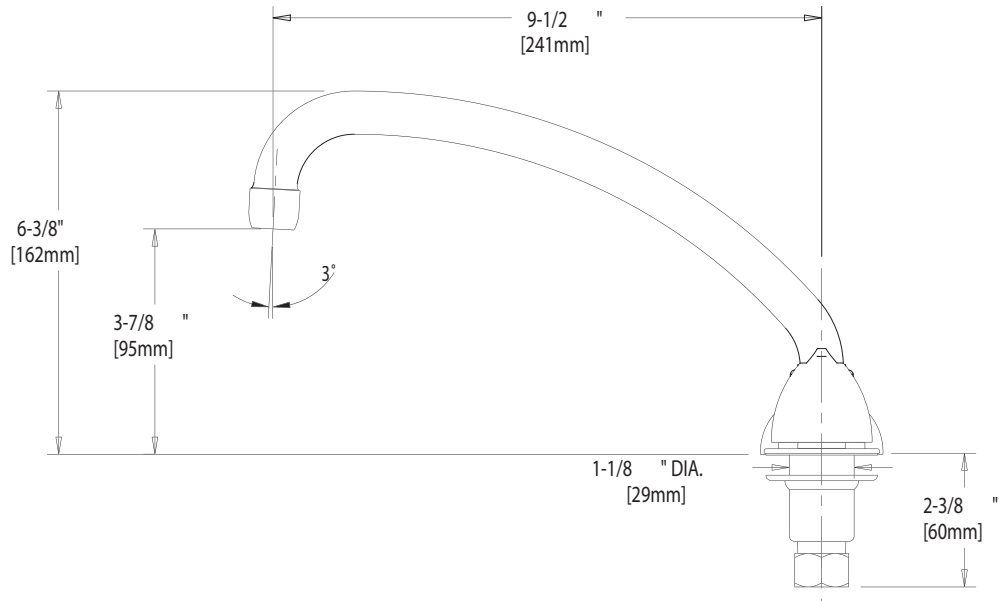

SIDE VIEW

DIMENSIONS IN INCHES AND [MILLIMETERS].

TECHNICAL DATA

- DECK MOUNTED CONCEALED FITTING FOR STAINLESS STEEL SINK
- 1888-001K SWING SPOUT
- 1000 SINGLE WING HANDLES
- QUATURN OPERATING CARTRIDGES
- FINISH: CHROME PLATED

- E3 SOFTFLO AERATOR
- 2.2 GPM [8.3 L/min.] MAXIMUM FLOW RATE
- NSF 61 COMPLIANT

DATE: 5-2-02

BY: JAR

CHK'D:

APP'D:

REV: A

1888

ROUGHING IN DIMENSIONS MAY VARY AND ARE SUBJECT TO CHANGE. NO RESPONSIBILITY