

Assembly Instructions Mode d'assemblage

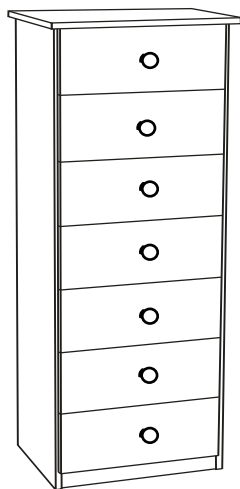

7 Drawer Lingerie Chest

Coffre de lingerie de 7 tiroirs

Series / séries #

WHD-2050-7

White / blanc

HBD-2050-7

Oak / chêne

BEP-2050-7

Black / noir

Cabinet Parts / Pièces de l'armoire

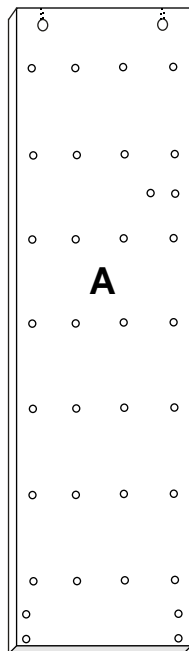

Left Side (1)
Côté gauche
SL-5108 black / noir
SL-5208 oak / chêne
SL-5308 white / blanc

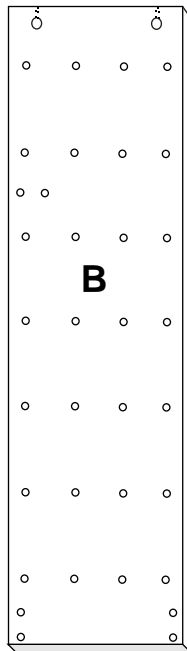

Right Side (1)
Côté droit
SR-5108 black / noir
SR-5208 oak / chêne
SR-5308 white / blanc



Unfinished Stabilizer (2)
Renforcement de structure non-fini
ST-5003



Front Kicker (1)
Renforcement de structure avant
ST-5103 black / noir
ST-5203 oak / chêne
ST-5303 white / blanc

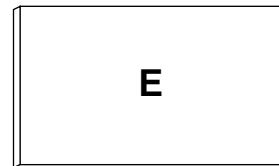

Top / Dessus (1)
TP-5104 black / noir
TP-5204 oak / chêne
TP-5304 white / blanc

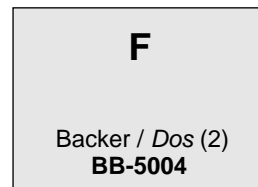

Backer / Dos (2)
BB-5004

Drawer Parts / Pièces des tiroirs

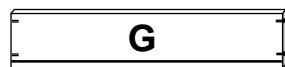

Drawer Back (7)
Arrière du tiroir
DK-5001



Left Drawer Side (7)
Côté gauche du tiroir
DS-5000-L



Right Drawer Side (7)
Côté droit du tiroir
DS-5000-R

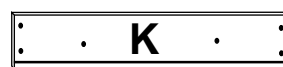

Drawer Front (7)
Devant du tiroir
DF-5111 black / noir
DF-5201 oak / chêne
DF-5301 white / blanc



Drawer Glides & Stoppers (7)
Glissières de tiroir avec arrêts
RM-0507



Drawer Bottom (7)
Fond du tiroir
DB-5001

Hardware Included / Quincaillerie comprise



2" Confirmat Screws (12)
Vis Confirmat 2 po.
RM-0001

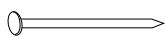

1" nail (18)
Clou de 1"
RM-0022

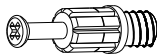

24mm Green Twister Dowel (14)
Goujon de torsion vert 24mm
RM-0501



12mm Zinc Cam (18)
Ferrure en zinc 12mm
RM-0502



#8 - 1 1/2" Hi Lo Screws (28)
Vis no. 8 - 1 1/2 po.
RM-0504

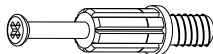

34mm Black Twister Dowel (4)
Goujon de torsion noir 34mm
RM-0500

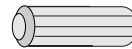

Wood Dowel (14)
Goujon de bois
RM-0503

Tools Needed Outils nécessaires



Phillips Screwdriver
Tournevis à pointe cruciforme



Hammer
Marteau

If you have any missing parts, please call: 1-877-PREPAC1 (1-877-773-7221) Mon - Fri 7:00am to 4:30pm Pacific Time (10:00am - 7:30pm Eastern) or visit www.prepacmfg.com/forms/?form=parts Please have your product series number available (listed above).

Si des pièces sont manquantes, veuillez téléphoner au 1-877-PREPAC1 (1-877-773-7221) lors des heures suivantes: LUN - VEN 7h à 16h 30, heure du Pacifique (10h à 19h 30 heure de l'Est). Veuillez noter le numéro de série avant de téléphoner (voir ci-dessus). Ou visitez www.prepacmfg.com/forms/?form=parts. Pour le service en français, contactez s'il vous plaît votre détaillant.

DATE STAMP

Drawer Glides are marked: LEFT, RIGHT and FRONT

Les mentions LEFT (gauche) et RIGHT (droit) sont indiquées sur les coulisses de tiroirs

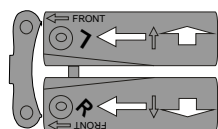

1. Separate the 3 drawer glide parts:
Séparez les pièces des coulisses de tiroirs

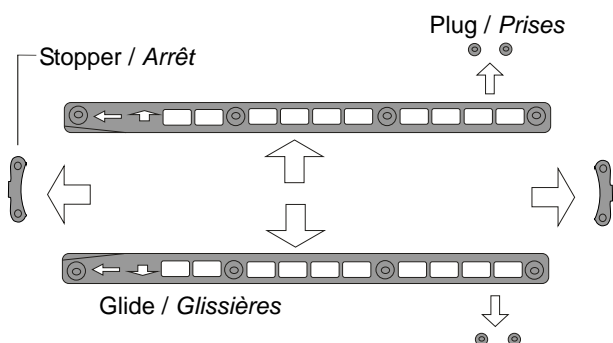

2. Important

Make sure you install the drawer glides on the correct cabinet side. Look for the arrows marked on each glide.

Assurez-vous de poser les coulisses de tiroirs du bon côté de l'armoire. Suivez le sens des flèches indiqué sur les coulisses.

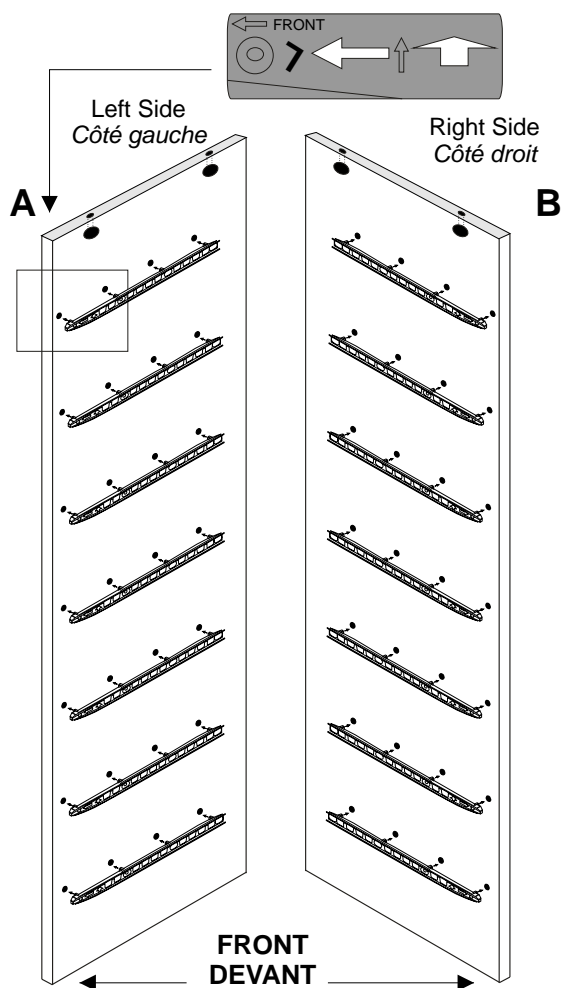

3.

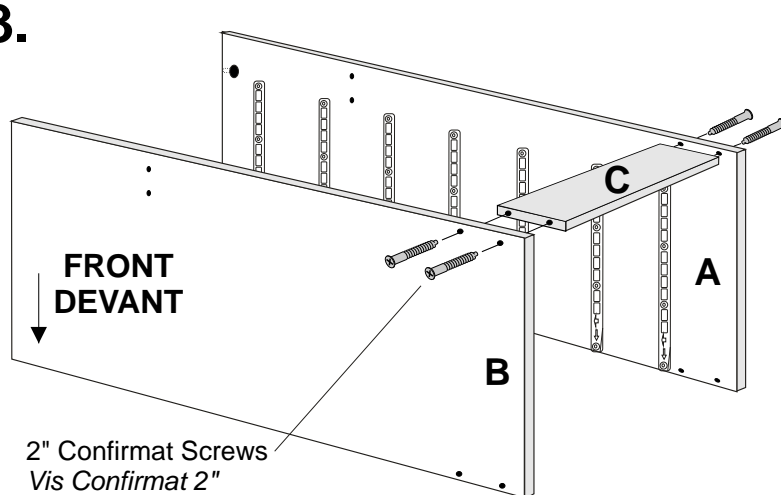

4.

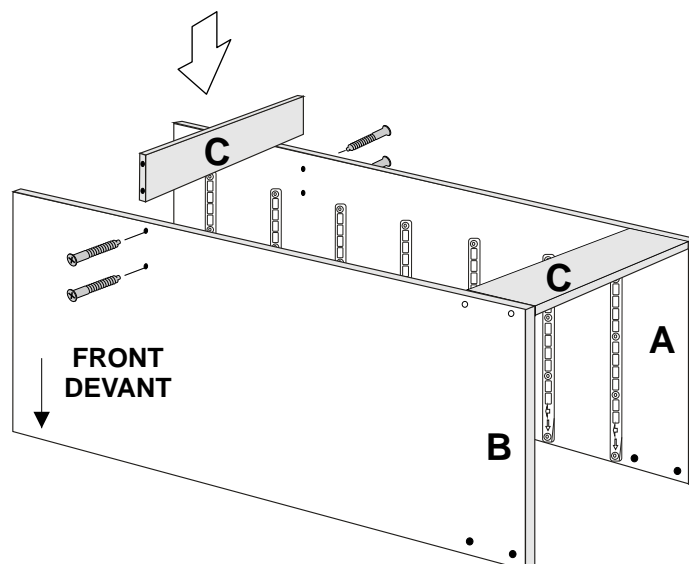

5.

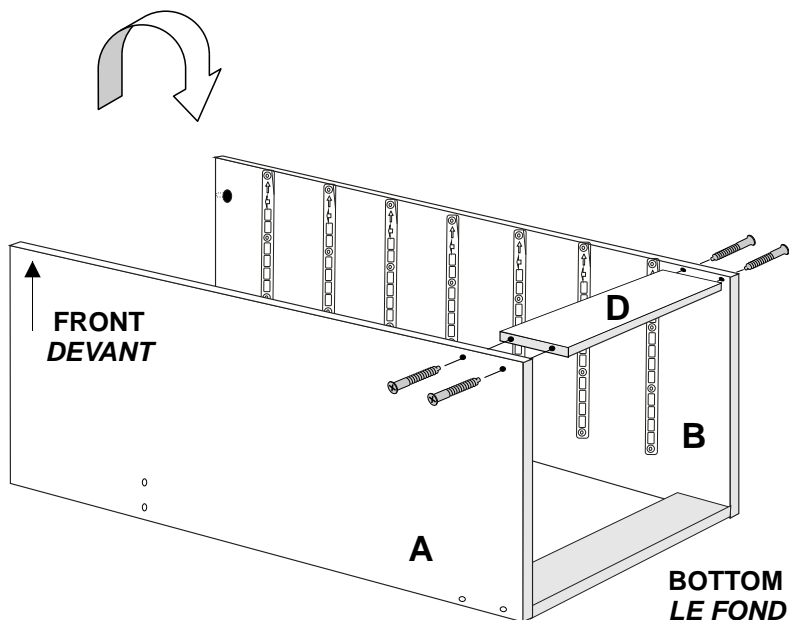

6.

BOTTOM
LE FOND

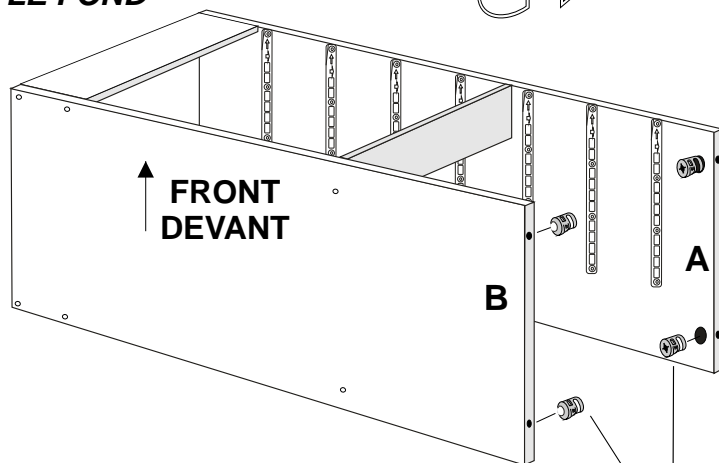

Insert cams in the **unlocked** position, with the opening facing toward the hole for the rod.

*Insérez les ferrures dans la position **déverrouillée**, de façon à ce que l'ouverture soit face au trou de la tige.*

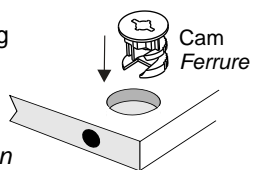

8.

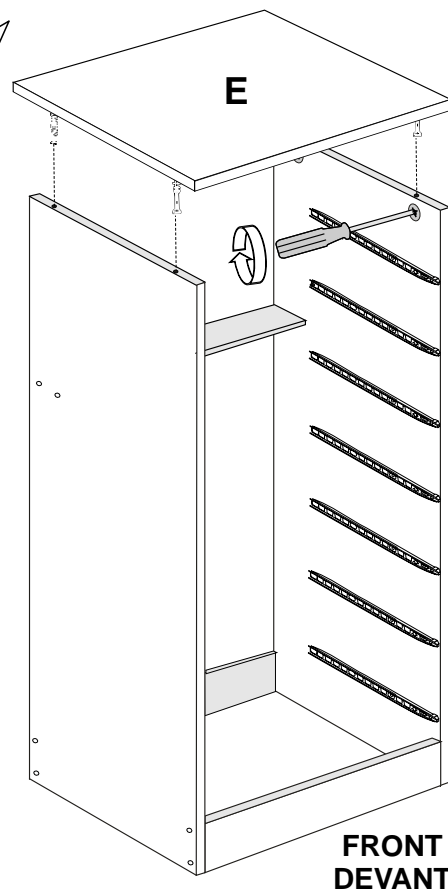
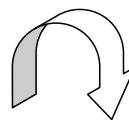

7.

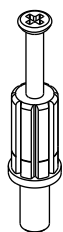

34mm Black Twister Dowel
Goujon de torsion noir 34mm

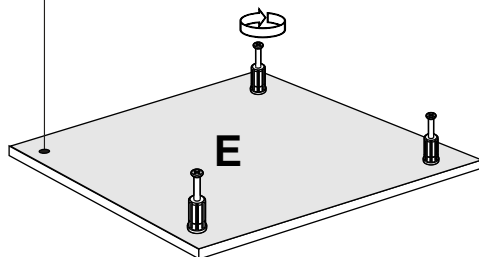

9.

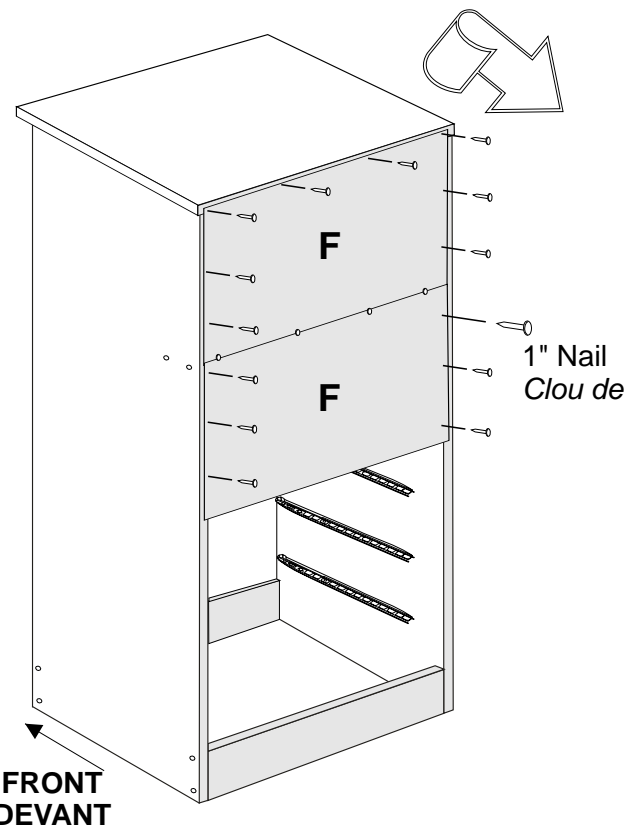

ONLINE
HELP



AIDE EN
LIGNE

To see a video showing how the cams and connectors work, visit our website:
www.prepacmfg.com/support/assemblyvideos.html

*Pour voir qu'une vidéo montrant comment les ferrures et les tiges travaillent, visitez notre site internet :
www.prepacmfg.com/support/assemblyvideos.htm*

- 10.** Lay drawer sides flat before inserting drawer stops
Mettre les côtés du tiroir à plat avant d'insérer les arrêts

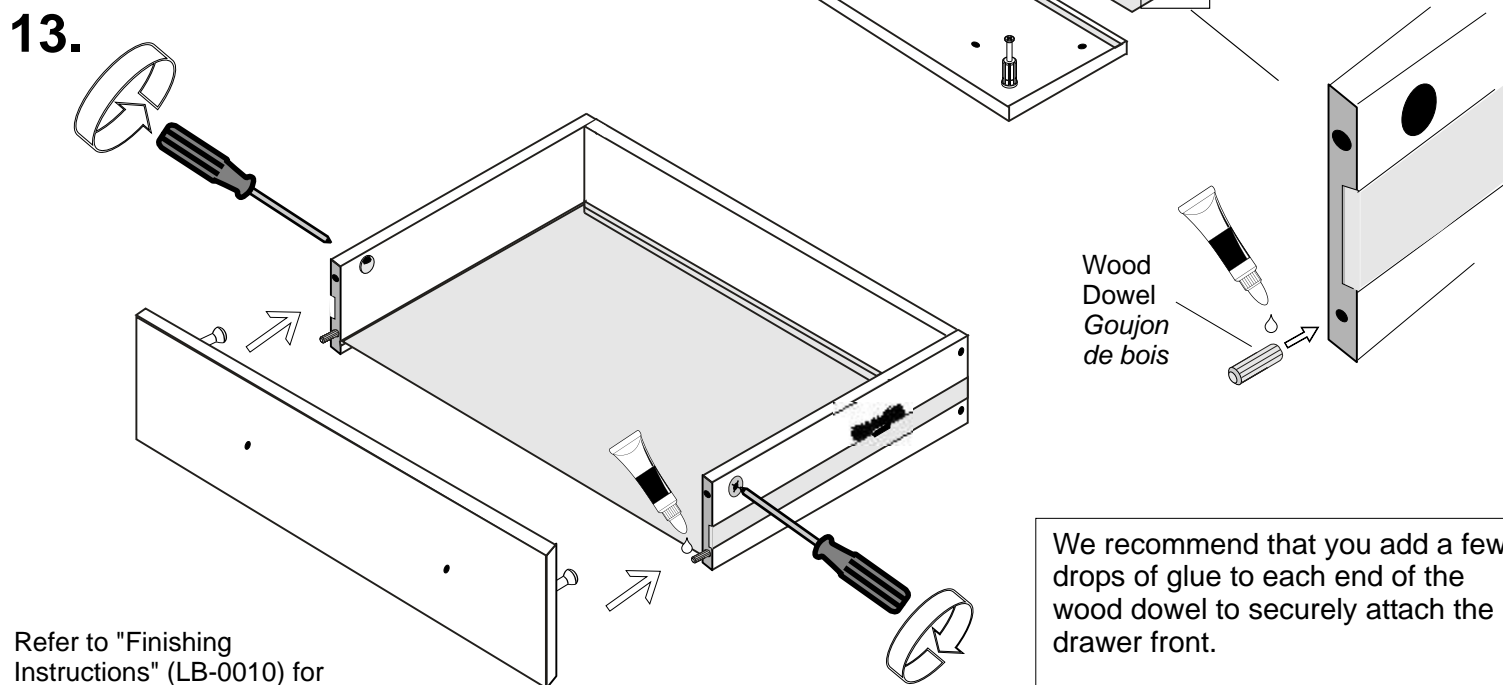
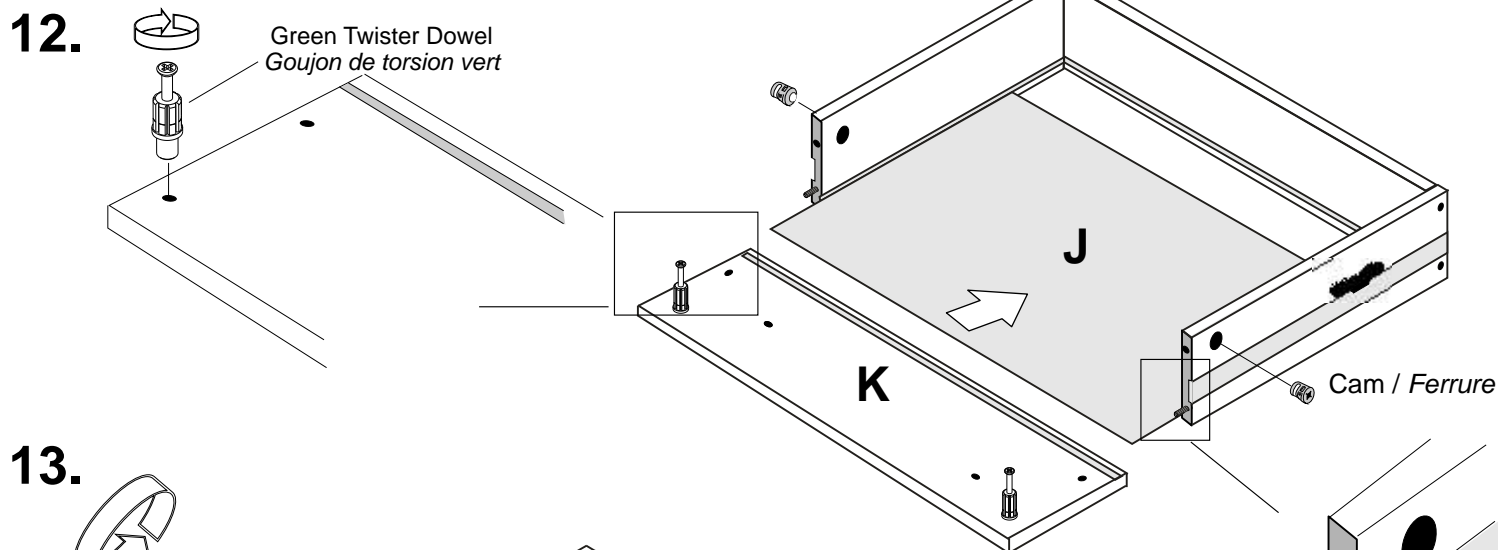
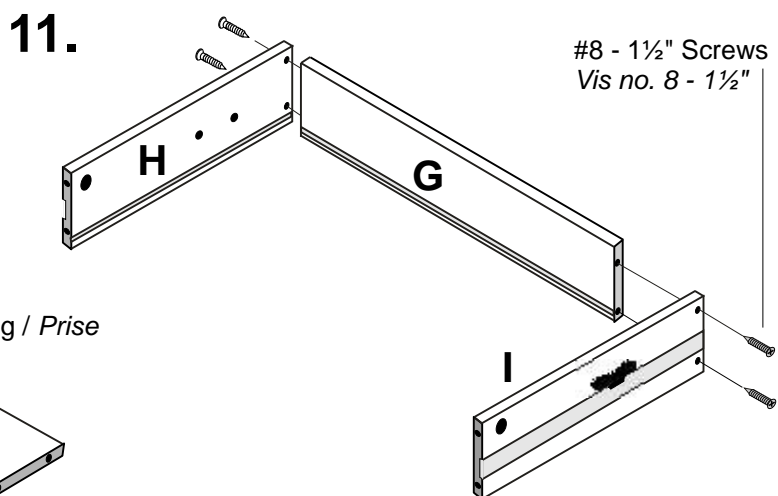
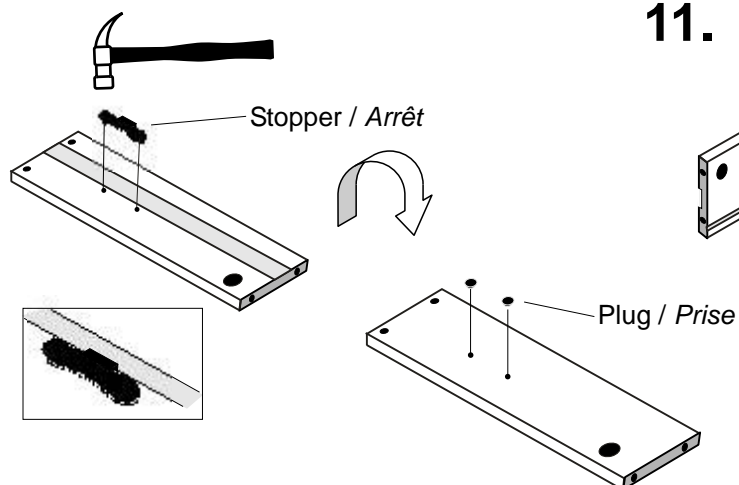

Refer to "Finishing Instructions" (LB-0010) for attaching drawer pulls
Voir la section «Finition de l'assemblage» (LB-0010) pour l'insertion des poignées des tiroirs

We recommend that you add a few drops of glue to each end of the wood dowel to securely attach the drawer front.

Nous vous recommandons de mettre un peu de colle de chaque côté du goujon de bois pour attacher solidement le devant du tiroir.