

Revell

KIT 2874

SHELBY GT.350R



85287410200

With the introduction of its new Mustang in April of 1964, Ford had a major success story on its hands right from the start. In Ford's desire to create a more limited edition high performance version of its little pony car, they turned to retired race driver Carroll Shelby with whom they had a business relationship. Shelby's Cobra sports cars were powered by Ford engines. The result was the now well-known Shelby GT350's with Shelby combining Mustangs in its new fastback body style and factory high-performance versions of the stock 289 V8s with Shelby's retuning of the suspension to create a very credible street burner.



* REPEAT SEVERAL TIMES * REPEAT PROCEDURE * OPTIONAL PARTS * DECAL * ASSEMBLY CAUTION * CEMENT TOGETHER * REMOVE AND THROW AWAY * DO NOT CEMENT
 * A REPETER PLUSIEURS FOIS * RÈPÈTEZ LE PROCÈDÈ * PIÈCES EN OPTION * DECAL COMANIE * ATTENTION D'ASSEMBLÉE * A COLLER * A RETIRER ET JETER * NE PAS COLLER

READ THIS BEFORE YOU BEGIN

- * Study the assembly drawings.
- * Each plastic part is identified by a number.
- * In the assembly drawings, some parts will be marked by a star (★) to indicate chrome plated plastic.
- * For better paint and decal adhesion, wash the plastic parts in a mild detergent solution. Rinse and let air dry.
- * Check the fit of each piece before cementing in place.
- * Use only cement for polystyrene plastic.
- * Scrape plating and paint from areas to be cemented.
- * Allow paint to dry thoroughly before handling parts.
- * Any unused parts may be discarded.

DECAL APPLICATION INSTRUCTIONS

1. Cut desired decal from sheet.
2. Dip decal in water for a few seconds.
3. Place wet decal on paper towel.
4. Wait until decal is movable on paper backing.
5. Place decal in position on model, face up and slide backing away.
6. Press out air bubbles with a soft damp cloth.
7. Milkiness that may appear is for better decal adhesion and will dry clear. Wipe away any excess adhesive.
8. Do not touch decal until fully dry.
9. Allow the decals 48 hours to dry before applying clear coat.

NOTE: Decals are compatible with setting solutions or solvents.

LIRE CE QUI SUIT AVANT DE COMMENCER

- * Etudier les schémas de montage.
- * Chaque pièce en plastique est identifiée par un numéro.
- * Sur les schémas de montage, certaines pièces sont marquées d'une étoile (★) pour indiquer qu'elles sont en plastique chromé.
- * Pour une meilleure prise de la peinture et des autocollants, laver les pièces en plastique avec une solution détergente peu concentrée. Les rincer et les laisser sécher à l'air.
- * Vérifier que chaque pièce s'ajuste bien avant de la coller en place.
- * N'utiliser que de la colle pour polystyrène.
- * Gratter les parties à coller pour enlever le chrome et la peinture.
- * Laisser la peinture bien sécher avant de manipuler les pièces.
- * Toute pièce inutilisée peut être jetée.

DIRECTIVES D'APPLICATION DES AUTOCOLLANTS

1. Découper l'autocollant désiré de la feuille.
2. Tremper l'autocollant dans de l'eau pendant quelques secondes.
3. Placer l'autocollant mouillé sur une serviette en papier.
4. Attendez que l'autocollant puisse être déplacé sur son support en papier.
5. Mettre l'autocollant en position sur le modèle face sur le dessus et faire glisser le support pour l'enlever.
6. Appuyer avec un chiffon doux humide pour éliminer les bulles d'air.
7. La substance laiteuse qui peut apparaître est destinée à améliorer l'adhésion de l'autocollant et devient incolore au séchage. Essuyer pour enlever tout excédent d'adhésif.
8. Ne pas toucher l'autocollant tant qu'il n'est pas bien sec.
9. Laisser l'autocollant sécher pendant 48 heures avant d'appliquer une couche transparente.

REMARQUE: Les autocollants sont compatibles avec les solutions de fixation ou les solvants.

This optional paint guide is provided if you choose to detail paint your model.

Ce guide de peinture vous sera fourni si vous choisissez de peindre votre modèle en détail.

Aluminum	Aluminium
Flat Black	Noir mat
Gloss Red	Rouge brillant
Gloss White	Blanc brillant
Guardsmen Blue	Bleu gardes
Semigloss Black	Noir satiné
Silver	Argent
Steel	Acier
Transparent Red	Rouge transparent
Turn Signal Amber	Feu clignotant de direction ambre
Wood	Bois

If you have any questions or comments, call our hotline at: **(800) 833-3570**
 or, please write to:

Revell Inc Consumer Service Department, 1850 Howard Street Unit A, Elk Grove Village, Illinois 60007
 Be sure to include the plan number (85287410200), part number, description, your return address and phone number.

Visit our website: www.revell.com

1

BODY ASSEMBLY

A

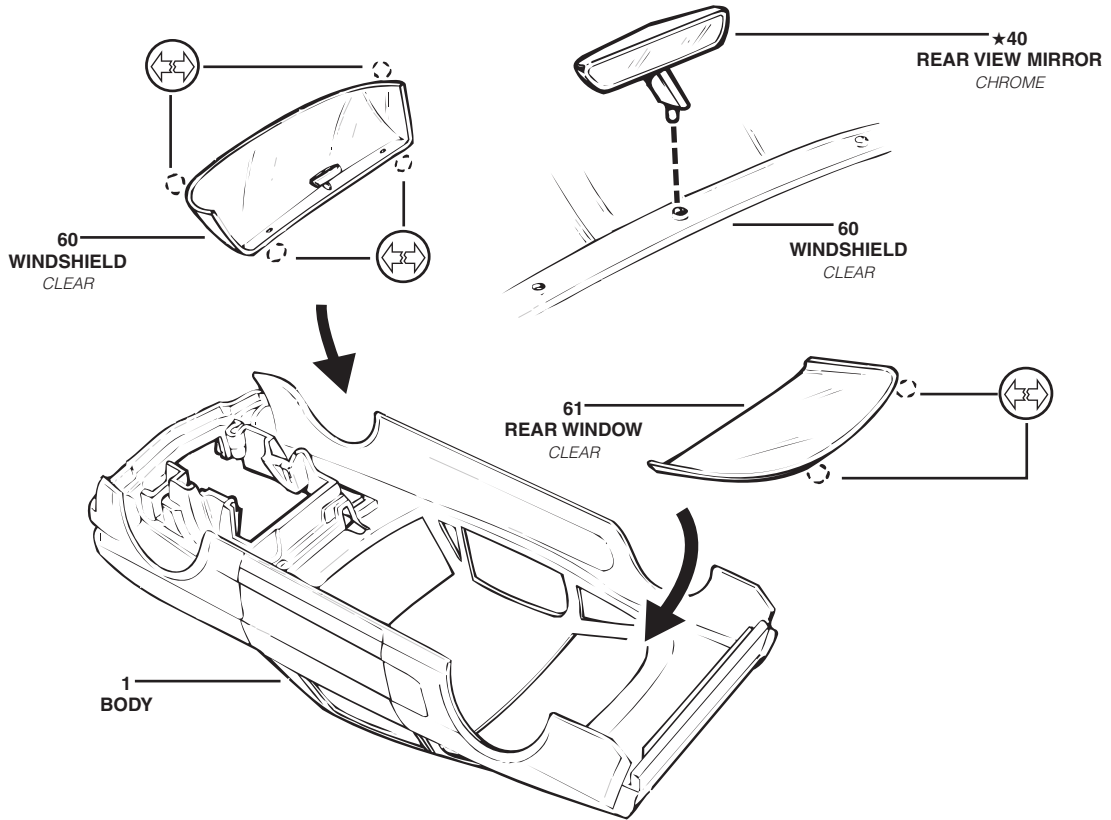

B

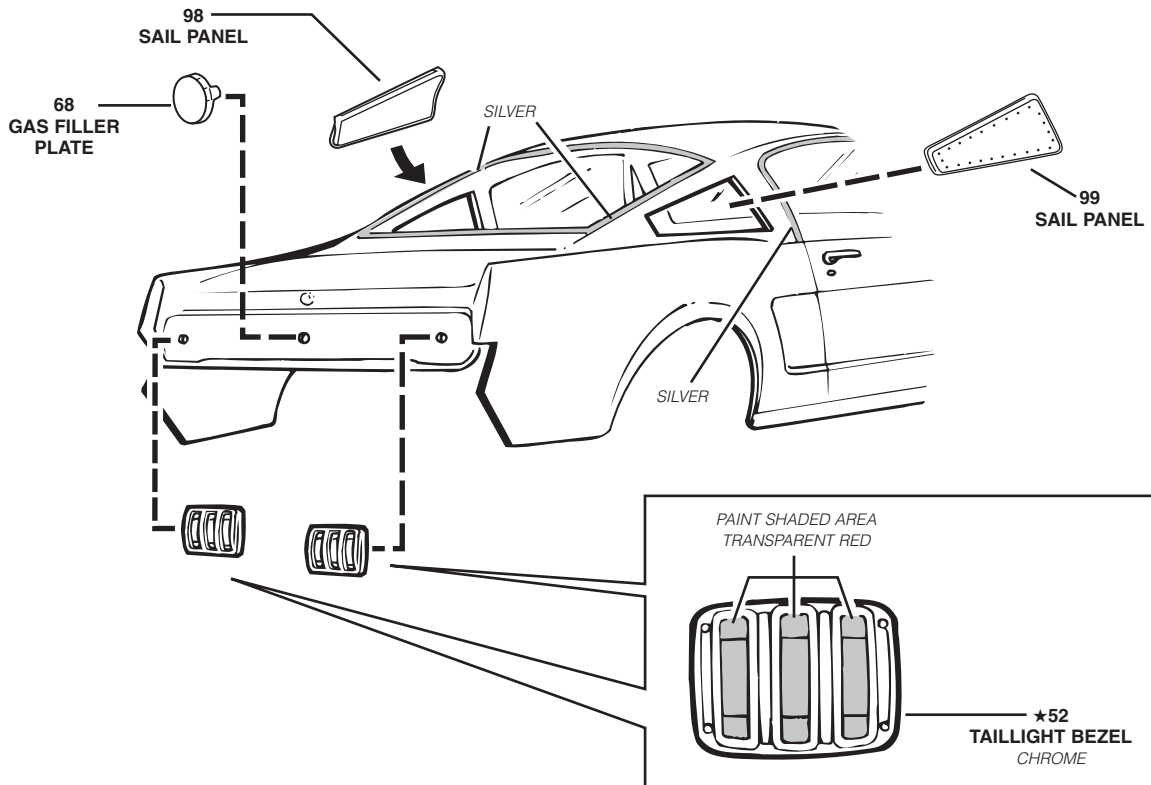

2

INTERIOR ASSEMBLY

A

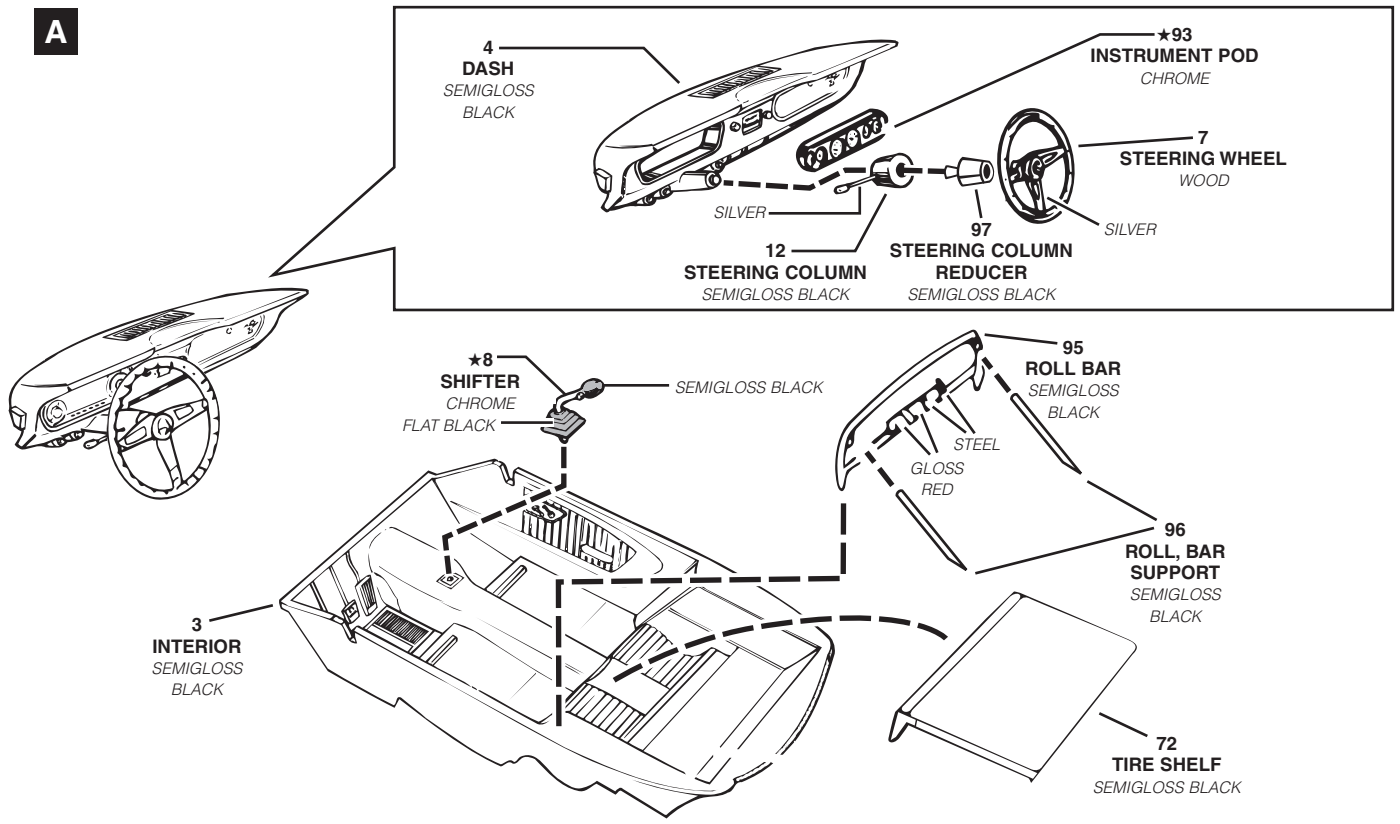

B

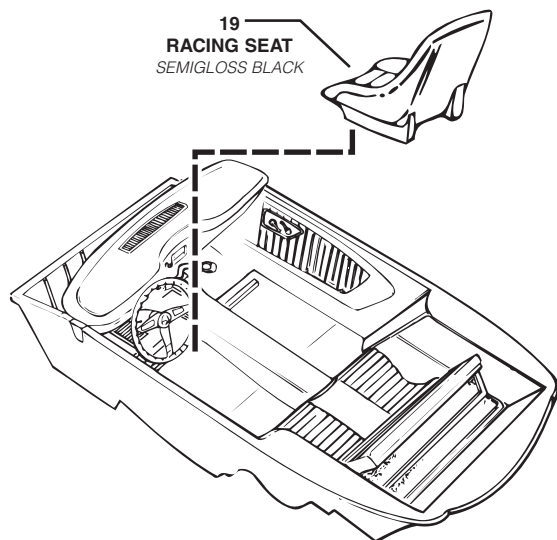

C

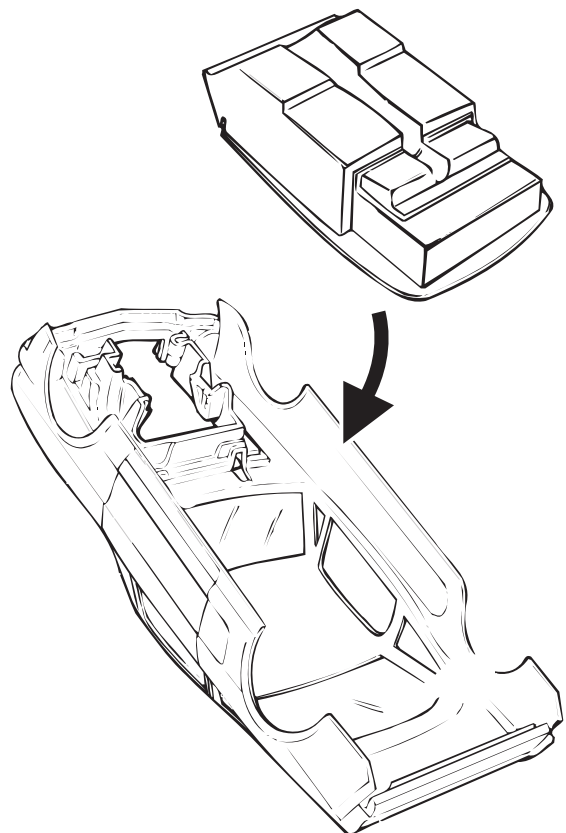

3

ENGINE ASSEMBLY

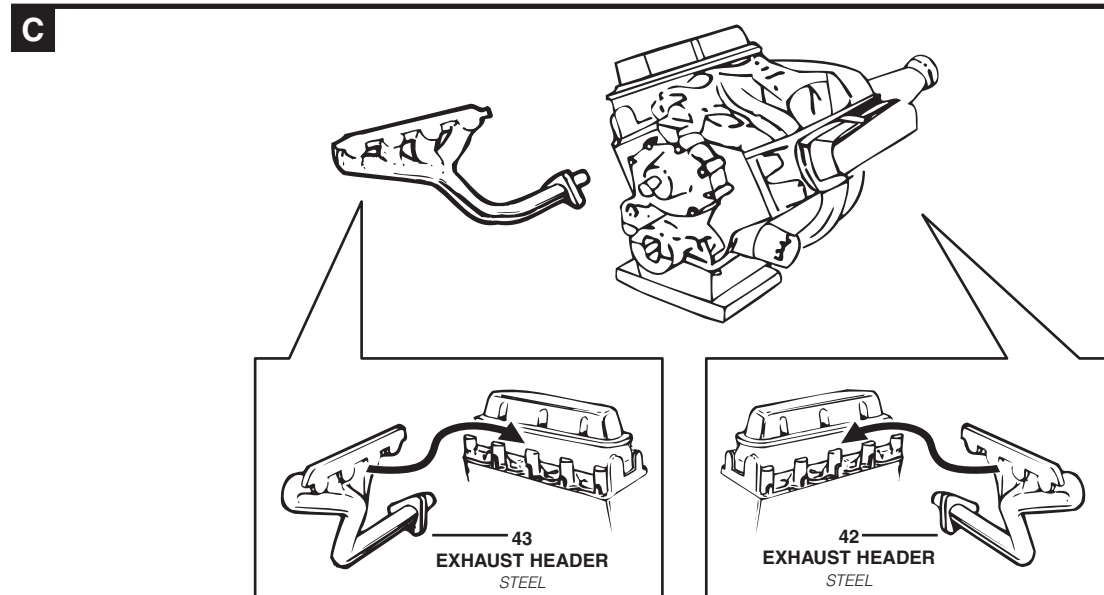
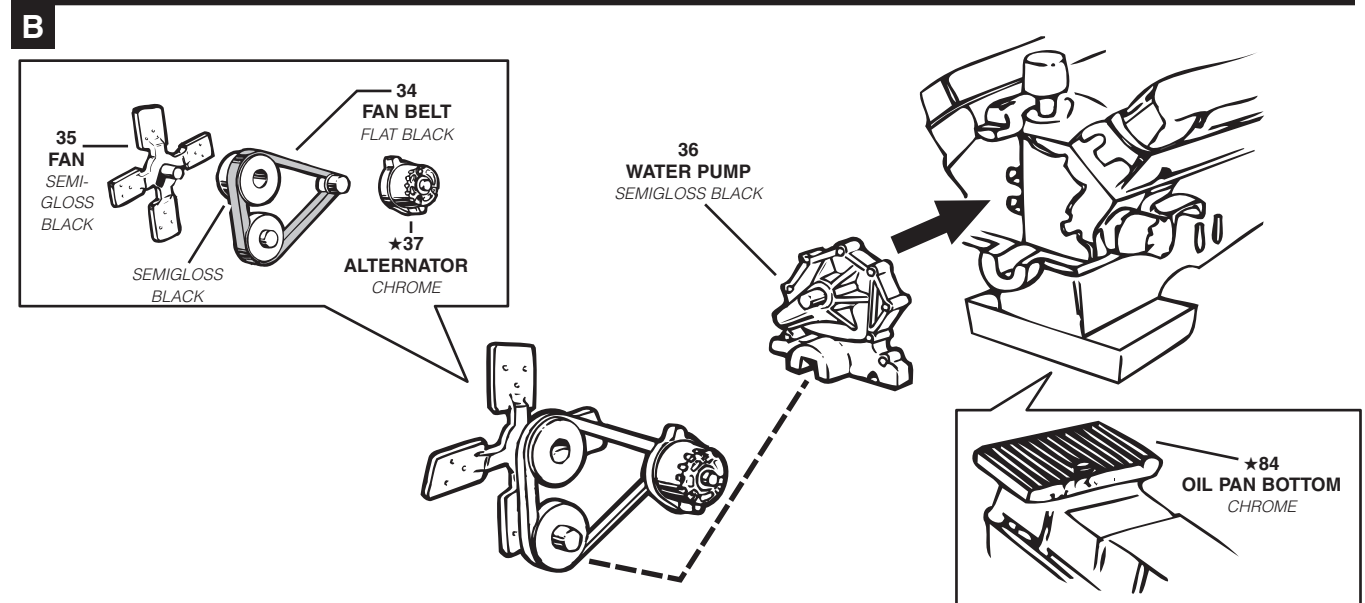
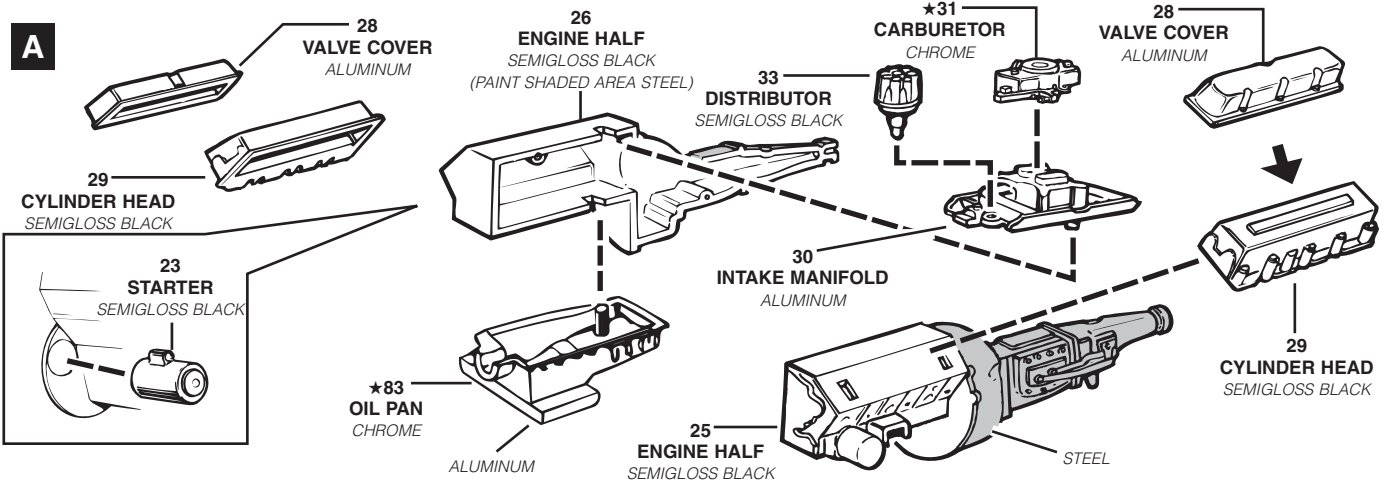

4

SUSPENSION ASSEMBLY

A

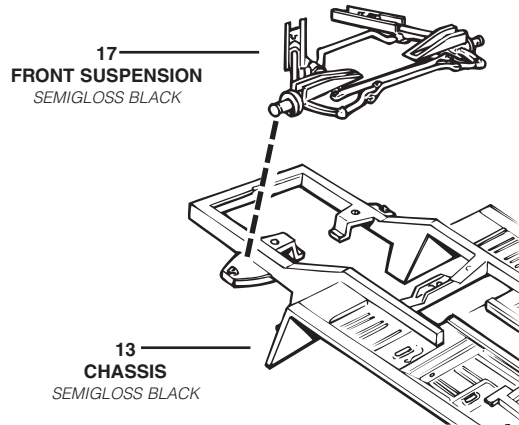

B

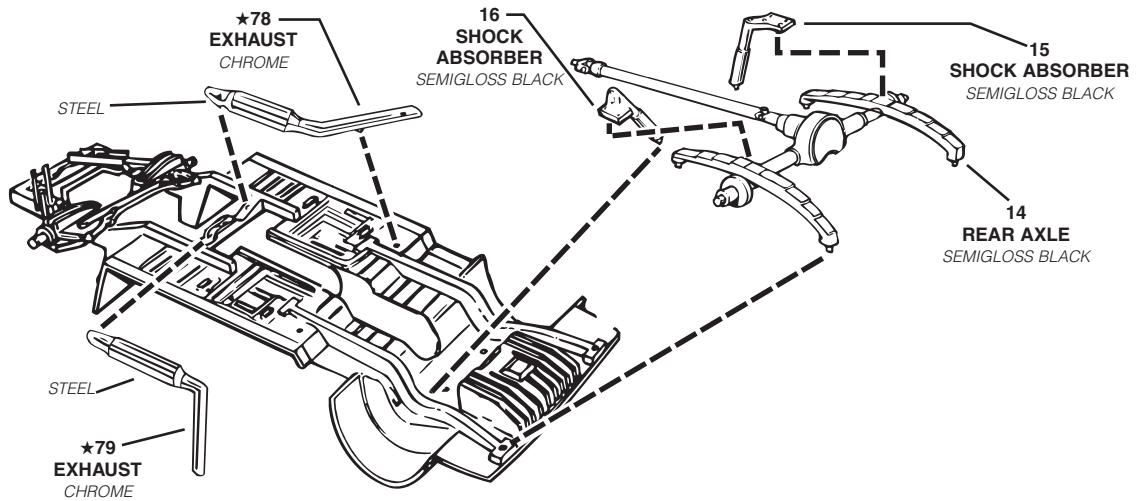

C

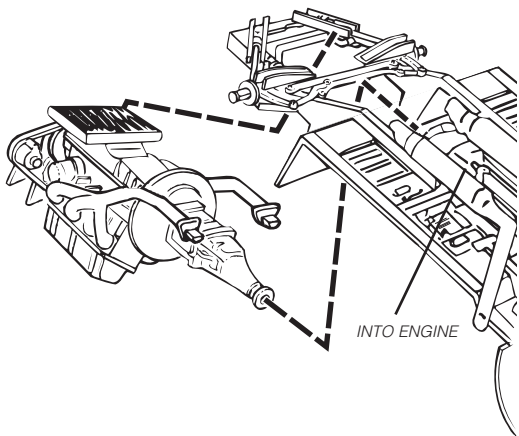

D

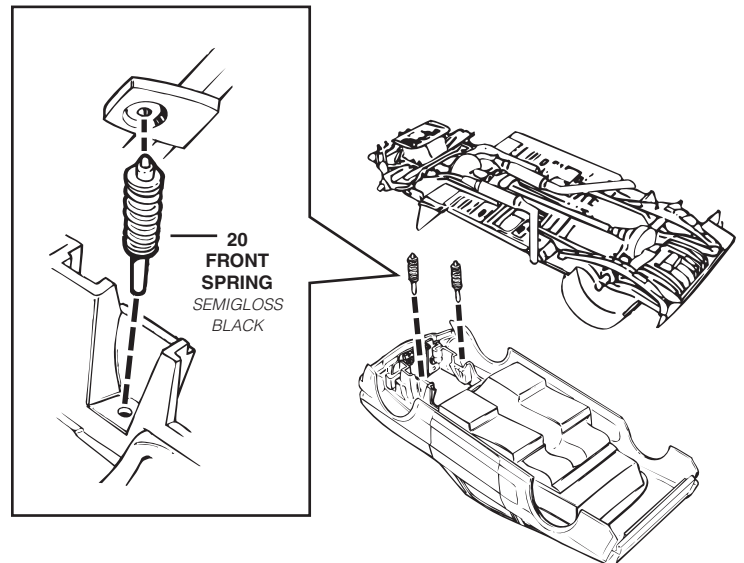

5

WHEEL AND TIRE ASSEMBLY

A

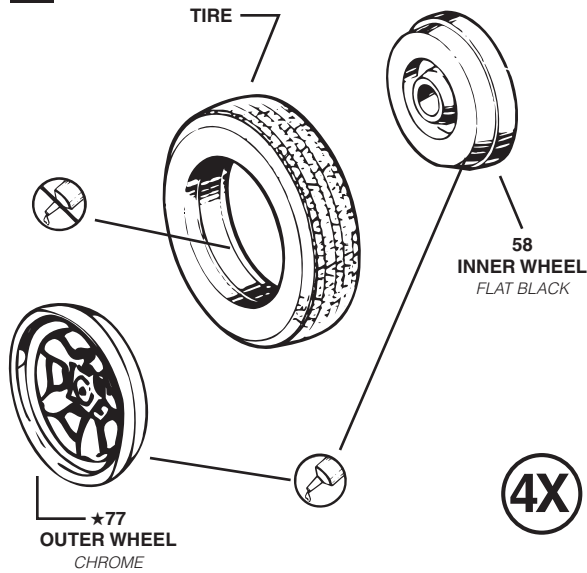

B

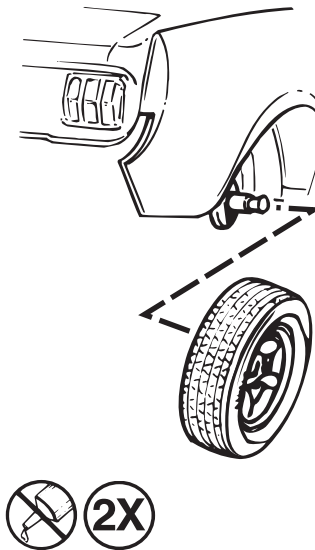

C

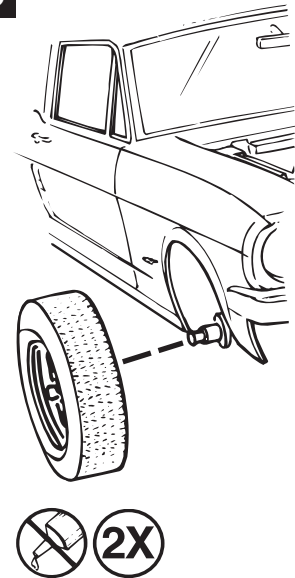

6

FINAL ASSEMBLY

A

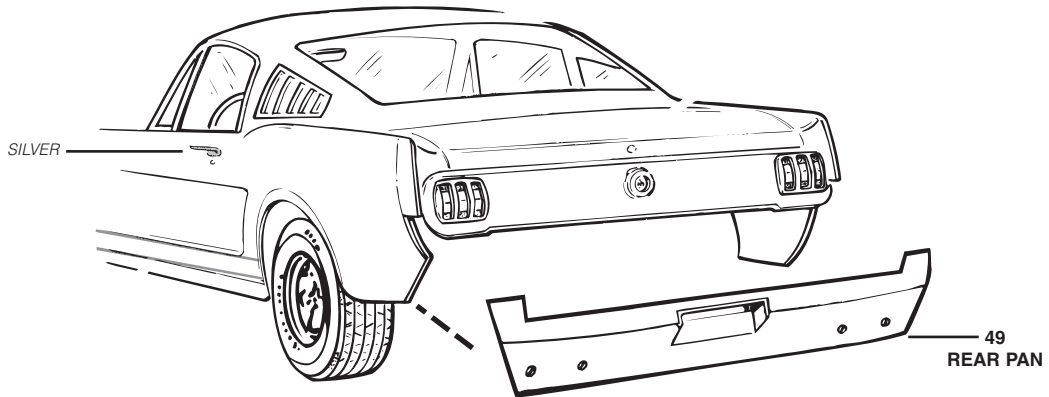

B

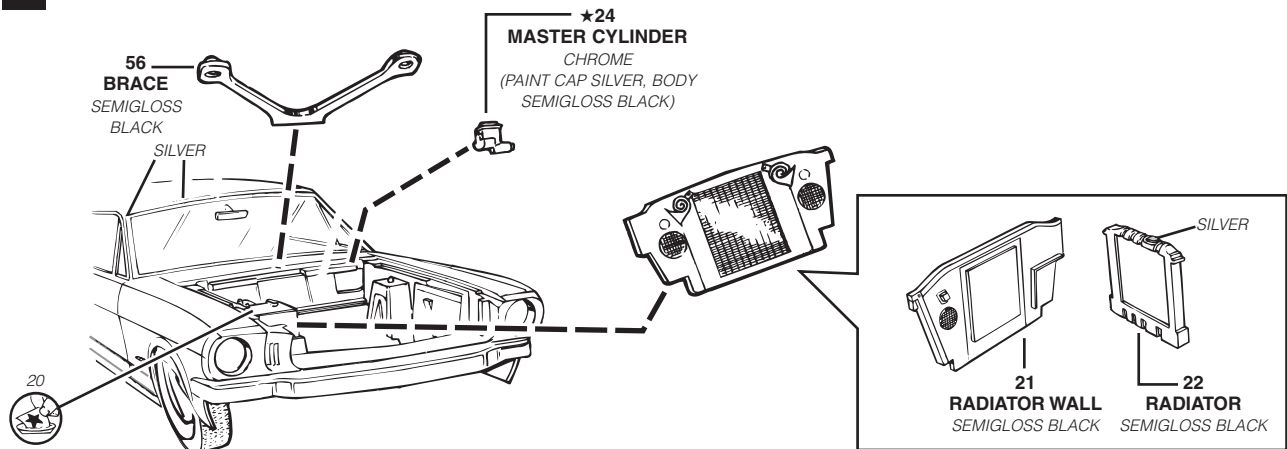

6

FINAL ASSEMBLY CONTINUED

C

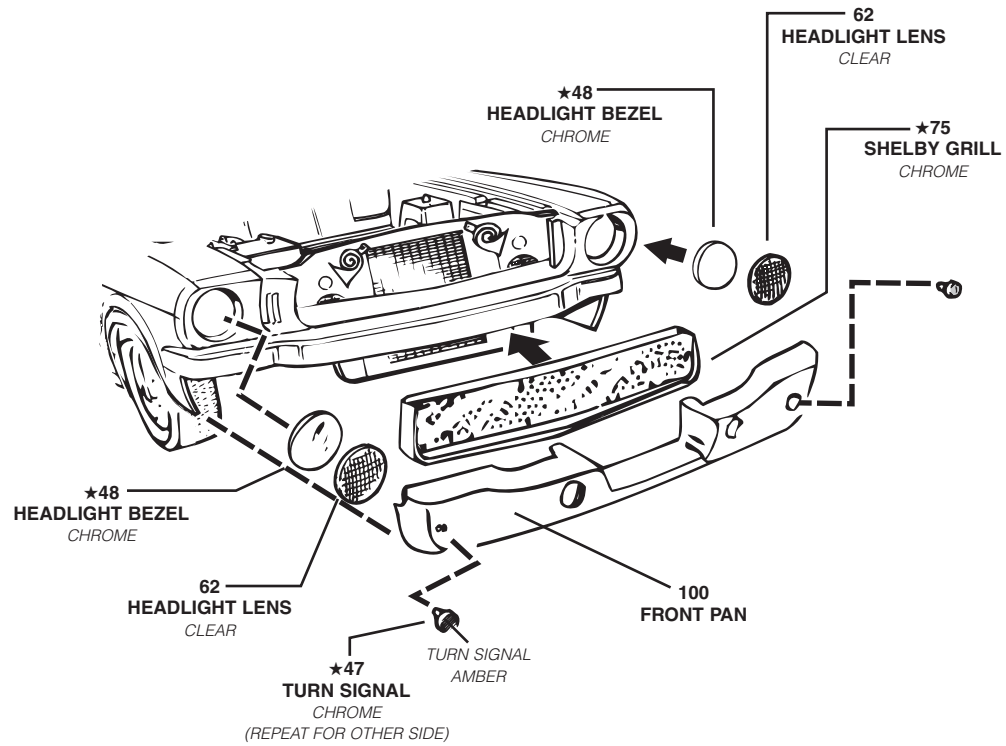

D

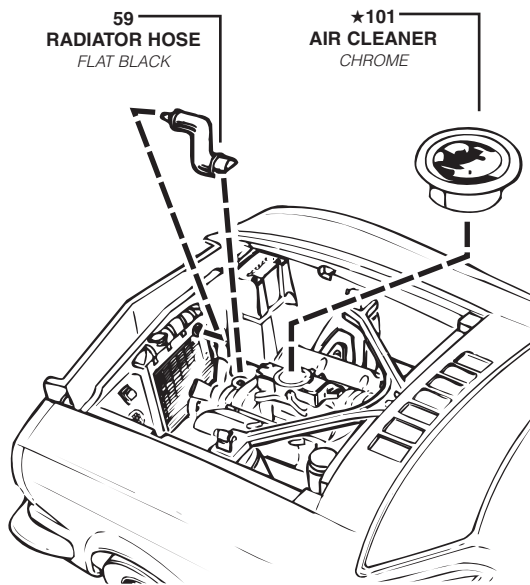

E

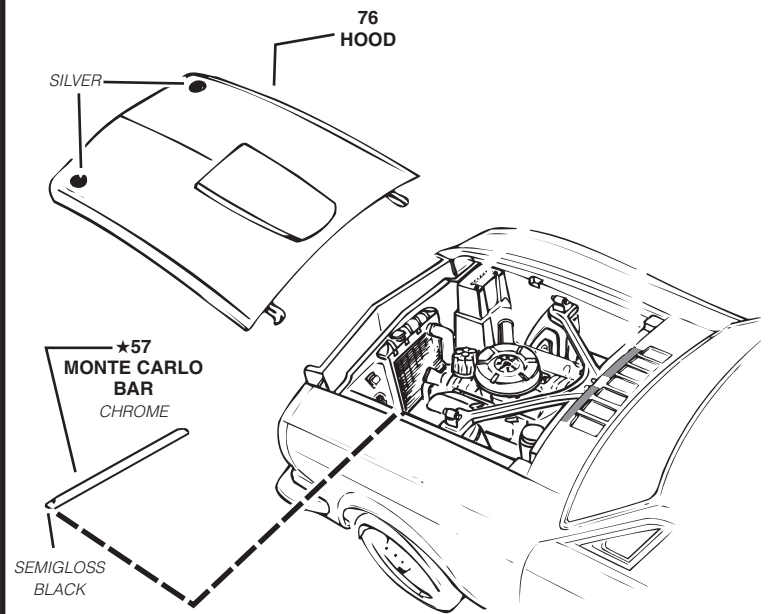

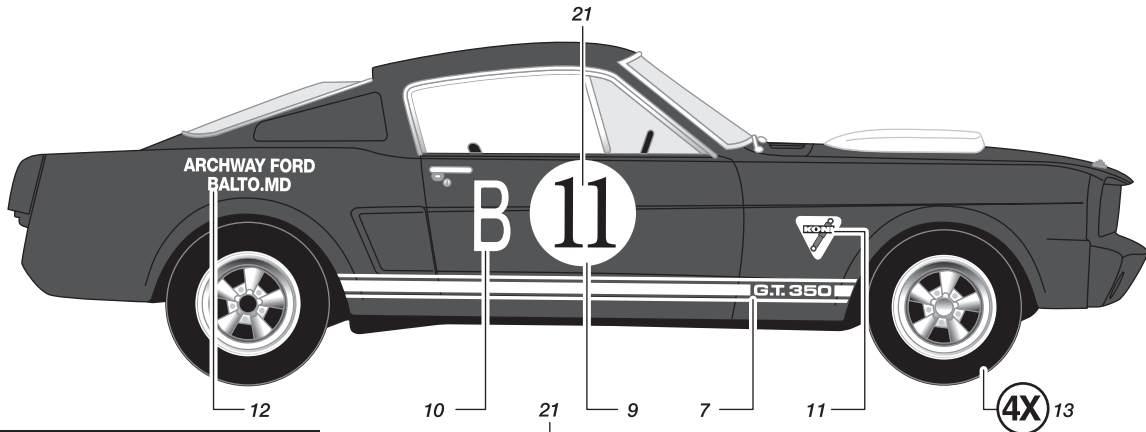
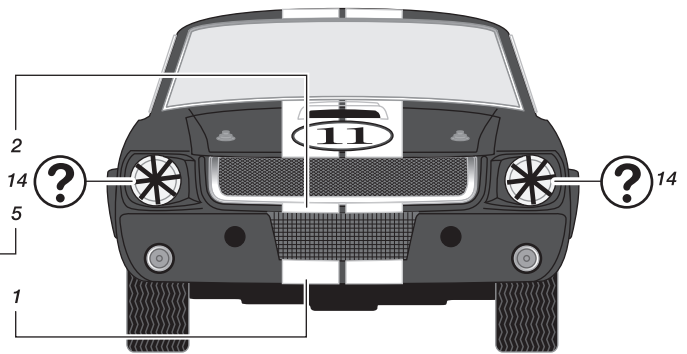
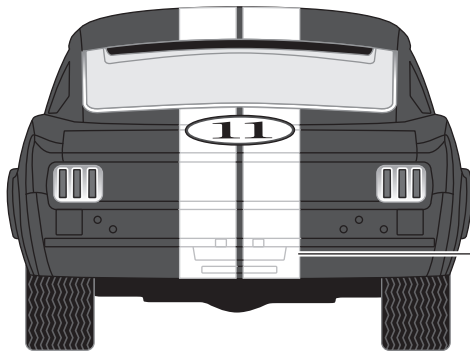

NOTE: DECALS 15, 16, 17, 18, 19 ARE NOT USED

