

American Standard

Installation Instructions

DECK MOUNT TUB SYSTEMS HAMPTON TRIM KIT

T980.702
T980.712
T980.722
T980.732



Thank you for selecting American-Standard...the benchmark of fine quality for over 100 years.

To ensure that your installation proceeds smoothly—please read these instructions carefully before you begin.

Certified to comply with ANSI A112.18.1
U.S. Patent No. D403,750 M968655A

Trim Kits

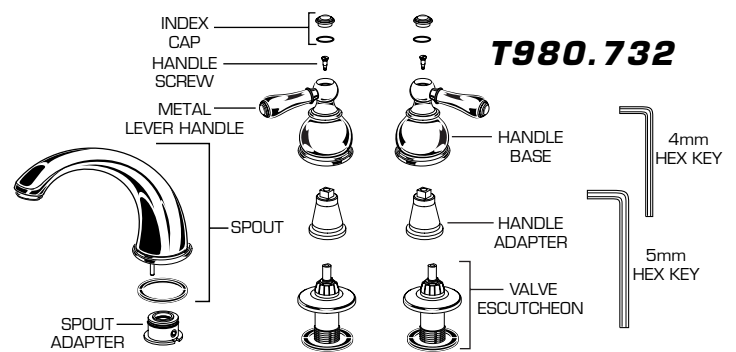
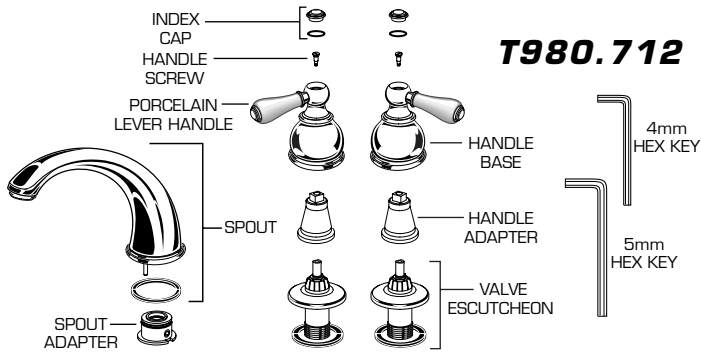
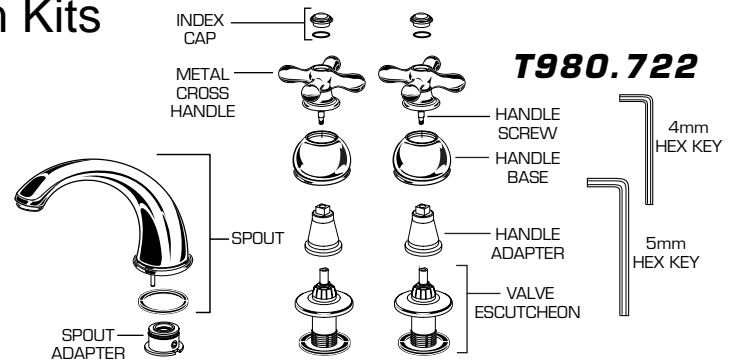
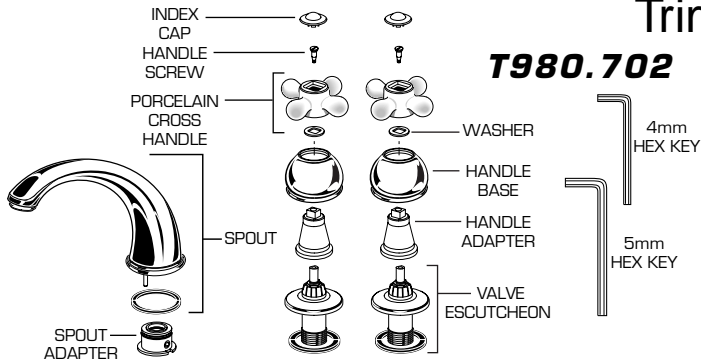

1 SPOUT INSTALLATION

- Complete FINISHED DECK before trim installation.
- Turn off the water supplies.
- Remove the GUARDS from the VALVE BODIES. Remove the GUARD and 1/4" PLUG from the SPOUT SHANK.
- The SPOUT SHANK height should be 1" to 2" above the FINISHED DECK. Cut the SPOUT SHANK if necessary. **Remove all burrs and bevel the end of the shank. Failure to do so may damage the SPOUT O-ring during installation and cause water leakage.**
- Drill a 3/16" hole in the finished deck. See TEMPLATE for location.

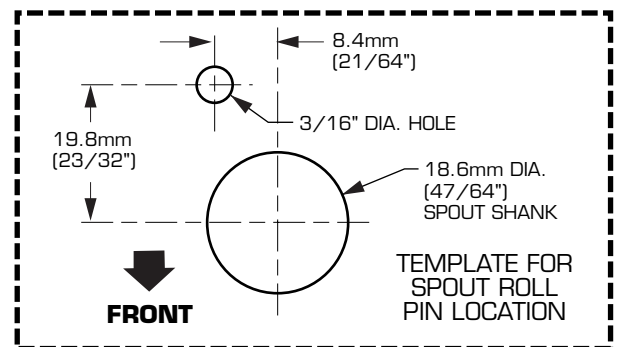
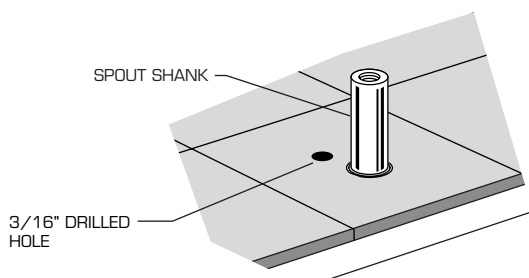
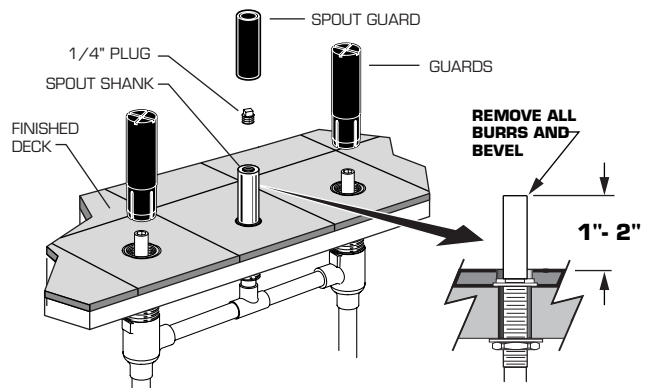

1 CONTINUED

- Lubricate the SPOUT ADAPTER O-RING and SPOUT O-RING.
- Push SPOUT ADAPTER on SPOUT SHANK and align slot in SPOUT ADAPTER with 3/16" drilled hole.
- Tighten SPOUT ADAPTER SET SCREW securely with 4mm HEX KEY.
- Remove the PLUG BUTTON from the SPOUT.
- Position the RUBBER RING in the groove in the base of the SPOUT. Push the SPOUT down onto the SPOUT ADAPTER and tighten the SET SCREW securely with the 5mm HEX KEY.
- Insert the PLUG BUTTON into the SPOUT.

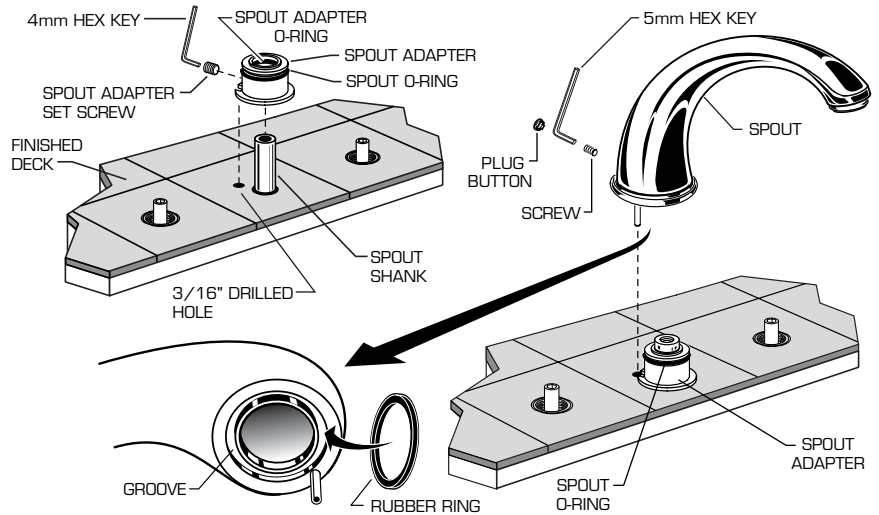

2 VALVE TRIM

- Place the ESCUTCHEON SEALS over the VALVE BODIES.
- Thread the VALVE ESCUTCHEONS into the VALVE BODIES. Align the HANDLE STEM with the SLEEVE as necessary. Thread the VALVE ESCUTCHEON into the BODIES until the ESCUTCHEON contacts the finished deck.

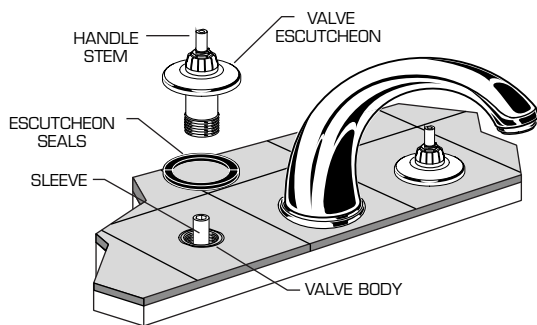

3 INSTALL HANDLES

LEVER HANDLE

- Turn VALVE into OFF position.
- Push ADAPTER into HANDLE BASE in a way that the male square on the ADAPTER fits in the female square of the HANDLE BASE.
- Push HANDLE and ADAPTER onto VALVE STEM.
- Check alignment, if not satisfactory aligned;
 - Push out ADAPTER carefully.
 - Turn ADAPTER either 45° or 90° so that male square on ADAPTER catches different female square in HANDLE BASE.
 - Assemble and tighten HANDLE SCREW.
- Push INDEX CAP in top of HANDLE.

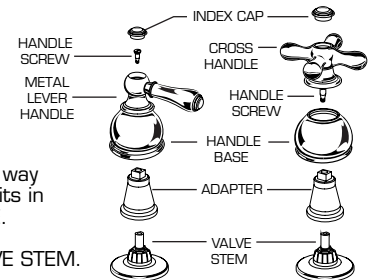

CROSS HANDLE

- Turn VALVE into OFF position.
- Push ADAPTER into HANDLE BASE.
- Push HANDLE and ADAPTER onto VALVE STEM.
- Push CROSS onto ADAPTER.
- Assemble and tighten HANDLE SCREW.
- Push INDEX CAP in top of HANDLE.

4 TESTING

- Turn the HOT HANDLE clockwise and the COLD HANDLE counterclockwise to the off position.
- Unscrew and remove the SPOUT END.
- Slowly turn on the water supplies.
- Operate the HANDLES to flush water lines thoroughly. Check SPOUT connection for leakage.
- Turn the Handles off. Replace the SPOUT END.

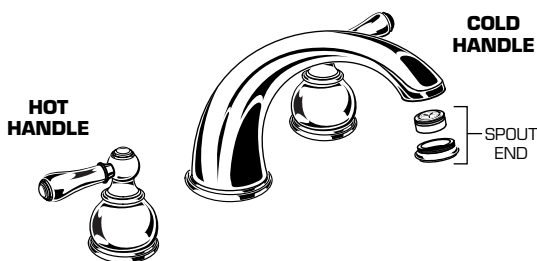

5 SERVICE

To change the direction of handle rotation

- Turn off the water supplies
- Turn HANDLE to the off position.
- Remove the INDEX CAP and the HANDLE SCREW. Pull the HANDLE BASE off and remove ADAPTER.
- Unscrew the VALVE ESCUTCHEON.
- Unscrew the VALVE LOCK NUT and remove. A 17mm deep socket is required.
- Remove the CARTRIDGE by pulling up on the SLEEVE.
- Remove the SLEEVE from the CARTRIDGE.
- Remove the SPRING CLIP.
- Remove the STOP WASHER. Turn it 90° and replace.
- Replace the SPRING CLIP.
- Reverse the above steps to reassembly the components.
- If the spout drips, operate the handles several times from the off to the on position. Do not force - the handles only turn 90°

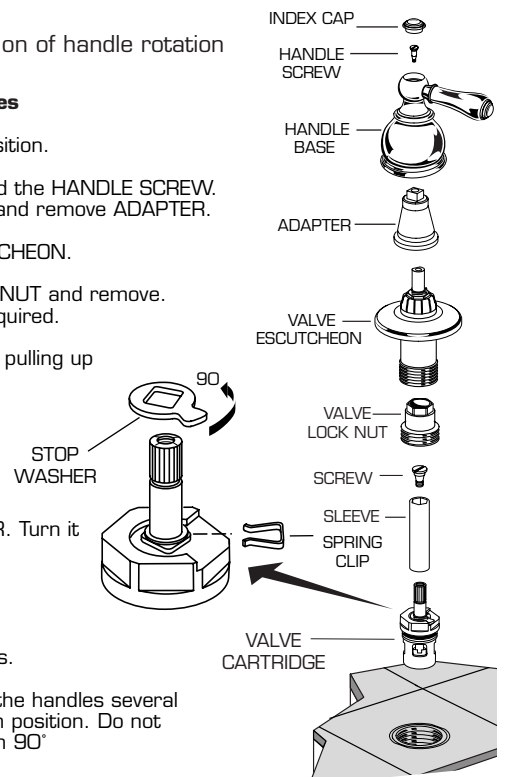

HOTLINE FOR HELP
For toll-free information and answers to your questions, call:
1 (800) 442-1902
Weekdays 8:00 a.m. to 7:00 p.m. Eastern Time
IN CANADA 1-800-387-0369 (TORONTO 1-416-536-5609)

American Standard

DECK MOUNT TUB FILLERS

Installation Instructions T991 SERIES

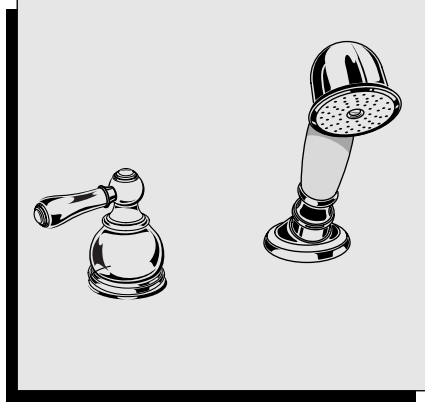

Certified to comply with ANSI A112.18.1
U.S. Patent No. D403,750

M968357

HAMPTON DIVERTER & PERSONAL SHOWER TRIM KITS

Thank you for selecting American-Standard...the benchmark of fine quality for over 100 years.

To ensure that your installation proceeds smoothly—please read these instructions carefully before you begin.

T991.702

Trim Kits

T991.722

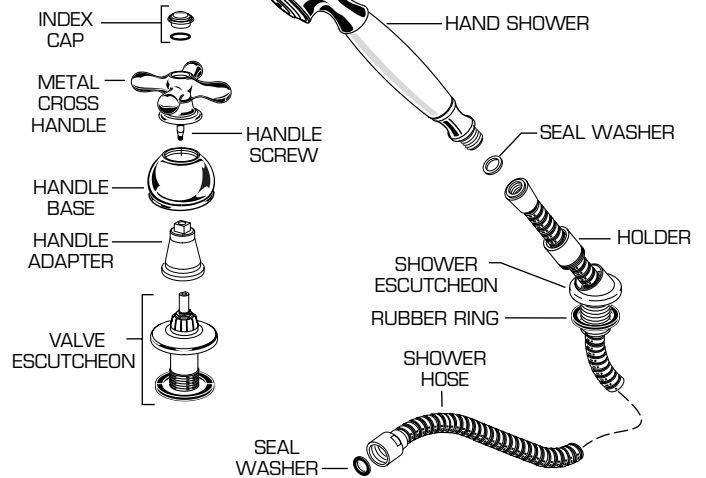
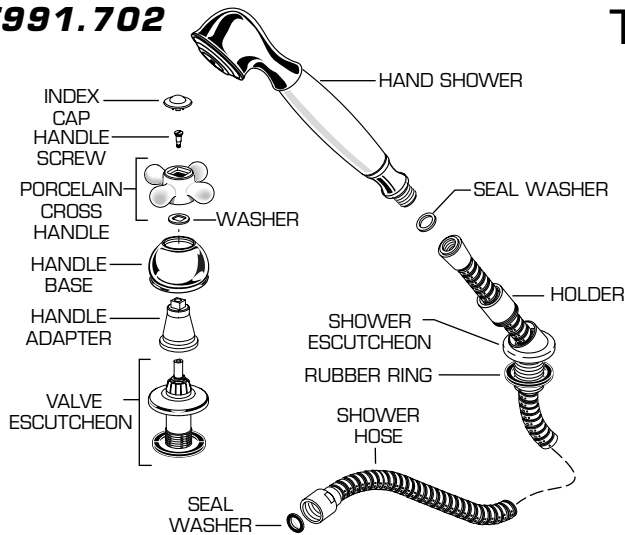

T991.712

T991.732

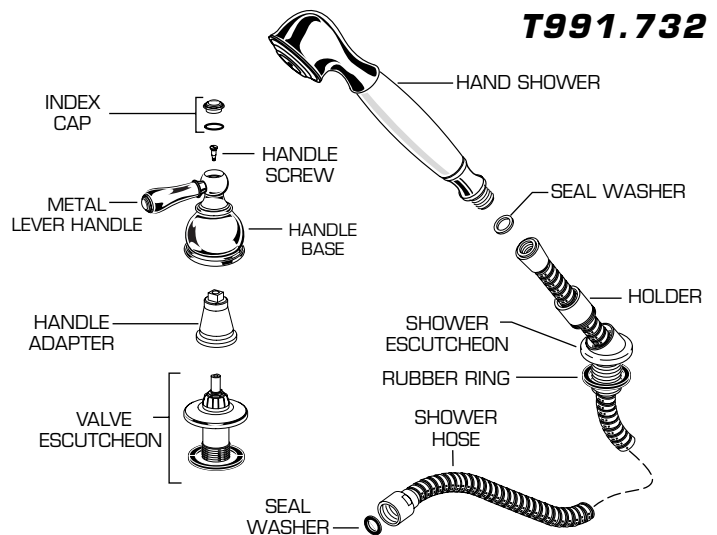
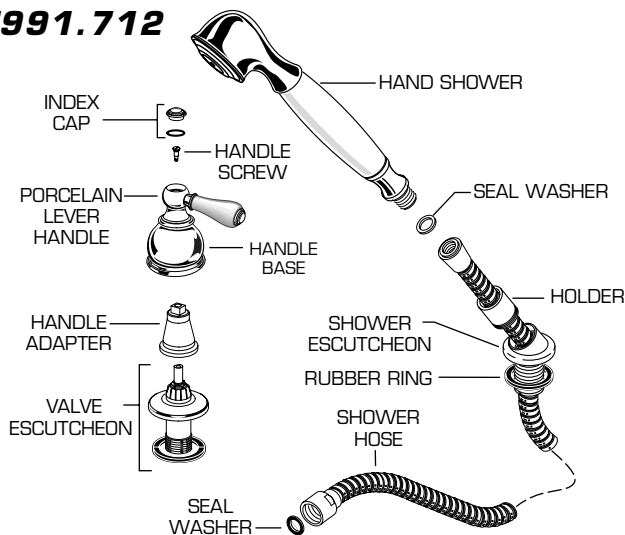

1 INSTALL DIVERTER

- REMOVE THE DIVERTER GUARD.
- Place the ESCUTCHEON SEAL over the DIVERTER BODY.
- Thread the VALVE ESCUTCHEON into the DIVERTER BODY. Align the HANDLE STEM with the SLEEVE as necessary. Thread the VALVE ESCUTCHEON into the BODY until the ESCUTCHEON contacts the finished deck.

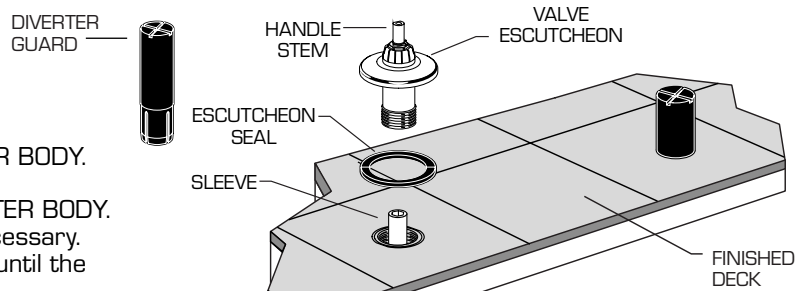

2

INSTALL HANDLES

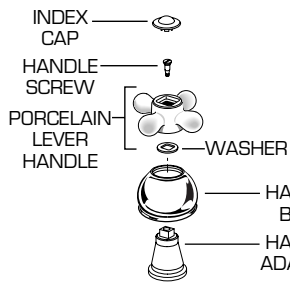

CROSS HANDLES

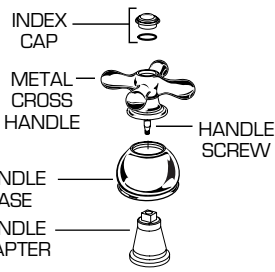

LEVER HANDLES

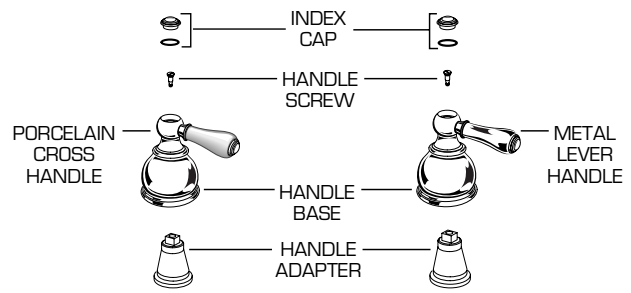

LEVER HANDLE

- Turn HANDLE STEM fully clockwise (Tub Fill position).
- Push ADAPTER into HANDLE BASE in a way that the male square on the ADAPTER fits in the female square of the HANDLE BASE.
- Push HANDLE and ADAPTER onto VALVE STEM.

CROSS HANDLE

- Check alignment, if not satisfactory aligned;
 - Push out ADAPTER carefully.
 - Turn ADAPTER either 45° or 90° so that male square on ADAPTER catches different female square in HANDLE BASE.
 - Assemble and tighten HANDLE SCREW.
- Push INDEX CAP in top of HANDLE.
- Turn HANDLE STEM fully clockwise (Tub Fill position).
- Push ADAPTER into HANDLE BASE.
- Push HANDLE and ADAPTER onto VALVE STEM.
- Push CROSS onto ADAPTER.
- Assemble and tighten HANDLE SCREW.
- Push INDEX CAP in top of HANDLE.

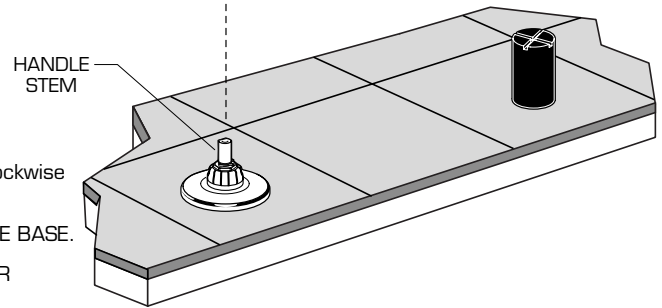

3

INSTALL HAND SHOWER

- Unscrew the HOLDER from the SHOWER ESCUTCHEON. Slip the SHOWER HOSE through the HOLDER and the SHOWER ESCUTCHEON. Insert a SEAL WASHER into the SHOWER HOSE CONNECTOR.
- Pull out the SLEEVE GUARD and HOSE. Unthread the SLEEVE GUARD from the HOSE END connection. **Be careful not to allow the HOSE to fall back through the SLEEVE.**
- Thread the SHOWER HOSE onto the HOSE END connection and tighten securely.
- Apply a sealant around the HOSE HOLE.
- Thread the SHOWER ESCUTCHEON into the SLEEVE until the ESCUTCHEON contacts the finished deck.
- Loosen the SET SCREW in the SHOWER ESCUTCHEON and rotate the ESCUTCHEON towards the center of the tub. Retighten the SET SCREW.
- Thread the HOLDER into the SHOWER ESCUTCHEON.
- Insert a SEAL WASHER into the SHOWER HOSE connector and connect the HAND SHOWER. Place the HAND SHOWER into the HOLDER.

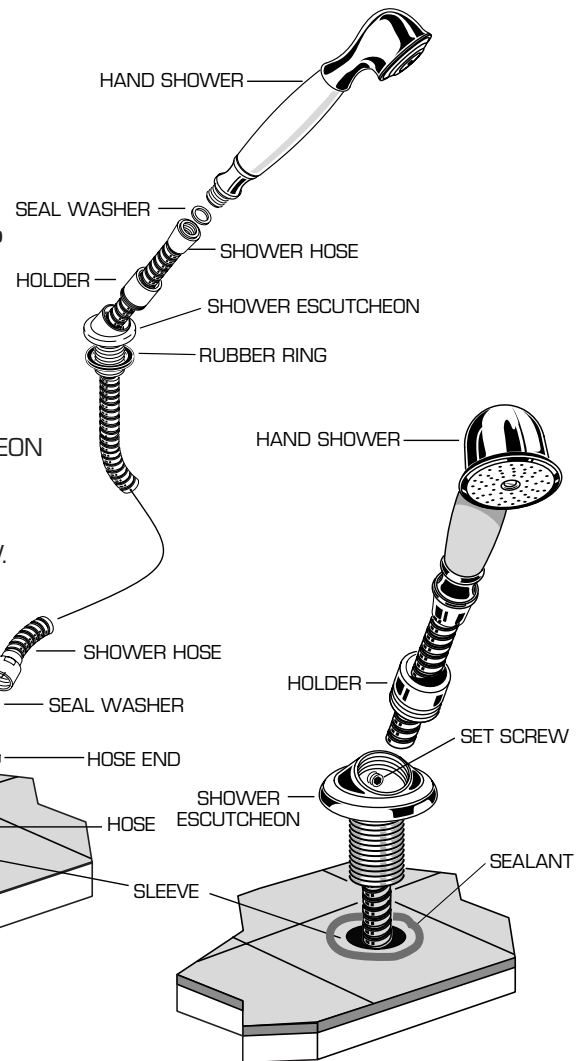

HOTLINE FOR HELP
For toll-free information
and answers
to your questions, call:
1 (800) 442-1902

Weekdays 8:00 a.m. to 7:00 p.m. Eastern Time

IN CANADA 1-800-387-0369 (TORONTO 1-905-306-1093)

Product names listed herein are trademarks of American Standard Inc.
©American Standard Inc. 2000

M968357

American Standard

DECK MOUNT TUB SYSTEMS ROUGH VALVE KIT

Installation Instructions R800 SERIES R810 SERIES

Thank you for selecting American-Standard...
the benchmark of fine quality for over 100 years.

To ensure that your installation proceeds smoothly—please
read these instructions carefully before you begin.

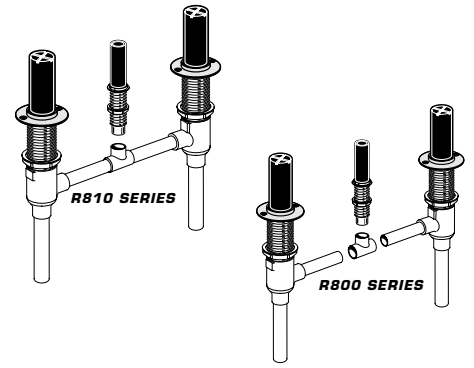

Certified to comply with ANSI A112.18.1
U.S. Patent No. D403,750

M968650C

1 ROUGHING-IN

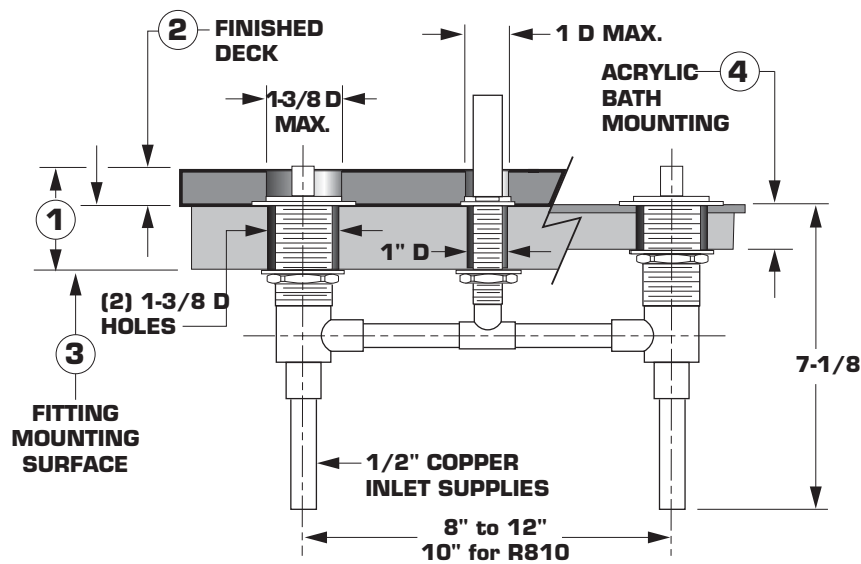

1. DECK THICKNESS

TOTAL DECK THICKNESS UP TO 2-1/2"

2. FINISHED DECK

FINISHED DECK VARIABILITY ACCOMMODATES
DECKING MATERIAL (TILE, MARBLE, CORIAN®...) TO 1" THICK

3. FITTING MOUNTING SURFACE

ADJUSTABILITY, TO 1-1/2" THICK

4. ACRYLIC BATHS

ADJUSTABILITY, TO 1-1/2" THICK

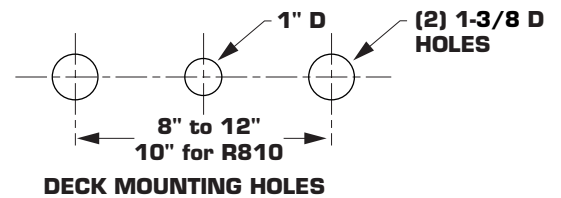

2 MOUNT SPOUT SHANK

- Drill holes in mounting deck as shown. The maximum allowable deck thickness is 1-1/2".
- Insert the SPOUT SHANK through the mounting deck from below. Assemble the SPOUT SHANK LOCK RING so it is flush with the top of the threads on the SHANK.

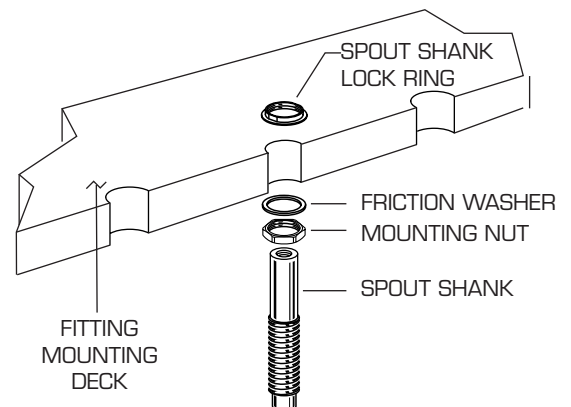
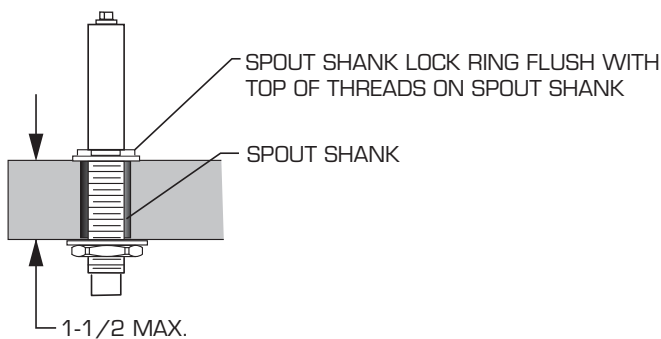

3 MOUNT VALVE BODIES

- Cut the copper outlet tubes of the VALVE BODIES as required. (Not necessary for R810).
- Insert the HOT and COLD VALVE BODIES into the TEE. (Not necessary for R810). The HOT VALVE BODY is marked with a red label.
- Insert the VALVE BODIES and TEE through the mounting deck from below. Assemble the VALVE LOCK RINGS so they are flush with the top of the VALVE BODIES.
- Insert the SPOUT SHANK into the TEE. (Not necessary for R810).
- Tighten the VALVE BODY and SHANK MOUNTING NUTS securely.
- Fasten the VALVE LOCK RING to the wooden mounting surface with #8 screws (not provided).

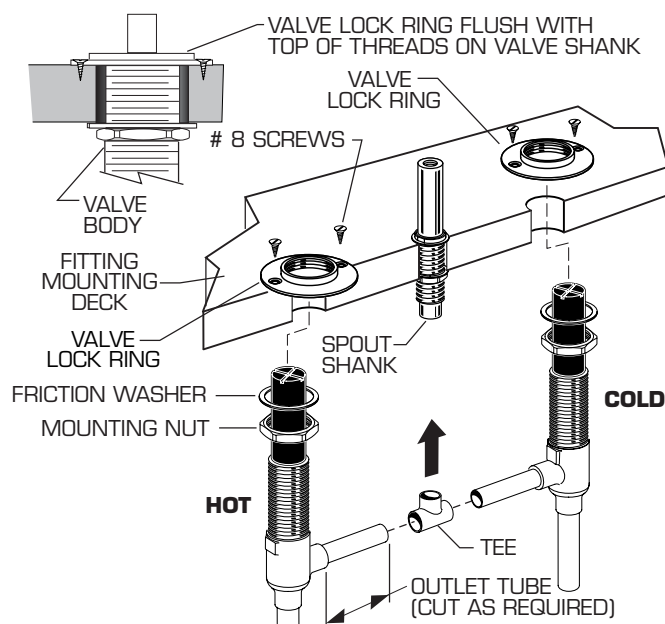

4 SOLDER CONNECTIONS

- Connect the water supply lines to the copper inlet tubes of the VALVE BODY.
- Solder all TEE and WATER SUPPLY CONNECTIONS.
- Remove the GUARD from the SPOUT SHANK. Assemble the 1/4" PLUG to the SPOUT SHANK with a thread sealant.
- Turn on the water supplies and check all connections for leakage.
- Replace the GUARD on the SPOUT SHANK. Turn off the water supplies.

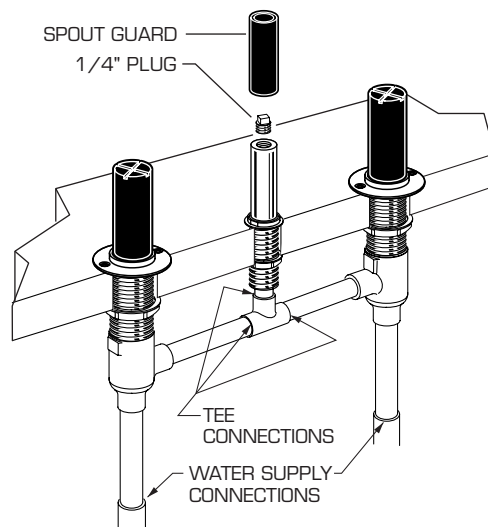

5 SERVICE TO CHANGE THE DIRECTION OF HANDLE ROTATION

- **Turn off the water supplies.**
- Turn HANDLE to the off position.
- Unscrew the VALVE LOCK NUT and remove. A 17mm deep socket is required.
- Remove the CARTRIDGE by pulling upon the SLEEVE.
- Remove the SLEEVE from the CARTRIDGE.
- Remove the SPRING CLIP.
- Remove the STOP WASHER. Turn it 90° and replace.
- Replace the SPRING CLIP.
- Reverse the above steps to reassembly the components.
- If the spout drips, operate the handles several times from the off to the on position. Do not force - the handles only turn 90°

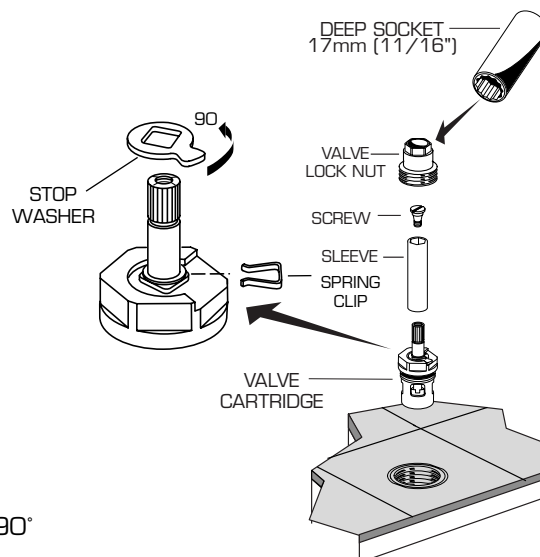

American Standard

DECK MOUNT TUB SYSTEMS

MODEL NUMBERS

R800
R810

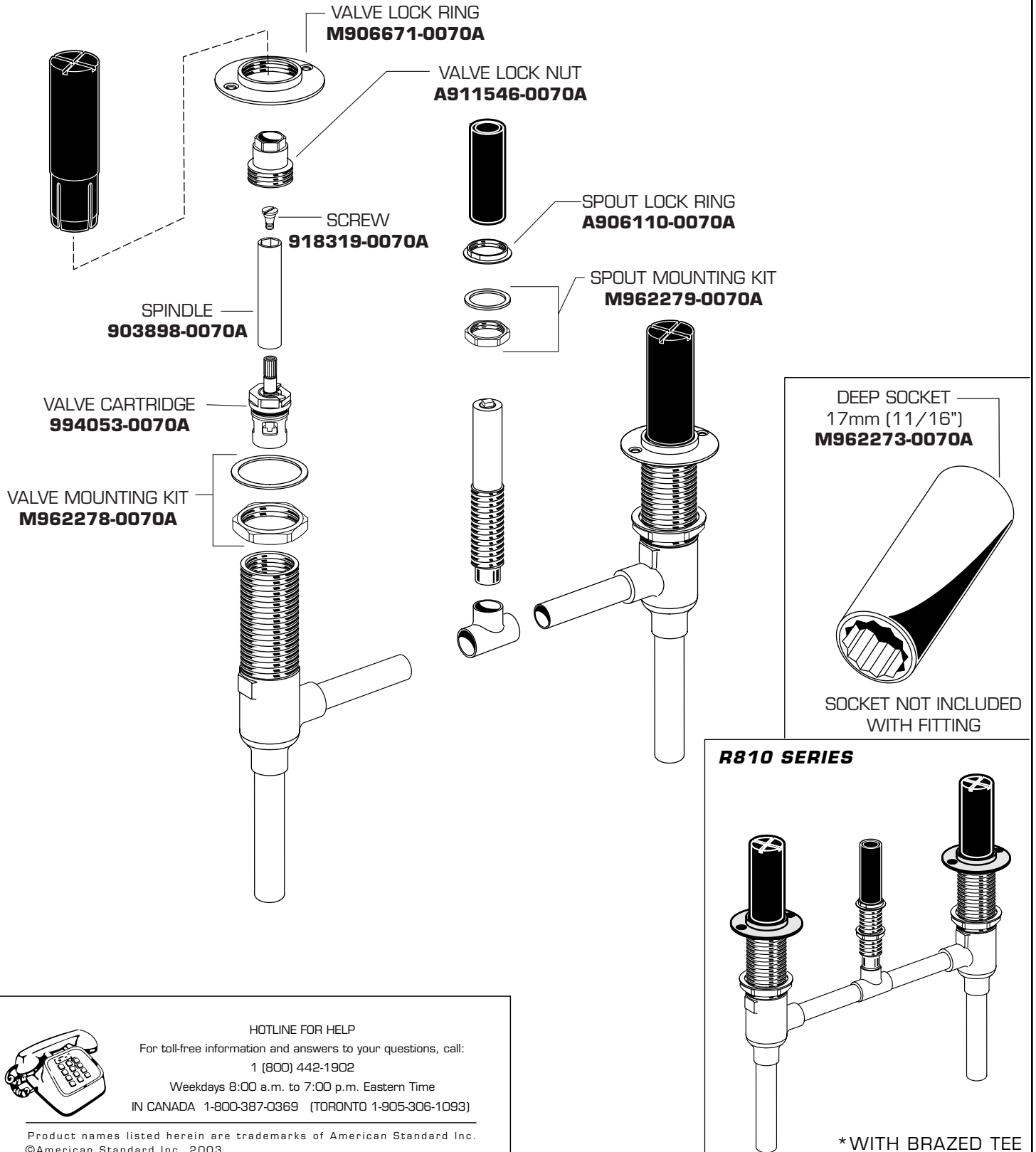

HOTLINE FOR HELP

For toll-free information and answers to your questions, call:

1 (800) 442-1902

Weekdays 8:00 a.m. to 7:00 p.m. Eastern Time

IN CANADA 1-800-387-0369 (TORONTO 1-905-306-1093)

Product names listed herein are trademarks of American Standard Inc.
©American Standard Inc. 2003

American Standard

DECK MOUNT TUB FILLERS

Installation Instructions R890 SERIES

DIVERTER & PERSONAL SHOWER ROUGH VALVE KIT

Thank you for selecting American-Standard...the benchmark of fine quality for over 100 years.

To ensure that your installation proceeds smoothly—please read these instructions carefully before you begin.

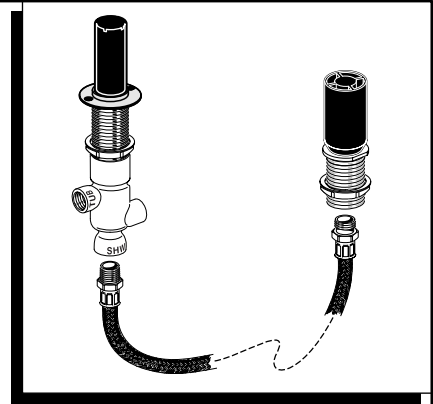

Certified to comply with ANSI A112.18.1

U.S. Patent No. D403,750

M968355D

1 ROUGHING-IN

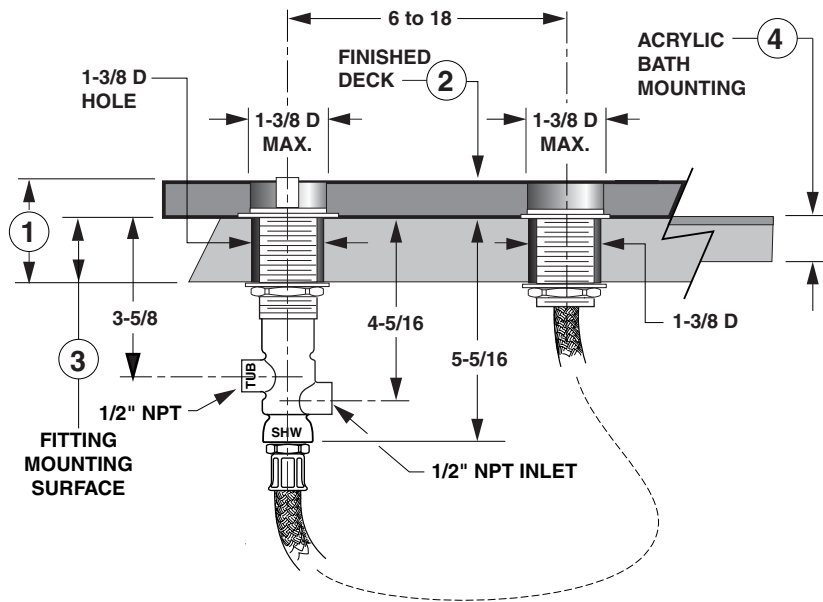

- 1. DECK THICKNESS**
TOTAL DECK THICKNESS UP TO 2-1/2"
- 2. FINISHED DECK**
FINISHED DECK VARIABILITY ACCOMMODATES DECKING MATERIAL (TILE, MARBLE, CORIAN®...) TO 1" THICK
- 3. FITTING MOUNTING SURFACE**
ADJUSTABILITY, TO 1-1/2" THICK
- 4. ACRYLIC BATHS**
ADJUSTABILITY, TO 1-1/2" THICK

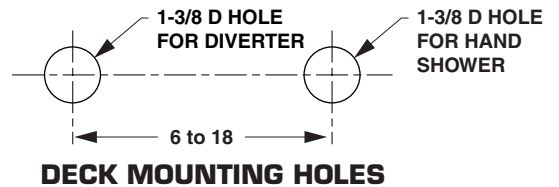

2 LOCATION OF R890 WHEN USED WITH R800

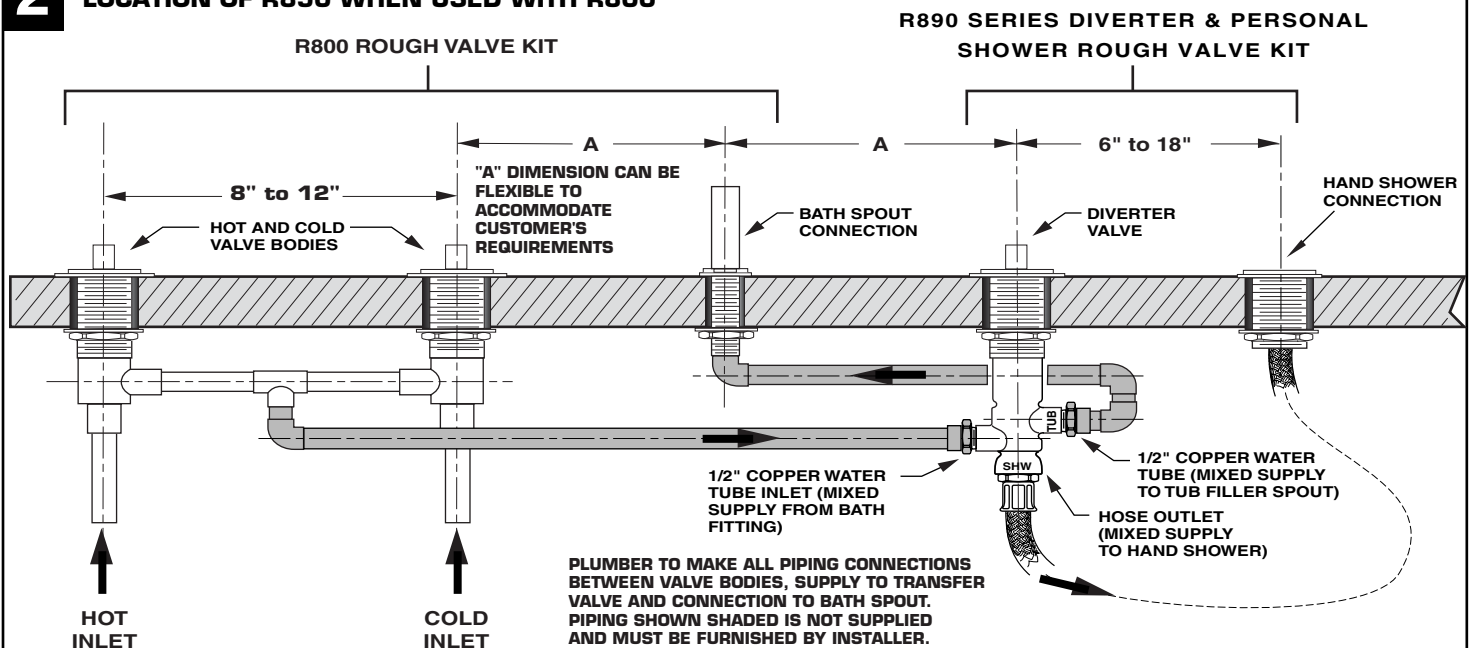

3 INSTALLATION

NOTE: Use thread sealant on all threaded connections.

- Drop the SLEEVE (1) into the hole in the mounting deck.
- Assemble the WASHER (2) and LOCKNUT (3) to the SLEEVE (1) and tighten securely.
- For copper water tube installations, make two 4" long adapter nipples (1/2" Male NPT x 1/2" CWT). Thread nipples into the inlet and tub outlet of the DIVERTER BODY. Tighten connections securely. **Do Not Solder these Connections on the DIVERTER BODY. Damage may occur.**
- Thread HOSE (4) into the SHOWER CONNECTION (5) of the DIVERTER BODY (6) and tighten securely. **Check with local plumbing codes for backflow prevention requirements. Install a backflow prevention device if required.**
- Assemble MOUNTING NUT (7) and WASHER (8) onto DIVERTER BODY (6).
- Insert the DIVERTER BODY (6) through the mounting deck from below. Assemble the VALVE LOCK RING (9) so it is flush with the top of the DIVERTER BODY (6).
- Position the DIVERTER BODY (6) as required and tighten the MOUNTING NUT (7) securely.
- Fasten the VALVE LOCK RING (9) to the wooden mounting surface with #8 screws (not provided).
- Connect the water inlet and tub outlet lines to the DIVERTER BODY (6).

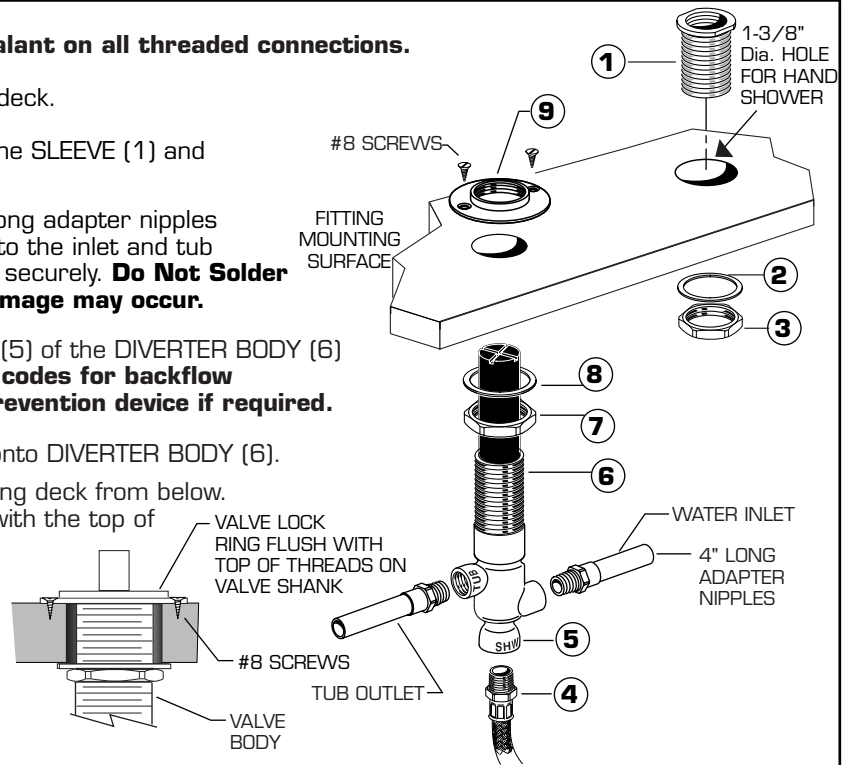

4 TEST *Note: Test Cap not provided.*

- Cap the HOSE OUTLET. Remove the DIVERTER GUARD.
- Remove the SPOUT GUARD. Assemble the 1/4" PLUG to the SPOUT SHANK with a thread sealant. *See the R800 SERIES ROUGH VALVE KIT instructions for details.*
- Turn on the water supplies.
- Rotate the DIVERTER SLEEVE back and forth fully. Check all connections for leakage.
- Turn off the water supplies. Replace the DIVERTER GUARD and the SPOUT GUARD. Remove the CAP from the HOSE OUTLET.

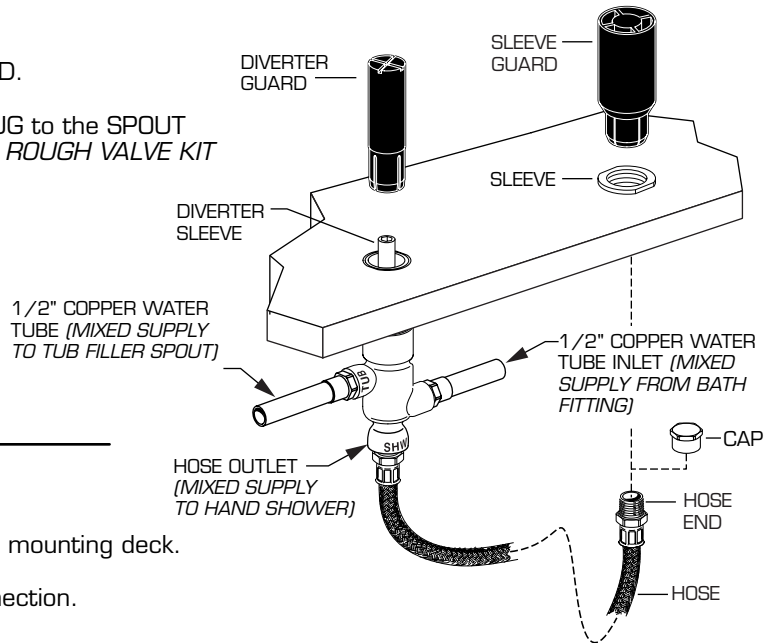

5 HOSE

- Insert the HOSE through the SLEEVE from below the mounting deck.
- Thread the SLEEVE GUARD onto the HOSE END connection.
- Insert the SLEEVE GUARD into the SLEEVE.

6 SERVICE TO REMOVE DIVERTER

- **Turn off the water supplies.**
- Turn HANDLE to the off position.
- Remove the SLEEVE from DIVERTER by loosening screw.
- Using 14mm (9/16") Deep Socket, remove diverter.

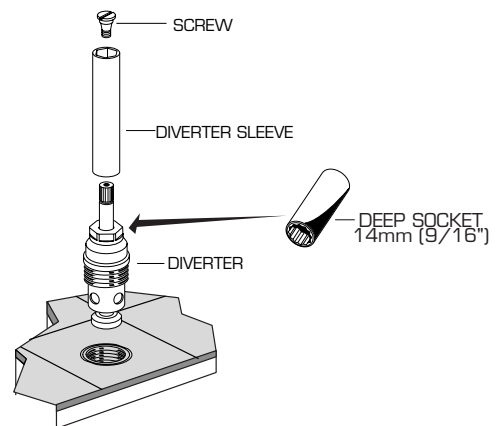

American Standard

**DIVERTER & PERSONAL SHOWER
ROUGH VALVE KIT**

MODEL NUMBER

R890

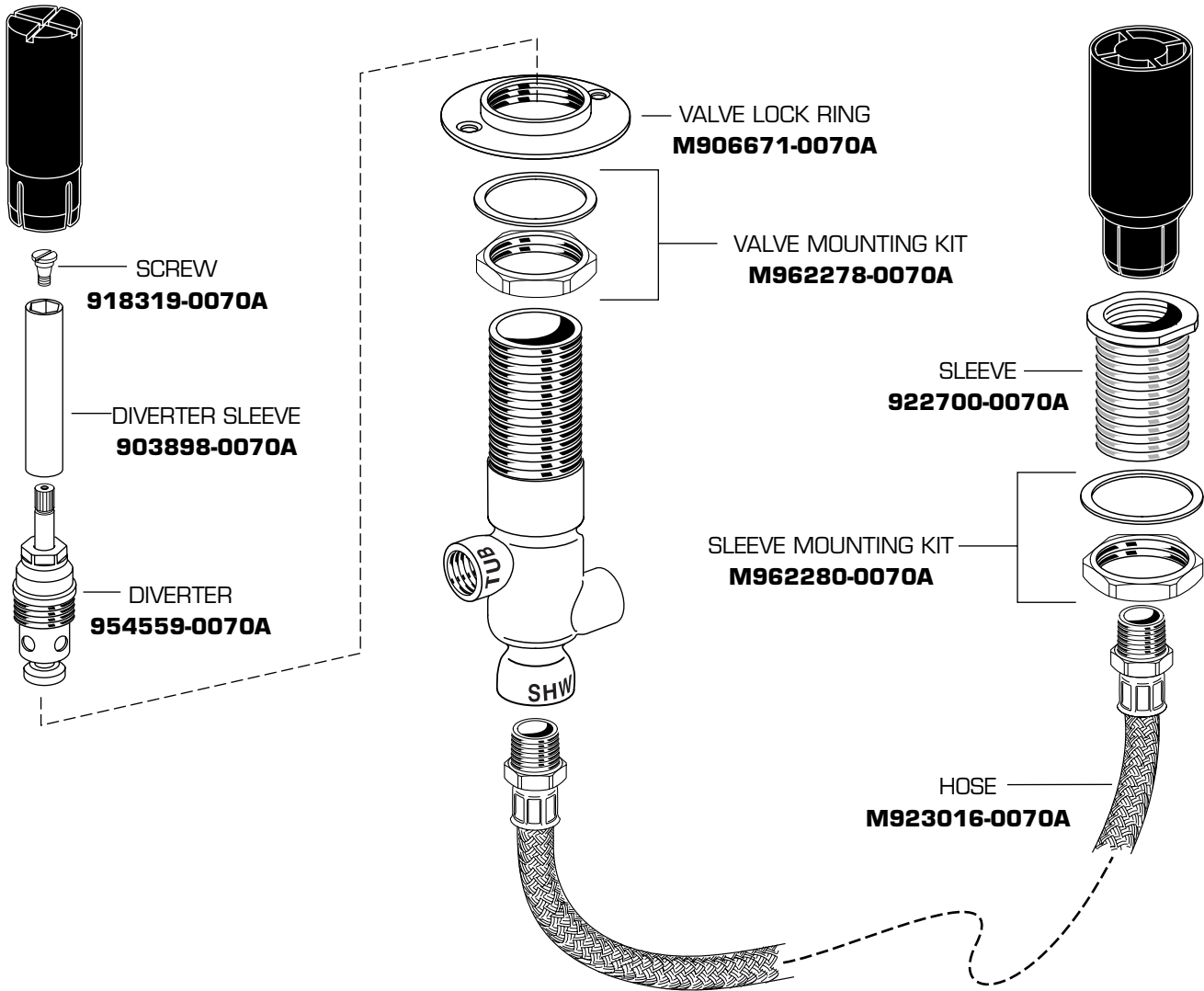

HOT LINE FOR HELP
For toll-free information and answers to your questions, call:
1-800-442-1902
Weekdays 8:00 a.m. to 8:00 p.m. EST
IN CANADA 1-800-387-0369 (TORONTO 1-905-306-1093)
Weekdays 8:00 a.m. to 7:00 p.m. EST
IN MEXICO 01-800-839-12-00
Product names listed herein are trademarks of American Standard Inc.
© American Standard Inc. 2004

