

Fusion Jack 4" Round Dome Canopy

CK001B-FJ- 1.2



GENERAL PRODUCT INFORMATION:



This product is suitable for indoor dry locations only.

This product can be dimmed with a standard incandescent dimmer.

Minimum volume of the electrical box must be 6 cubic inches (98 cubic centimeter).

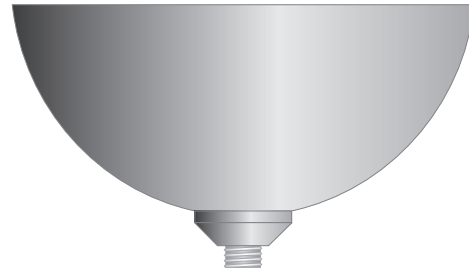

Install the 4" Round Dome Canopy

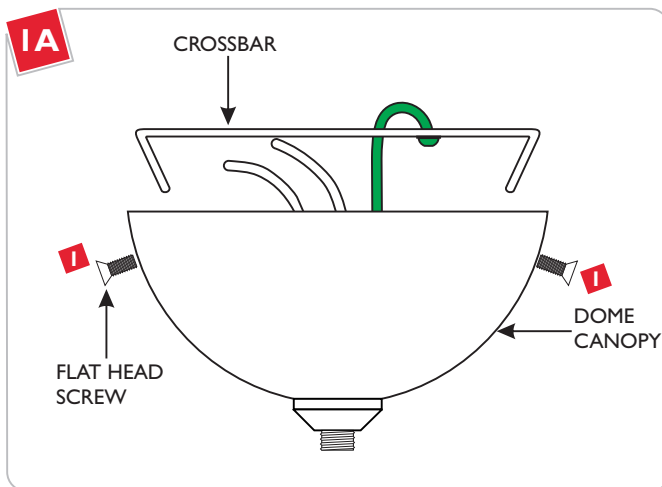

1 Loosen the two flat head screws to remove the crossbar from the dome canopy.

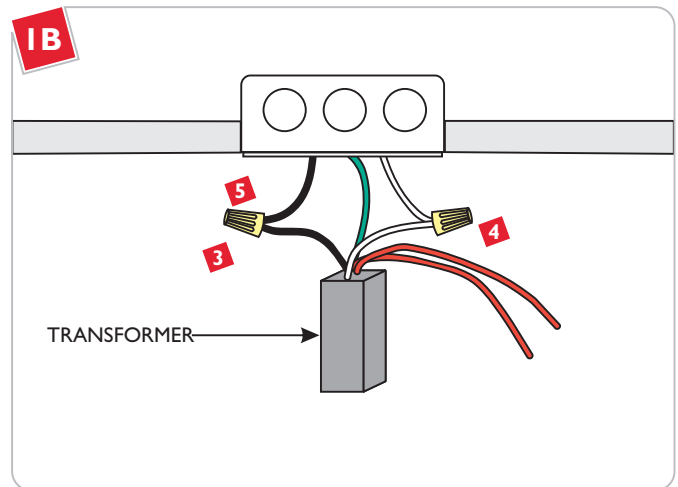

- 2** Turn the power to the electrical box off.
- 3** In accordance with local electrical codes, ground the crossbar and transformer green wire.
- 4** Connect the 120 volt white transformer wire to the neutral power line wire with a wire nut.
- 5** Connect the 120 volt black transformer wire to the hot power line wire with a wire nut.

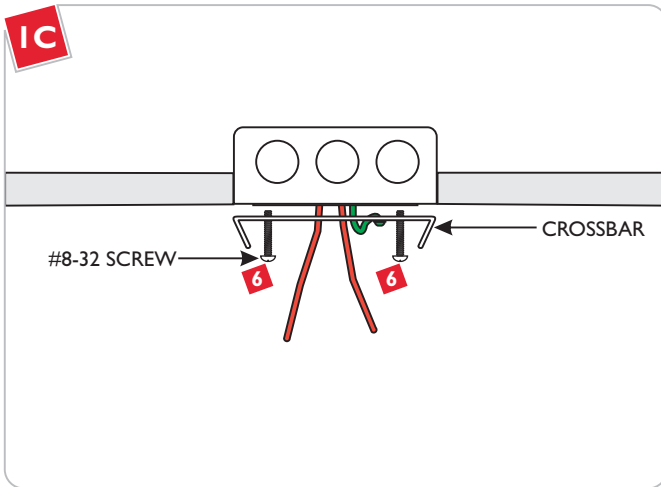

- 6** Mount the crossbar to the electrical box with the two #8-32 screws.

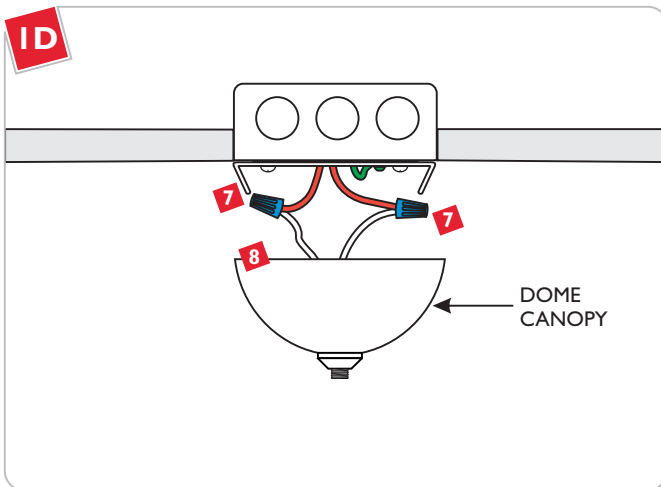

- 7** Connect each canopy wire to one transformer low voltage wire with a wire nut.
- 8** Place all wire and wire nut connection properly inside the dome canopy.

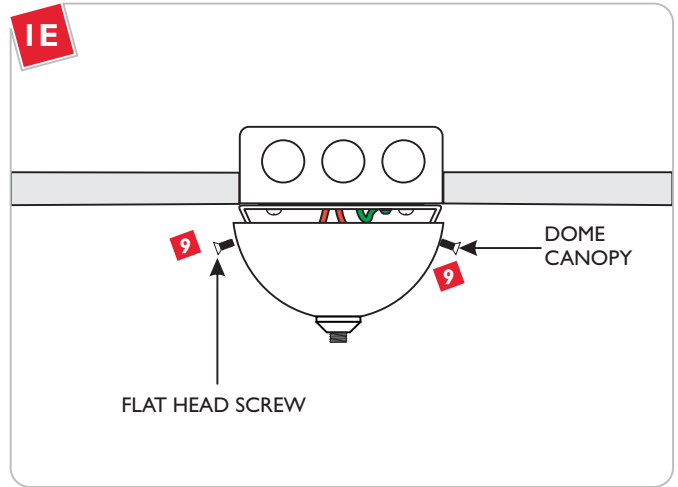

- 9** Line up the dome canopy holes with the crossbar holes. Replace and tighten the flat head screws to secure the dome canopy in place.

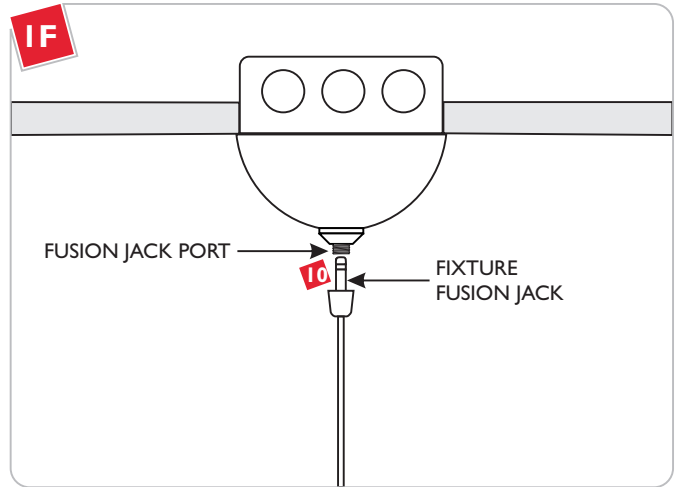

- 10** Screw the fixture Fusion Jack into the Fusion Jack port.
- 11** Turn the power on.

SAVE THESE INSTRUCTIONS!



7400 Linder Ave, Skokie, IL 60077

800.323.3226 - 847.626.6300

www.lblighting.com

© 2008 LBL Lighting. All rights reserved. The "LBL Lighting" graphic is a registered trademark of LBL Lighting. LBL Lighting reserves the right to change specifications for product improvements without notification.

A Generation Brands Company