

<b>CATALOG NUMBER</b>	<b>TYPE</b>
<b>PROJECT</b>	

**LINEAR SYSTEM – HALOGEN TRACK FIXTURE**

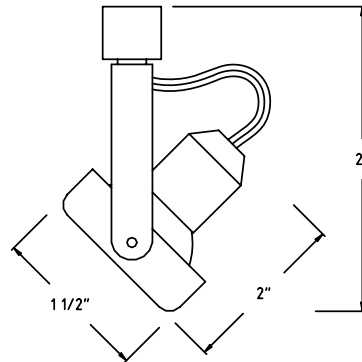



**MODEL SF-211**



<b>Ordering Matrix</b>			
Model	Series	Finish	Accessories
[ ]	[ ]	[ ]	
SF	211	BK      WT	See table below

Ordering Example (model – series – finish + optional accessory): SF-211-WT

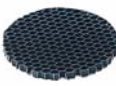
<b>Product Details</b>	<b>Specification Features</b>
<p><b>Description:</b> Low voltage track head utilizing precise MR11 lamps. Specifically designed small sized fixture for use with the W.A.C. Linear System.</p> <p><b>Materials:</b> All metal track head with polycarbonate track adaptor. Bi-pin ceramic socket with 18 gauge Teflon insulated wires and fiberglass sleeves. Clear glass lens. Spring tension ring to retain lens.</p> <p><b>Aiming:</b> 350° horizontal rotation and 90° vertical aiming. Yoke style aiming allows easy and fine adjustment to the desired angle. The aiming screw may be tightened to firmly hold vertical aiming angle.</p> <p><b>Lamping:</b> MR11 lamp, 35w max. The SF-211 is suitable for 12v or 24v lamps. Lamps sold separately.</p> <p><b>Finish:</b> Abrasion resistant Black (BK) or White (WT) paint finish.</p> <p><b>Listing:</b> UL &amp; CUL Listed. 2 year W.A.C. Lighting product warranty.</p>	<ul style="list-style-type: none"> <li>The supplied clear glass lens can be replaced with one lens accessory such as a colored dichroic lens, UV filter lens, etc.</li> <li>Can use 12 volt or 24 volt lamps, dependant on Linear System transformer. Transformer and Linear System track is ordered separately.</li> </ul>

<b>Accessory Lenses (ordered separately):</b>			
LENS-11-UVF UV Filter Lens 	LENS-11-COLOR Colored Lenses AMB = Amber BLU = Blue GRN = Green RED = Red YEL = Yellow 	LENS-11-DIC-COLOR Dichroic Lenses AMB = Amber BLU = Blue GRN = Green RED = Red YEL = Yellow 	
LENS-11-HCL Honeycomb Louver 	LENS-11-SPR Spread Lens 	LENS-11-BEL Beam Elongating Lens 