

# FLUIDMASTER® 7500 WAX-FREE™ TOILET BOWL GASKET KIT INSTALLATION INSTRUCTIONS

**NOTE:** If you find the bowl gasket and sleeve have snapped together during shipping, separate them by twisting the pieces in opposite directions and pulling apart as shown:

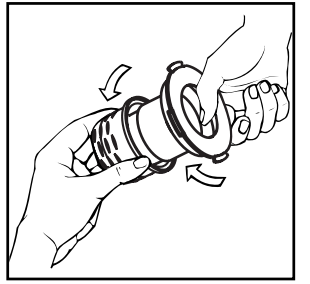

## 1. TOILET BOWL & FLOOR FLANGE PREPARATION:

Turn off water supply. Flush toilet to drain toilet tank and bowl. Sponge remaining water until both tank and bowl are dry.

Disconnect water supply connector at toilet tank.

Carefully remove tank from bowl. Next, remove bowl from floor. Gently lay bowl on its side. Typically a wax ring seals the bottom of the bowl to the flange. You may need to gently rock the bowl to break this seal.

Using a putty knife, remove old wax from floor flange and bottom of bowl. If re-installing old toilet, remove old bolts. Clean bowl horn and floor flange with stiff wire brush.

Place a rag in the hole to block sewer gas odor. Temporarily cover the floor flange and rag with a bucket until you are ready to begin installation of new bowl gasket.

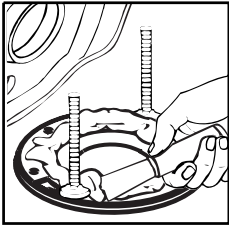

NOTE: SAVE INSTRUCTION SHEET FOR FUTURE REFERENCE.

TOOLS NEEDED FOR INSTALLATION: Putty knife, pliers or adjustable wrench, hacksaw, wire brush, bucket, sponge and rag.

CONTENTS: 1 Bowl Gasket, 1 Sleeve, 3 O-Rings (2 thin, 1 thick), 1 Cardboard Spacer, 2 Bolts, 2 Retainer Washers, 2 Brass Washers, 2 Acorn Nuts.

DO NOT LUBRICATE THE O-RINGS.

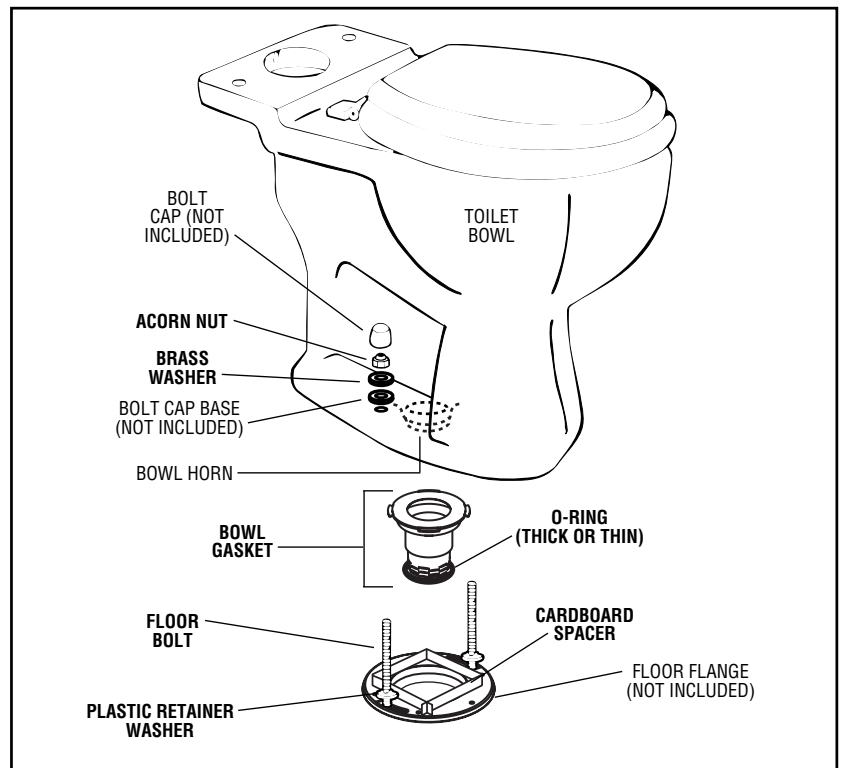

## 2. DETERMINE DRAIN PIPE SIZE & PARTS NEEDED:

Remove the rag you may have placed earlier in the drain pipe hole. Determine if you have a 3" or 4" drain pipe as follows: Place the 4" sleeve into the drain. If it fits with clearance, you have a 4" drain pipe. **If it does not fit or fits tight, you have a 3" drain pipe** – OR – Use the template located on the bottom of the box to measure the drain pipe

SELECT THE RIGHT PARTS FOR YOUR DRAIN PIPE SIZE (3" OR 4") BELOW:

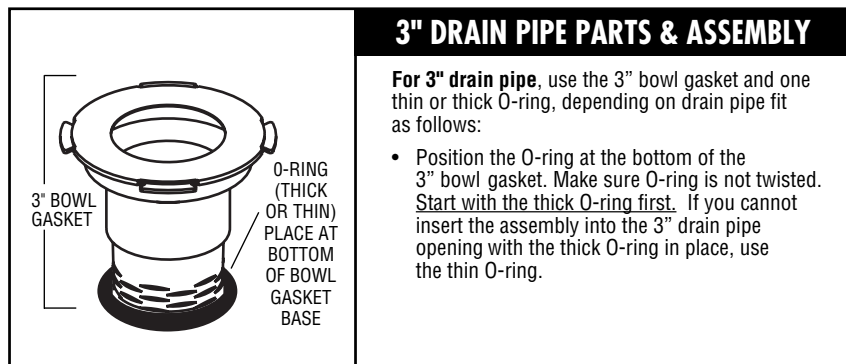

– OR –

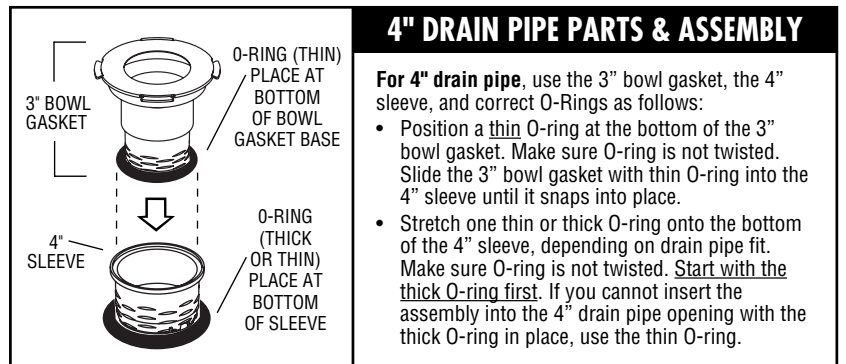

## 3. INSTALL BOWL GASKET AND TOILET:

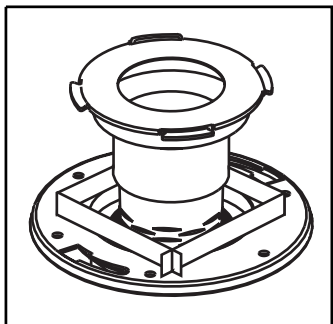

**A.** Slightly insert the bowl gasket assembly into the drain pipe. Before completely installing, wrap the cardboard spacer around the bowl gasket and secure at the two cut corners.

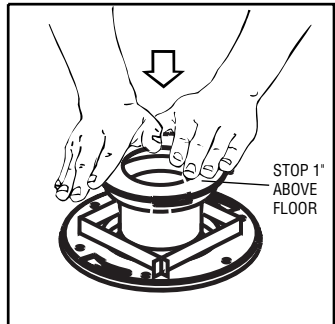

**B.** Slowly and evenly push the bowl gasket assembly downward into the pipe until it is **POSITIONED 1" ABOVE THE FLOOR SURFACE** (It may or may not touch the spacer depending on your floor and floor flange. This will allow the bowl horn to contact the rubber opening of the bowl gasket before the bowl touches the floor.) The O-ring should roll into the drain pipe and will move up the bowl gasket assembly as needed to create a tight seal. The cardboard spacer is designed to collapse and remain in place once the toilet is installed. It will not interfere with the seal of the bowl gasket.

**CAUTION:** If floor flange is above the floor and toilet rocks after installation, you may need to call a professional to correct this condition before installing the Bowl Gasket. SEE TROUBLESHOOTING.

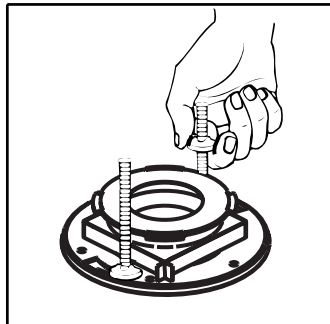

**C.** Connect floor bolts to floor flange by inserting floor bolts, head down, into mounting adjustment slots on floor flange. Slide plastic retainer washers down the threads to hold bolts in place.

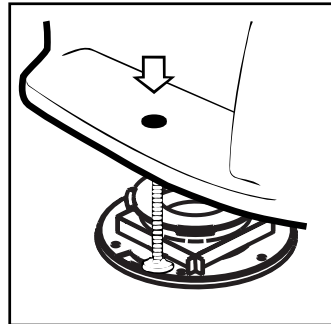

**D.** Line up holes in toilet base with floor bolts in floor flange. This will line up the top of the bowl gasket with the horn on the bottom of the toilet bowl. Lower toilet. Apply weight to get toilet to rest on the floor.

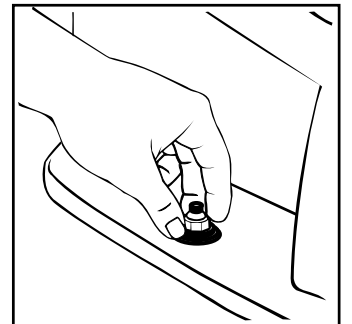

**E.** Place bolt cap base (not included), brass washer, then acorn nut on bolt. Tighten just enough to prevent movement of the toilet bowl. **DO NOT OVERTIGHTEN** or bowl may crack. If floor bolts are too long to allow the bolt caps to fit, carefully cut the floor bolts with hacksaw to correct length. Install bolt caps (not included). Reconnect tank to bowl. Reconnect water supply connector to tank fill valve. Turn on water supply.

### To remove Fluidmaster Bowl Gasket:

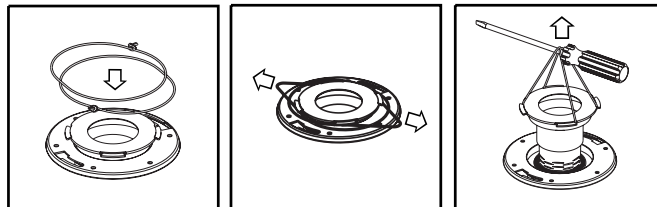

1. Make two loops of string and place the loops between the floor flange and the bowl gasket.
2. Pull the string loops outward in opposite directions.
3. Pull the string loops upward toward the center making sure they rest between hooks on the bowl gasket. Insert screwdriver as shown and pull upward to remove bowl gasket from drain pipe.

### TROUBLESHOOTING

If toilet rocks after installing, it may be:

- A. Floor flange is too high above the floor.
  - The floor flange needs to be lowered or floor raised to correct this condition.
- B. Bowl Gasket is not completely inserted in the drain pipe.
  - Pipe rust may be obstructing Bowl Gasket.
  - The drain pipe is offset. Bowl Gasket will not work with this condition.
  - The drain pipe makes 90 degree turn so that Bowl Gasket bottoms out.
- C. Floor bolts are not secured properly.
- D. Uneven floor. May require shims.

**GUARANTEE:** This Fluidmaster product is guaranteed to be free from defective materials and workmanship for a period of ten years. Units returned to Fluidmaster, California, will be replaced without charge.

Always use quality Fluidmaster repair parts when maintaining your Fluidmaster products. Fluidmaster shall not be responsible or liable for any damages caused by parts used in Fluidmaster products that were not manufactured by Fluidmaster, Inc.

**Fluidmaster Inc.**

30800 Rancho Viejo Road  
San Juan Capistrano, CA 92675  
(800) 631-2011 or (949) 728-2000  
www.fluidmaster.com