

Installation Instructions / Warranty

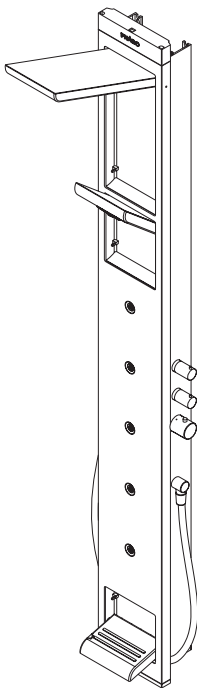

Pharo Skyline
26017XX1

hansgrohe

Pharo Skyline Showerpanel 26017XX1

Technical Information

Recommended water pressure	14.7 - 72.5 psi
Minimum water pressure	29 psi
Max. water pressure	147 psi
Recommended hot water temp.	120° - 140° F*
Max. hot water temp	165°F*
Max. flow rate:	
showerhead	2.5 gpm
handshower	2.5 gpm
neck spray	2.5 gpm
bodysprays	0.72 gpm each

- Thermostatic temperature control
- The high temperature limit stop on the thermostatic mixing valve may be reset to comply with local plumbing codes.
- Protection against back siphonage provided by check valves. The check valves should be removed and inspected yearly.
- This panel may be used with an instantaneous water heater if the heater is at least 24 kW and the output is at least 3 gpm @ 30 psi pressure. However, only one panel function may be used at a time.

*Please know and follow all applicable local plumbing codes when setting the temperature on the water heater. In Massachusetts, the water heater may be set no higher than 112°F.

Installation Considerations

- For best results, Hansgrohe recommends that this unit be installed by a licensed, professional plumber.
- Please read over these instructions thoroughly before beginning installation. Make sure that you have all tools and supplies needed to complete the installation.
- A minimum of two people is required to install this panel. Do not attempt to install this panel alone as injury or damage to the panel may result. 

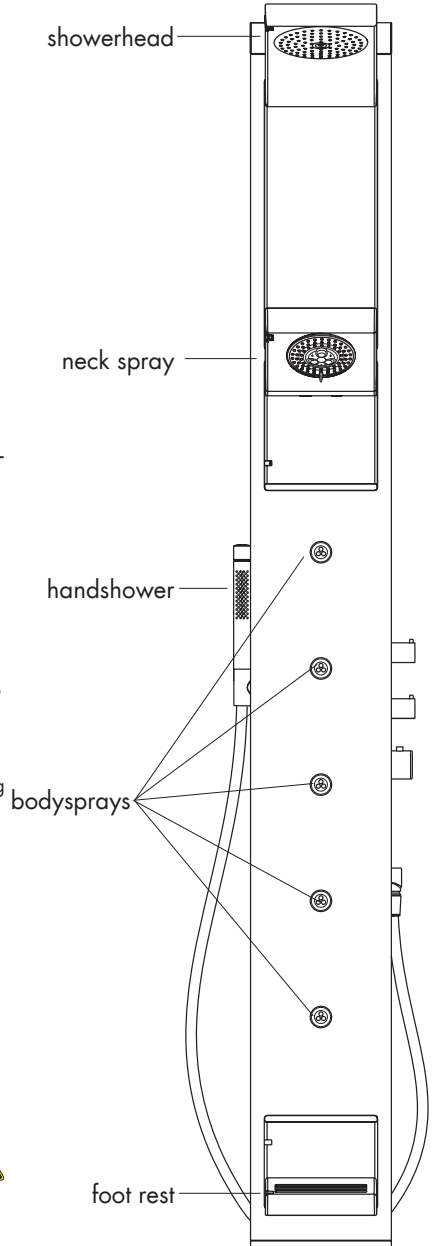

Suggested installation

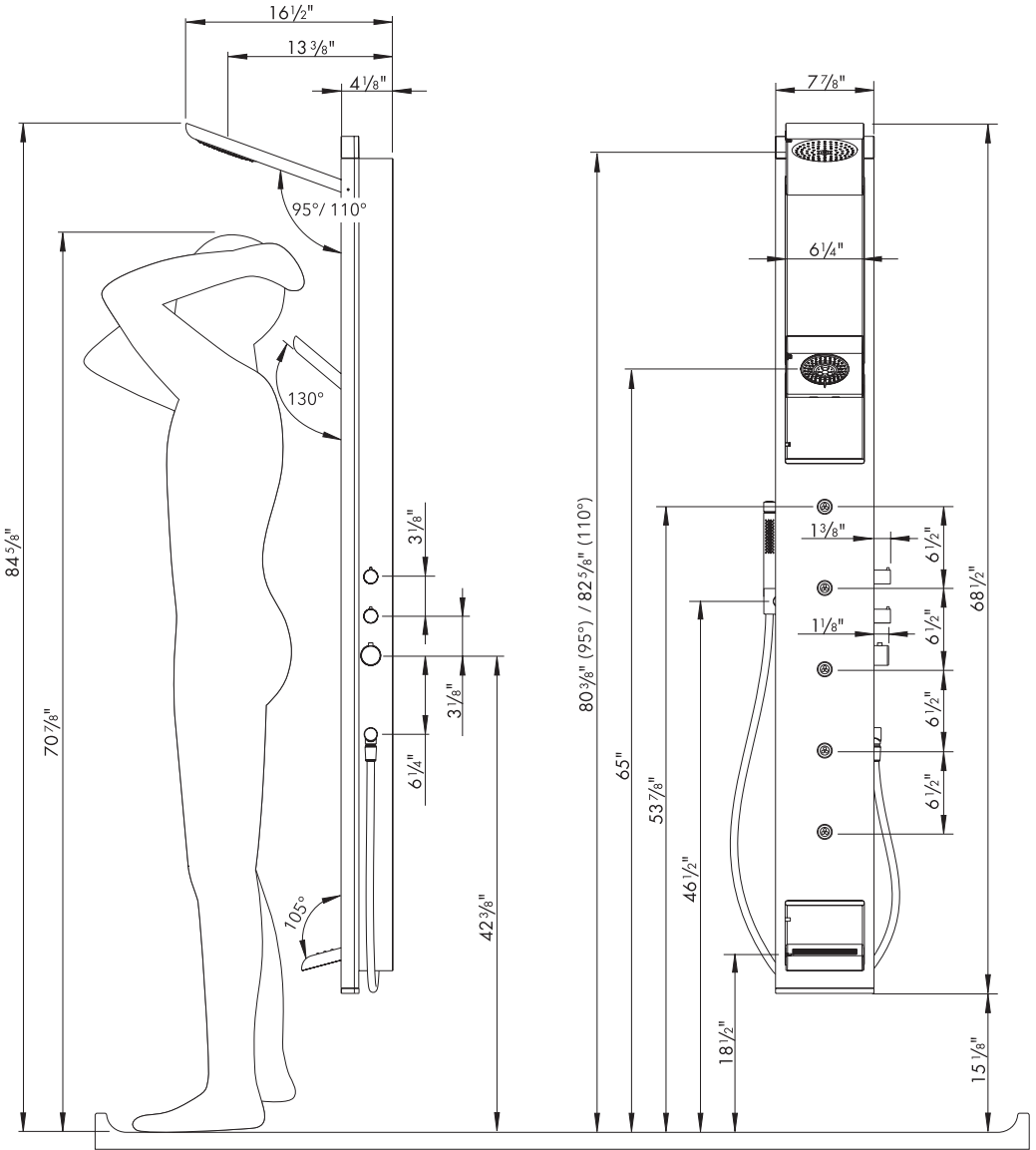

Minimum ceiling height – $86\frac{5}{8}"$

Package Contents

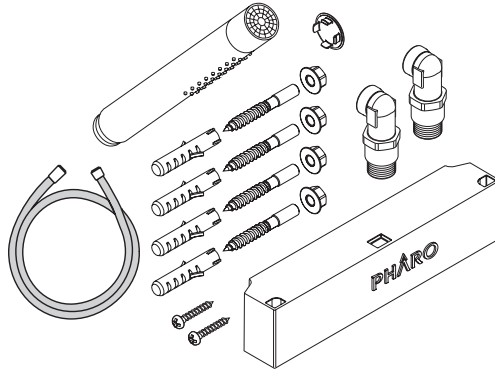

Please check the package contents before beginning installation. If parts are missing or are not in good condition, please contact Hansgrohe Technical Service.

Rough-in

- Install 1/2" NPT male nipples at the positions shown on the rough-in diagram for the hot and cold water supplies.
- The nipples should extend 5/8" outside the surface of the finished wall.
- Install the finished wall surface. Make the wall watertight.
- The showerpanel will hang on the finished wall.
- The measurements shown on page 5 are for the suggested installation shown on page 3, which is ideal for users of approximately 5'11" in height. The minimum ceiling height for this installation is 86 5/8".
- The panel height may be increased if desired. The measurements shown on page 5 must be increased accordingly, including the minimum ceiling height.
- Thoroughly flush the hot and cold water supplies before installing the showerpanel.

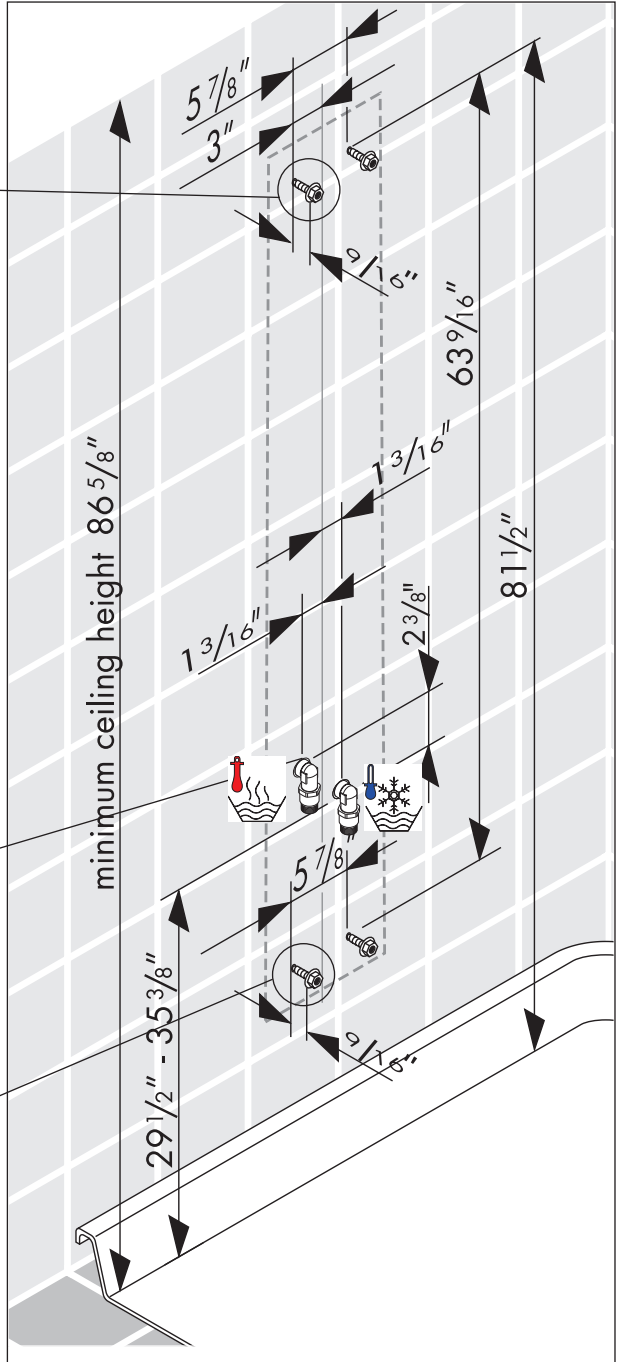
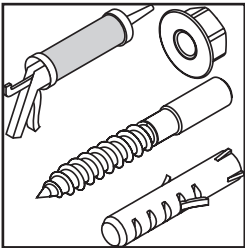
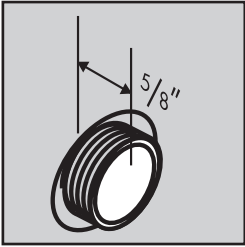
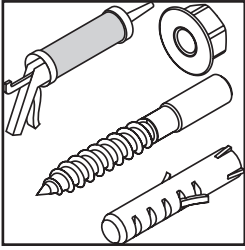

Installation

Wrap the threads on the nipples with Teflon tape.

Install the elbows. The elbow outlets should face downward.



Seal the wall around the elbows with waterproof sealant.



Failure to seal the wall can lead to possible water damage.

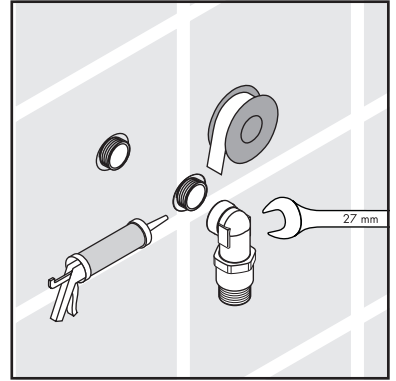

Drill the holes for the mounting screws with an 8 mm bit.



Do not drill into water lines!

Install the anchors.



Seal the wall around the anchors with waterproof sealant.



Failure to seal the wall can lead to possible water damage.

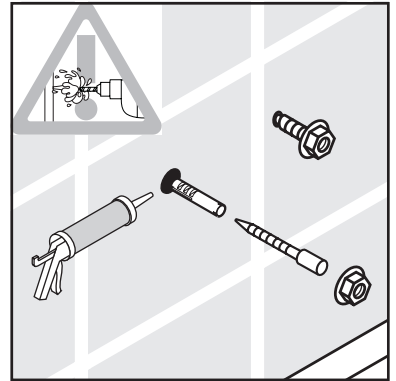

Install the screws. Install the nuts. There should be 9/16" between the rear of the nut and the surface of the wall.

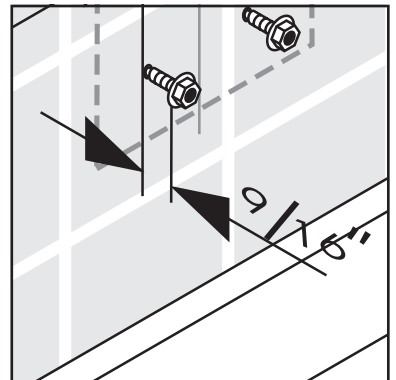

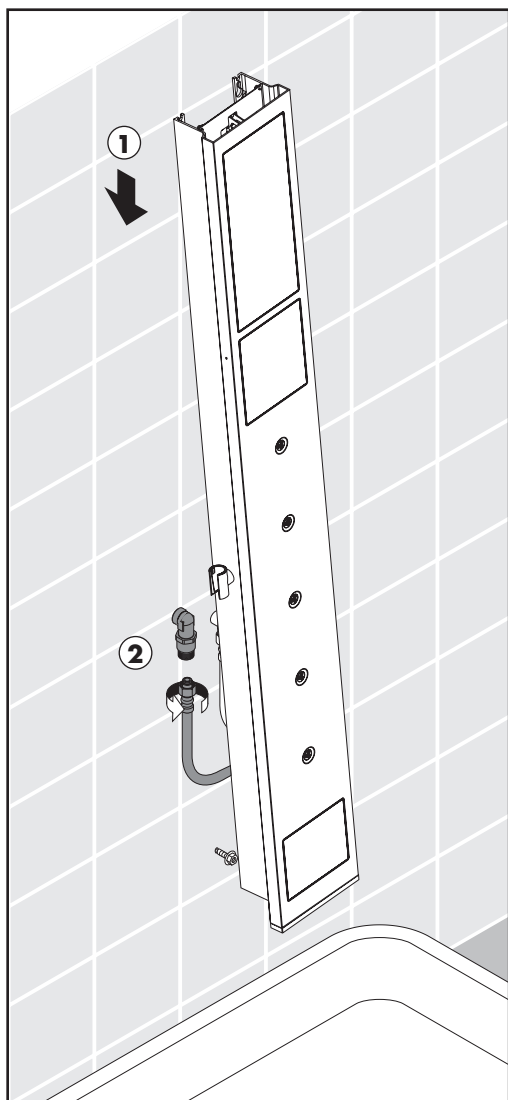

Hang the panel over the top screws only (1).

With a partner holding the panel out of the way, install the panel supply hoses on the elbows. Tighten the hose nuts. (2)

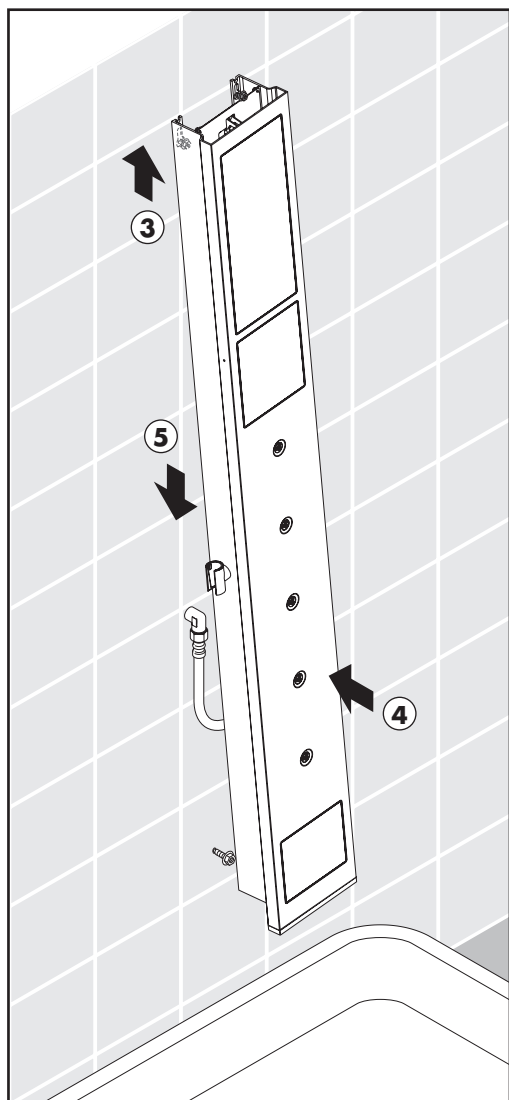

Raise the panel (3). Push the bottom of the panel over the bottom screws (4). Lower the panel (5) so that the screws are in the narrow parts of the keyways.

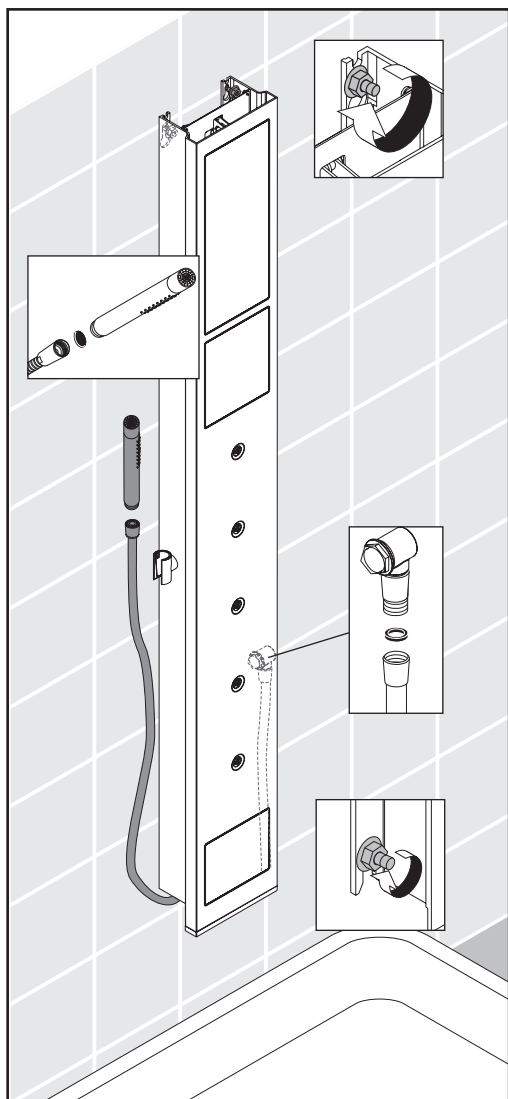

Tighten the nuts using a 10 mm wrench.

Place a black rubber hose washer in one end of the handshower hose. Install this end of the hose on the handshower outlet.

Place the screen washer in the other end of the hose. Connect this end of the hose to the handshower.

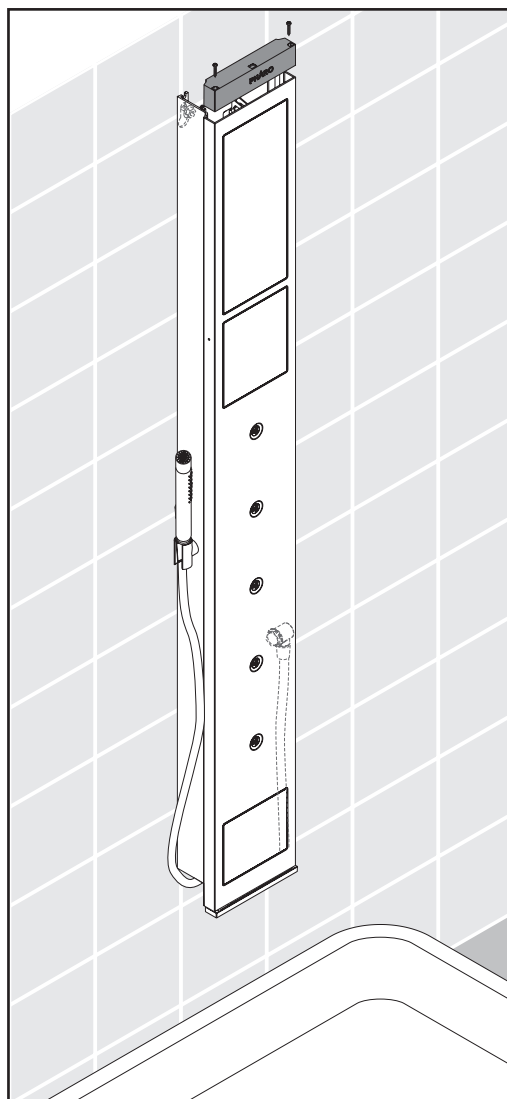

Place the handshower in the holder.

Install the top cover.

Reset the High Temperature Limit Stop

(Optional – if required by local code)

Remove the thermostatic mixer handle and safety set.

Remove the clip and stop ring from the thermostatic mixer stem.

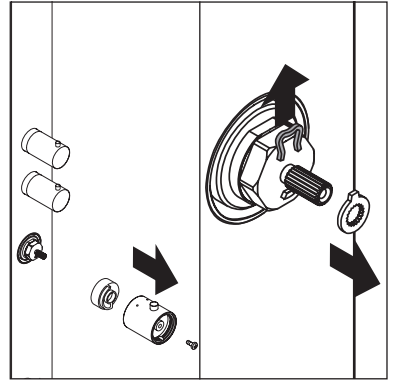

Turn the water on to the handshower. Turn the stem until the output water is the desired maximum high temperature – usually 110°F - 112°F.

Turn the water off.

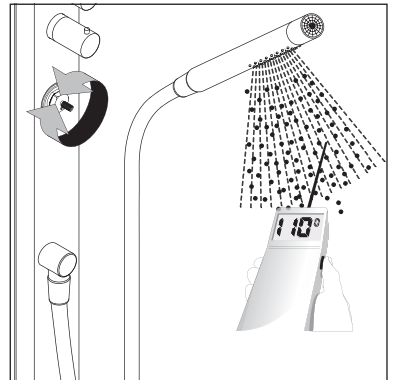

Reinstall the stop ring so that the tooth is against the stop. Reinstall the clip.

Justify and install the handle.

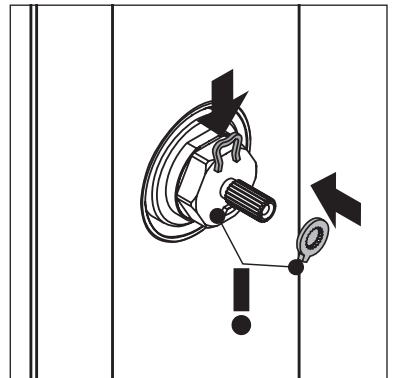

Justify the handle

Turn the water on to the handshower.

Turn the thermostatic mixer handle until the output water is 100°F.

Turn the water off.

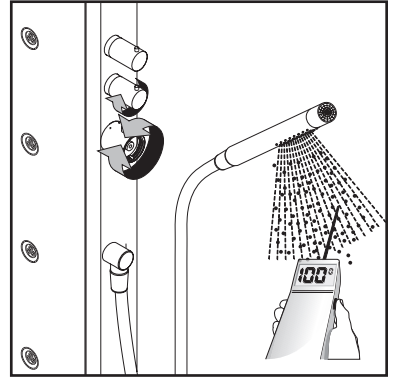

Remove the thermostatic mixer handle and safety set.

Reinstall the safety set so that the notch is at the 12:00 position.

Reinstall the handle with the safety stop override button at the 12:00 position.

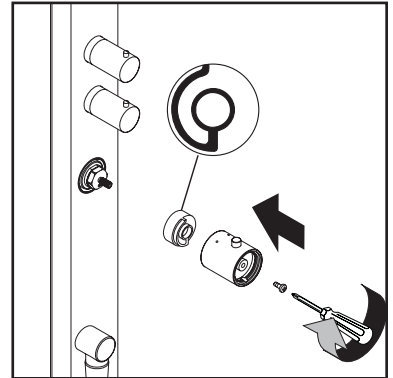

Tighten the screw fully, then loosen it 1/4 - 1/2 turn.

Install the screw cover.

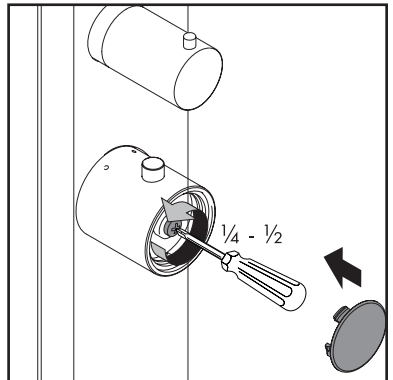

Troubleshooting

Problem	Possible cause	Solution
Outputs both hot and cold water, but no mix	Supply lines connected to the incorrect elbows	Reconnect supply lines to correct elbows
Insufficient water	Filters inside supply elbows clogged	Remove and clean filters
Erratic water temperature	Thermostatic mixer cartridge faulty	Replace thermostat cartridge
Function drips, won't shut off completely	Volume control cartridge faulty	Replace volume control cartridge
Hot water bleeds over into cold water supply in house or vice-versa	Faulty check valve	Remove and clean check valve, replace if necessary

Limited Lifetime Consumer Warranty

This product has been manufactured and tested to the highest quality standards by Hansgrohe, Inc. ("Hansgrohe"). This warranty is limited to Hansgrohe products which are purchased by a consumer in the United States after March 1, 1996, and installed in either the United States or Canada.

WHO IS COVERED BY THE WARRANTY

This warranty extends to the original consumer purchaser only. This warranty is non-transferable.

WHAT IS COVERED BY THE WARRANTY

This warranty covers only your Hansgrohe manufactured product. Hansgrohe warrants this product against defects in material or workmanship as follows: Hansgrohe will repair at no charge for parts only or, at its option, replace any product or part of the product that proves defective because of improper workmanship and/or material, under normal installation, use, service and maintenance. If Hansgrohe is unable to provide a replacement and repair is not practical or cannot be timely made, Hansgrohe may elect to refund the purchase price in exchange for the return of the product.

LENGTH OF WARRANTY

Replacement or repaired parts of products will be covered for the term of this warranty as stated in the following two sentences. If you are a consumer who purchased the product for use primarily for personal, family, or household purposes, this warranty extends for as long as you own the product and the home in which the product is originally installed. If you purchased the product for use primarily for any other purpose, including, without limitation, a commercial purpose, this warranty extends only (i) for 1 year, with respect to Hansgrohe and Commercial products, and (ii) for 5 years, with respect to AXOR products.

THIS WARRANTY DOES NOT COVER, AND HANSGROHE WILL NOT PAY FOR:

- A. Conditions, malfunctions or damage not resulting from defects in material or workmanship.
- B. Conditions, malfunctions or damage resulting from (1) normal wear and tear, improper installation, improper maintenance, misuse, abuse, negligence, accident or alteration, or (2) the use of abrasive or caustic cleaning agents or "no-rinse" cleaning products, or the use of the product in any manner contrary to the product instructions. (3) Conditions in the home such as excessive water pressure or corrosion.

- C. Labor or other expenses for the disconnection, deinstallation, or return of the product for warranty service, or for installation or reinstallation of the product (including but not limited to proper packaging and shipping costs), or for installation or reinstallation of the product.
- D. Accessories, connected materials and products, or related products not manufactured by Hansgrohe.

TO OBTAIN WARRANTY PARTS OR INFORMATION

Contact your Hansgrohe retailer, or contact Technical Service at:

Hansgrohe Inc.
1492 Bluegrass Lakes Parkway
Alpharetta GA 30004
Toll-free (800) 334-0455.

In requesting warranty service, you will need to provide

1. The sales receipt or other evidence of the date and place of purchase.
2. A description of the problem.
3. Delivery of the product or the defective part, postage prepaid and carefully packed and insured, to Hansgrohe Inc. 1492 Bluegrass Lakes Parkway, Alpharetta, Georgia 30004, Attention: Technical Service, if required by Hansgrohe.

When warranty service is completed, any repaired or replacement product or part will be returned to you postage prepaid.

EXCLUSIONS AND LIMITATIONS

REPAIR OR REPLACEMENT (OR, IN LIMITED CIRCUMSTANCES, REFUND OF THE PURCHASE PRICE) AS PROVIDED UNDER THIS WARRANTY IS THE EXCLUSIVE REMEDY OF THE PURCHASER. HANSGROHE NEITHER ASSUMES NOR AUTHORIZES ANY PERSON TO CREATE FOR IT ANY OBLIGATION OR LIABILITY IN CONNECTION WITH THIS PRODUCT.

HANSGROHE SHALL NOT BE LIABLE TO PURCHASER OR ANY PERSON FOR ANY INCIDENTAL, SPECIAL, OR CONSEQUENTIAL DAMAGES, ARISING OUT OF BREACH OF THIS WARRANTY OR ANY IMPLIED WARRANTY (INCLUDING MERCHANTABILITY).

Some States do not allow the exclusion or limitation of incidental or consequential damages, so the above limitation or exclusion may not apply to you. This warranty gives you specific legal rights, and you may have other rights which vary from State to State. You may be required by law to give us a reasonable opportunity to correct or cure any failure to comply before you can bring any action in court against us under the Magnuson-Moss Warranty Act.

PRODUCT INSTRUCTIONS AND QUESTIONS

Upon purchase or prior to installation, please carefully inspect your Hansgrohe product for any damage or visible defect. Prior to installing, always carefully study the enclosed instructions on the proper installation and the care and maintenance of the product. If you have questions at any time about the use, installation, or performance of your Hansgrohe product, or this warranty, please call or write to us or call us toll-free at 800 334 0455.

hansgrohe

Hansgrohe, Inc. • 1490 Bluegrass Lakes Parkway • Alpharetta, GA 30004
Tel. 770-360-9880 • Fax 770-360-9887

www.hansgrohe-usa.com

User Instructions / Warranty

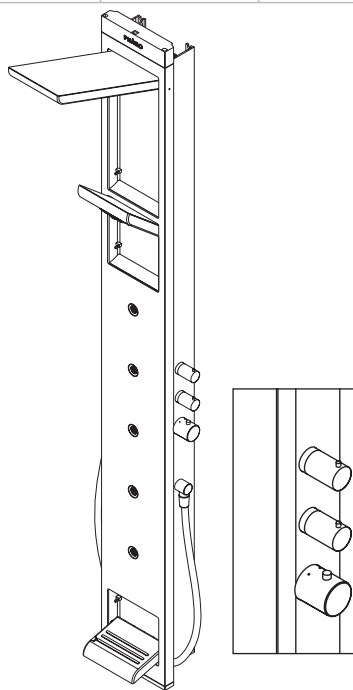

Pharo Skyline

26017XX1

hansgrohe

Technical Information

Recommended water pressure	14.7 - 72.5 psi
Minimum water pressure	29 psi
Max. water pressure	147 psi
Recommended hot water temp.	120° - 140° F*
Max. hot water temp	165°F*
Max. flow rate:	
showerhead	2.5 gpm
handshower	2.5 gpm
neck spray	2.5 gpm
bodysprays	0.72 gpm each

- Thermostatic temperature control
- The high temperature limit stop on the thermostatic mixing valve may be reset to comply with local plumbing codes – please refer to the installation instruction manual.
- Protection against back siphonage provided by check valves. The check valves should be removed and inspected yearly (see page 8).
- This panel may be used with an instantaneous water heater if the heater is at least 24 kW and the output is at least 3 gpm @ 30 psi pressure. However, only one panel function may be used at a time.

*Please know and follow all applicable local plumbing codes when setting the temperature on the water heater. In Massachusetts, the water heater may be set no higher than 112°F.

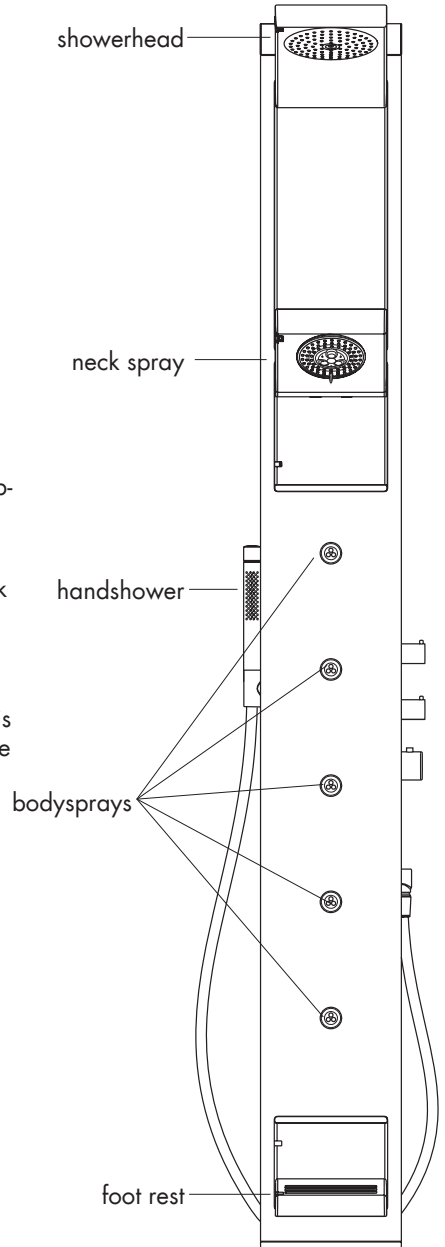

User Instructions

Turn the top volume control clockwise to obtain water from the overhead shower.

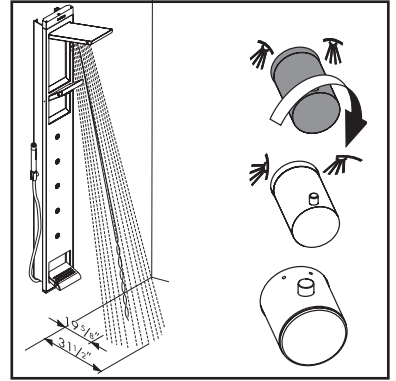

Turn the top volume control counter-clockwise to obtain water from the neck spray.

It is not possible to run the overhead shower and the neck spray simultaneously.

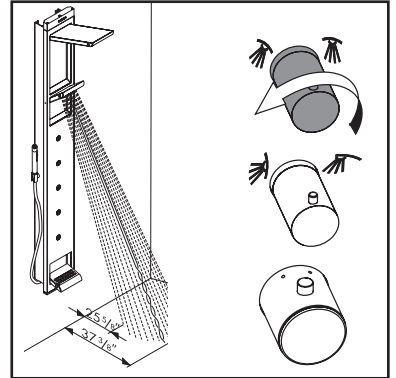

Turn the bottom volume control clockwise to obtain water from the handshower.

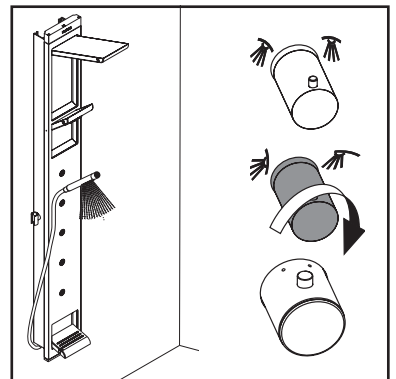

Turn the bottom volume control counter-clockwise to obtain water from the bodysprays.

It is not possible to run the handshower and bodysprays simultaneously.

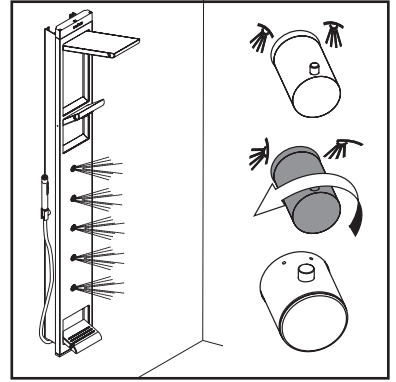

The following combinations may be used by turning on each function with the volume control:

- Overhead shower and handshower

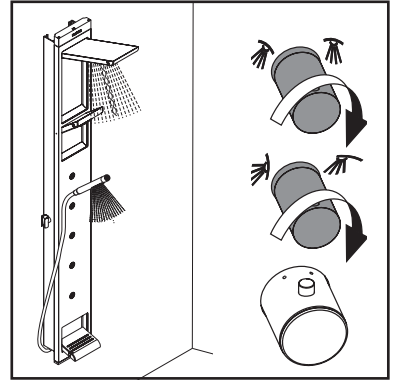

- Overhead shower and bodysprays

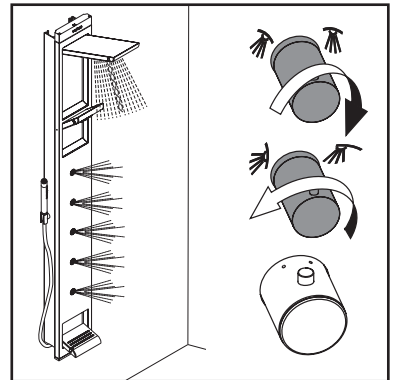

- Neck spray and handshower

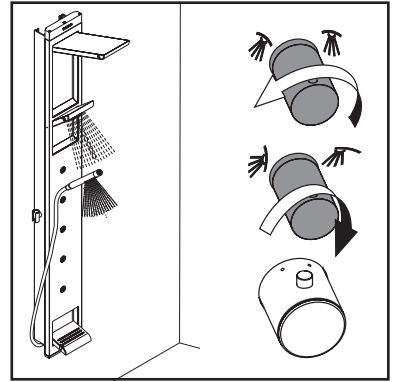

- Neck spray and bodysprays

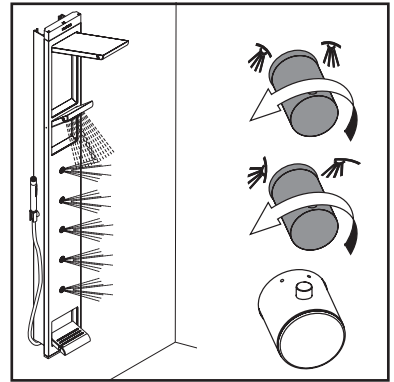

Using the thermostatic mixer

Turn the thermostatic mixer handle clockwise to make the water cooler.

Turn it counter-clockwise to make it warmer.

The handle will stop at the 100° safety stop.

To override the safety stop, press the override button and continue turning the handle counter-clockwise.

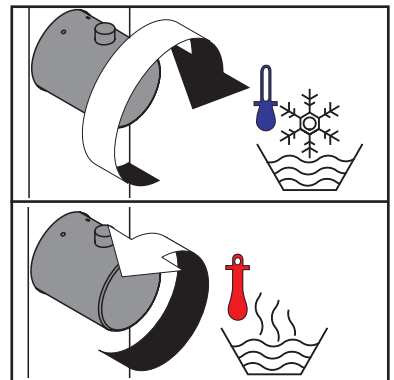

Open the overhead shower and neck spray

To open the overhead shower and neck spray, press the lower left hand corner of the cover.

To open the footrest, press the upper left corner of the cover.

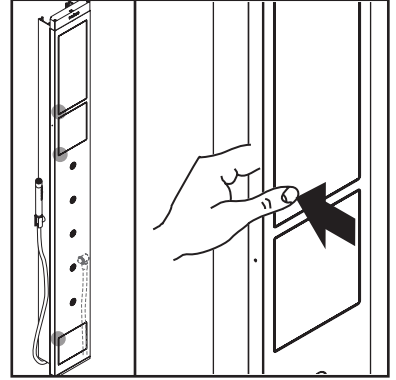

The showerhead will open to the 95° position.

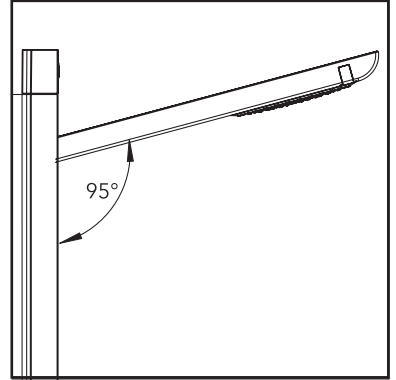

Push it upward to the 110° position, if desired.

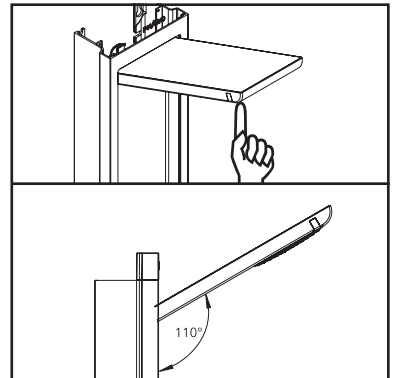

Adjust the showerhead cover

If the showerhead or neckspray cover does not hang straight, loosen or tighten the set screw with a 3 mm Allen wrench to correct.

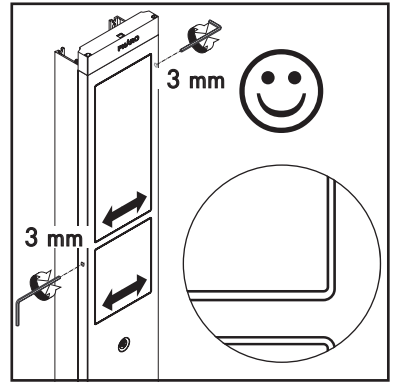
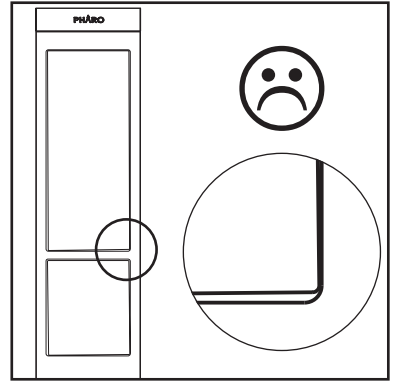

Cleaning the hand and overhead showers

The handshower and overhead shower use the Rubit™ self-cleaning system.

If scale deposits are noticed in the spray channels, turn the water on lightly and rub over the channels with a finger or a sponge to dislodge them.

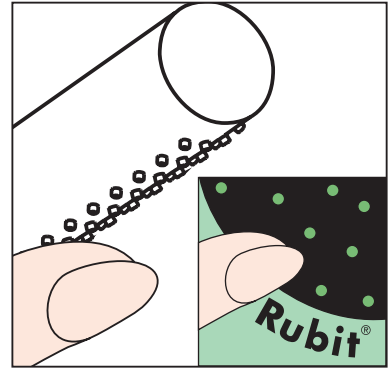

Troubleshooting

Problem	Possible cause	Solution
Outputs both hot and cold water, but no mix	Not a product defect Supply lines connected to the incorrect elbows	Reconnect supply lines to correct elbows
Insufficient water	Filters inside supply elbows clogged	Remove and clean filters
Erratic water temperature	Thermostatic mixer cartridge faulty	Replace thermostat cartridge
Function drips, won't shut off completely	Volume control cartridge faulty	Replace volume control cartridge
Hot water bleeds over into cold water supply in house or vice-versa	Faulty check valve	Remove and clean check valve, replace if necessary

Maintenance Note:

The check valves located in the hot and cold elbows should be removed and inspected yearly.

If the flow of water decreases over time, clean the filters.

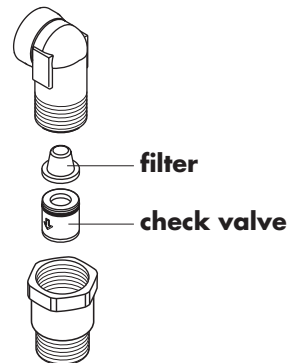

Replacement Parts

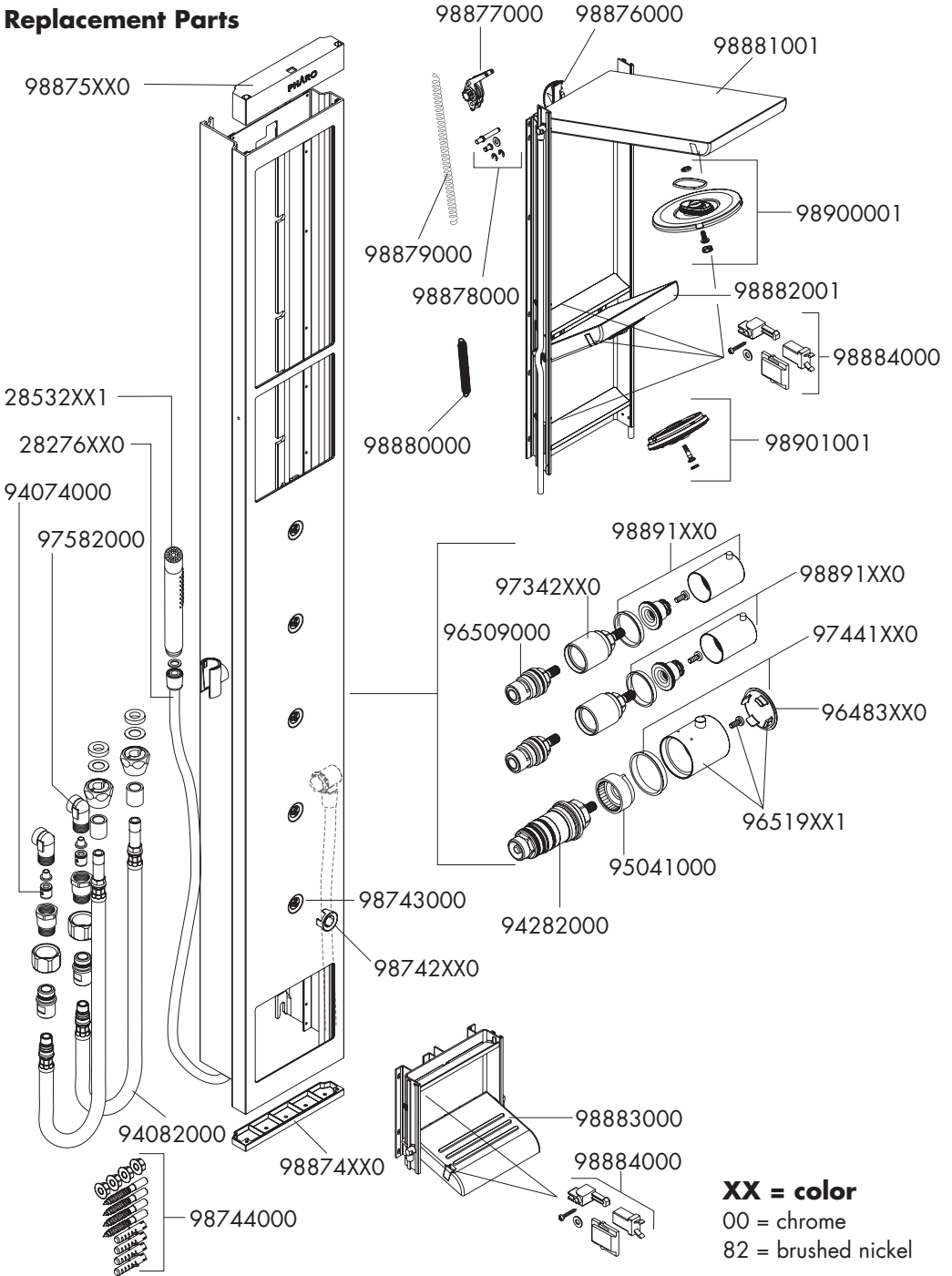

XX = color
 00 = chrome
 82 = brushed nickel

Cleaning Recommendation for Hansgrohe Products

Modern lavatory faucets, kitchen faucets and showers consist of very different materials to comply with the needs of the market with regard to design and functionality.

To avoid damage and returns, it is necessary to consider certain criteria when cleaning.

When cleaning fittings and showers, keep the following in mind:

- Only use cleaning materials intended for this purpose.
- Never use cleaning materials which contain hydrochloric acid, formic acid, chlorine pale lye or acetic acid, as they cause considerable damage.
- Phosphoric acidic cleaners are only conditionally applicable.
- Do not mix cleaning products, unless instructed to do so by the cleaning material manufacturer.
- Never use cleaning materials or appliances with an abrasive effect, such as unsuitable cleaning powders, sponge pads, or micro fiber cloths.
- Always follow the instructions provided by the manufacturer of the cleaning product.
- Be sure to use the correct amount of cleaner, and leave it in contact with the fitting for the correct amount of time.
- The buildup of limescale and hard water spots should be prevented by regular cleaning.
- When using spray cleaners, spray first onto a soft cloth or sponge; never directly onto the fitting, as drops could enter openings and gaps and cause damage.
- After cleaning, rinse the fitting thoroughly with clean water to remove any cleaner residue.
- The use of steam cleaners is not permitted. The high temperatures can damage fittings.

Important

Residues of liquid soaps, shampoos and shower foams can also cause damage, so rinse with clean water after using.

Please note: If the surface is already damaged, the effect of cleaning materials will cause further damage.

Components with damaged surfaces must be replaced, otherwise this could cause an injury.

Damage caused by improper treatment is not covered by our warranty.

Limited Lifetime Consumer Warranty

This product has been manufactured and tested to the highest quality standards by Hansgrohe, Inc. ("Hansgrohe"). This warranty is limited to Hansgrohe products which are purchased by a consumer in the United States after March 1, 1996, and installed in either the United States or Canada.

WHO IS COVERED BY THE WARRANTY

This warranty extends to the original consumer purchaser only. This warranty is non-transferable.

WHAT IS COVERED BY THE WARRANTY

This warranty covers only your Hansgrohe manufactured product. Hansgrohe warrants this product against defects in material or workmanship as follows: Hansgrohe will repair at no charge for parts only or, at its option, replace any product or part of the product that proves defective because of improper workmanship and/or material, under normal installation, use, service and maintenance. If Hansgrohe is unable to provide a replacement and repair is not practical or cannot be timely made, Hansgrohe may elect to refund the purchase price in exchange for the return of the product.

LENGTH OF WARRANTY

Replacement or repaired parts of products will be covered for the term of this warranty as stated in the following two sentences. If you are a consumer who purchased the product for use primarily for personal, family, or household purposes, this warranty extends for as long as you own the product and the home in which the product is originally installed. If you purchased the product for use primarily for any other purpose, including, without limitation, a commercial purpose, this warranty extends only (i) for 1 year, with respect to Hansgrohe and Commercial products, and (ii) for 5 years, with respect to AXOR products.

THIS WARRANTY DOES NOT COVER, AND HANSGROHE WILL NOT PAY FOR:

- A. Conditions, malfunctions or damage not resulting from defects in material or workmanship.
- B. Conditions, malfunctions or damage resulting from (1) normal wear and tear, improper installation, improper maintenance, misuse, abuse, negligence, accident or alteration, or (2) the use of abrasive or caustic cleaning agents or “no-rinse” cleaning products, or the use of the product in any manner contrary to the product instructions. (3) Conditions in the home such as excessive water pressure or corrosion.
- C. Labor or other expenses for the disconnection, deinstallation, or return of the product for warranty service, or for installation or reinstallation of the product (including but not limited to proper packaging and shipping costs), or for installation or reinstallation of the product.
- D. Accessories, connected materials and products, or related products not manufactured by Hansgrohe.

TO OBTAIN WARRANTY PARTS OR INFORMATION

Contact your Hansgrohe retailer, or contact Technical Service at:

Hansgrohe Inc.
1492 Bluegrass Lakes Parkway
Alpharetta GA 3XX04
Toll-free (800) 334-0455.

In requesting warranty service, you will need to provide

- 1. The sales receipt or other evidence of the date and place of purchase.
- 2. A description of the problem.
- 3. Delivery of the product or the defective part, postage prepaid and carefully packed and insured, to Hansgrohe Inc. 1492 Bluegrass Lakes Parkway, Alpharetta, Georgia 3XX04, Attention: Technical Service, if required by Hansgrohe.

When warranty service is completed, any repaired or replacement product or part will be returned to you postage prepaid.

EXCLUSIONS AND LIMITATIONS

REPAIR OR REPLACEMENT (OR, IN LIMITED CIRCUMSTANCES, REFUND OF THE PURCHASE PRICE) AS PROVIDED UNDER THIS WARRANTY IS THE EXCLUSIVE REMEDY OF THE PURCHASER. HANSGROHE NEITHER ASSUMES NOR AUTHORIZES ANY PERSON TO CREATE FOR IT ANY OBLIGATION OR LIABILITY IN CONNECTION WITH THIS PRODUCT.

HANSGROHE SHALL NOT BE LIABLE TO PURCHASER OR ANY PERSON FOR ANY INCIDENTAL, SPECIAL, OR CONSEQUENTIAL DAMAGES, ARISING OUT OF BREACH OF THIS WARRANTY OR ANY IMPLIED WARRANTY (INCLUDING MERCHANTABILITY).

Some States do not allow the exclusion or limitation of incidental or consequential damages, so the above limitation or exclusion may not apply to you. This warranty gives you specific legal rights, and you may have other rights which vary from State to State. You may be required by law to give us a reasonable opportunity to correct or cure any failure to comply before you can bring any action in court against us under the Magnuson-Moss Warranty Act.

PRODUCT INSTRUCTIONS AND QUESTIONS

Upon purchase or prior to installation, please carefully inspect your Hansgrohe product for any damage or visible defect. Prior to installing, always carefully study the enclosed instructions on the proper installation and the care and maintenance of the product. If you have questions at any time about the use, installation, or performance of your Hansgrohe product, or this warranty, please call or write to us or call us toll-free at 800 334 0455.

hansgrohe

Hansgrohe, Inc. • 1490 Bluegrass Lakes Parkway • Alpharetta, GA 3XX04
Tel. 770-360-9880 • Fax 770-360-9887

www.hansgrohe-usa.com