

Installation / Warranty

hansgrohe



**Three-hole Tub Filler Rough
Three-hole Tub Filler Trims**

interaktiv
hansgrohe

retroaktiv
hansgrohe

90964701 4/2004

3-Hole Tub Filler Rough 06607000

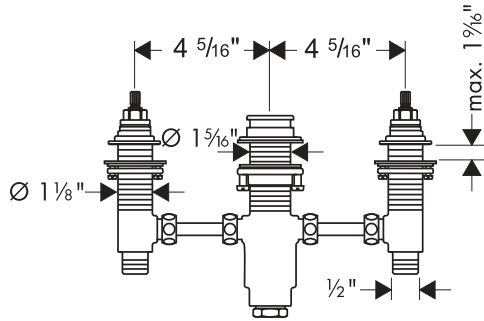
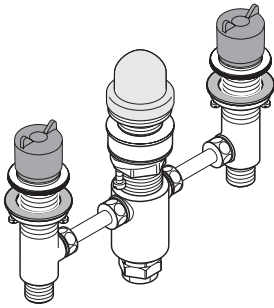

Technical Specification

Recommended operating pressure	45 - 80 psi
Recommended hot water temperature	120° - 140° F*
Flow rate - valves	approx. 7 gpm each

Hole sizes

Valves	1 1/4"
Spout	1 3/8"
Spout Adapter Pin	3/16"
Maximum mounting surface thickness	1 1/2"

Installation Considerations

For best results, Hansgrohe recommends installation by a licensed professional plumber. Installation must be completed with an Interaktiv or Retroaktiv 3-hole tub filler trim kit.

Hansgrohe does not provide supply lines or nuts.

Large differences in pressure between the hot and cold supplies should be balanced.

The hot and cold supplies must be thoroughly flushed before installation of this rough valve. Damage to the valve cartridges caused by debris in the water lines is not covered under the Hansgrohe Consumer Limited Lifetime Warranty.

Install the connecting tubes

Install a compression nut and ferrule to one end of the connection tube. Push the tube into the inlet of the spout tee. Tighten the compression nut.

Install a compression nut and ferrule on the other end of the connection tube. Push the tube into the outlet port of the valve corner. Tighten the compression nut.

Repeat with the second connection tube.

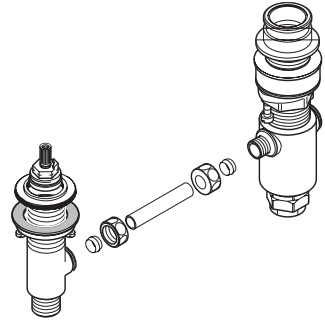

Install the rough

Caution: Do not bend or kink the copper connection tubes.

- Remove the plaster shields, mounting plates, o-rings, and stop rings from the valve corners and set them aside in a safe location. Remove the plaster shield, spout adapter, and spout adapter gasket from the spout tee.
- If necessary, reinstall the o-rings to the corresponding grooves on the mounting plates.
- From below, insert the valve corners and spout tee through the corresponding holes in the mounting surface.
- From above, slide the stop rings onto the valve corners. Thread the mounting plates onto the valve corners. The stop rings will stop them at the proper height. Rest the mounting plates on the mounting surface.

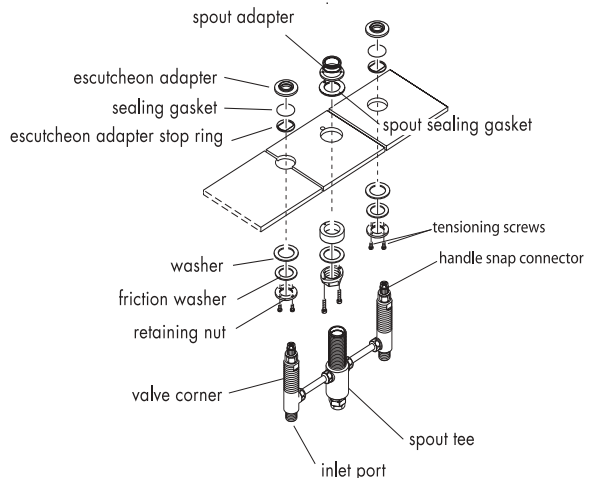

- Slide the spout adapter gasket over the spout tee, aligning the retaining pin hole in the gasket with the retaining pin hole in the surface. Thread the spout adapter onto the tee. When resting on the mounting surface, the retaining pin should go through the retaining pin hole in the gasket and mounting surface – adjust if necessary.
- From underneath the deck, tighten the mounting nuts firmly against the underside of the mounting surface. Tighten the tensioning screws.

Finish the installation

- Install the hot and cold supplies to the inlet ports of the valve corners.
- Make sure that the enclosed plug on the spout adapter is securely in place. Pressurize the system and check all connections for leaks.
- Cover the valve stems and the spout adapter with the enclosed plaster shields until ready to install the trim.

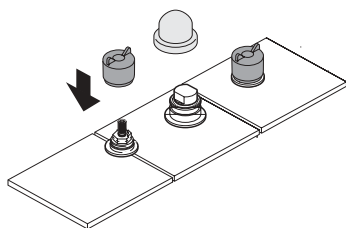

Replacement Parts

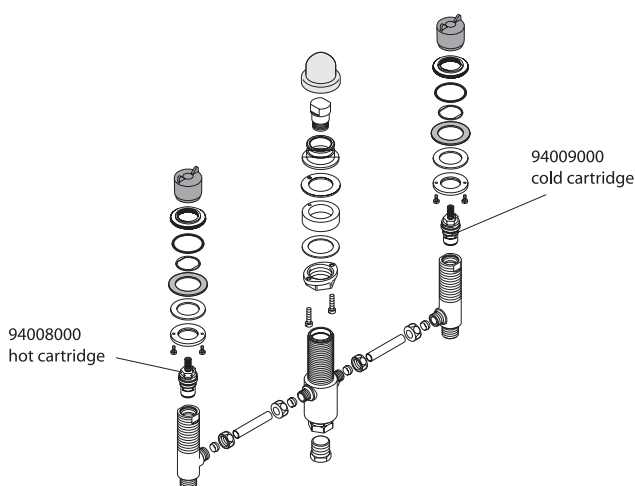

3-Hole Tub Filler Trim Kits

Models Covered

Interaktiv	1901	Solaris	Monsoon	
	06606XX0	06630XX0	06617XX0	
	Stratos	Metro	S	
	06574XX0	06551000	06875000	
Retroaktiv	Swing	Tango	Limbo	
	Cross handle	06122XX0	06045XX0	06109XX0
	Scroll handle	06120XX0	06044XX0	06108XX0
	Lever handle	06120XX0	06043XX0	06107XX0

Installation Considerations

These trim kits are for use with 3-hole roman tub rough 06607000. The rough must be installed, and the finished deck complete before this trim kit can be installed.

For best service, Hansgrohe recommends that this product be installed by a licensed, professional plumber.

Interaktiv

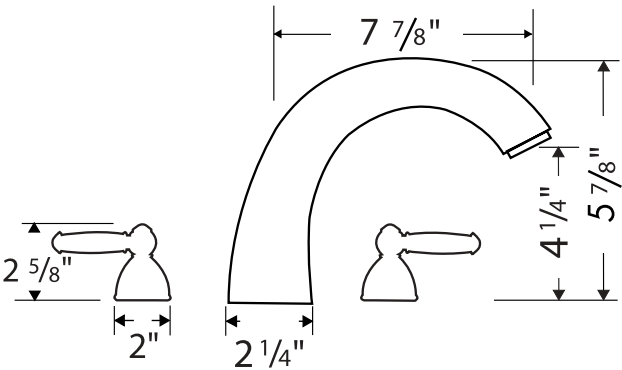

Interaktiv - 1901 handles shown

Retroaktiv

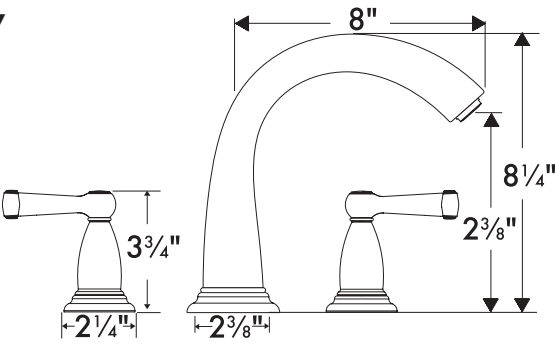

Swing - scroll handles shown

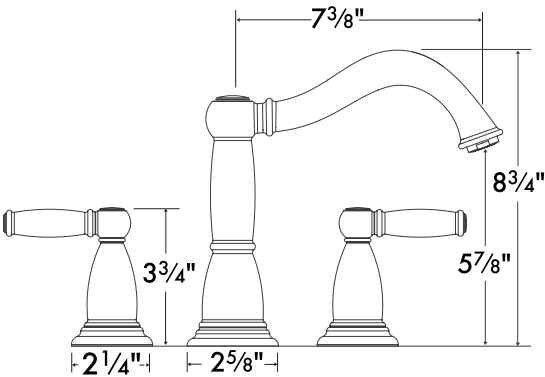

Tango - lever handles shown

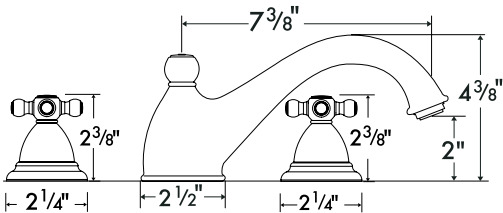

Limbo - cross handles shown

Installation Instructions

Install the Handles

- Remove the plaster shields from the hot and cold valves.
- Position the handle over the valve stem with the lever in the desired "off" position.
- Holding the lever in place, use your other hand to turn the "bell" and screw it down over the mounting plate.

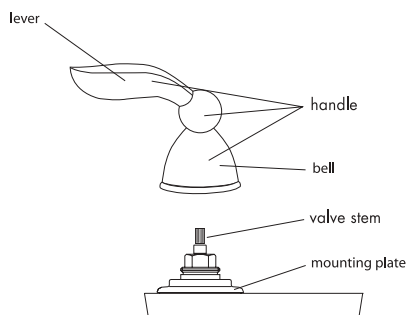

Install the Spout

- Remove the plaster shield from the spout tee. Remove the brass plug from the tee.

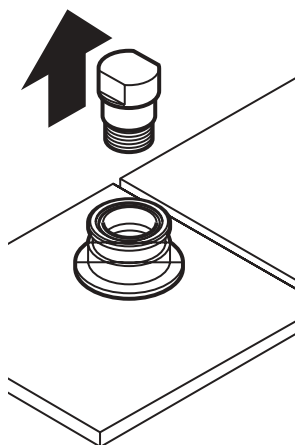

- Push the spout sealing ring into the spout tee.
- Press the spout over the spout tee firmly. Tighten the set screw.

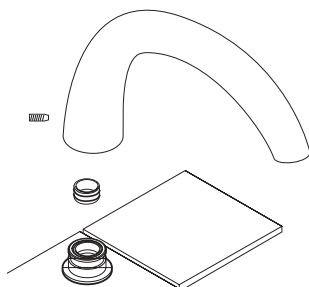

User Instructions:

Turn the left handle to obtain hot water, the right handle to obtain cold water.

Service Parts

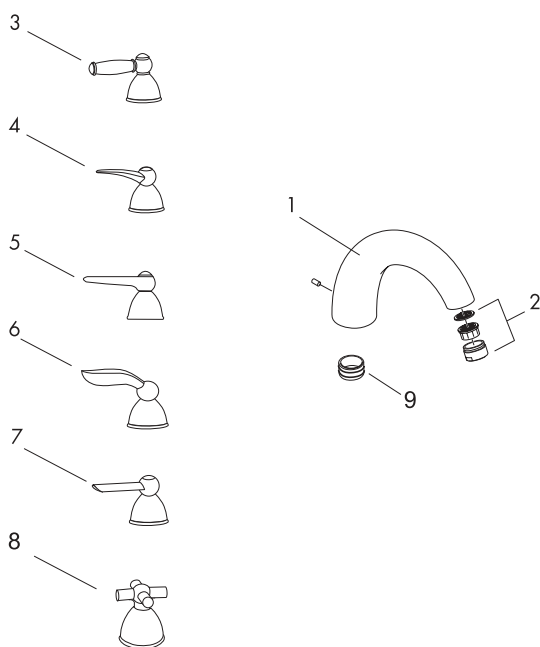

- 1 spout
- 2 aerator
- 3 1901 handle
- 4 Monsoon handle
- 5 Metro handle
- 6 Solaris handle
- 7 Stratos handle
- 8 Interaktiv S handle
- 9 spout sealing ring

Cleaning Recommendation for Hansgrohe Products

Modern faucetry and shower products utilize a combination of materials to comply with the needs of the market with regard to design and functionality.

To avoid damage, it is necessary to use some caution when cleaning. Damage caused by improper treatment is not covered under the Hansgrohe warranty.

Cleaning Materials for Faucets and Showers

- To remove lime scale, use only products made specifically for that purpose. Always follow the manufacturer's instructions when using.
- Do not use cleaners that contain hydrochloric, formic, acetic, or phosphoric acids, as these will cause considerable damage to finishes and to plastic components.
- Never mix cleaning materials.
- Never use cleaners containing abrasives. Do not use abrasive cleaning cloths, pads, or sponges.

Cleaning Procedures

- Clean your faucets and shower products as and when required. Regular cleaning will prevent scale buildup and water spotting.
- Follow the label instructions. Do not allow any cleaner to remain on the product for longer than necessary.
- When using spray cleaners, spray first onto a sponge or cloth – do not spray directly onto the product.
- After cleaning, rinse thoroughly with clear water to remove any cleaner residue.

Important

- Soap and shampoo residue can also cause damage to the product. Rinse well with clean water after use.
- If the surface is already damaged, harsh cleaning materials will cause further damage.

Limited Lifetime Consumer Warranty

This product has been manufactured and tested to the highest quality standards by Hansgrohe, Inc. ("Hansgrohe"). This warranty is limited to Hansgrohe products which are purchased by a consumer in the United States after March 1, 1996, and installed in either the United States or Canada.

WHO IS COVERED BY THE WARRANTY

This warranty extends to the original consumer purchaser only.

WHAT IS COVERED BY THE WARRANTY

This warranty covers only your Hansgrohe manufactured product. Hansgrohe warrants this product against defects in material or workmanship as follows: Hansgrohe will repair at no charge for parts only or, at its option, replace any product or part of the product which proves defective because of improper workmanship and/or material, under normal installation, use, service and maintenance. If Hansgrohe is unable to provide a replacement and repair is not practical or cannot be timely made, Hansgrohe may elect to refund the purchase price in exchange for the return of the product.

LENGTH OF WARRANTY

Replacement or repaired parts of products will be covered for the term of this warranty as stated in the following two sentences. If you are a consumer who purchased the product for use primarily for personal, family, or household purposes, this warranty extends for as long as you own the product and the home in which the product is installed. If you purchased the product for use primarily for any other purpose, including, without limitation, a commercial purpose, this warranty extends only (i) for 1 year, with respect to Interaktiv and Retroaktiv products, and (ii) for 5 years, with respect to AXOR, ShowerPower and Pharo products.

THIS WARRANTY DOES NOT COVER, AND HANSGROHE WILL NOT PAY FOR:

- A. Conditions, malfunctions or damage not resulting from defects in material or workmanship.
- B. Conditions, malfunctions or damage resulting from (1) improper installation, improper maintenance, misuse, abuse, negligence, accident or alteration, or (2) the use of abrasive or caustic cleaning agents or "no rinse" cleaning products, or the use of the product in any manner contrary to the product instructions.
- C. Labor or other expenses for the disconnection or return of the product for warranty service, or for installation or reinstallation of the product.
- D. Accessories or related products not manufactured by Hansgrohe.

TO OBTAIN WARRANTY SERVICE

Contact your Hansgrohe retailer, or write to Technical Service at:

Hansgrohe Inc.
1492 Bluegrass Lakes Parkway
Alpharetta GA 30004

Or, call Hansgrohe toll-free at (800) 334-0455.

In requesting warranty service, you will need to provide

- 1. The sales receipt or other evidence of the date and place of purchase.
- 2. A description of the problem.
- 3. Delivery of the product or the defective part, postage prepaid and carefully packed and insured, to Hansgrohe Inc. 1492 Bluegrass Lakes Parkway, Alpharetta, Georgia 30004, Attention: Technical Service, if required by Hansgrohe.

When warranty service is completed, any repaired or replacement product or part will be returned to you postage prepaid.

EXCLUSIONS AND LIMITATIONS

REPAIR OR REPLACEMENT (OR, IN LIMITED CIRCUMSTANCES, REFUND OF THE PURCHASE PRICE) AS PROVIDED UNDER THIS WARRANTY IS THE EXCLUSIVE REMEDY OF THE PURCHASER. HANSGROHE NEITHER ASSUMES NOR AUTHORIZES ANY PERSON TO CREATE FOR IT ANY OBLIGATION OR LIABILITY IN CONNECTION WITH THIS PRODUCT.

HANSGROHE SHALL NOT BE LIABLE TO PURCHASER OR ANY PERSON FOR ANY INCIDENTAL, SPECIAL, OR CONSEQUENTIAL DAMAGES, ARISING OUT OF BREACH OF THIS WARRANTY OR ANY IMPLIED WARRANTY (INCLUDING MERCHANTABILITY).

Some States do not allow the exclusion or limitation of incidental or consequential damages, so the above limitation or exclusion may not apply to you.

This warranty gives you specific legal rights, and you may have other rights which vary from State to State.

You may be required by law to give us a reasonable opportunity to correct or cure any failure to comply before you can bring any action in court against us under the Magnuson-Moss Warranty Act.

PRODUCT INSTRUCTIONS AND QUESTIONS

Upon purchase or prior to installation, please carefully inspect your Hansgrohe product for any damage or visible defect. Prior to installing, always carefully study the enclosed instructions on the proper installation and the care and maintenance of the product. If you have questions at any time about the use, installation, or performance of your Hansgrohe product, or this warranty, please call or write to us at the toll-free number and address printed above.

Hansgrohe Inc.
1490 Bluegrass Lakes Parkway
Alpharetta GA 30004
770 360 9880
website: www.hansgrohe-USA.com