

Installation Instructions / Warranty

hansgrohe



**Interaktiv 1901 4" Centerset Lavatory Faucet
Variable Spread Lavatory Faucet**

interaktiv
hansgrohe

retroaktiv
hansgrohe

Models Covered

Interaktiv

	4" Centerset	Variable Spread
1901	06608XX0	06609XX0
Solaris	n/a	06633XX0
Monsoon	n/a	06673XX0
Stratos	n/a	06577XX0
Metro	n/a	06653000
S	n/a	06874000

Retroaktiv

	4" Centerset	Variable Spread
Limbo		
Lever handle	06101XX0	06104XX0
Scroll handle	06102XX0	06105XX0
Cross handle	06103XX0	06106XX0
Tango		
Lever handle	06037XX0	06040XX0
Scroll handle	06038XX0	06041XX0
Cross handle	06039XX0	06042XX0
Swing		
Lever handle	n/a	06117XX0
Scroll handle	n/a	06118XX0
Cross handle	n/a	06119XX0

Installation Considerations

- For best results, Hansgrohe recommends installation by a licensed professional plumber.
- Large differences in pressure between the hot and cold supplies should be balanced.
- Hansgrohe does not include inlet supply lines or nuts with its widespread lavatory faucets.
- Due to the size of the escutcheons, the Retroaktiv variable spread lavatory faucets cannot be used in a 4" installation.

Product Specifications

Recommended incoming water pressure	22 - 72 PSI
Recommended incoming hot water temperature	120° - 140°F*
Hole size in mounting surface	
Valves	1 1/4"
spout	1 3/8"
Maximum mounting surface thickness	1 1/2"
Flow rate	2.2 gpm max.

*some municipalities have codes limiting the maximum temperature of the water heater to 120°F or less. Please know and follow all applicable local codes when setting the temperature on the water heater.

Replacement Parts

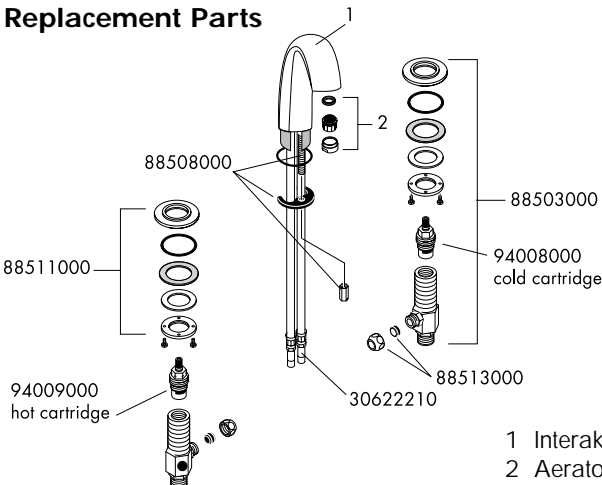

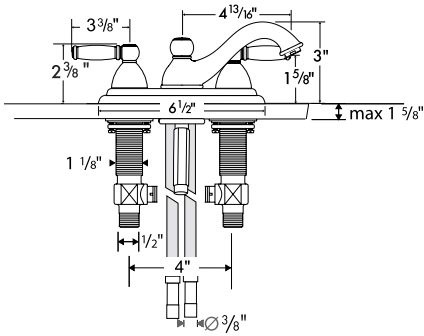

Limbo 4" Centerset - lever handles

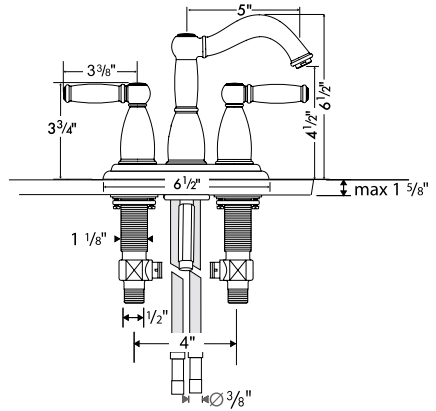

Tango 4" Centerset - scroll handles

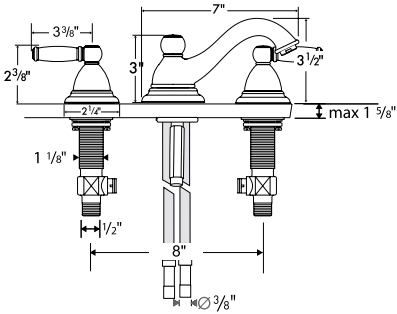

Limbo Variable Spread - lever handles

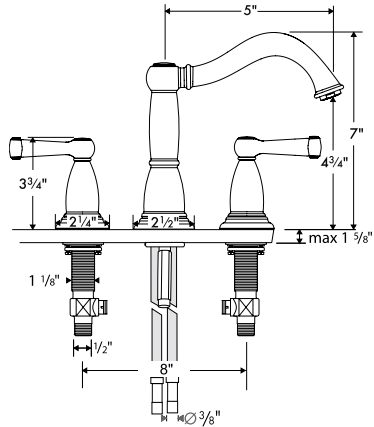

Tango Variable Spread - scroll handles

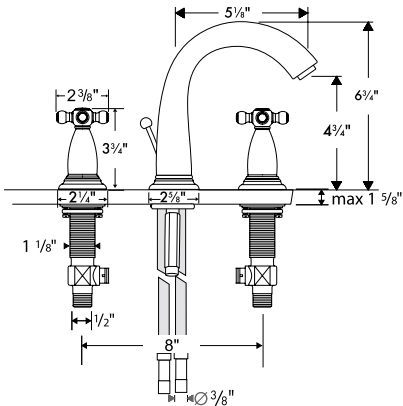

Swing Variable spread - cross handles

Interaktiv Faucets

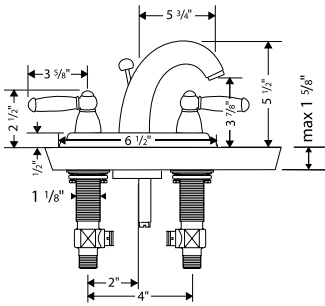

1901 4" Centerset

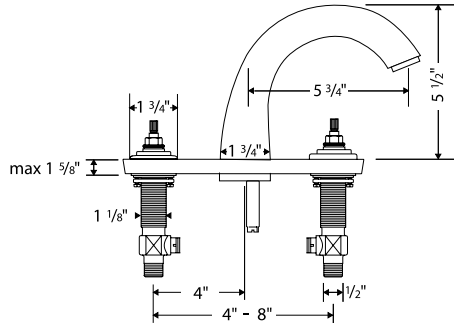

Interaktiv variable spread lav (handles not shown)

Install the hot and cold valves

- Install the mounting nut, metal washer and the fiber washer to the valve corner.
- Install the o-rings to the corresponding grooves on the mounting plate.
- **If using the 4" centerset escutcheon, put it in place.**
- Insert the valve corner through the hole in the deck from the below the mounting surface. The hot corner is marked with red and the cold with blue.
- From the top, install the stop ring to the valve corner. Thread the mounting plate onto the valve corner as far as it will go — the stop ring will stop it at the proper height. Place the valve corner on the mounting surface. Turn the valve so that the outlet ports point toward the center.
- From underneath the deck, tighten the mounting nut. Tighten the tensioning screws.

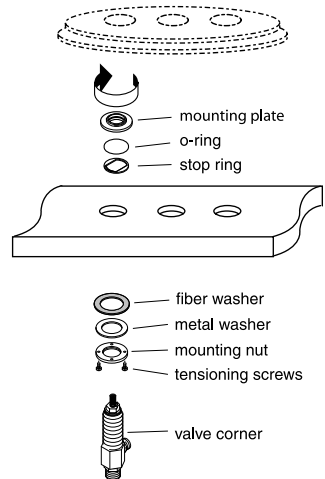

Install the spout

- Place the spout and sealing ring on top of the mounting surface.
- From beneath the mounting surface, install the flange seal and the mounting flange. Thread the collar onto the stud and tighten.

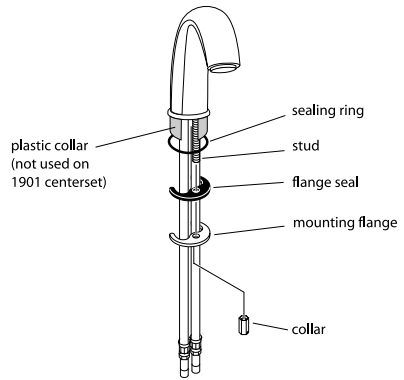

Connect the valves to the spout

- Slip a compression nut and washer over the male shank of the flexible connection.
- Insert the shank of the flexible connection into the valve corner. Tighten wrench tight.
- Repeat with the other valve corner and hose.

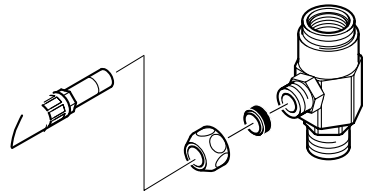

Install the handle

- **If using the 4" centerset, install the o-rings over the bottoms of the handles.**

- Position the handle over the valve stem with the lever in the desired "off" position – normally pointing to the 3:00 position for the cold handle, and the 9:00 position for the hot handle.
- Holding the lever in place, use your other hand to turn the "bell" and screw it down against the mounting plate.

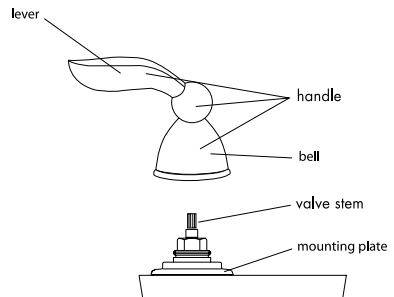

Install the Pop Up Drain

- Remove the plunger assembly.
- Unscrew the drain outlet flange from the tee.
- Unscrew the tailpiece from the tee. Wrap the threads with plumbers' thread tape and replace.
- Install the flexible sealing gasket to the flange. Sit it in the sink outlet.
- From under the sink, install the black mack gasket, white friction ring, and retainer nut to the flange. Do not tighten the nut against the bottom of the sink at this time.

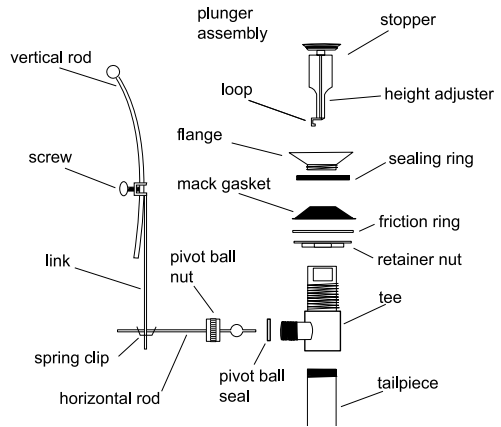

- Thread the tee and tailpiece to the flange. The pivot must face the faucet. If necessary, turn the drain assembly.
- Tighten the retainer nut.
- Sit the plunger assembly in the drain.
- Install the horizontal rod through the pivot ball gasket and into the tee so that the end goes through the loop in the bottom of the height adjuster.
- Slide link over end of vertical rod. Tighten screw.
- Slide one end of spring clip over end of horizontal rod. Slide link over end of horizontal rod. Test motion of drain plunger. Reposition link as necessary. There are multiple holes in the linkage -- the horizontal rod may go through any of the holes.
- When satisfied with the action of the drain, slide the other end of the spring clip over the end of the horizontal rod.

Complete the Installation

- Connect the hot and cold supply lines to the valve corners. Note: Hansgrohe does not include supply lines or nuts with this faucet.
- Turn on the water and check all connections for leaks.

Cleaning Recommendation for Hansgrohe Products

Modern faucetry and shower products utilize a combination of materials to comply with the needs of the market with regard to design and functionality.

To avoid damage, it is necessary to use some caution when cleaning. Damage caused by improper treatment is not covered under the Hansgrohe warranty.

Cleaning Materials for Faucets and Showers

- To remove lime scale, use only products made specifically for that purpose. Always follow the manufacturer's instructions when using.
- Do not use cleaners that contain hydrochloric, formic, acetic, or phosphoric acids, as these will cause considerable damage to finishes and to plastic components.
- Never mix cleaning materials.
- Never use cleaners containing abrasives. Do not use abrasive cleaning cloths, pads, or sponges.

Cleaning Procedures

- Clean your faucets and shower products as and when required. Regular cleaning will prevent scale buildup and water spotting.
- Follow the label instructions. Do not allow any cleaner to remain on the product for longer than necessary.
- When using spray cleaners, spray first onto a sponge or cloth – do not spray directly onto the product.
- After cleaning, rinse thoroughly with clear water to remove any cleaner residue.

Important

- Soap and shampoo residue can also cause damage to the product. Rinse well with clean water after use.
- If the surface is already damaged, harsh cleaning materials will cause further damage.

Limited Lifetime Consumer Warranty

This product has been manufactured and tested to the highest quality standards by Hansgrohe, Inc. ("Hansgrohe"). This warranty is limited to Hansgrohe products which are purchased by a consumer in the United States after March 1, 1996, and installed in either the United States or Canada.

WHO IS COVERED BY THE WARRANTY

This warranty extends to the original consumer purchaser only.

WHAT IS COVERED BY THE WARRANTY

This warranty covers only your Hansgrohe manufactured product. Hansgrohe warrants this product against defects in material or workmanship as follows: Hansgrohe will repair at no charge for parts only or, at its option, replace any product or part of the product which proves defective because of improper workmanship and/or material, under normal installation, use, service and maintenance. If Hansgrohe is unable to provide a replacement and repair is not practical or cannot be timely made, Hansgrohe may elect to refund the purchase price in exchange for the return of the product.

LENGTH OF WARRANTY

Replacement or repaired parts of products will be covered for the term of this warranty as stated in the following two sentences. If you are a consumer who purchased the product for use primarily for personal, family, or household purposes, this warranty extends for as long as you own the product and the home in which the product is installed. If you purchased the product for use primarily for any other purpose, including, without limitation, a commercial purpose, this warranty extends only (i) for 1 year, with respect to Interaktiv and Retroaktiv products, and (ii) for 5 years, with respect to AXOR, ShowerPower and Pharo products.

THIS WARRANTY DOES NOT COVER, AND HANSGROHE WILL NOT PAY FOR:

- A. Conditions, malfunctions or damage not resulting from defects in material or workmanship.
- B. Conditions, malfunctions or damage resulting from (1) improper installation, improper maintenance, misuse, abuse, negligence, accident or alteration, or (2) the use of abrasive or caustic cleaning agents or "no rinse" cleaning products, or the use of the product in any manner contrary to the product instructions.
- C. Labor or other expenses for the disconnection or return of the product for warranty service, or for installation or reinstallation of the product.
- D. Accessories or related products not manufactured by Hansgrohe.

TO OBTAIN WARRANTY SERVICE

Contact your Hansgrohe retailer, or write to Technical Service at:

Hansgrohe Inc.
1492 Bluegrass Lakes Parkway
Alpharetta GA 30004

Or, call Hansgrohe toll-free at (800) 334-0455.

In requesting warranty service, you will need to provide

- 1. The sales receipt or other evidence of the date and place of purchase.
- 2. A description of the problem.
- 3. Delivery of the product or the defective part, postage prepaid and carefully packed and insured, to Hansgrohe Inc. 1492 Bluegrass Lakes Parkway, Alpharetta, Georgia 30004, Attention: Technical Service, if required by Hansgrohe.

When warranty service is completed, any repaired or replacement product or part will be returned to you postage prepaid.

EXCLUSIONS AND LIMITATIONS

REPAIR OR REPLACEMENT (OR, IN LIMITED CIRCUMSTANCES, REFUND OF THE PURCHASE PRICE) AS PROVIDED UNDER THIS WARRANTY IS THE EXCLUSIVE REMEDY OF THE PURCHASER. HANSGROHE NEITHER ASSUMES NOR AUTHORIZES ANY PERSON TO CREATE FOR IT ANY OBLIGATION OR LIABILITY IN CONNECTION WITH THIS PRODUCT.

HANSGROHE SHALL NOT BE LIABLE TO PURCHASER OR ANY PERSON FOR ANY INCIDENTAL, SPECIAL, OR CONSEQUENTIAL DAMAGES, ARISING OUT OF BREACH OF THIS WARRANTY OR ANY IMPLIED WARRANTY (INCLUDING MERCHANTABILITY).

Some States do not allow the exclusion or limitation of incidental or consequential damages, so the above limitation or exclusion may not apply to you.

This warranty gives you specific legal rights, and you may have other rights which vary from State to State.

You may be required by law to give us a reasonable opportunity to correct or cure any failure to comply before you can bring any action in court against us under the Magnuson-Moss Warranty Act.

PRODUCT INSTRUCTIONS AND QUESTIONS

Upon purchase or prior to installation, please carefully inspect your Hansgrohe product for any damage or visible defect. Prior to installing, always carefully study the enclosed instructions on the proper installation and the care and maintenance of the product. If you have questions at any time about the use, installation, or performance of your Hansgrohe product, or this warranty, please call or write to us at the toll-free number and address printed above.