

*Installation Instructions / Warranty*

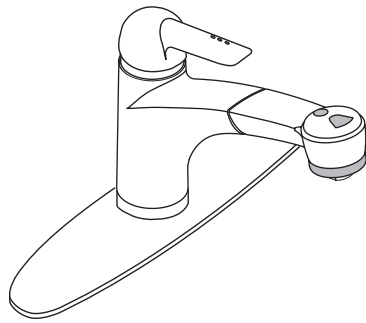

*Single Control Kitchen Mixers*

*3/8" supply hoses  
requires 3/8" compression fittings*

**hansgrohe**  
**interaktiv**

90964601-01 05/2005

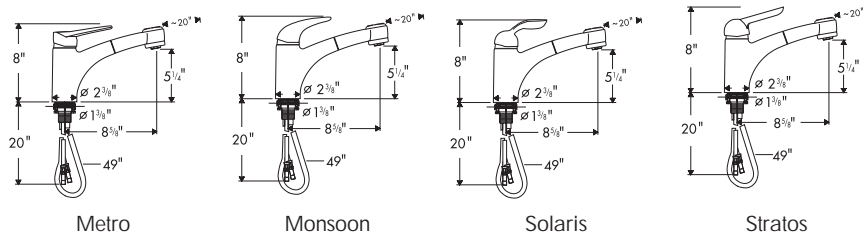

### Models Covered

	<b>Metro</b>	<b>Monsoon</b>	<b>Solaris</b>	<b>Stratos</b>
KM with baseplate	06917XX0	06916XX3	06649XX0	06919XX2
KM w/o baseplate	06566XX0	06551XX0	06544XX0	06559XX0

### Product Specifications:

Hole size in mounting surface	Minimum 1-1/2" Maximum 1-5/8"
Maximum mounting surface depth	2-1/4"
Flow rate	2.2 GPM
Maximum incoming water pressure	145 PSI
Recommended incoming water pressure	22 - 72.5 PSI
Recommended incoming hot water temp	120° - 140° F*
M3 cartridge with high temperature limit stop	

\*Some governing bodies require that the water heater be set to 120°F or less. Please know and follow all applicable local codes when setting the temperature on the water heater.

### *Prepare for installation*

- Read the instructions thoroughly.
- Inspect the faucet to make sure that it is in good condition, and that all parts are present.
- Insure that you have the tools, supplies, and parts necessary to complete the installation.
- The supply hoses on this faucet require 3/8" compression fittings. Purchase the compression fittings and any parts required to adapt your existing water supplies to them.
- Flush the supply lines of debris.

### *Install the baseplate (if using)*

The baseplate is only included with models 06917XX0, 06916XX3, 06649XX0, 06919XX2..

NO ADDITIONAL PARTS ARE NECESSARY IF YOU DECIDE THAT YOU DO NOT WISH TO INSTALL THE FAUCET WITH THE BASEPLATE

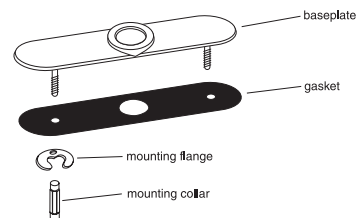

Position the baseplate and gasket on the faucet deck. From under the sink, install the mounting flanges and tighten the mounting collars by hand.

The baseplate can be used on a kitchen sink with less than three holes. Remove and discard the threaded studs on the bottom of the baseplate. Align the baseplate and the gasket visually.

### *Install the faucet*

- Leave the rubber washer in place on the faucet. Remove the slide washer, metal washer, and collar nut from the faucet shank and place in a safe, convenient location.
- Feed the supply lines, handspray hose, and faucet shank through the hole. From underneath the sink, install the plastic washer\*, slide washer, and metal washer. Thread on the collar nut loosely.

\*If the total thickness of the mounting surface is greater than 1-3/8", or if there is insufficient space available, omit the plastic washer.

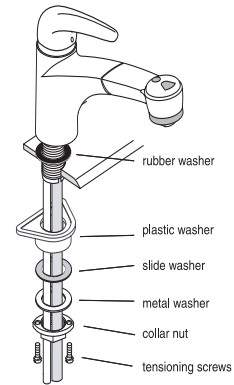

- From above the sink, inspect the placement of the faucet and base-plate. Reposition if necessary.
- Check the swivel of the faucet spout - it should swivel equally to the right and to the left. If it appears to swivel more to one side than to the other, pivot the faucet body until the swivel is even.
- When you are satisfied that everything is oriented properly, finish tightening the collar nut. Tighten the tensioning screws.

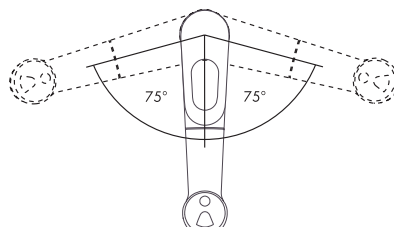

### *Connect the hot and cold supplies*

- Connect the hot and cold supply hoses to the supplies using 3/8" compression fittings (not included). Tighten wrench tight.

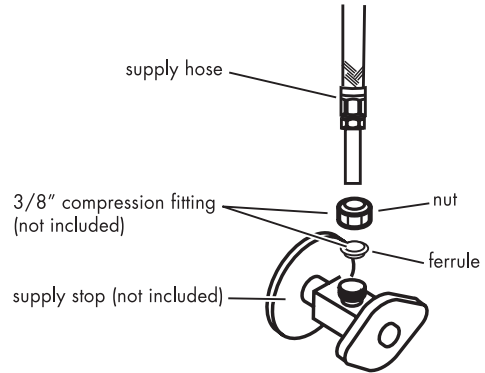

### *Connect the handspray hose*

- Loosen the compression fitting on the end of the flexible handspray hose.
- Slide it over the end of the metal hose supply tube as far as it will go.
- Hold the hose still with a 12mm wrench. Use a 17 mm wrench to tighten the nut. **DO NOT ALLOW THE HOSE TO TWIST - A TWISTED HOSE WILL REDUCE THE FLOW OF WATER TO THE HANDSPRAY.**

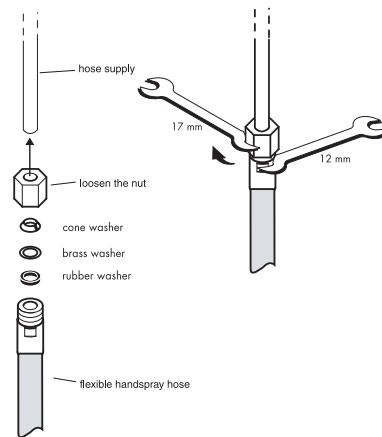

### Set the High Temperature Limit Stop (optional)

- Remove the decorative flange.
- Remove the handle screw from the stem of the cartridge.

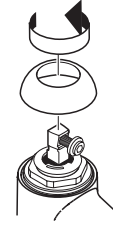

- Remove the high temperature limit stop.

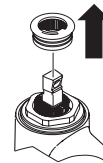

- Replace the high temperature limit stop so that the pin is in the desired notch. The temperatures marked on the diagram assume an incoming hot water temperature of 140° F and an incoming cold water temperature of 50° F, and a water pressure of 45 psi. Your high temperature will vary according to your conditions.

- Replace the nut cover.

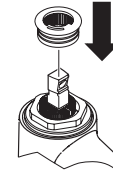
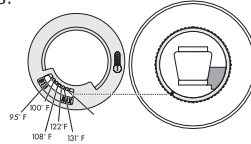

6

### Install the handle

- If the handle screw was removed while re-setting the high temperature limit stop, thread it onto the M3 stem 4 complete turns.
- Slide the handle over the stem and screw. Use the enclosed 4 mm hex wrench to finish tightening the screw. Turn the handle to one side to more easily access the screw.
- Install the screw cover.

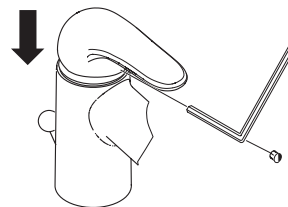
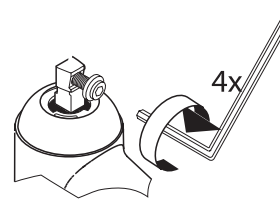

6

***Install the hose weight:***

- Proper installation of the hose weight will insure that the handspray hose retracts smoothly.
- On the handshower side of the hose, use a ruler to measure 15" down from the body of the faucet. Install the hose weight at this point.
- Pull out on the handspray, and guide it back into the faucet. It should move easily and retract smoothly. Reposition the hose weight if necessary.
- At this point, also make sure that the hot and cold supply hoses do not interfere with movement of the hose. They can be repositioned slightly if necessary.

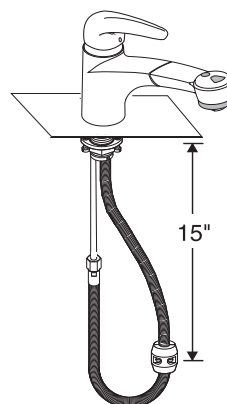

***Turn on the water. Check all connections for leaks. Check the faucet for proper operation.***

***Troubleshooting Information:***

Problem	Possible Cause	Solution
too little water	debris in aerator debris in hose filter kinked handspray hose	remove and clean aerator remove and clean hose filter straighten handspray hose
handle hard to turn	cartridge dirty or faulty	replace cartridge
faucet drips	cartridge dirty or faulty	replace cartridge
too little hot water	high temperature limit stop set incorrectly	re-set high temperature limit stop
water under sink	handspray hose connection loose  pinhole in hose crack in handspray	tighten hose to handspray  replace hose replace handspray

**Replacement Parts:**

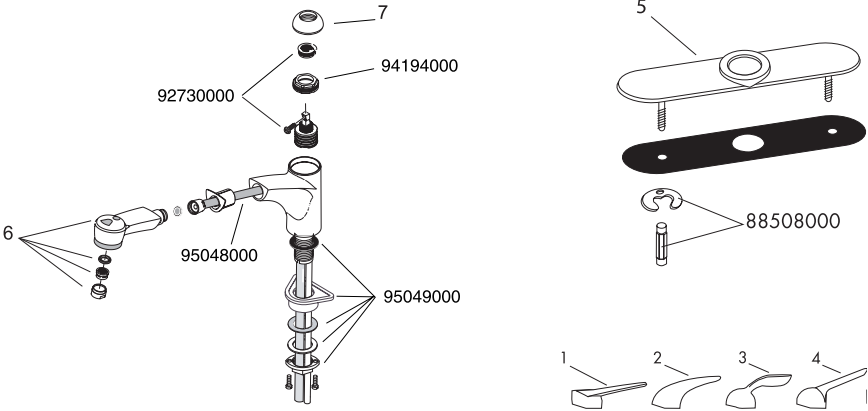

	chrome	steel optik
1 Metro handle	06843000	06843860
2 Monsoon handle	06841000	06841860
3 Solaris handle	06840000	06840860
4 Stratos handle	06842000	06842860
5 Baseplate	88525000	88525860
6 Sprayhead	14893001	14893861
7 Nut cover	96391000	96391860



### ***Cleaning Recommendation for Hansgrohe Products***

Modern faucetry and shower products utilize a combination of materials to comply with the needs of the market with regard to design and functionality.

To avoid damage, it is necessary to use some caution when cleaning. Damage caused by improper treatment is not covered under the Hansgrohe warranty.

### ***Cleaning Materials for Faucets and Showers***

- To remove lime scale, use only products made specifically for that purpose. Always follow the manufacturer's instructions when using.
- Do not use cleaners that contain hydrochloric, formic, acetic, or phosphoric acids, as these will cause considerable damage to finishes and to plastic components.
- Never mix cleaning materials.
- Never use cleaners containing abrasives. Do not use abrasive cleaning cloths, pads, or sponges.

### ***Cleaning Procedures***

- Clean your faucets and shower products as and when required. Regular cleaning will prevent scale buildup and water spotting.
- Follow the label instructions. Do not allow any cleaner to remain on the product for longer than necessary.
- When using spray cleaners, spray first onto a sponge or cloth – do not spray directly onto the product.
- After cleaning, rinse thoroughly with clear water to remove any cleaner residue.

### ***Important***

- Soap and shampoo residue can also cause damage to the product. Rinse well with clean water after use.
- If the surface is already damaged, harsh cleaning materials will cause further damage.

### ***Limited Lifetime Consumer Warranty***

This product has been manufactured and tested to the highest quality standards by Hansgrohe, Inc. ("Hansgrohe"). This warranty is limited to Hansgrohe products which are purchased by a consumer in the United States after March 1, 1996, and installed in either the United States or Canada.

#### ***WHO IS COVERED BY THE WARRANTY***

This warranty extends to the original consumer purchaser only.

#### ***WHAT IS COVERED BY THE WARRANTY***

This warranty covers only your Hansgrohe manufactured product. Hansgrohe warrants this product against defects in material or workmanship as follows: Hansgrohe will repair at no charge for parts only or, at its option, replace any product or part of the product which proves defective because of improper workmanship and/or material, under normal installation, use, service and maintenance. If Hansgrohe is unable to provide a replacement and repair is not practical or cannot be timely made, Hansgrohe may elect to refund the purchase price in exchange for the return of the product.

#### ***LENGTH OF WARRANTY***

Replacement or repaired parts of products will be covered for the term of this warranty as stated in the following two sentences. If you are a consumer who purchased the product for use primarily for personal, family, or household purposes, this warranty extends for as long as you own the product and the home in which the product is installed. If you purchased the product for use primarily for any other purpose, including, without limitation, a commercial purpose, this warranty extends only (i) for 1 year, with respect to Interaktiv and Retroaktiv products, and (ii) for 5 years, with respect to AXOR, ShowerPower and Pharo products.

#### ***THIS WARRANTY DOES NOT COVER, AND HANSGROHE WILL NOT PAY FOR:***

- A. Conditions, malfunctions or damage not resulting from defects in material or workmanship.
- B. Conditions, malfunctions or damage resulting from (1) improper installation, improper maintenance, misuse, abuse, negligence, accident or alteration, or (2) the use of abrasive or caustic cleaning agents or "no rinse" cleaning products, or the use of the product in any manner contrary to the product instructions.
- C. Labor or other expenses for the disconnection or return of the product for warranty service, or for installation or reinstallation of the product.
- D. Accessories or related products not manufactured by Hansgrohe.

#### ***TO OBTAIN WARRANTY SERVICE***

Contact your Hansgrohe retailer, or write to Technical Service at:

Hansgrohe Inc.  
1492 Bluegrass Lakes Parkway  
Alpharetta GA 30004

Or, call Hansgrohe toll-free at (800) 334-0455.

In requesting warranty service, you will need to provide

1. The sales receipt or other evidence of the date and place of purchase.
2. A description of the problem.
3. Delivery of the product or the defective part, postage prepaid and carefully packed and insured, to Hansgrohe Inc. 1492 Bluegrass Lakes Parkway, Alpharetta, Georgia 30004, Attention: Technical Service, if required by Hansgrohe.

When warranty service is completed, any repaired or replacement product or part will be returned to you postage prepaid.

#### **EXCLUSIONS AND LIMITATIONS**

***REPAIR OR REPLACEMENT (OR, IN LIMITED CIRCUMSTANCES, REFUND OF THE PURCHASE PRICE) AS PROVIDED UNDER THIS WARRANTY IS THE EXCLUSIVE REMEDY OF THE PURCHASER. HANSGROHE NEITHER ASSUMES NOR AUTHORIZES ANY PERSON TO CREATE FOR IT ANY OBLIGATION OR LIABILITY IN CONNECTION WITH THIS PRODUCT.***

***HANSGROHE SHALL NOT BE LIABLE TO PURCHASER OR ANY PERSON FOR ANY INCIDENTAL, SPECIAL, OR CONSEQUENTIAL DAMAGES, ARISING OUT OF BREACH OF THIS WARRANTY OR ANY IMPLIED WARRANTY (INCLUDING MERCHANTABILITY).***

Some States do not allow the exclusion or limitation of incidental or consequential damages, so the above limitation or exclusion may not apply to you.

This warranty gives you specific legal rights, and you may have other rights which vary from State to State.

You may be required by law to give us a reasonable opportunity to correct or cure any failure to comply before you can bring any action in court against us under the Magnuson-Moss Warranty Act.

#### **PRODUCT INSTRUCTIONS AND QUESTIONS**

Upon purchase or prior to installation, please carefully inspect your Hansgrohe product for any damage or visible defect. Prior to installing, always carefully study the enclosed instructions on the proper installation and the care and maintenance of the product. If you have questions at any time about the use, installation, or performance of your Hansgrohe product, or this warranty, please call or write to us at the toll-free number and address printed above.

**hansgrohe**

*Hansgrohe Inc.*

1490 Bluegrass Lakes Parkway

Alpharetta GA 30004

Phone 770 360 9880

Internet [www.Hansgrohe-USA.com](http://www.Hansgrohe-USA.com)