

FEATURES

- Brass construction
- Available with blade handle
- Push button diverter

**BATH AND SHOWER FAUCET TRIM
K-T948**

**ALSO K-T949, K-T950, K-951, K-952,
K-304, K-305**

ADA

CODES/STANDARDS APPLICABLE

Specified model meets or exceeds the following:

- ASME/ANSI A112.18.1M
- ASSE/ANSI 1016
- CSA B125
- IAPMO/UPC

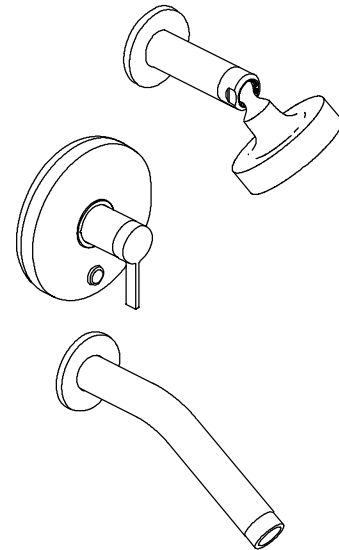

COLORS/FINISHES

- CP Polished Chrome
- Other Refer to Price Book for additional finishes

SPECIFIED MODEL: For complete faucet, both faucet trim and Rite-Temp valve must be specified.



Model	Description	<input type="checkbox"/> CP	<input type="checkbox"/> Other ____
K-T948-4	Bath and Shower Trim, Blade Handle	<input type="checkbox"/> CP	<input type="checkbox"/> Other ____
K-T949-4	Shower Only Trim, Blade Handle	<input type="checkbox"/> CP	<input type="checkbox"/> Other ____
K-T950-4	Valve Only Trim, Blade Handle	<input type="checkbox"/> CP	<input type="checkbox"/> Other ____
K-951	Shower Head, Arm and Flange	<input type="checkbox"/> CP	<input type="checkbox"/> Other ____
K-952	Bath Spout	<input type="checkbox"/> CP	<input type="checkbox"/> Other ____

Required Accessory on Page 2.

PRODUCT SPECIFICATION:

Rite-Temp pressure-balancing single-control bath and shower faucet trim shall be of brass construction. Bath and shower trim shall include showerhead with arm and flange, 8-3/4" (22.2cm) non-diverter spout with N.P.T. connection, and faceplate with handle and push-button diverter. Shower only trim shall include showerhead with arm and flange, and faceplate with handle. Valve only trim shall include faceplate with handle. Faucet trim shall be K-T____-____-____ and Rite-Temp valve shall be K-____-____-NA.

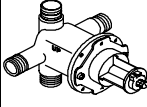
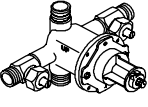
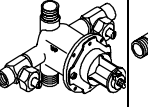
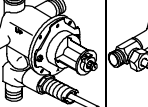
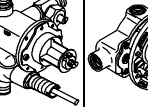
STILLNESS™

Required Accessory							
K-304-K	Rite-Temp Valve Without Stops	<input type="checkbox"/> NA					
K-304-KS	Rite-Temp Valve With Stops		<input type="checkbox"/> NA				
K-304-KP	Rite-Temp Valve With PVC Connections			<input type="checkbox"/> NA			
K-305-K	Rite-Temp Valve Without Stops				<input type="checkbox"/> NA		
K-305-KS	Rite-Temp Valve With Stops					<input type="checkbox"/> NA	
K-306-KS	HiFlow Rite-Temp Valve With Stops						<input type="checkbox"/> NA

PRODUCT INFORMATION



WARNING: Risk of damage to the K-306-KS valve assembly. When using the K-306-KS valve in a fiberglass or acrylic installation, use the thin wall installation kit (88526).

INSTALLATION NOTES

Install this product according to the installation guide. Avoid cross-flow conditions. Do not install shut-off device on either valve outlet. Cap shower outlet if deck-mount spout, diverter, or handshower is connected to spout outlet. Install straight pipe or tube drop of 7" (17.8cm) to 18" (45.7cm) with single elbow between valve and wall-mount spout.

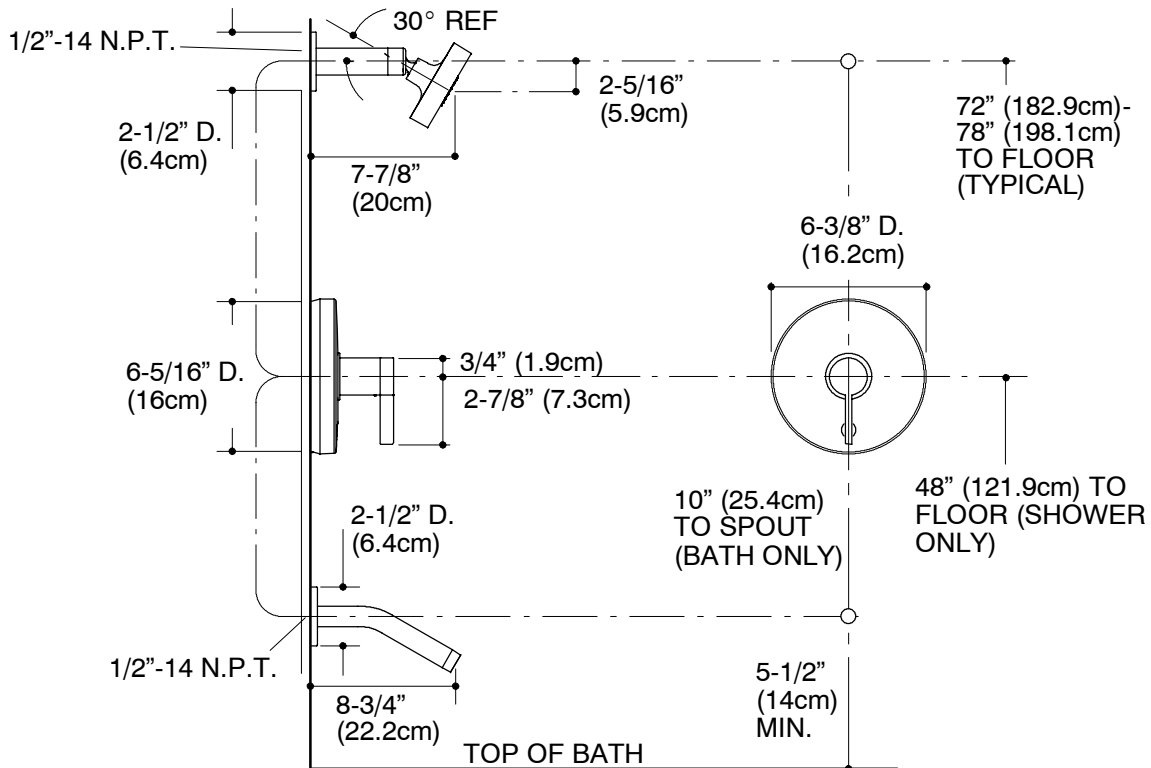

PRODUCT DIAGRAM