

**SHELF-BACK BATHROOM SINK
FAUCET
K-8040**

ADA **CSA B651** **OBC**

Features

- Brass construction
- Brass valve bodies
- Valvet® valves
- Pop-up drain with lift rod and tailpiece
- Available with standard Water-Guard® aerator
- For 5-1/2" (140 mm) centers
- Variety of handle style options
- 1-1/4" (32 mm) spout
- 2.0 gallons (7.6 L) per minute flow rate

Codes/Standards Applicable

Specified model meets or exceeds the following:



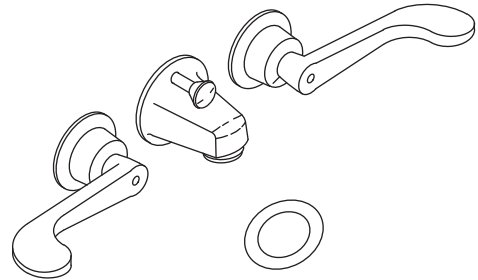

- ADA
- CSA B651
- OBC
- ASME A112.18.1/CSA B125.1
- NSF 61
- Energy Policy Act of 2005
- ICC/ANSI A117.1



Colors/Finishes

- CP: Polished Chrome

Specified Model

Model	Description		 ADA	 ADA	 ADA CSA B651 OBC
K-8040-2A	Shelf-back bathroom sink faucet with standard handles and standard aerator	<input type="checkbox"/> CP			
K-8040-3A	Shelf-back bathroom sink faucet with cross handles and standard aerator		<input type="checkbox"/> CP		
K-8040-4A	Shelf-back bathroom sink faucet with lever handles and standard aerator			<input type="checkbox"/> CP	
K-8040-5A	Shelf-back bathroom sink faucet with wristblade handles and standard aerator			<input type="checkbox"/> CP	

Product Specification

Shelf-back bathroom sink faucet shall be of brass construction. Faucet shall feature brass valve bodies and Valvet valves. Product shall include 5-1/2" (140 mm) centers, 1-1/4" (32 mm) spout, pop-up drain with lift rod and tailpiece. Product shall have a variety of handle style options available. Product shall include standard aerator. Faucet shall be rated at 2.0 gallons (7.6 L) per minute flow rate. Faucet shall be Kohler Model K-8040-____-CP.

TRITON®

Optional Accessories		
1160594	Large Spray 0.35 gpm (1.32 lpm) – Insert only	<input type="checkbox"/> NA
_____	Additional flow options are available (refer to the Price Book)	<input type="checkbox"/> NA

Installation Notes

Install this product according to the installation guide.

ADA, CSA B651, OBC compliant when installed to the specific requirements of these regulations.

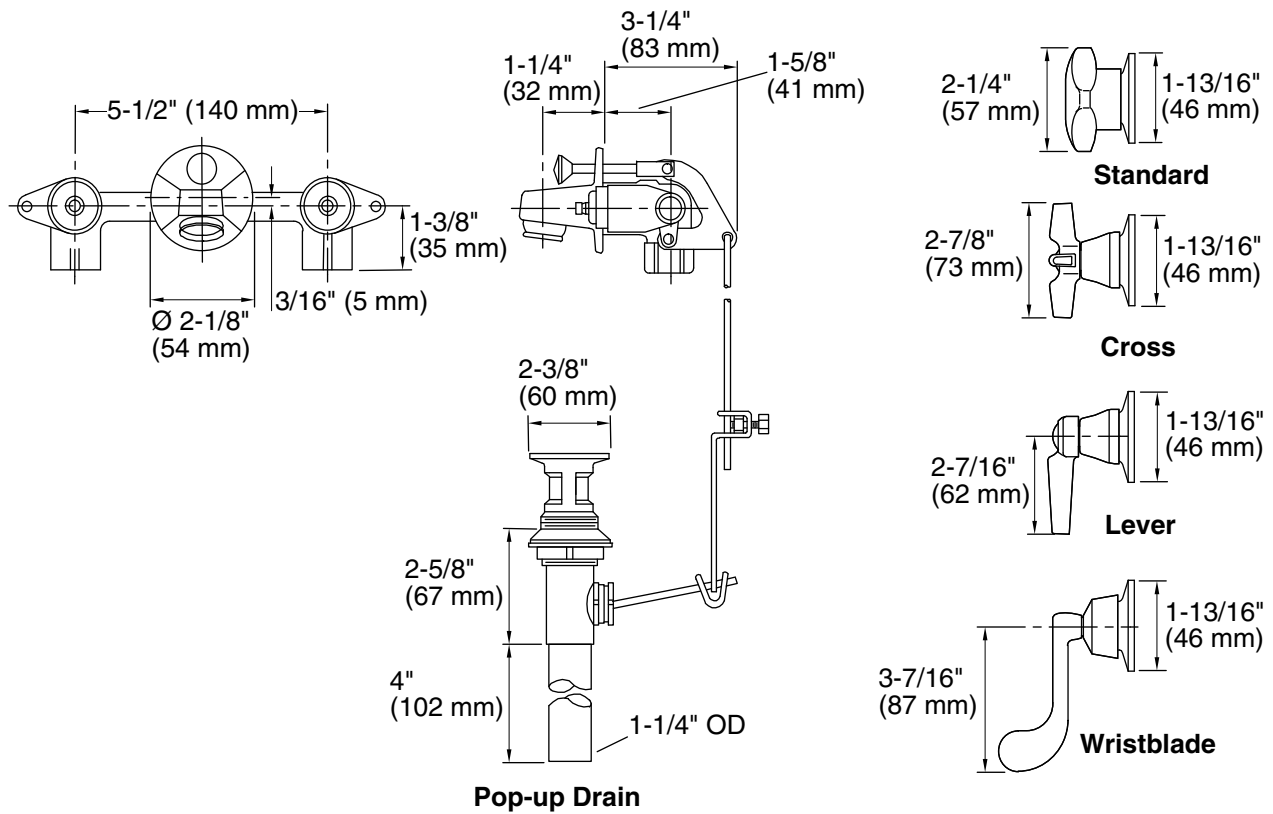

Product Diagram