

Installation Guide

del Number:_____



Mexico: 001-800-456-4537
www.kohler.com

Required Tools

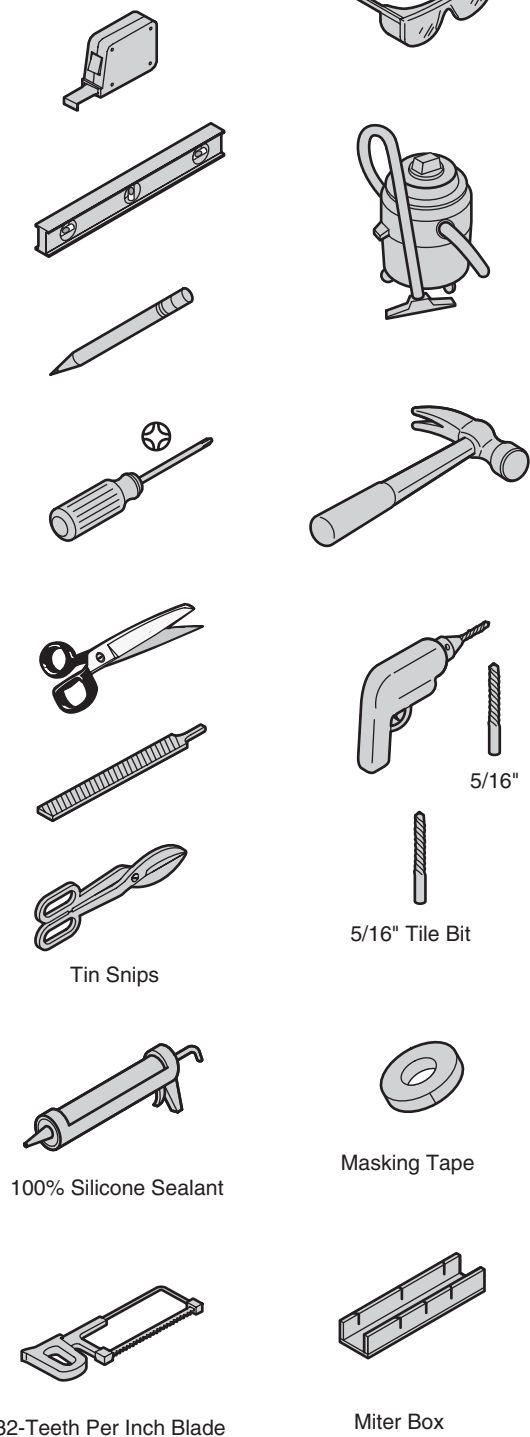

Parts Identification

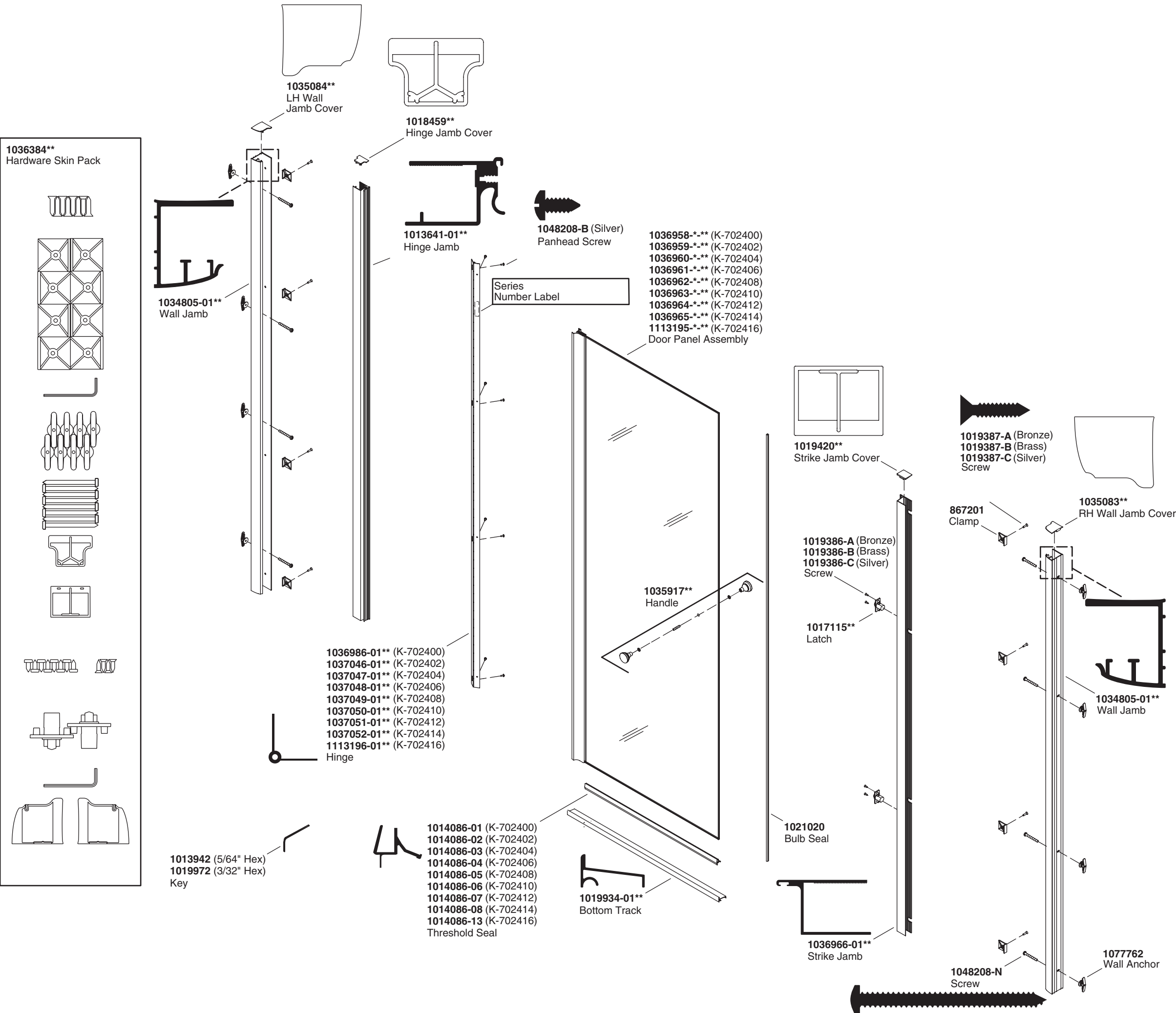

- Walls must be within 3/8" (10 mm) of plumb.
- Cover drain with tape to avoid loss of small parts.
- Follow the silicone sealant manufacturer's instructions for application and curing time.

- 1 Determine either a right or a left door pivot. The door handle installs on the same side as the showerhead.

2 Loosely attach four adjustment clamps to each wall jamb with flathead screws. Use the hex wrench provided. Do not tighten the screws at this time.

3 Center the wall jambs on the threshold and check the fit. If needed, snip and file the bottom edges of the wall jambs for a snug fit.

4 Using a level, plumb both wall jambs. Secure with masking tape. Mark the screw holes and the front edges of the wall jambs.

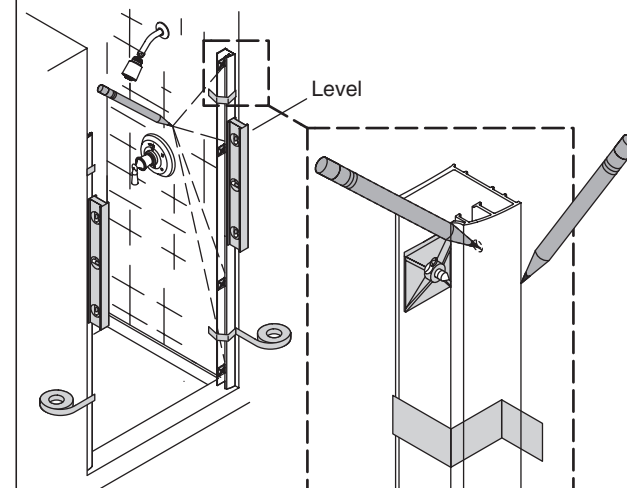
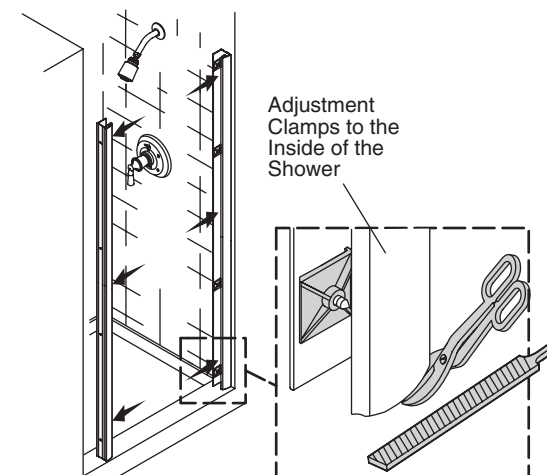
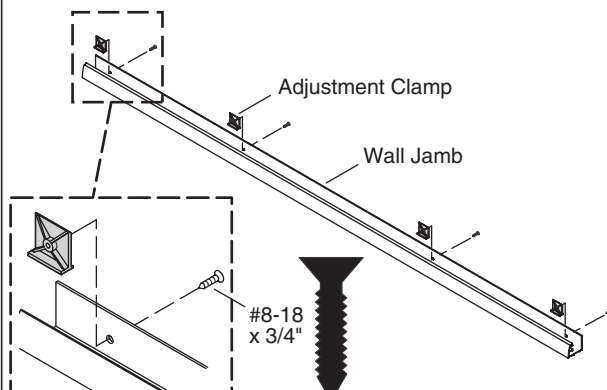
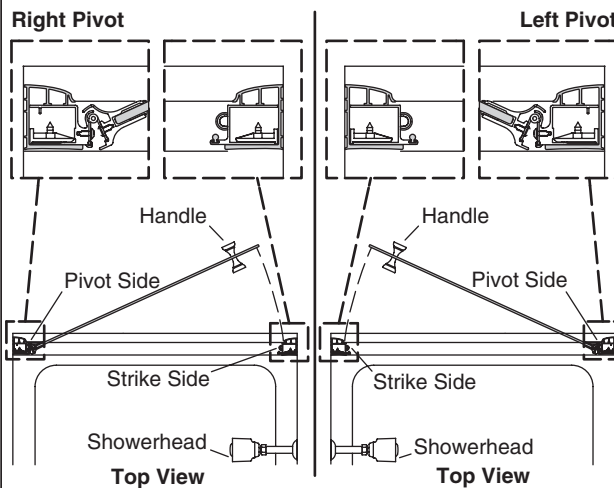

5 Remove the wall jacks. Drill 5/16" holes and insert anchors in both shower walls. For tile, use a 5/16" tile bit. Anchors will work in wall studs.

6 Realign and plumb both wall jacks. Secure with screws.

7 At the threshold, measure from the first stop on the inside of the strike wall jamb to the first stop on the inside of the hinge wall jamb (Dimension "A").

8 Cut the bottom track to dimension "A." Smooth the cut edge with a file. Verify bottom track fit between the wall jambs so the tall side of the bottom track is to the outside.

9 Apply silicone sealant along the groove on the underside of the bottom track.

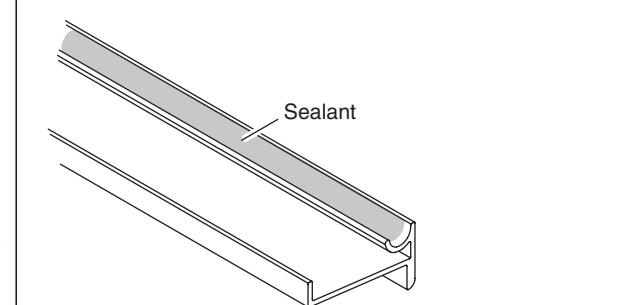
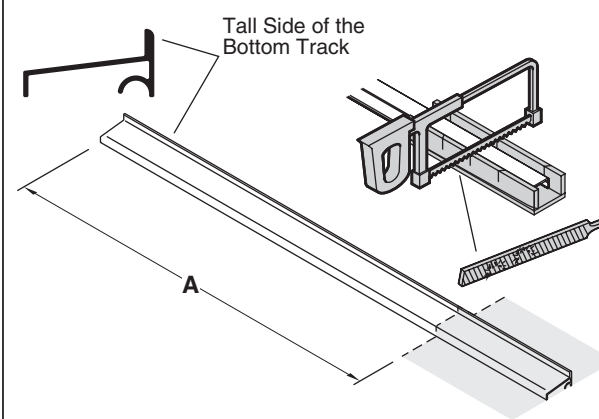
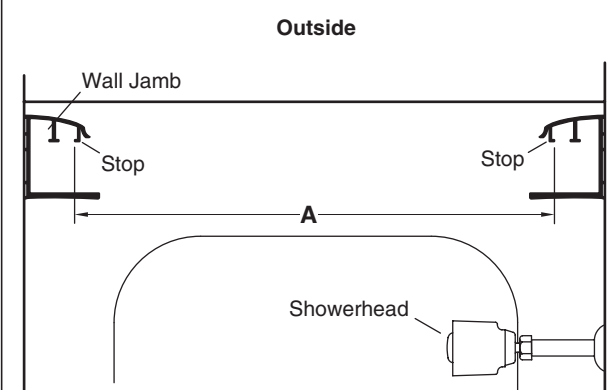
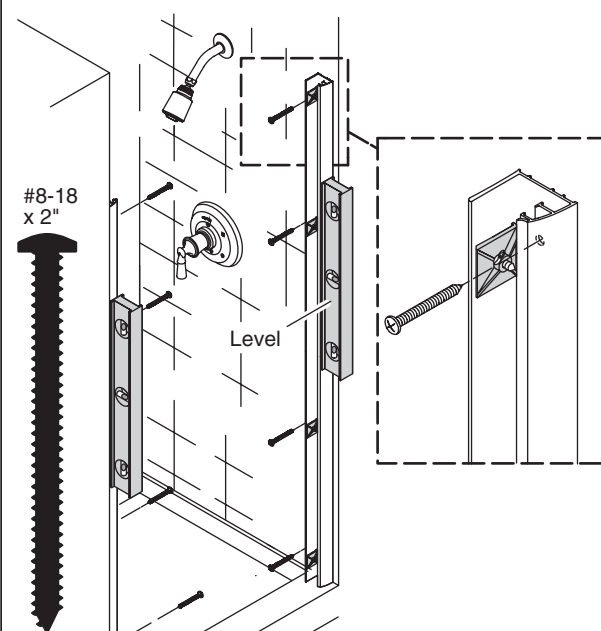
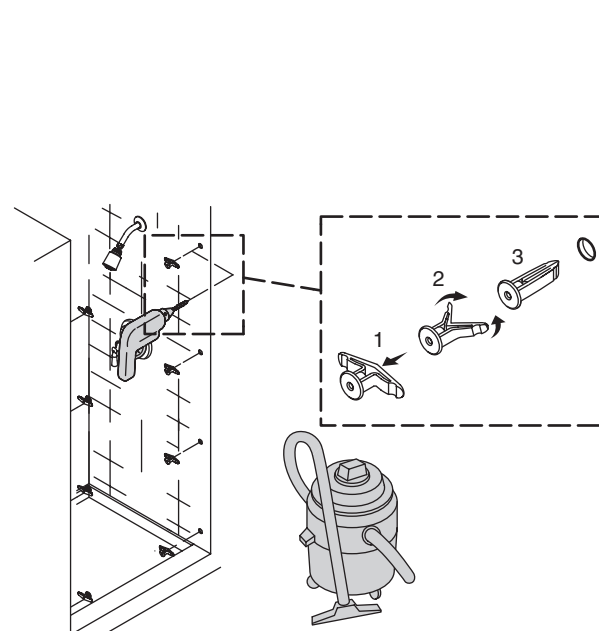

10

Position the bottom track on the threshold and between the first steps of the wall jambs. Make sure the tall side of the bottom track faces out. Tape the bottom track in place.

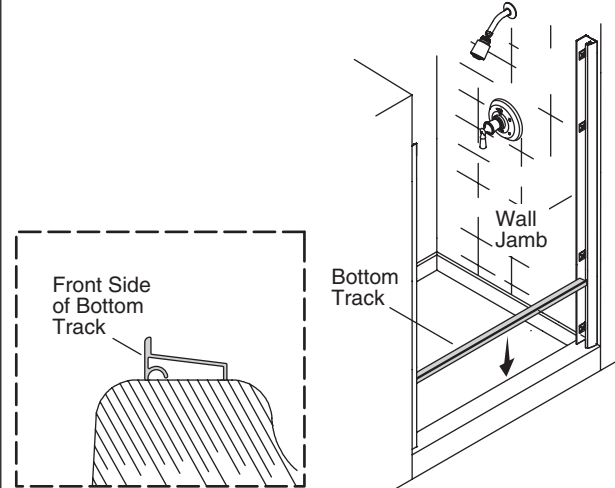

11

Lay the hinge jamb on a flat, protected surface. Insert the unslotted wing of the hinge into the hinge jamb groove. Use four screws to secure the hinge to the hinge jamb.

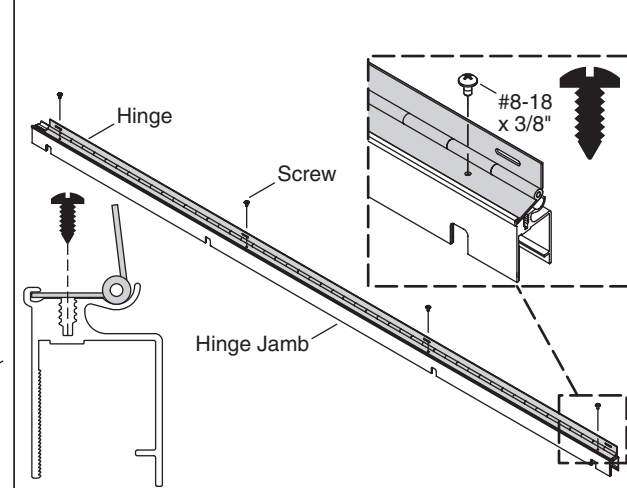

12

Align the hinge assembly even with the top of the channel. Secure the hinge to the door panel with the panhead screws. Install the hinge jamb cover to the hinge jamb.

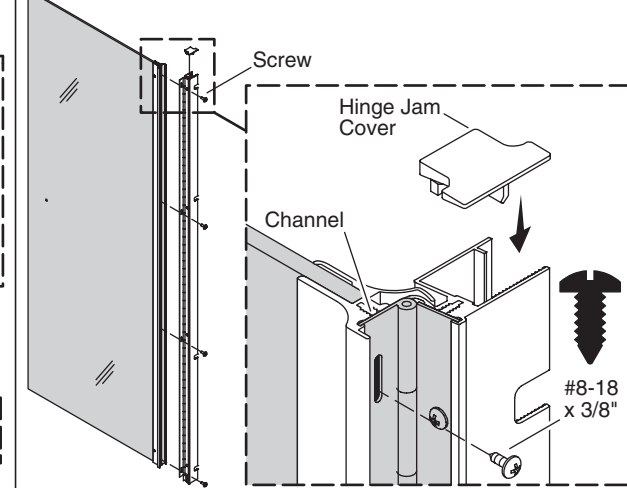

13

Lay the door panel on a flat, protected surface. Starting at the hinge end of the glass, press the threshold seal onto the bottom of the door panel.

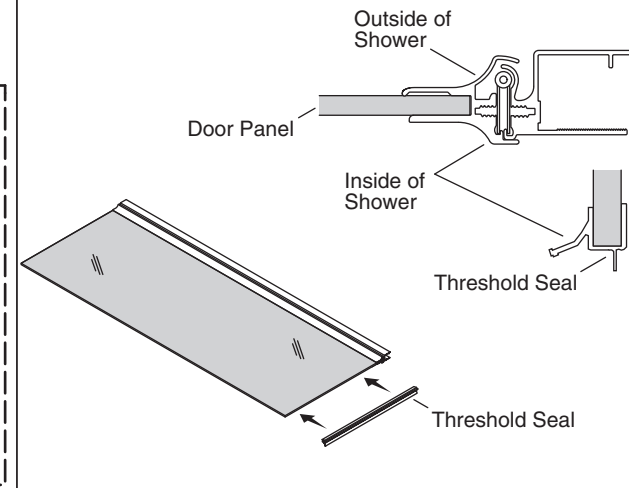

14

Position a latch in the strike jamb, and secure it in place with the two screws. Repeat for the second latch.

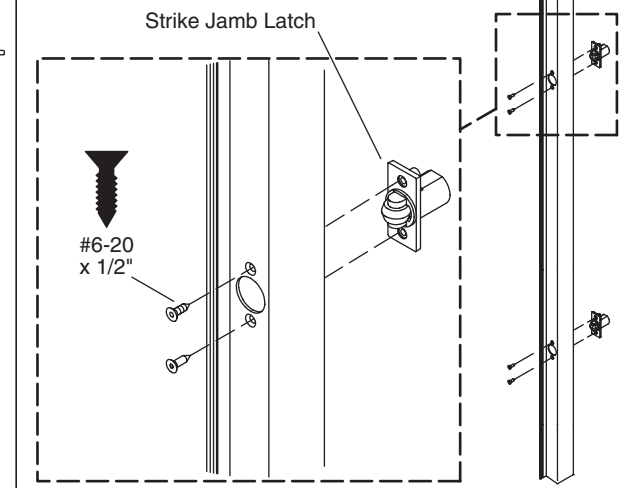

15

Fit the strike jamb into the wall jamb so the strike jamb slots fit over the adjustment clamp screws. Tighten the adjustment clamp screws. Install the strike jamb cover to the strike jamb.

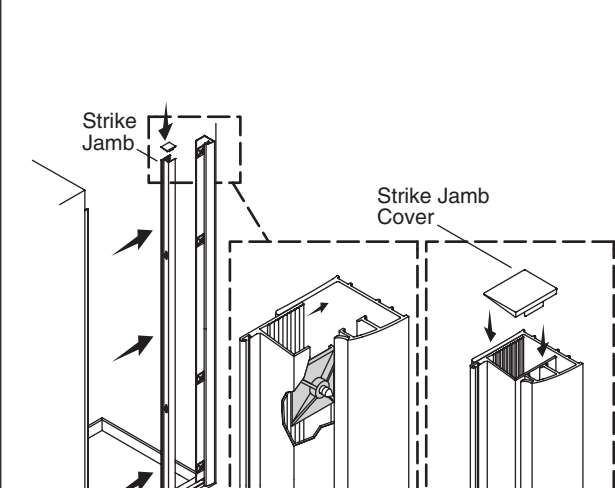

16

Make sure the strike seal is fully installed into the strike jamb channel until it contacts the bottom track. Cut off any excess seal material at the top.

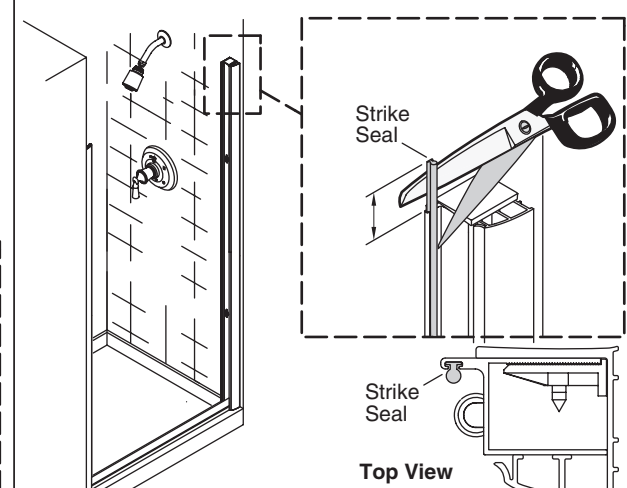

17

Lift the door panel into position, and fit the hinge jamb into the remaining wall jamb. Tighten the adjustment clamp screws to secure the door panel in place.

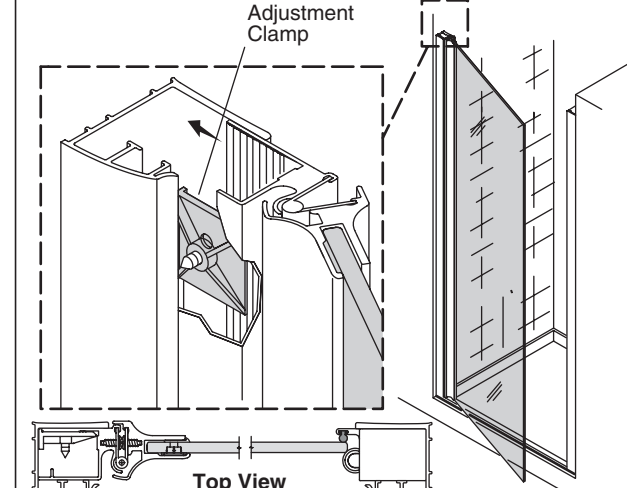

18

The gap between the edge of the glass and the strike jamb should be 3/16\" data-bbox="592 285 784 400"/>

19

Install the wall jamb covers to the top of the wall jambs so the flat edges are toward the wall.

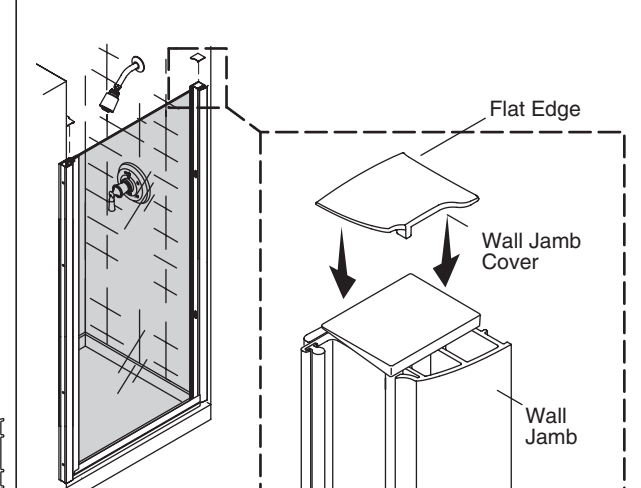

20

Assemble and install the door handles as shown, so the logo is to the outside. Hand tighten the handles so the logo is properly oriented.

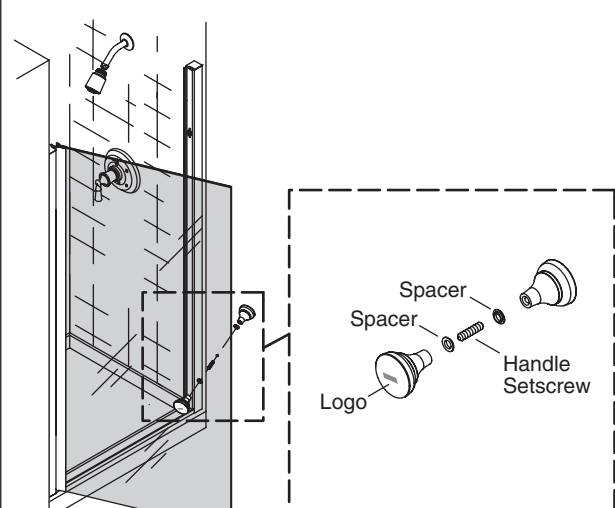

21

On the inside of the shower, apply silicone sealant where the wall jambs meet the walls and where the bottom track contacts the threshold.

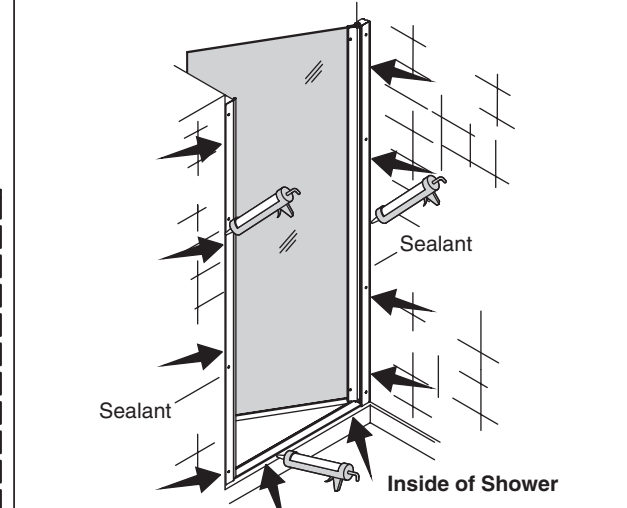

22

On the outside of the shower, apply silicone sealant where the wall jambs meet the walls and where the bottom track meets the threshold.

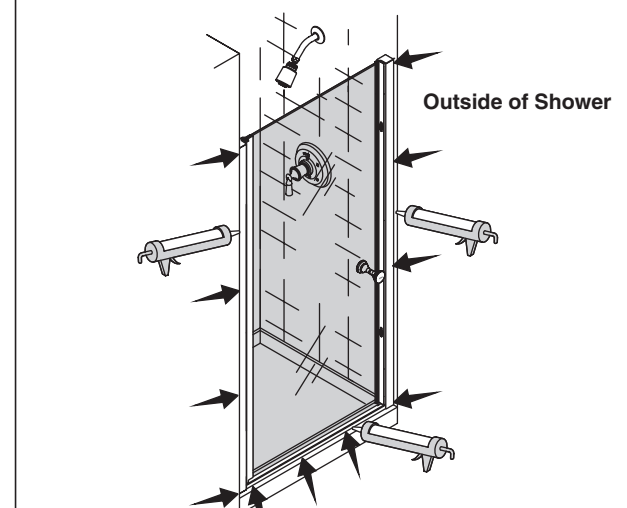

23

On the outside of the shower, apply silicone sealant to the seams between the bottom track and the hinge jamb, and the strike jamb and the bottom track.

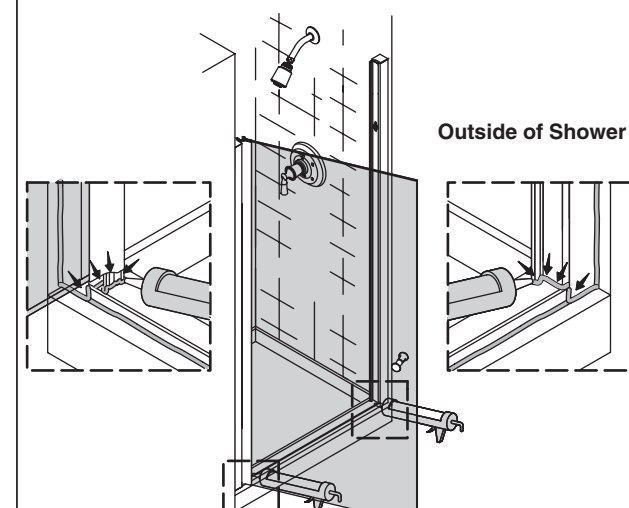

TROUBLESHOOTING	
Symptom: Installation	Recommended Action
1. The door does not close properly.	A. Make sure the door seal has been trimmed so a small gap exists on the handle side of the seal. See step 13. B. Check the hinge installation to verify that the hinge is properly installed into the hinge jamb groove. See step 11.
Symptom: Door Functionality	Recommended Action
1. Opening or closing the door panel is difficult.	A. Adjust the adjustment clamps to increase the gap between the door panel and the strike jamb. See step 18.
2. The door contacts the bottom track.	A. Adjust the adjustment clamps so the door panel opens evenly and does not contact the bottom track. See step 15.
Symptom: Water Leaks	Recommended Action
1. Water leaks under the door panel.	A. Verify the seal is in place. See step 13.
2. Water leaks past the strike jamb.	A. Adjust the door to decrease the gap between the door panel and the strike jamb. See step 18. B. Adjust the strike jamb so the door panel makes contact with the strike jamb. See step 15.
3. Water leaks under the bottom track.	A. From the outside of the shower, apply silicone sealant where the bottom track meets the threshold. See step 21.
4. Water leaks between the wall jamb and the wall.	A. From the outside of the shower, apply silicone sealant where the wall jamb meets the wall. See step 22.

WARRANTY

KOHLER plumbing products are warranted to be free of defects in material and workmanship for one year from date of installation.

Kohler Co. will, at its election, repair, replace or make appropriate adjustment where Kohler Co. inspection discloses any such defects occurring in normal usage within one (1) year after installation. Kohler Co. is not responsible for removal or installation costs. **Use of in-tank toilet cleaners will void the warranty.**

To obtain warranty service contact Kohler Co. either through your Dealer, Plumbing Contractor, Home Center or E-tailer, or by writing Kohler Co., Attn.: Customer Care Center, 444 Highland Drive, Kohler, WI 53044, USA, or by calling 1-800-4-KOHLER (1-800-456-4537) from within the USA and Canada, and 001-800-456-4537 from within Mexico, or visit www.kohler.com within the USA, www.ca.kohler.com from within Canada, or www.mx.kohler.com in Mexico.

IMPLIED WARRANTIES INCLUDING THAT OF MERCHANTABILITY AND FITNESS FOR A PARTICULAR PURPOSE ARE EXPRESSLY LIMITED IN DURATION TO THE DURATION OF THIS WARRANTY. KOHLER CO. AND/OR SELLER DISCLAIM ANY LIABILITY FOR SPECIAL, INCIDENTAL OR CONSEQUENTIAL DAMAGES. Some states/provinces do not allow limitations on how long an implied warranty lasts, or the exclusion or limitation of special, incidental or consequential damages, so these limitations and exclusions may not apply to you. This warranty gives you specific legal rights. You may also have other rights which vary from state/province to state/province.

This is Kohler Co.'s exclusive written warranty.