

Tub/Shower Trim Garniture pour Bain/Douche

Adorno para Bañera/Ducha

Models/Modelos/Modèles T17T086, T17T286 & T17T486 Series/Series/Seria

Tub/Shower



RP49760▲
Showerhead
Cabeza de Regadera
Pomme de Douche



RP46870▲
Shower Arm
Brazo de Regadera
Tuyau de Pomme de Douche



RP46872▲
Shower Flange
Pestaña de la Regadera
Collerette

RP53420▲
Escutcheon
(Diagonal Screw Holes)
Chapetón
(Huecos para los Tornillos Diagonales)
Rosace
(Trous de Vis en Diagonale)

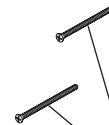
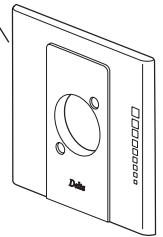

RP196▲
Trim Screws
Atornillos de Franja
Vis de Finition

RP50879▲
Trim Sleeve
Manga de Franja
Manchon de Finition



RP53422▲
Handle Assembly
Ensamble de la Manija
Poignée

RP50465
Set Screw & Wrench
Tornillo de Ajuste y Llave
Vis de calage et Clé

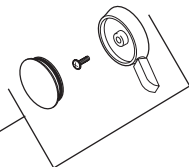

RP47201*
Cartridge Assembly
Cartucho
Cartouche



RP23336
O-Ring
Anillo "O"
Joint Torique



RP53421▲
Temperature Knob, Cover & Screw
Perilla de la Temperatura, Cubierta y Tornillo
Poigné de Réglage de Température et Vis

RP53419▲
Tub Spout/Pull-Up Diverter
Tubo de Salida para Bañera/
Botón Desviador de Alzar
Bec/avec dérivation à tirette

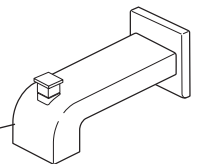

▲Specify finish / Especificar el Acabado / Préciser le fini

T17T086, T17T286, T17T486

51975 Rev. I

1-31-12

*Refer to page 2 for more information. / Consulte con la página 2 para más información. / Pour obtenir de plus amples renseignements, reportez-vous à la page 2.

Cartridge Summary Reference Sheet

Units shipped in March 2006 and after.

MultiChoice® 13/14



Order RP46074 to Replace Cartridge.

Units shipped before March 2006.

Old Monitor® 1300/1400



Order RP19804 to Replace Cartridge.

Replacement cartridges shipped in July 2006 and after.

New Monitor® 1300/1400



Order RP19804 to Replace Cartridge.

17

Grey Upper Cap



Order RP46463 to Replace Cartridge.

1700

White Upper Cap



Order RP32104 to Replace Cartridge.

NA

17T

Brass

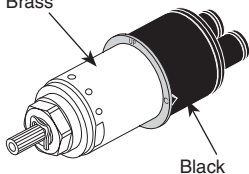

Order RP47201 to Replace Cartridge.

NA
Will Not Fit

NA