

# Tub/Shower Trim Garniture pour Bain/Douche

Adorno para Bañera/Ducha

Tub/Shower

Models/Modelos/Modèles T17055, T17155, T17255, T17455,  
T17255-H2O & T17455-H2O Series/Series/Seria



**RP34355▲**  
Showerhead  
Cabeza de Rogadora  
Pomme de Douche

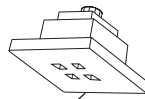

**RP51032▲**  
Showerhead  
Cabeza de Rogadora  
Pomme de Douche



**RP6023▲**  
Shower Arm  
Brazo de la Rogadora  
Tuyau de Pomme de Douche



**RP34356▲†**  
Shower Flange  
Pestaña de la Rogadora  
Collerette



**RP70172▲**  
Showerhead  
Cabeza de Rogadora  
Pomme de Douche

**RP196▲**  
Trim Screws  
Atornillos de Franja  
Vis de Finition

**RP12630▲**  
For Longer Screws  
Para Tornillos Más Grandes  
Pour Vis Plus Longues

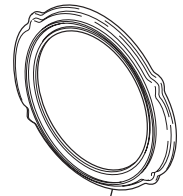

**RP34359▲**  
Trim Ring  
Aro de accesorio  
Anneau décoratif

**RP32105**  
Screw/Tornillo/Vis

**NOTE:** Do NOT overtighten screw  
**NOTA:** NO apriete demasiado el tornillo  
**NOTE:** NE serrez PAS trop la vis

**\*RP46463**  
Cartridge Assembly  
Cartucho  
Cartouche

**RP50880▲†**  
Trim Sleeve  
Manga de Franja  
Manchon de Finition

**RP28598**  
Decal (Red/Blue)  
Etiqueta (Rojo/Azul)  
Etiquette (Rouge/Bleu)

**RP32102**  
Rotational Limit Stop  
Tope para Limitar  
Butée Rotative

**RP23336**  
O-Ring  
Anillo "O"  
Joint Torique

**RP34354▲**  
Escutcheon  
Roseta  
Rosace avec Orifice



**RP32103▲**  
Handle Assembly  
Ensamble de la Manija  
Poignée

**RP26852**  
Spindle/Husillo/Tige

**A716▲**  
Victorian Accent

**A712**  
Traditional Accent

**RP34358▲**  
Temperature Knob and Cover  
Perilla de la Temperatura y Cubierta  
Poigné de Réglage de Température

**RP43028▲**  
Tub Spout/Non Diverter  
Tubo de Salida para Bañera/  
Sin Desviador  
Bec/Sans Dérivation

**RP34349▲†**  
Finial  
Pomo  
Grain

**RP34357▲**  
Tub Spout/Pull-Up Diverter  
Tubo de Salida para Bañera/  
Botón Desviador de Alzar  
Bec/avec dérivation à tirette

† Designates the accent color on split finish models  
† Designa el color para acentuar los modelos con acabados divididos  
† Désigne la couleur contrastante sur les modèles à deux finis

▲Specify finish / Especifique el Acabado / Précisez le fini

T17055, T17255, T17455, T17255-H2O & T17455-H2O 51975 Rev. I 1-27-12

\*Refer to page 2 for more information. / Consulte con la página 2 para más información. / Pour obtenir de plus amples renseignements, reportez-vous à la page 2.

# Cartridge Summary Reference Sheet

**Units shipped in March 2006 and after.**

## MultiChoice® 13/14

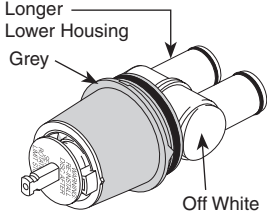

**Order RP46074 to Replace Cartridge.**

**Units shipped before March 2006.**

## Old Monitor® 1300/1400

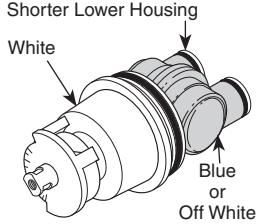

**Order RP19804 to Replace Cartridge.**

**Replacement cartridges shipped in July 2006 and after.**

## New Monitor® 1300/1400

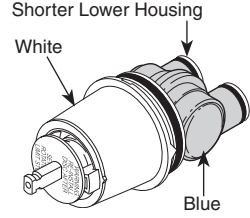

**Order RP19804 to Replace Cartridge.**

**17**

Grey Upper Cap

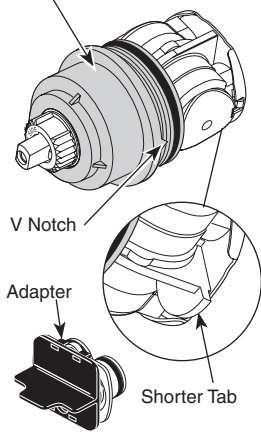

**Order RP46463 to Replace Cartridge.**

**1700**

White Upper Cap

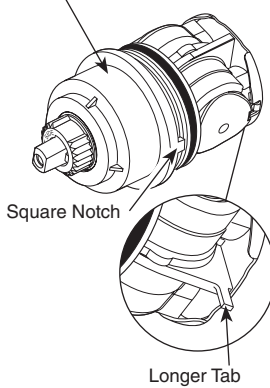

**Order RP32104 to Replace Cartridge.**

**NA**

**17T**

Brass

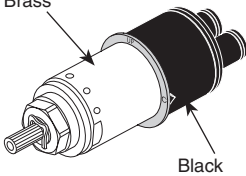

**Order RP47201 to Replace Cartridge.**

**NA**  
Will Not Fit

**NA**