

Rough Installation for Thread-On Spout Models

(See Illustrations B & C)

1. Apply thread sealant to end of spout nipple as shown in Illustration D. Thread this end of spout nipple into the spout.
2. Apply silicone sealant to the underside of the spout base. If your model does not have a base, apply silicone sealant to the underside of the spout.
3. Insert spout & nipple into the 1-1/4" hole in deck.
4. From underside of deck, slip brass washer and hex nut onto spout nipple and finger tighten hex nut against underside of deck surface.
5. From topside, align spout with tub. Wrench tighten hex nut from underneath. Wipe off excess sealant with soft cloth.

Installation Instructions for Flange

For Model 65

Remove the top hex nut on the end valves. Replace hex by turning hex nut 2 revolutions only. Apply silicone sealant to underside of handle flanges. Screw on flanges until they bottom out. Tighten bottom hex nut. This should allow the flange to seat properly on the finished surface.

For Models 22 & 26

Remove top hex nuts and washers. Apply silicone sealant to underside of flanges. Screw on flanges until they bottom out. Tighten bottom hex nuts. Wipe off excess sealant with soft cloth.

Cutting End Valve Stems

Temporarily place handle bodies on valve stems.

1. **For Model 65**—determine the amount of handle shank that will be exposed after the handle is installed. (See Illustration G). Measure the distance, "X", between this point on the handle shank and the top of the flange to determine the amount of valve stem that will be cut off. Subtract 1/16" as shown in Illustration G. **For Models 22 & 26**—the handle mounts flush to the plastic washer provided with kit. (See Illustration H).
2. Remove handle and flange. (If flange has already been permanently installed, protect flange with cloth). Cut off valve stem as shown in Illustration G or H. Remove burrs from the cut valve stem.
3. Reinstall handles and tighten screws.

Cutting Diverter Valve Stems and "All-Thread"

1. Thread the handle flange onto the "All-Thread" until it bottoms out. Measure and write down the distance between the bottom of the flange and the top of the finished surface. (See Illustration I). Add 1/16" from this distance. This will be referred to as the "X" distance.
2. Remove flange. Measure down from the top of the "All-thread" the "X" distance and mark a line on the "All-thread" at this point.
3. Cut the "All-thread" on the line that you marked, being careful not to damage the threads.
4. You are now ready to cut the diverter valve stem to the same height as the end valve stems. (Refer to "Cutting End Valve Stems" instructions). After cutting diverter valve stems, apply silicone sealant to underside of flange. Remove the top hex nut & washer if necessary to allow best fit of flange to mounting surface. Thread flange onto "All-thread" until it seals against the base.
5. Make connections for water supply lines according to Illustration C. on page 1.
6. Turn on water supplies, check for leaks and let lines flush for one minute without moving faucet handles. This will remove debris from lines which can damage internal parts of faucet and create leaks.

HOW TO CARE FOR YOUR BEAUTIFUL FAUCETS!

We suggest the following minimum maintenance for maximum enjoyment and use of your faucets.

All brass parts have been carefully finished and protected with Artistic Brass' exclusive Marine™ Protective Finish before leaving the factory. After each use, wipe the fitting gently with a damp cloth and blot dry with a soft towel. It is particularly important not to let water stand where the faucet contacts the counter, tub deck, or finished wall. Use only mild soap and water to clean your faucet. **NEVER USE ACIDS, HARSH ABRASIVES, OR DETERGENTS.** Failure to comply with these maintenance instructions may void the warranty.

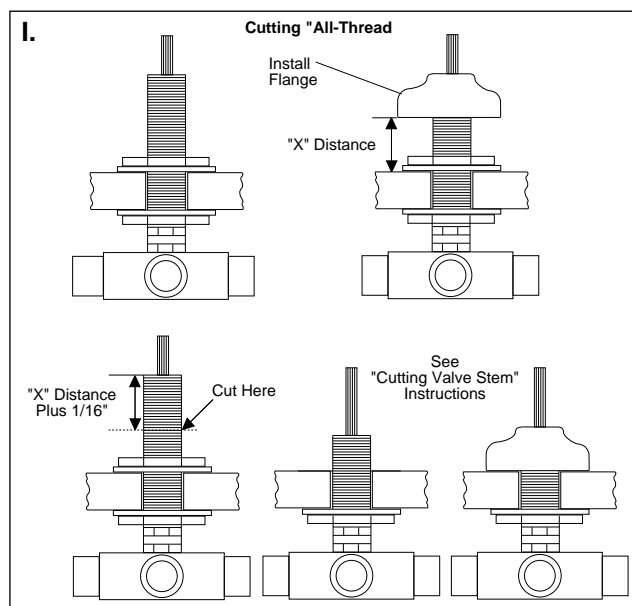
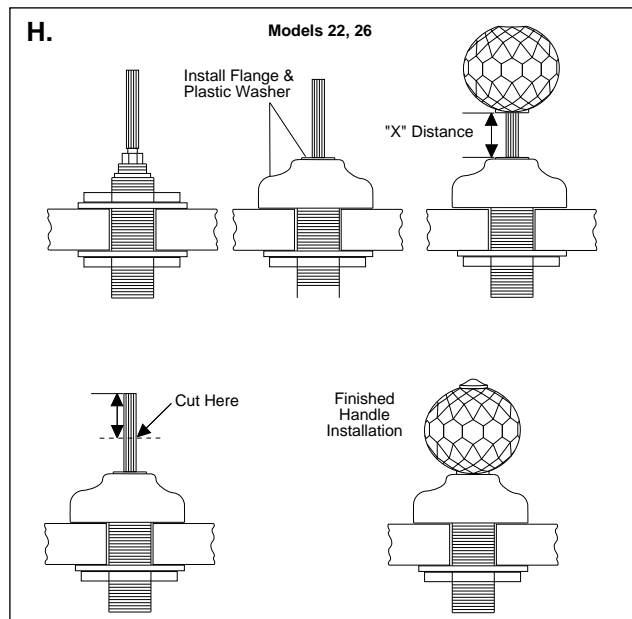
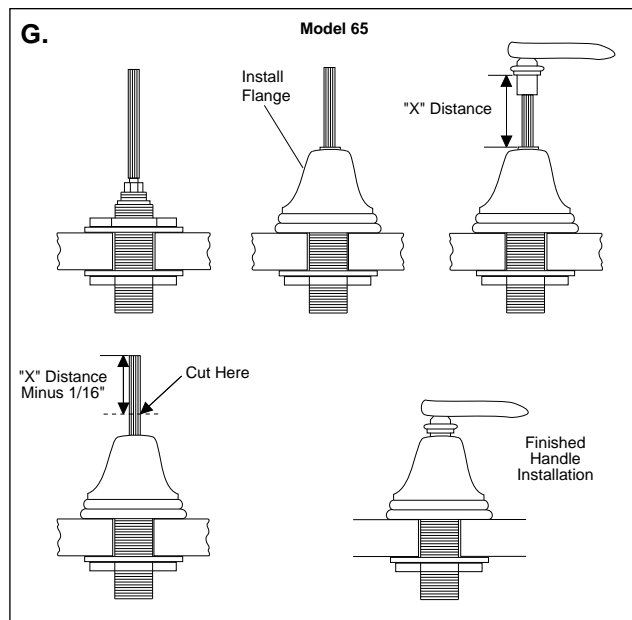

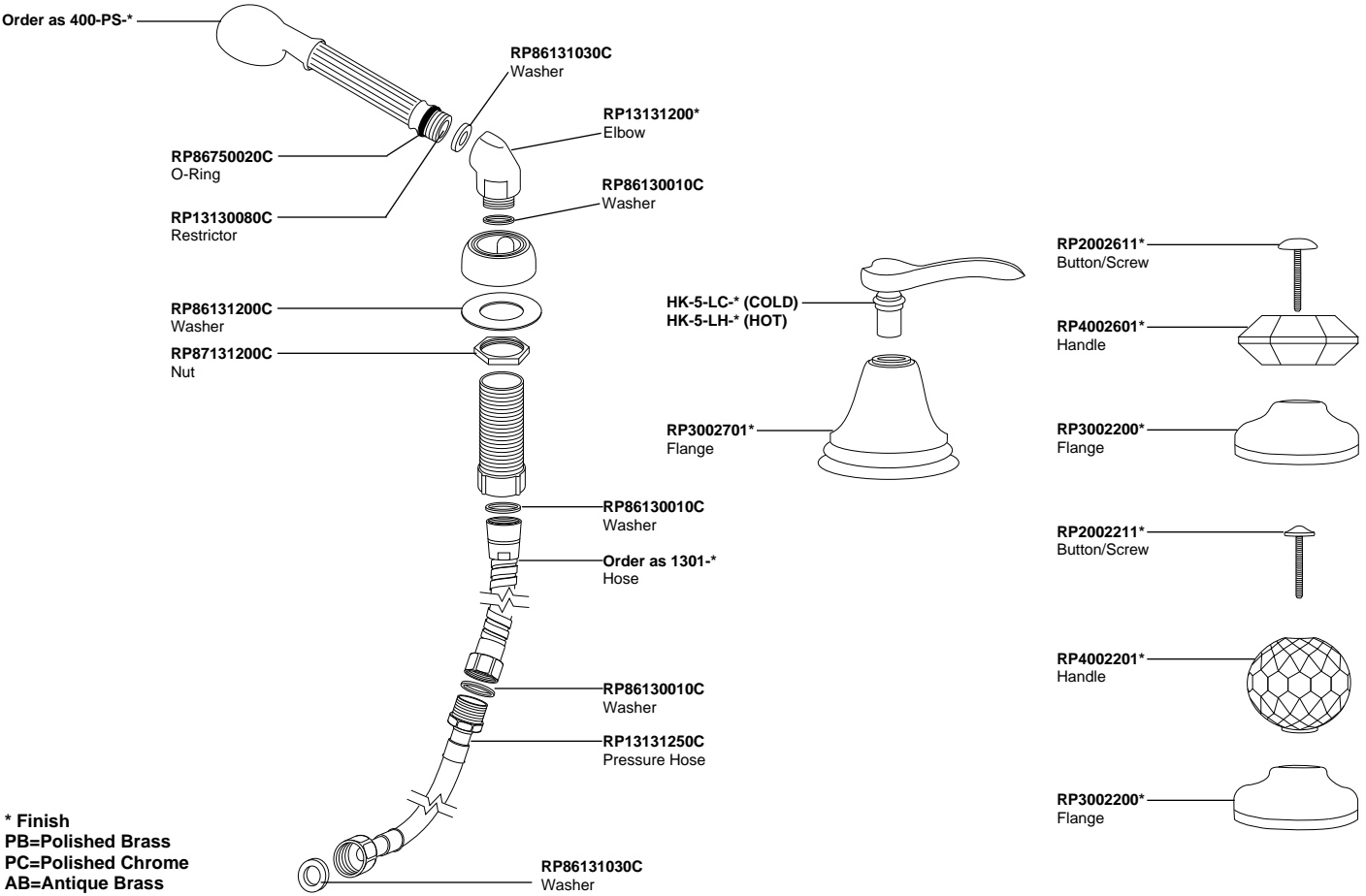
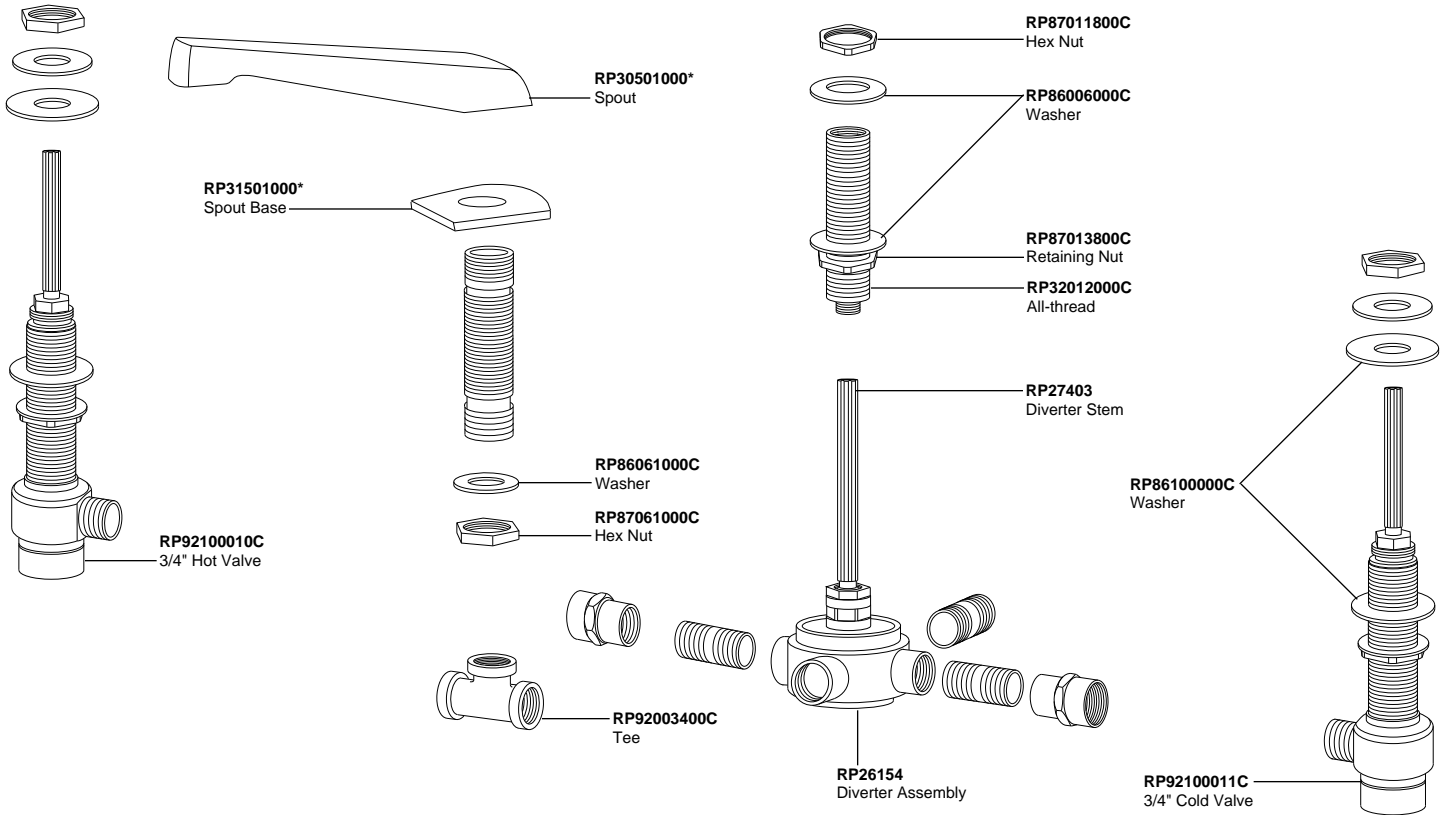

* Finish
 PB=Polished Brass
 PC=Polished Chrome
 AB=Antique Brass

INSTALLATION INSTRUCTIONS FOR HAND HELD SHOWERS.

IMPORTANT: Use Teflon® tape on all threaded connections.

INSTALLATION INSTRUCTIONS

Supply valve installation: Water supply is through diverter.

1. Install hose guide assembly on finished deck as shown in Figure 1. See Figure 1A & Figure 3 for additional information on hose guide installation.
2. Slide flexible metal hose through hose guide assembly and attach to 30" metal braided hose as shown in Figure 2.
3. Attach hand held showerhead unit to the end of the flexible metal hose as shown in Figure 4.
4. Attach the end of the metal braided hose to the diverter as shown in Figure 5.

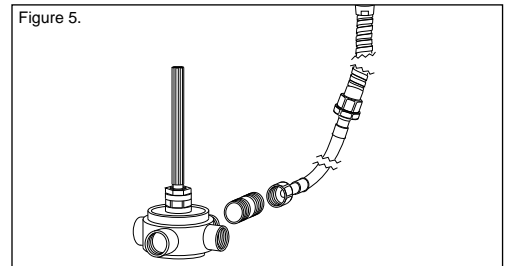
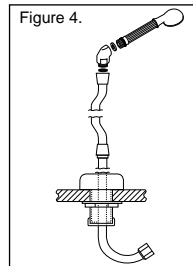
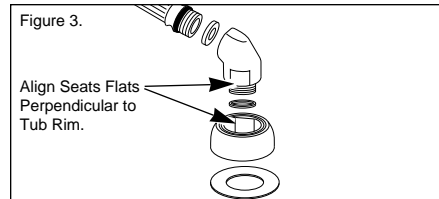
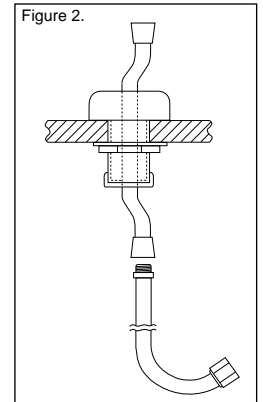
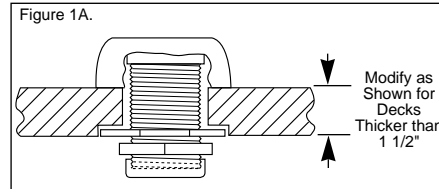
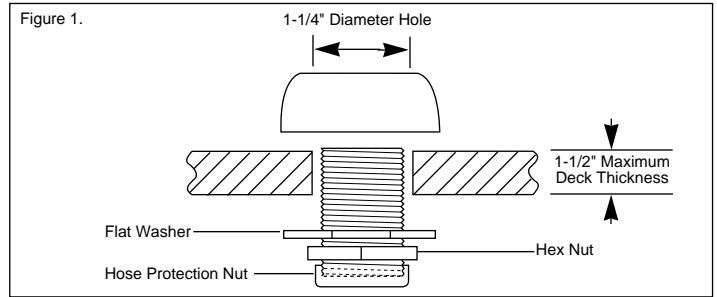

1/2" & 3/4" Hand-Held Shower Installation

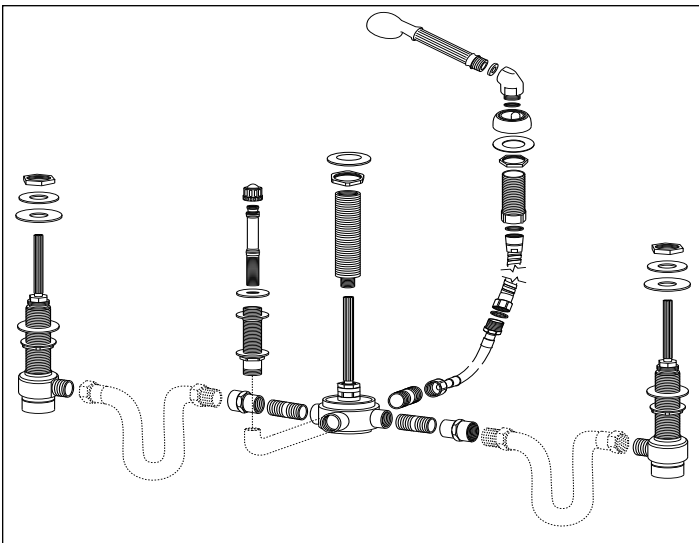

Artistic Brass® Faucet Company Lifetime Faucet and Finish Limited Warranty

All parts and finishes of the Artistic Brass® faucet are warranted to the original consumer purchaser to be free from defects in material and workmanship for as long as the original consumer purchaser owns their home. Artistic Brass® Faucet Company recommends using a professional plumber for all installation and repair. Artistic Brass® will replace, FREE OF CHARGE, during the warranty period, any part or finish which proves defective in material and/or workmanship under normal installation, use, and service. Replacement parts may be obtained by writing to:

Artistic Brass Faucet Company
Product Service
55 E. 111th Street
Indianapolis, IN 46280

This warranty is extensive in that it covers replacement of all defective parts and even finish, but these are the only two things that are covered. LABOR CHARGES AND/OR DAMAGE INCURRED IN INSTALLATION, REPAIR, OR REPLACEMENT AS WELL AS ANY OTHER KIND OF LOSS OR DAMAGE ARE EXCLUDED. Proof of purchase (original sales receipt) from the original consumer purchaser must be made available to Artistic Brass® for all warranty claims. THIS IS THE EXCLUSIVE WARRANTY BY ARTISTIC BRASS® FAUCET COMPANY, WHICH DOES NOT MAKE ANY OTHER WARRANTY OF ANY KIND, INCLUDING THE IMPLIED WARRANTY OF MERCHANTABILITY.

This warranty excludes all industrial, commercial, and business usage, whose purchasers are hereby extended a five year limited warranty from the date of purchase, with all other terms of this warranty applying except for the duration of the warranty. This warranty is applicable only to Artistic Brass® faucets made after January 1, 1996.

Some states do not allow the exclusion or limitation of incidental or consequential damages, so the above limitation or exclusion may not apply to you. Any damage to this faucet as a result of misuse, abuse, or neglect, or any use of other than genuine Artistic Brass® replacement parts WILL VOID THE WARRANTY.

This warranty gives you specific legal rights, and you may also have other rights which vary from state to state. It applies only for Artistic Brass® Faucets installed in the United States of America, Canada, and Mexico.

© 1997, Masco Corporation of Indiana

ARTISTIC BRASS™

A DIVISION OF MASCO CORPORATION OF INDIANA • ROUTE 46 WEST, P.O. BOX 47, GREENSBURG, INDIANA 47240