

IMPORTANT! Read entire instruction sheet before you start assembly and installation.

Parts List

PART #	QTY.	DESCRIPTION
A 600-0025	4	foot

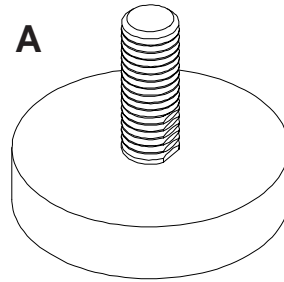

- 1 With Plasma TV off, lay Plasma cart down on its back side. Unfasten existing casters from the bottom of Plasma Cart.

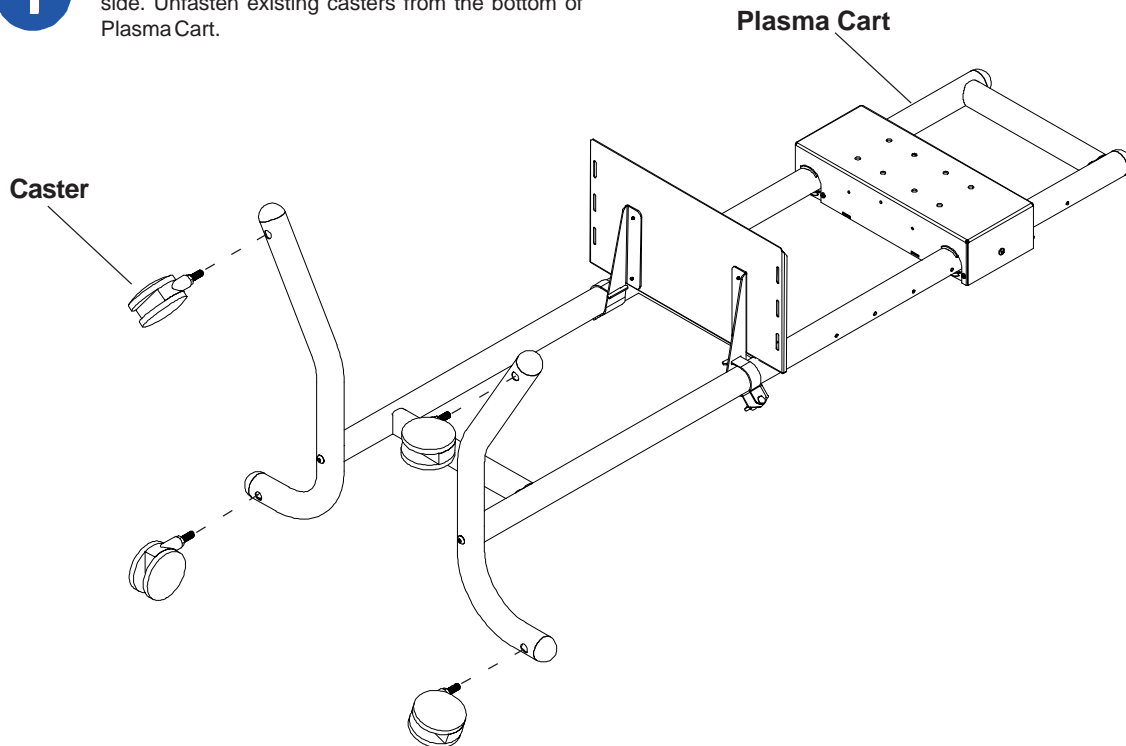

- 2** Screw four feet (A) to bottom of plasma cart. **Note:** Turn the feet (A) an equal amount of turns to keep it level.

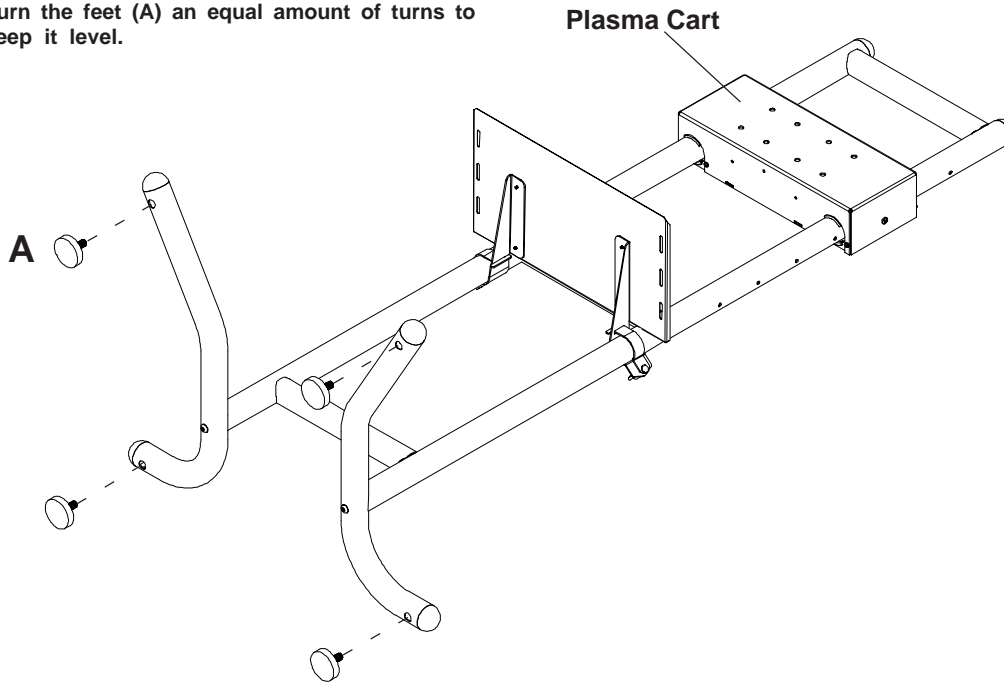

- 3** Stand Plasma Cart up and check to see if the cart is level. **Note:** Feet (A) can also be adjusted by using a wrench to lower or raise feet (A).

