

# WALL LEDGE

Maximum load claim 9 in CUBE: HOLDS UP TO 20 lbs (9 kg)  
7 in CUBE: HOLDS UP TO 15 lbs (6.8kg)  
5 in CUBE: HOLDS UP TO 10 lbs (4.5 kg)

## TOOLS NEEDED (Not included in product)



## HARDWARE (Included in product)

plastic dry wall anchor  
Size : 9mm Ø x 32mm L

philip head screws



mounting bracket

Anchor screw (6mm Ø x 25mm L)



Stud screw (6mm Ø x 30mm L)



## NOTE FOR STUD MOUNTING :

- Anchor is not necessary for stud mounting.
- Additional tool/hardware may be required for stud mounting, or if on wall surfaces other than dry wall. Consult your local hardware store.

## STEP 1

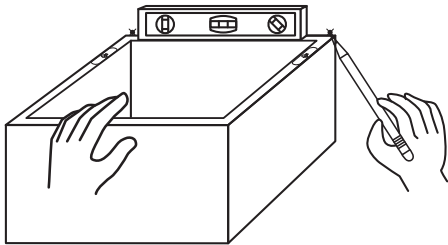

**1a**  
Drywall mounting: Choose a desired location. Mark mounting holes for anchors.

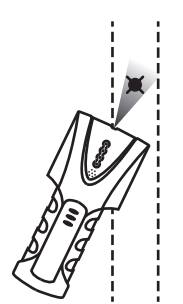

**1b**  
Stud mounting: Choose a desired location. Use a stud finder and mark the location of studs.

## STEP 2

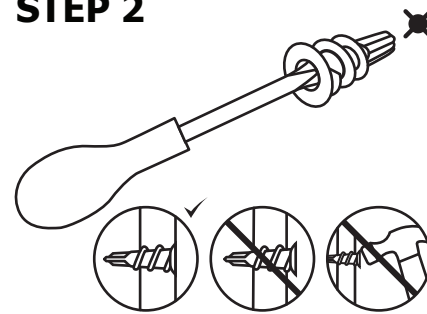

**2a**  
Drywall mounting: Tighten the anchors into dry wall with Philips screw driver until anchors are flush with the wall surface.

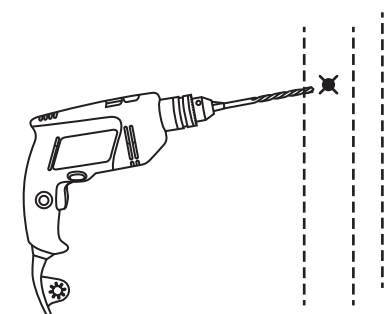

**2b**  
Stud mounting: Drill pilot hole and drive the stud screw into the pilot hole.

## STEP 3

Tighten screws into anchor(s) and the stud(s).

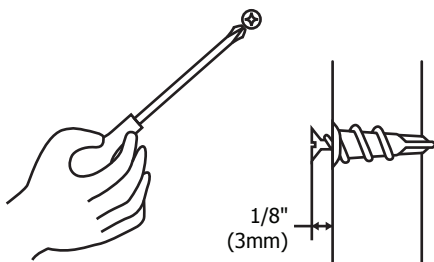

## STEP 4

Hang cube.

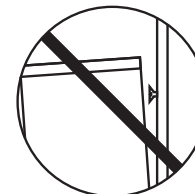
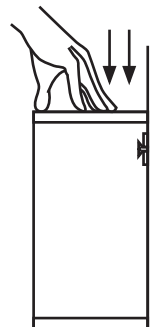

If cube cannot hang on to the screws, untighten the screws slightly and re-hang. Repeat as necessary.