



A Division of Troy-CSL Lighting, Inc.

ABEO - XE

Project _____

Fixture Type _____

Dimensions	Lamps	WT	BZ	BK	SA
70" 70½"L x 1"W x 1"H	13	XE-82-WT	XE-82-BZ	XE-82-BZ	XE-82-SA

ABEO - XE XE- 82



Finishes WT-White, BK-Black, BZ-Bronze, SA-Satin Aluminum

ABEO-XE FEATURES

SPECIFICATIONS:

Construction: Extruded Aluminum body available in 11 lengths up to 94" with molded plastic end caps.

Finish: Options include White, Bronze, Black and Satin Aluminum

Lens/Reflector: The lens is a molded frosted glass, the reflector is constructed of high grad semi-specular aluminum.

Lamps: Low voltage G-4 Bi-pin Xenon lamp. Lamps are available in 12V or 24V. 5W, 10W and 20W options, 6000 hour rated average life. Ordered separately

Lamp Socket: Porcelain G-4 socket with sliding glass lens for easy lamp replacement

Electrical: Remote transformer required, ordered separately. Transformers are available in 12V and 24V, electronic or magnetic options, 150W max @ 12V / 300W max @ 24V. Abeo is warranted using any UL or cUL transformer as long as voltage and wattage requirements are met.

Dimming: Abeo dims by matching the style of dimmer with the style of transformer (exp. Use low voltage magnetic dimmer when using a low voltage magnetic transformer)

Installation: Abeo is designed for installing into, under or above wood cabinets, display cases and shelves. The face of the fixture can be easily removed exposing holes for mounting screws and a 13 amp terminal block on each end allowing for low voltage electricity

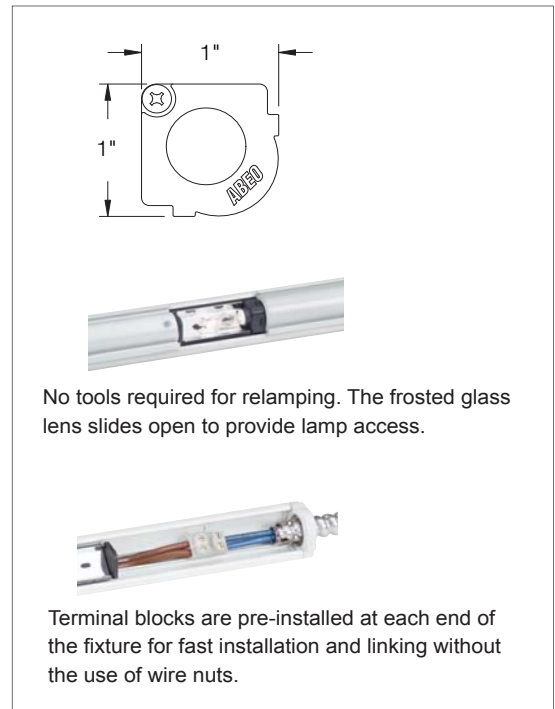

No tools required for relamping. The frosted glass lens slides open to provide lamp access.

Terminal blocks are pre-installed at each end of the fixture for fast installation and linking without the use of wire nuts.

to flow in or out of either side of extrusion. Each terminal block can accept up to 10 awg low voltage wire. Fixtures can be linked together using low voltage wire between fixtures keeping within voltage and wattage minimums and maximums. Included for installation: 2 terminal blocks (pre-installed), mounting screws and ½" flex connectors.

Listing: UL and cUL

Warranty: Abeo fixtures have a 1 year limited warranty on the fixture, lamps and transformers included from time of purchase from CSL.

ORDERING INFORMATION

Product Number	Finish	Lamp	Transformer	Example:
XE-10	WT (White)	L-160 (5W 12V)	please see back for transformer options	XE-28-BZ
XE-16	BZ (Bronze)	L-105 (10W 12V)		(4) L-105
XE-22	BK (Black)	L-161 (20W 12V)		T-118
XE-28	SA (Satin Aluminum)	L-108 (5W 24V)		
etc.		L-109 (10W 24V)		
		L-162 (20W 24V)		



ABEO - XE ACCESSORIES

ABEO-90 Corner connector provides a clean, convenient solution for 90° corners and attachment of flex conduit.

Corner Connector	WT	BZ	BK	SA
90° Corner Connector	ABEO-90-WT	ABEO-90-BZ	ABEO-90-BK	ABEO-90-SA









Xenon Lamps

Voltage	5 watt - 60 lumens	10 watt - 125 lumens	20 watt - 250 lumens
12	L-160	L-105	L-161
24	L-108	L-109	L-162

All lamps Clear; G4 base; 2,650°K

ELECTRONIC TRANSFORMERS

	Cat. No.	Wattage	Voltage	Description	Minimum Load	Dimensions	Weight
	ELVT-IV2	60W	12	Class 2, 60watt 12volt electronic transformer	10watt w/o dimmer 20watt w/ dimmer	1 3/8" x 1 1/4" x 2 3/8"	3 oz
	T-17ENCL	60W	12	Enclosed, 60watt 12volt electronic transformer	50watt	1 3/8" x 1 1/2" x 6 1/2"	1 lbs
	T-30BK (Black)	60W	12	Class 2, 60watt 12volt plug in electronic transformer	20watt	1 3/8" x 1 1/2" x 3 3/8"	3 oz
	T-30 (White)	60W	12	Class 2, 60watt 12volt plug in electronic transformer	20watt	1 3/8" x 1 1/2" x 3 3/8"	3 oz
	T-14ENCL	150W	24	Enclosed, 150watt 24volt electronic transformer	50watt	1 3/8" x 1 1/2" x 6 1/2"	1 lbs
	T-16ENCL	300W	24	Enclosed, 300watt 24volt electronic transformer	50watt	1 3/8" x 1 1/4" x 9 1/2"	1.5 lbs

MAGNETIC TRANSFORMERS

	Cat. No.	Wattage	Voltage	Description	Dimensions	Weight
	T-118	150W	12V	150 watt 12 volt E.I. laminated magnetic transformer, multi-tap with primary and secondary internal circuit protection	8 3/4" x 4 1/4" x 3 3/4"	15 lbs
	T-119	150W	24V	150 watt 24 volt E.I. laminated magnetic transformer, multi-tap with primary and secondary internal circuit protection	8 3/4" x 4 1/4" x 3 3/4"	15 lbs
	T-120	300W	12V	300 watt 12 volt E.I. laminated magnetic transformer, multi-tap with primary and secondary internal circuit protection	8 3/4" x 4 1/4" x 3 3/4"	15 lbs
	T-121	300W	24V	300 watt 24 volt E.I. laminated magnetic transformer, multi-tap with primary and secondary internal circuit protection	8 3/4" x 4 1/4" x 3 3/4"	15 lbs
	T-122	600W (2-300)	12V	600 watt 12 volt E.I. laminated magnetic transformer, multi-tap with primary and secondary internal circuit protection	9 1/2" x 6 1/4" x 4 3/4"	22 lbs
	T-123	600W	24V	600 watt 24 volt E.I. laminated magnetic transformer, multi-tap with primary and secondary internal circuit protection	9 1/2" x 6 1/4" x 4 3/4"	22 lbs
	T-124	300w	12V	300 watt 12 volt toroidal magnetic transformer, multi-tap with primary and secondary internal circuit protection	9 1/2" x 5 1/4" x 4 3/4"	15 lbs
	T-125	300W	24V	300 watt 24 volt toroidal magnetic transformer, multi-tap with primary and secondary internal circuit protection	9 1/2" x 5 1/4" x 4 3/4"	15 lbs
	T-126	600W (2-300)	12V	600 watt 12 volt toroidal magnetic transformer, multi-tap with primary and secondary internal circuit protection	10 1/2" x 6 1/4" x 5 3/4"	22 lbs
	T-127	600W	24V	600 watt 24 volt toroidal magnetic transformer, multi-tap with primary and secondary internal circuit protection	10 1/2" x 6 1/4" x 5 3/4"	22 lbs
	T-128	900W (3-300)	12V	900 watt 12 volt E.I. laminated magnetic transformer, multi-tap with primary and secondary internal circuit protection	10 1/2" x 6 1/4" x 5 3/4"	22 lbs