

# OWNER'S MANUAL

# IRONMAN

## IRONMAN MOJAVE MASSAGE TABLE

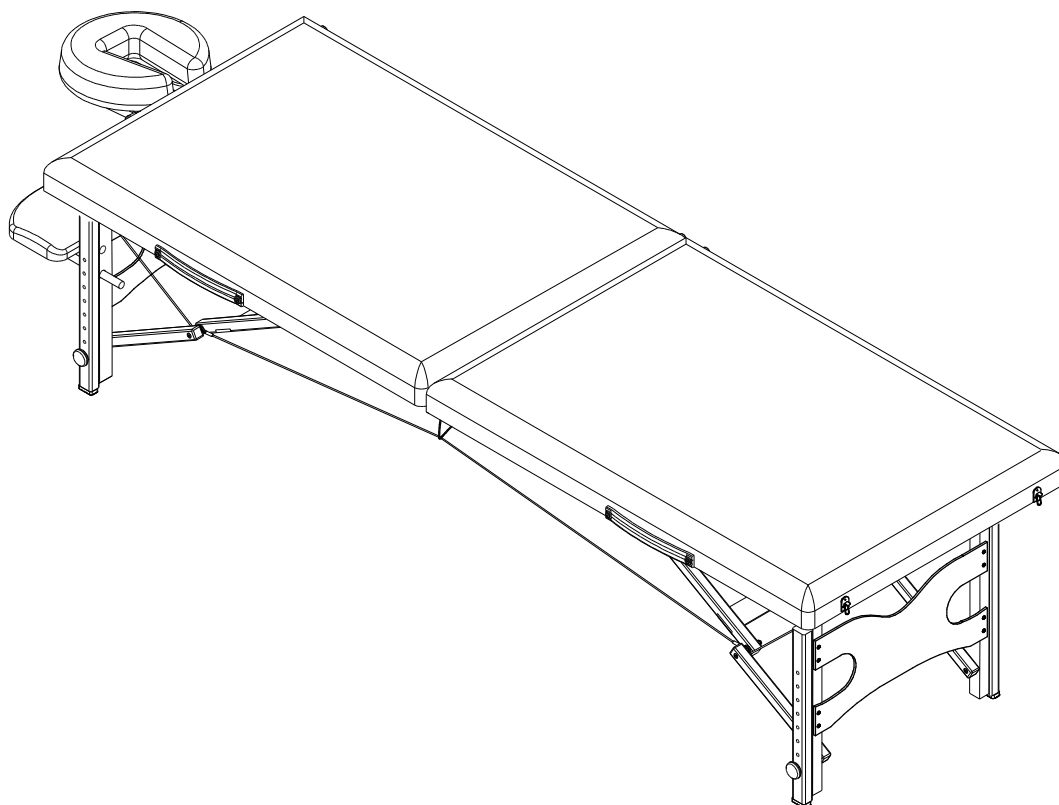

Model # 9105

The specifications of this product may vary from this photo and are subject to change without notice.  
IRONMAN, IRONMAN TRIATHLON AND M-DOT are registered trademarks of World Triathlon Corporation.  
This product is licensed by the IRONMAN TRIATHLON.

# TABLE OF CONTENTS

	<i>Page #</i>
Warning label placement	3
<hr/>	
Service	4
<hr/>	
Safety precautions	5
<hr/>	
Overview drawing	6
<hr/>	
Part list	7
<hr/>	
Assembly	8
<hr/>	
Adjustment	10
<hr/>	
Storage	12
<hr/>	
Transport the table	12
<hr/>	
Maintenance instructions	13
<hr/>	
Warranty	14
<hr/>	
Part request fax foam	15



## SERVICE

To request for product service and order replacement parts, please call our customer service department at

**1-866-924-1688**

Monday through Friday, 8:00 am-5:00 pm Pacific Standard Time,  
or email at: **service@paradigmhw.com**

Please have the following information ready when requesting for service:

Your name	Phone number	Owner's manual
Model number	Serial number	Part number
Date of Purchase		

**\*If the product has major defects which prevent it from functioning properly, please return it to the store of purchase within the period allowed by the store.**

Paradigm Health & Wellness, Inc.  
1189 Jellick Ave.  
City of Industry, CA 91748

## SAFETY PRECAUTIONS

- (1) Maintain the table periodically. Make sure all screws are secure and the cable has not deteriorated or frayed. Make sure there are no cracks in the wood structure.
- (2) Do not overload the table beyond the recommended weight limit. This could result in serious injury to the user.
- (3) Do not use alcohol based cleaners when cleaning the vinyl. This could cause damage to the vinyl material. Use warm soapy water and wipe dry.
- (4) Make sure when using the table that all four legs are at the same level. Using the legs at different levels can cause the table to be unstable and cause injury.
- (5) Maximum weight capacity- static weight: 2200lbs/998kgs  
working weight: 550lbs/250kgs

# OVERVIEW DRAWING

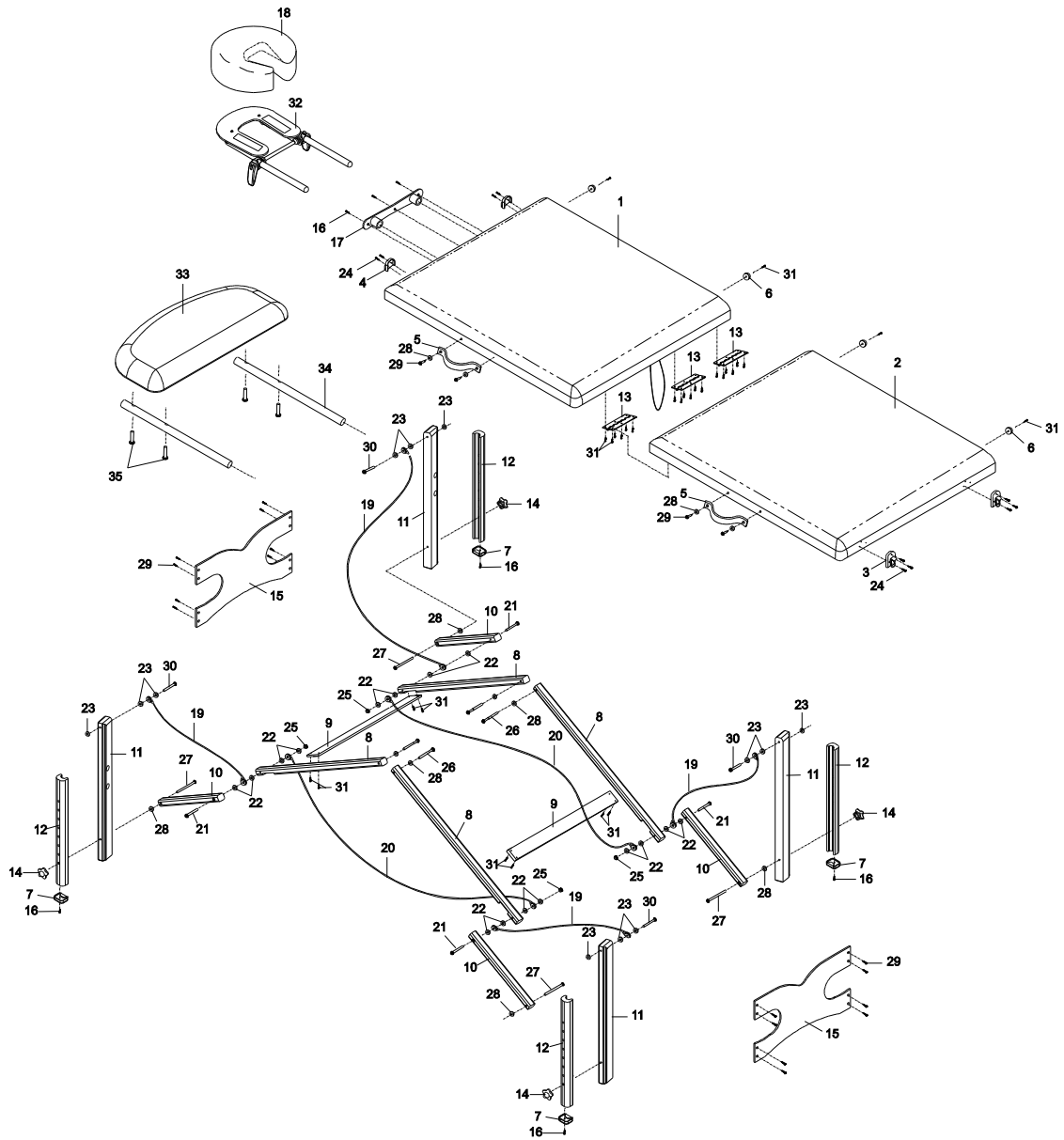

## PART LIST

Part#	Description	Quan.	Part#	Description	Quan.
001	Front Bed with Frame	1	019	Short Cable	4
002	Rear Bed with Frame	1	020	Long Cable	2
003	Upper Buckle	2	021	M6x70mm Self Tapping Bolt	4
004	Lower Buckle	2	022	Plastic Washer Ø13xØ6x2t	16
005	Handle	2	023	Plastic Washer Ø15xØ6x4t	12
006	Rubber Foot	4	024	M3x20mm Round Head Self Tapping Screw	10
007	Lower Leg End Cap	4	025	M6 Nylon Nut	4
008	Long Brace	4	026	M6x75mm Bolt	4
009	Cross Brace	2	027	M6x75mm Self Tapping Bolt	4
010	Short Brace	4	028	Plastic Washer Ø18xØ6x2t	12
011	Upper Leg	4	029	M4x18mm Mod. Truss Head Screw	20
012	Lower Leg	4	030	M6x90mm Bolt	4
013	Hinge	3	031	M4x20mm Self Tapping Screw	30
014	Leg Knob	4	032	U Shape Headrest	1
015	End Panel	2	033	Armrest	1
016	M4x20mm Round Head Self Tapping Screw	7	034	Armrest Tube	2
017	Headrest Bushing Plate	1	035	1/4"x25.5mm Bolt	4
018	Face Cushion	1			

# ASSEMBLY

1

Unlace the Buckles and then open the table so that it is standing on the Rubber Foot side. Take out the Face Cushion, U Shape Headrest, and Armrest from underneath of the table.

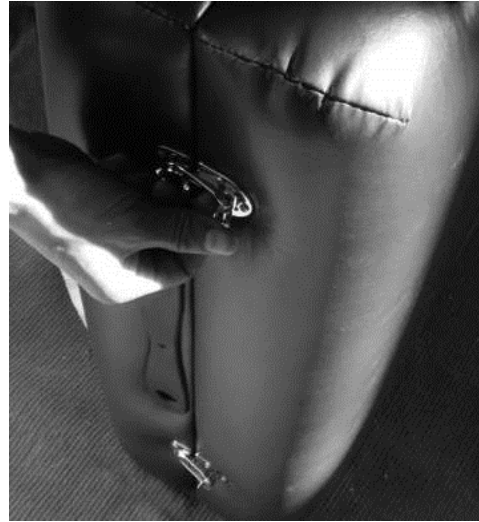

2

Pull out the left and right pair of Legs and straighten each joint.

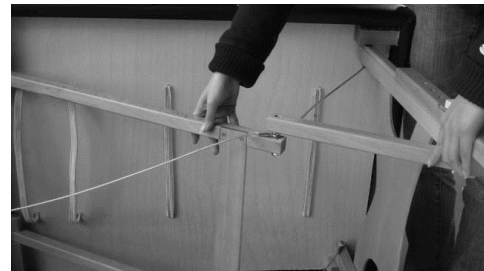

3

Lift the table up until all four legs are on the floor.

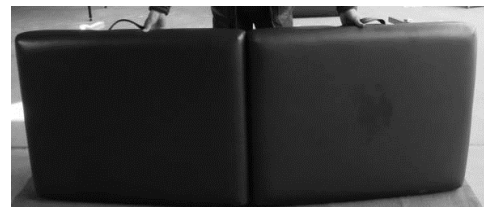



# ASSEMBLY

4

Lift one end of the table and pull out to open table fully.



5

Insert both Right/Left Headrest Sticks with Headrest into the holes of the Headrest Bushing Plate.



6

Place the Face Cushion onto the U Shape Headrest with the designated velcro stickers.

***WARNING: HEADREST IS FOR LIGHT RESTING ONLY! PLEASE DO NOT ADD HEAVY PRESSURE WHEN RESTING.***



## ASSEMBLY

7

Insert the Armrest Tubes into the holes on the Upper Legs.



## ADJUSTMENT

### Adjusting the angle of the Headrest

Pressing up the Locking Handles and then adjust the Headrest to the desired angle. Pressing down the Locking Handles after adjustment.



### Adjusting the Table Height

Lay the table on the Rubber Foot side and then remove the Leg Knob.

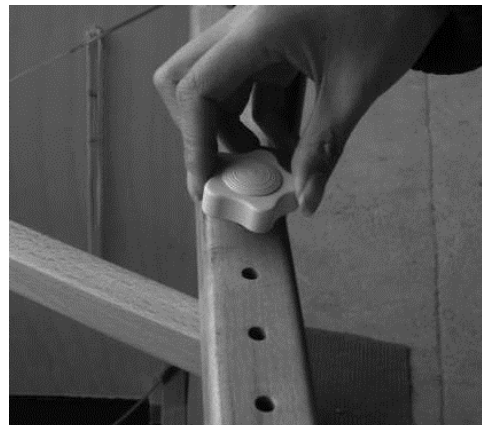

# ADJUSTMENT

## Adjusting the Table Height

Remove the Lower Leg and then place the Lower Leg back onto the Upper Leg to the desire hole for adjusting the height of the table.



Tighten the Leg Knob after adjustment.

***NOTE: Adjust all of the four Legs to the same height.***



## STORAGE

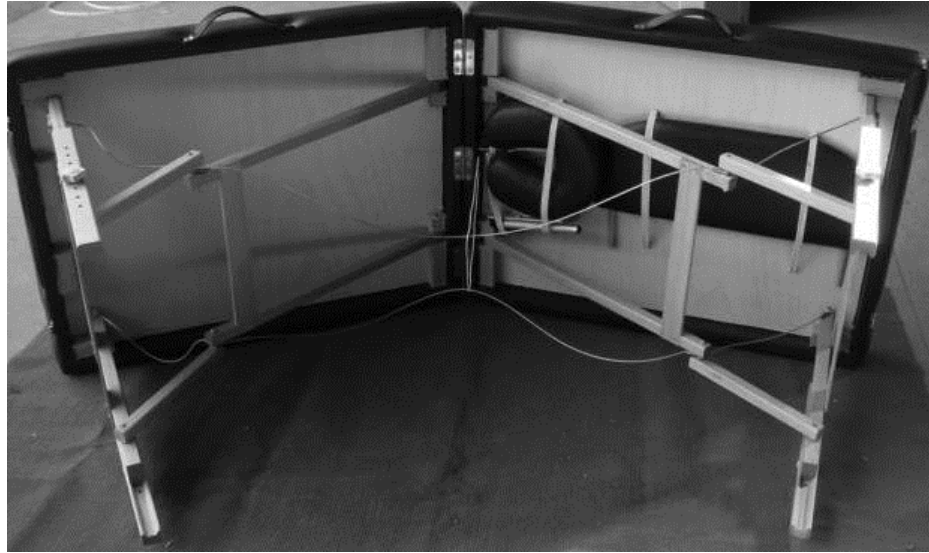

1. Lay the table on its side and fold at an angle.
2. Completely fold the Legs flat under the table.
3. Make sure the Cables, U Shape Headrest, Face Cushion, and Armrest are inside the table before closing it.

## TARNSPORT THE TABLE



The table is easy to carry with the shoulder strap of carry bag.

## MAINTENANCE INSTRUCTIONS

You should check your massage table for any kind of wear and tear before each use.

1. Check the legs, beds, cables for wear and tear.
2. Replace damaged and worn components immediately.
3. Keep all damaged equipment out of use until it is repaired.

## WARRANTY

Paradigm Inc. warrants to the original purchaser that this product is free from defects in material and workmanship when used for the purpose intended, under the conditions that it has been installed and operated in according to Paradigm's Owner's Manual. Paradigm's obligation under this warranty is limited to replacing free of charge, any parts which may prove to be defective under normal home use. This warranty does not include any damage caused by improper operation, misuse or commercial application. From the date of purchase, the frame is warranted to be free from defects for 1 (one) year. All parts and workmanship, including electronics and its console cases, upholstery, foam, ball bearings, pulleys, cables, shocks, all tension mechanisms, wheels, pedals and hardware are to be free from defects for 90 days. This warranty is offered only to the original owner and is not transferable. Proof of purchase is required.

