

CONSTRUCTION AND STANDARD FEATURES

- Single-bowl design; 3.5" drain opening pre-drilled.
- Can be undermounted or caulked directly to the countertop without the use of clips or channels.
- No holes drilled standard; up to 4 holes drilled by MTI at no additional charge.
- Durable Lucite® cast acrylic shell is extremely scratch- and stain-resistant yet renewable because the color goes all the way through the material.
- Non-porous surface makes cleaning and sanitizing faster and more effective.
- Multi-layered reinforced backing of thick fiberglass / resin / titanium.
- At least 30% thicker and stronger than other makes.
- Quality tested and certified by the NAHB.
- 2-year Limited Residential Warranty.

25" x 22.25" x 9.25"

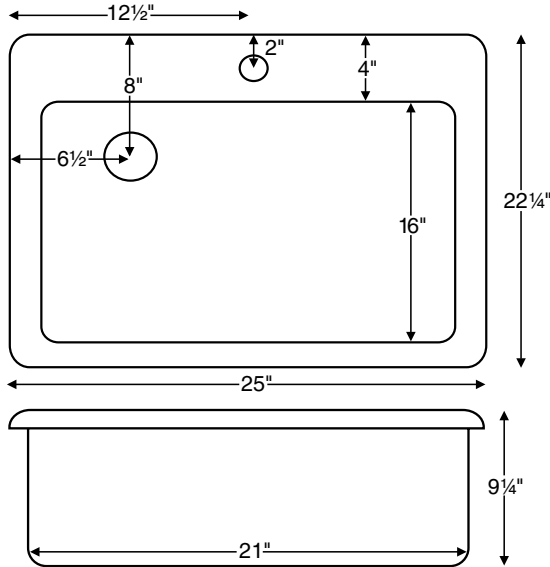

Distributor Multiplier Does Not Apply

NEW MSRP

MTKS-40 Simplicity (MTKS40)	
COLORS	
White	\$190
Bone, Biscuit, Almond	\$200
Other Colors: See p M-1	\$240
OPTIONS	
Quick Ship/Priority. Call for availability. (QUISINKSH)	\$78
Shipping Weight: 15 lbs	

NOTES: Measurements are ±1/2" and are subject to change without notice. Data herein supersedes all previous prior to publication date indicated below.

33" x 22.25" x 9.25"

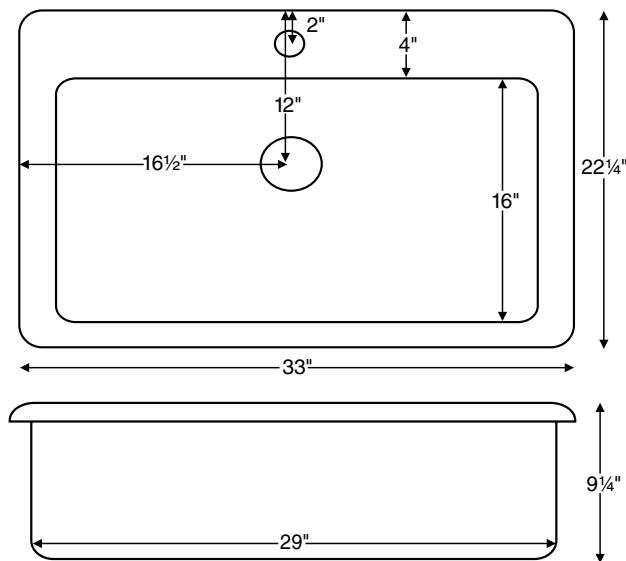

Distributor Multiplier Does Not Apply

NEW MSRP

MTKS-50 Reflection (MTKS50)	
COLORS	
White	\$220
Bone, Biscuit, Almond	\$235
Other Colors: See p M-1	\$280
OPTIONS	
Quick Ship/Priority. Call for availability. (QUISINKSH)	\$78
Shipping Weight: 20 lbs	

NOTES: Measurements are ±1/2" and are subject to change without notice. Data herein supersedes all previous prior to publication date indicated below.