

AL650L

32.0" x 23.63" x 23.5" (H x W x D)

ADA compliant freestanding refrigerator-freezer with cycle defrost, front lock, and white exterior

Highlights:

32 inch height for lower ADA counters

Cycle defrost system saves both you and your appliance energy

Ice cream stays frozen in zero degree freezer

Factory-installed lock provides security you can depend on



Cycle defrost	Combines an automatic defrosting refrigerator with a manual defrosting freezer to save energy but protect food
---------------	--

ADA compliant	32 inch height for lower ADA counters
---------------	---------------------------------------

Fully finished white cabinet	Allows the unit to be used freestanding
------------------------------	---

Factory installed lock	Keep contents secure with a key lock on the door
------------------------	--

Zero degree freezer	Keep ice cream frozen and freezer burn-free in a freezer that reaches and maintains zero degrees
---------------------	--

Dual evaporator	SUMMIT's unique and efficient design separately cools the refrigerator while maintaining zero degrees in the freezer with two evaporators
-----------------	---

Reversible door	Keep your options flexible with a reversible door that is easy to switch when your arrangement changes
-----------------	--

Adjustable shelves	Rearrange your refrigerator space to accommodate all shapes and sizes or remove shelves for a simple clean-up
--------------------	---

Door storage	Store large bottles right on the door for easy access
--------------	---

Clear crisper	Get the longest life and best taste out of produce by storing in a convenient slide drawer
---------------	--

Specifications:

Height	32.0"
Width	23.63"
Depth	23.5"
Capacity	5.1 cu.ft.
Ext Depth with Handle	24.13"
Interior Height 1	19.5"
Interior Width 1	20.5"
Interior Depth 1	17.0"
Interior Height 2	5.0"
Interior Width 2	19.0"
Interior Depth 2	11.5"
Comp Step Height	7.0"
Comp Step Width	20.5"
Comp Step Depth	5.0"
Shipping Weight	102.0 lbs.
Weight	100.0 lbs.
US Electrical Safety	UL
Amps	1.3
Canadian Electrical Safety	ULC
Voltage/Frequency	115 V AC/60 Hz
Energy Usage/Year	434.0 kWh/year
Reversible	Yes
Door Swing	RHD
Crisper Quantity	1
Shelf Quantity	3
Adjustable Shelf	true
Shelf Type	Wire
Crisper Cover Type	Glass
Crisper Finish	Transparent
Full Door Shelf Quantity	3
Defrost Type	Cycle
Height to Hinge Cap	32.25"
Depth with door at 90°°	45.13"
Condensor Location	Rear of Unit
Thermostat Type	Dial
Light	true
Freon Type	R134a
High Side PSI	285.0
Level Legs Quantity	2
Low Side PSI	70.0
Freon Oz	2.6
Parts/Labor Warranty	1 Year
Compressor Warranty	5 Years

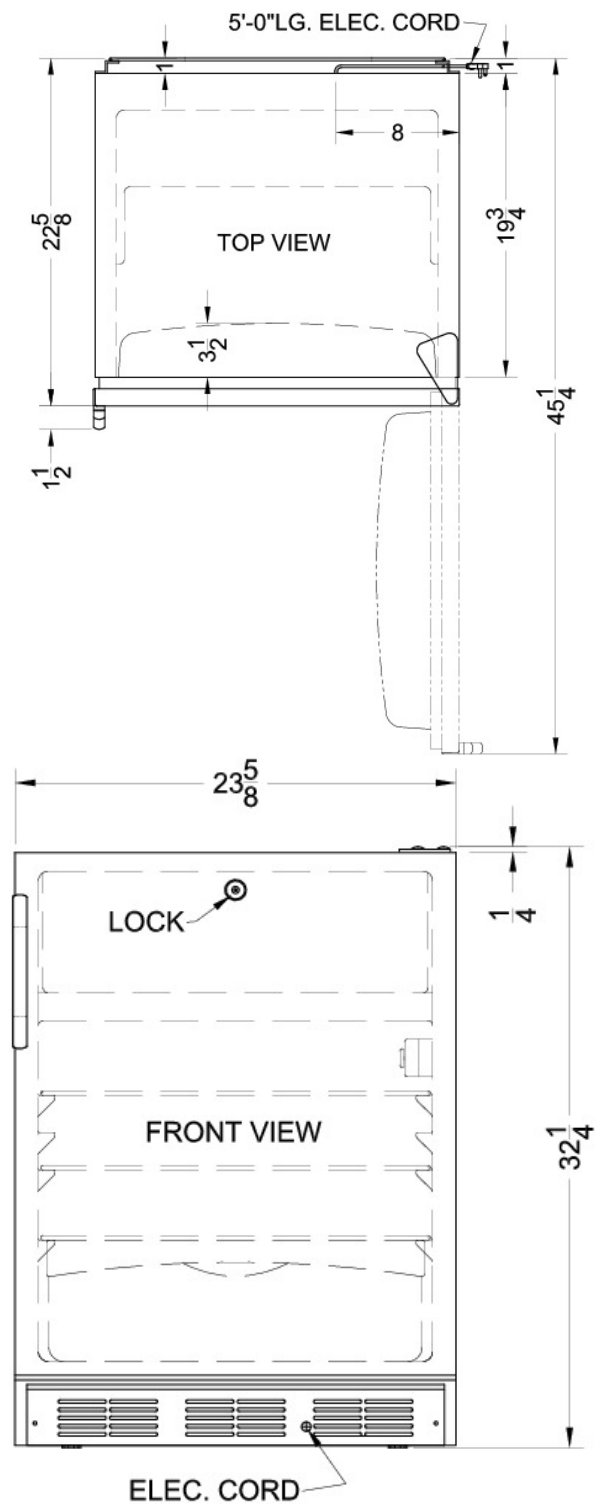

Summit Appliance Division, Felix Storch, Inc.
 770 Garrison Ave • Bronx, NY 10474
 Phone: 718-893-3900 • Fax: 718-842-3093
 Email: info@summitappliance.com