

## REPLACEMENT PARTS

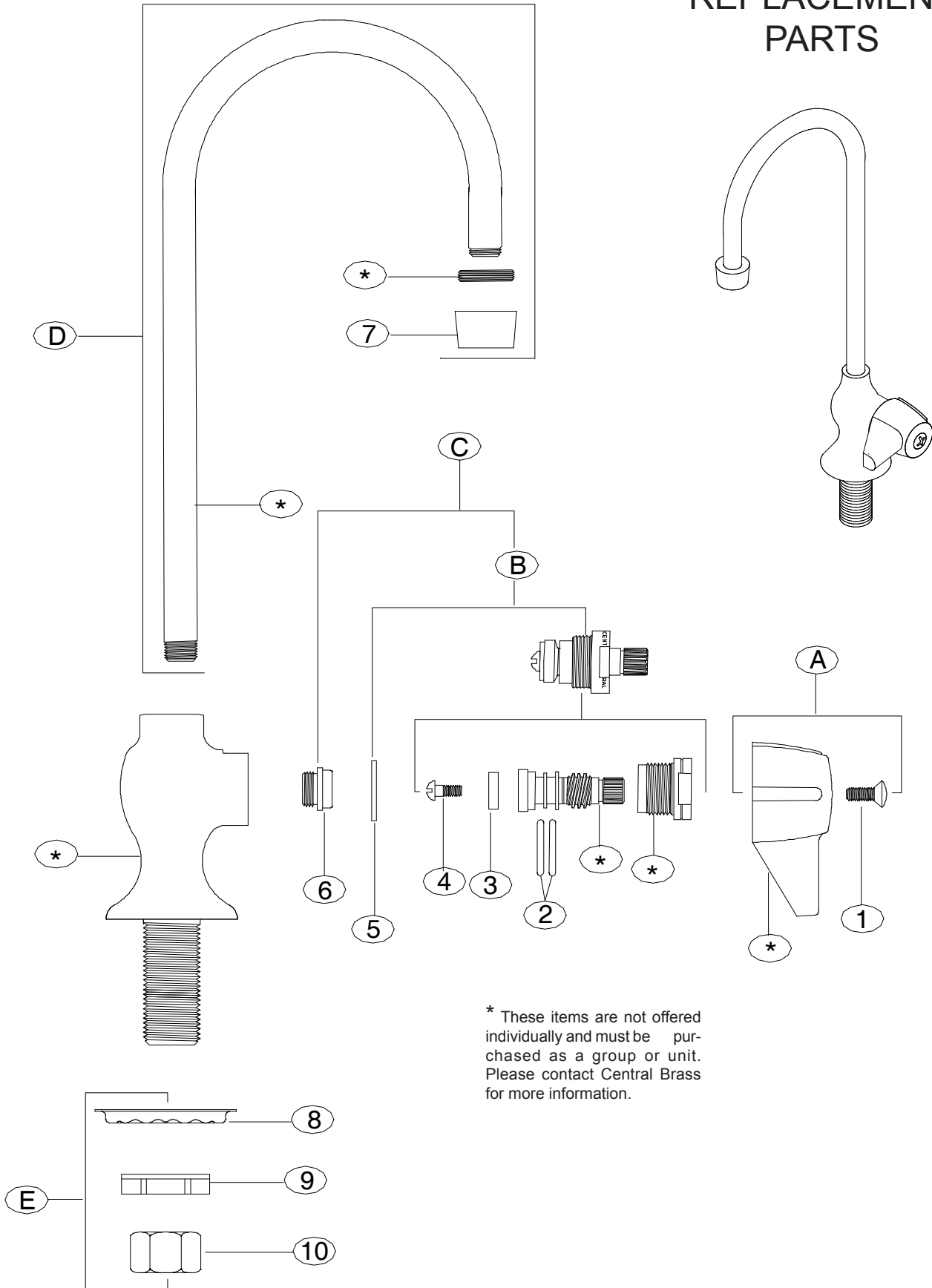

\* These items are not offered individually and must be purchased as a group or unit. Please contact Central Brass for more information.

## REPLACEMENT PARTS

#	Part #	Description
A	G-523-C	Lever Handle Indexed C with Screw (X107-F)
A	G-523-H	Lever Handle Indexed H with Screw (X107-F)
B	G-453-EL	Cold O-Ring Stem Assembly with Gasket (X1028-Y)
B	G-453-ER	Hot O-Ring Stem Assembly with Gasket (X1028-Y)
C	K-453-C	Cold O-Ring Stem Assembly with Gasket (X1028-Y) and Seat (X263-BC)
C	K-453-H	Hot O-Ring Stem Assembly with Gasket (X1028-Y) and Seat (X263-BC)
D	SU-157-HA	Rigid Gooseneck Spout with Aerator (30-M)
E	G-95-A	Coupling Nut Group
1	X107-F	Handle Screw (25 pcs per pack)
2	X1038-453	O-Rings (25 pcs per pack)
3	X901-WNN	Stem Seat Washer (25 pcs per pack)
4	X104	Seat Washer Screw (25 pcs per pack)
5	X1028-Y	Gasket (25 pcs per pack)
6	X263-BC	Replacement Seat (10 pcs per pack)
7	30-M	Aerator
8	X54	Crowfoot Washer (10 pcs per pack)
9	X7133-AZ	Locknut (10 pcs per pack)
10	X4015	Coupling Nut (4 pcs per pack)

### 80286 with Ceramic-disc Cartridge option

Prefix Number	Replaces Item #	Part Number	Description
8	B & 6	K-352-C	Ceramic-disc Stem Cartridge Cold with gasket (X1028-Y)
8	B & 6	K-352-H	Ceramic-disc Stem Cartridge Hot with gasket (X1028-Y)