

# CW1SW Wall Control

## SPECIFICATION and INSTRUCTION SHEET

**DESCRIPTION:** One Ceiling Fan & Light, 3 Speed Wall Control with ON/OFF Light Switch

**ELECTRICAL SPECS:** 120 Volts, 60 Hertz, Fan 1.25 amp, Light Rating 190W (max.)

Compact Fluorescent Light Bulb, Incandescent or Halogen, 4 Wire Installation  
[www.fanimation.com](http://www.fanimation.com) for more information



**IMPORTANT:** YOU MUST SET YOUR CEILING FAN TO HIGH SPEED AND LIGHT KIT (IF ANY) TO THE ON POSITION BEFORE OPERATING YOUR REMOTE CONTROL.

**NOTE:** If fan or supply wires are different colors than indicated, have this unit installed by a qualified electrician.

### ⚠ WARNING

To avoid possible electrical shock, be sure electricity is turned off at the main fuse box before wiring.  
**NOTE:** If you are not sure if the outlet box is grounded, contact a licensed electrician for advise, as it must be grounded for safe operation.

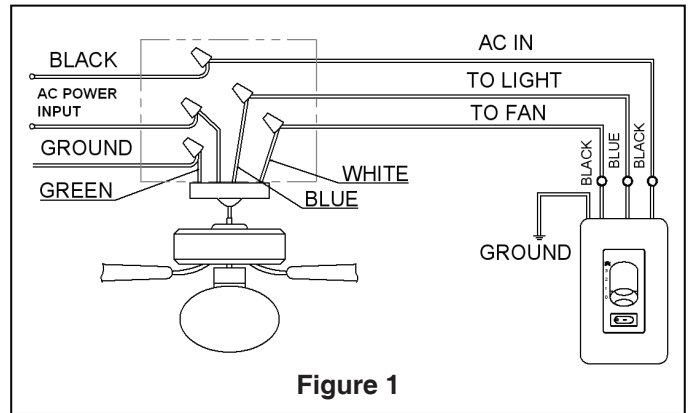

Figure 1

### ⚠ WARNING

Check to see that all connections are tight, including ground, and that no bare wire is visible at the wire connectors, except for the ground wire. Do not operate fan until the blades is in place. Noise and fan damage could result.

#### INSTALLING THE WALL CONTROL:

1. With power still off, remove existing wall plate, disconnect and remove the toggle switch from wall junction box. Save the 2 screws from the toggle switch.
2. Using the supplied wire connectors, make the electrical connections to the new wall control unit.
3. Set the knob and light switch of the wall-mounted control in the off (0) position.
4. Make wire connections and secure with wire nuts supplied. (Figure 1)
  - \* Connect the Black wire from the wall-mounted control with the wire from the wire of A.C. power supply.
  - \* Connect the Black wire from the wall-mounted control with the Black wire from the ceiling fan.
  - \* Connect the Blue wire from the wall-mounted control with the Blue wire from the ceiling fan.
  - \* Connect the Green/Yellow wire from the ceiling fan with the ground wire.
5. Carefully push all connected wires inside wall switch box.
6. Secure the wall-mounted control to the outlet box with two screws provided. Then the face plate clicks on the wall control. (Figure 2)
7. Push and click the face plate onto the wall control.
8. Restore power

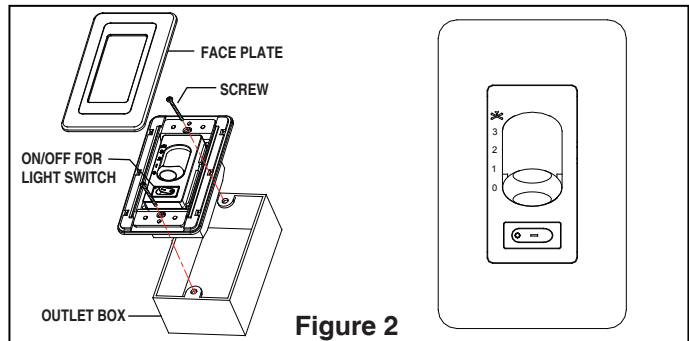



Figure 2

#### WALL CONTROL FUNCTIONS:

- 0: Power Off
- 1: High Speed
- 2: Medium Speed
- 3: Low Speed

: ON/OFF for Light Switch



10983 Bennett Parkway  
 Zionsville, IN 46077  
 (888) 567-2055 • FAX (866) 482-5215  
 Outside U.S. call (317) 733-4113  
 Visit Our Website @ [www.fanimation.com](http://www.fanimation.com)