



ASSEMBLY INSTRUCTIONS

Adult Assembly Required
Save these instructions for future use

MODEL #'s: 02211 White, 02212 Natural,
02232 Cherry, 02233 Honey
02234 Black

NAME: Sleigh Style Baby Changing Table

TOOLS NEEDED: Phillips Screwdriver*
**Power screwdriver is helpful but be careful not to damage the product*



Toys & accessories shown with table not included.

PARTS INCLUDED:

- (A) 16 - Black Pegs (one shown)
- (B) 2 - Top Rails
- (C) 6 - Shelf Rails
- (D) 2 - End Panels
- (E) 16 - 1 $\frac{3}{4}$ " Bolts (one shown)
- (F) 3 - Shelf Panels (not shown)
- (G) 1 - Safety Belt
- (H) 1 - Metal Support Bar
- (I) 2 - 5/8" Screws (one shown)
- (J) 1 - Mattress Pad (not shown)

NOTE: Parts diagrams not to scale.





BEFORE YOU BEGIN ASSEMBLY:
Ensure that all the parts and hardware listed above are included. If anything is missing, please do not return the product to the store. Call or e-mail us for assistance. Assemble the table on a carpeted surface so it won't get scratched while you are putting it together.



Visit us online at www.badgerbasket.com

Toll-Free Customer Service: 1-800-236-1310 (Monday through Thursday 7:30 AM to 4:30 PM CST)
parts@badgerbasket.com

PLANT AND GENERAL OFFICE: PO Box 227, Edgar, WI 54426-0227 715-352-2311 Fax: 715-352-3163

CORPORATE OFFICE: 111 Lions Dr., Suite 220, Barrington, IL 60010

The table can be assembled by one person. Having a second person available to help can speed things along. Don't fully tighten the bolts until the table is completely assembled. Then go back and tighten them securely, but don't overtighten.

STEP 1: See PICTURE 1. Insert the SIXTEEN BLACK PEGS (A) into the 16 peg holes on the ends of the TWO TOP RAILS (B) and the SIX SHELF RAILS (C).

Push the thinner end of the peg (as shown by Part B) into the hole until the wider end is flush with the wood (as shown on Part C).

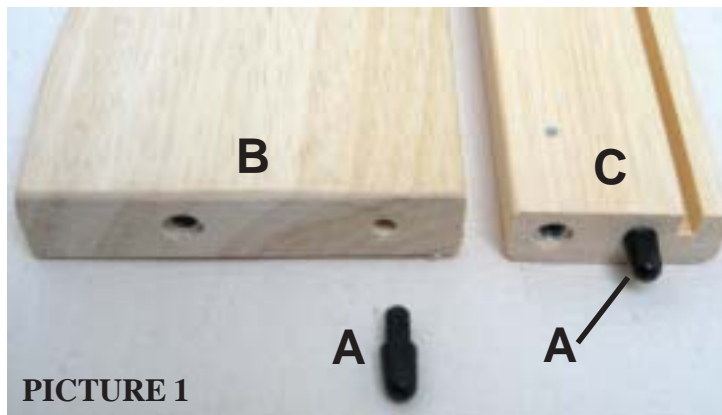

STEP 2: See PICTURE 2. Attach ONE TOP RAIL (B) and THREE SHELF RAILS (C) to ONE END PANEL (D) using FOUR 1 $\frac{3}{4}$ " BOLTS (E).

Insert the black pegs on the RAILS (B, C) into their pre-drilled holes on the END PANEL (D) to line up the other holes for the BOLTS (E).

The shelf grooves on the SHELF RAILS (C) should face in and line up with the shelf grooves on the END PANEL (D).

STEP 3: See PICTURE 3. Attach the second TOP RAIL (B) and the remaining THREE SHELF RAILS (C) to the same END PANEL (D) using FOUR 1 $\frac{3}{4}$ " BOLTS (E).

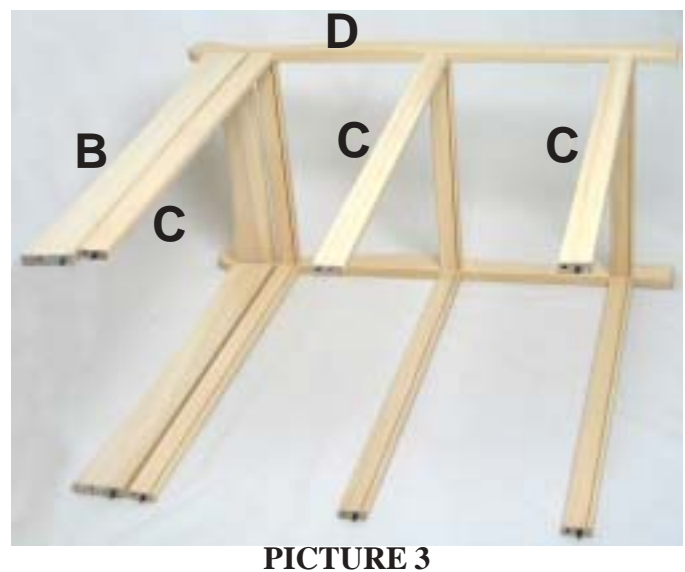
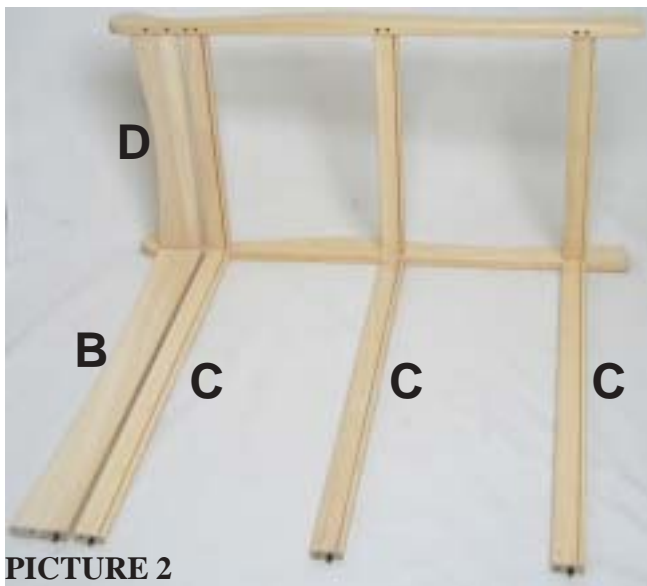

STEP 4: See PICTURE 4. Position the table so that it's resting on the END PANEL (D). Insert the THREE SHELF PANELS (F) into the shelf grooves on the SIX SHELF RAILS (C) with the white sides of the shelves facing up. Be sure the shelves are seated into the grooves on all three sides.

STEP 5: See PICTURE 5. Attach the SECOND END PANEL (D) to the TWO TOP RAILS (B) and SIX SHELF RAILS (C) using EIGHT 1 3/4" BOLTS (E).

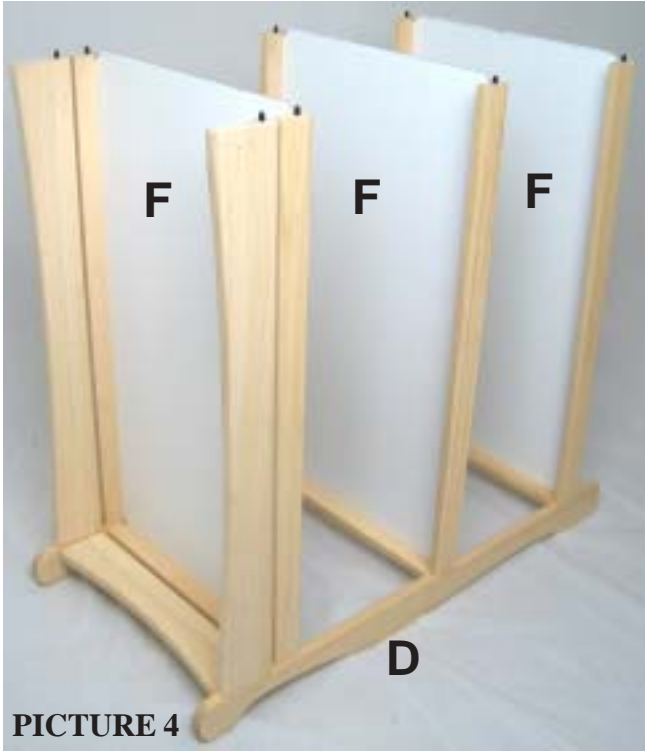

STEP 6: Note: This step can also be completed with the table upside down resting on the top which can make it easier to position the parts and secure them with the screws.

See PICTURE 6A. Locate the SAFETY BELT (G) and slip one of the ends with the pre-made screw hole between the TOP RAIL (B) and the TOP SHELF RAIL (C).

See PICTURE 6B. Using the pre-drilled hole on the **underside** of the TOP SHELF RAIL (C), secure the end of the SAFETY BELT (G) and the METAL SUPPORT BAR (H) with ONE 5/8" SCREW (I). Sandwich the end of the SAFETY BELT (G) between the metal bar and the top shelf rail as shown.

See PICTURE 6C. Repeat this step to secure the other end of the SAFETY BELT (G) and the other end of the METAL SUPPORT BAR (H) using the second 5/8" SCREW (I).

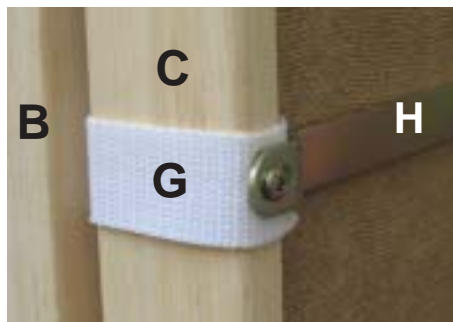
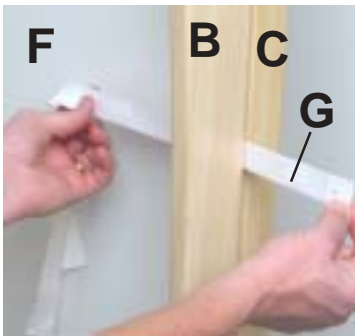

STEP 7: See PICTURE 7.

Put the table into its correct, upright position. Place the MATTRESS PAD (J) onto the TOP SHELF (F) underneath the SAFETY BELT (G).

Your SLEIGH STYLE CHANGING TABLE is now ready for use!



PICTURE 7



!! WARNING !! ATTENTION !!

READ ALL INSTRUCTIONS before use of this changing table.

Keep instructions for future use.

Use only the changing pad provided by Badger Basket.

Do not use the changing table if it is damaged or broken.

FALL HAZARD - To prevent death or serious injury, always keep baby within arm's reach. NEVER leave your baby unattended, not even for a moment, when you are changing Baby's diaper. ALWAYS use the safety belt; and as an extra precaution keep at least one hand on your baby at all times.

Do not allow any children to climb or play on the table.

This sturdy changing table is suitable for use with children up to 30 pounds (13.64 kg).

Wipe the table clean with a damp cloth and mild soap when needed.

Accessorize this table with our Nursery Baskets (sold separately)!
Browse our selection of baskets at:
<http://www.badgerbasket.com>



The toys, accessories, and baskets shown with tables here are not included.