

ELLIPSO DUO OVAL

ELLIPSO DUO OVAL

WITH MOULDED PANEL

- gently shaped shoulder rest for more pleasure and comfort
- elliptical exterior form reflects the interior form
- bathing with a friend: two identical back rests and centrally positioned outlet
- made of Kaldewei steel enamel 3.5 mm
- the moulded panel emphasizes the high design standard and means the bath can be free-standing

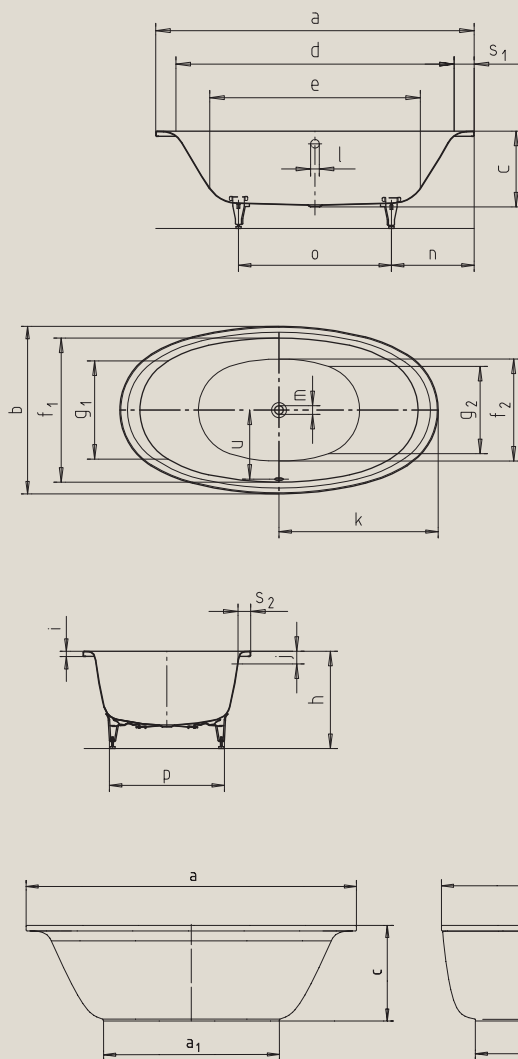

Model No.		232	232-7
External length	a	1900	1900 mm
External length (bottom)	a ₁	–	1013 mm
External width	b	1000	1000 mm
External width (bottom)	b ₁	–	608 mm
Depth	c	450	450 mm
Overall height with panel	c ₁	–	550 mm
Internal length (top)	d	1660	1660 mm
Internal length (bottom)	e	1260	1260 mm
Internal width (top)	f ₁ , f ₂	860; 610	860; 610 mm
Internal width (bottom)	g ₁ , g ₂	585; 520	585; 520 mm
Height with feet	h	565-595	565-595 mm
Height of rim	i	32	32 mm
Distance top edge to centre of overflow hole	j	75	75 mm
Distance tub edge to centre of drain hole	k	950	950 mm
Diameter of overflow hole	l	52	52 mm
Diameter of drain hole	m	52	52 mm
Distance foot end of tub edge to centre of foot	n	585	585 mm
Distance between the feet	o	730	730 mm
Max. width of feet	p	620	620 mm
Width of rim (foot end; lengthwise)	s ₁ , s ₂	120; 65	120; 65 mm
Distance between centre holes	u	421	421 mm
Water volume** in litres		214	214
Weight of the enamelled bath tub in kg		55	–
Anti-slip		Ø 587	Ø 587 mm
Full anti-slip		900 x 546	900 x 546 mm

Note: The operational system may protrude on some whirl systems.
Please refer to the Technical Information for Whirl Systems for further information.
Subject to technical alterations and tolerances.
** 70 litres displacement on average.