

Assembly Instructions For

F2719/5

(E) 11/11

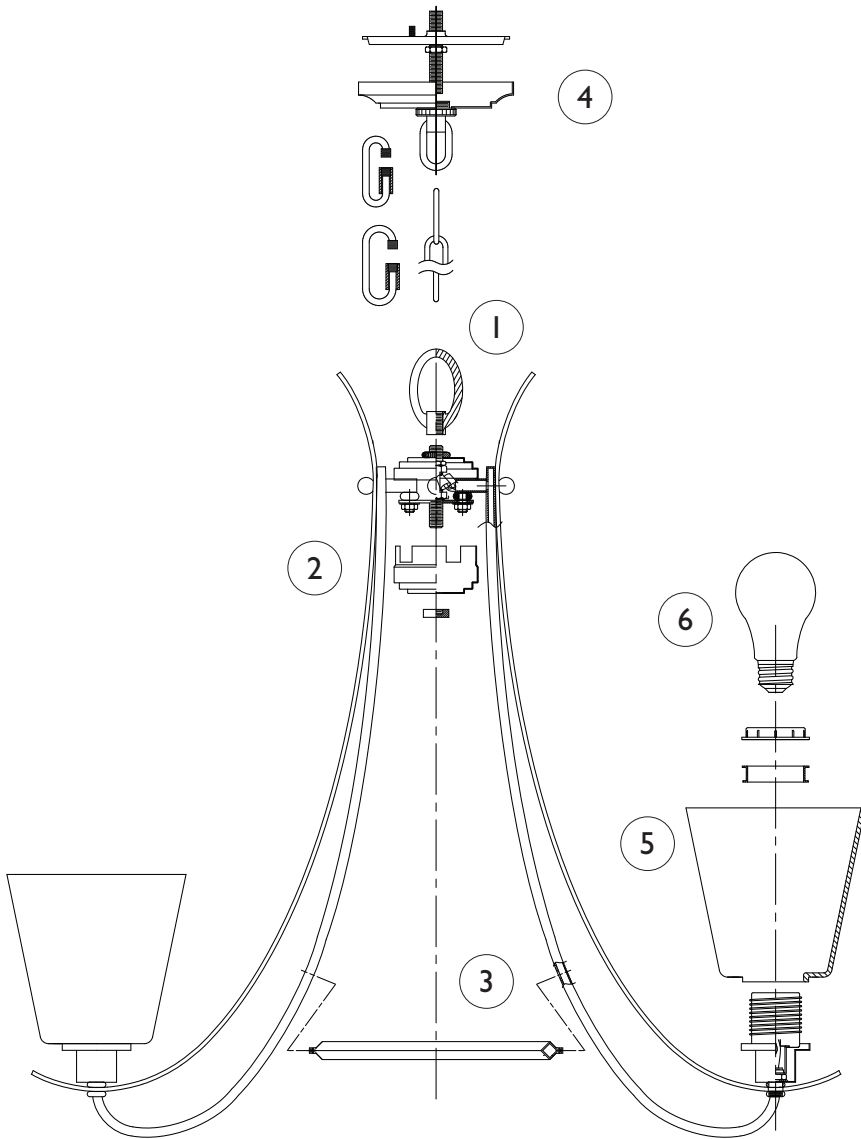

IMPORTANT
TURN OFF THE POWER AT THE MAIN FUSE
OR CIRCUIT BREAKER BOX
BEFORE STARTING INSTALLATION

Carefully unpack and identify all parts before assembly. Bulbs not included.

1. Install the fixture loop onto the top of the fixture.
2. Install the notched cover and secure with the finial.
3. Then install the center ring onto the fixture arms.
4. Follow enclosed supplement installation instructions for electrical and fixture installation onto house outlet box. If you do not have an outlet box at desired location to attach the fixture then hire a qualified electrician to create one.
5. Install shade by fastening with counter ring and spacer.
6. Install light bulb (not included). See relamping label at socket area for type and maximum allowed wattage.

