

Assembly Instructions For

F2686/6 (E) 4/11

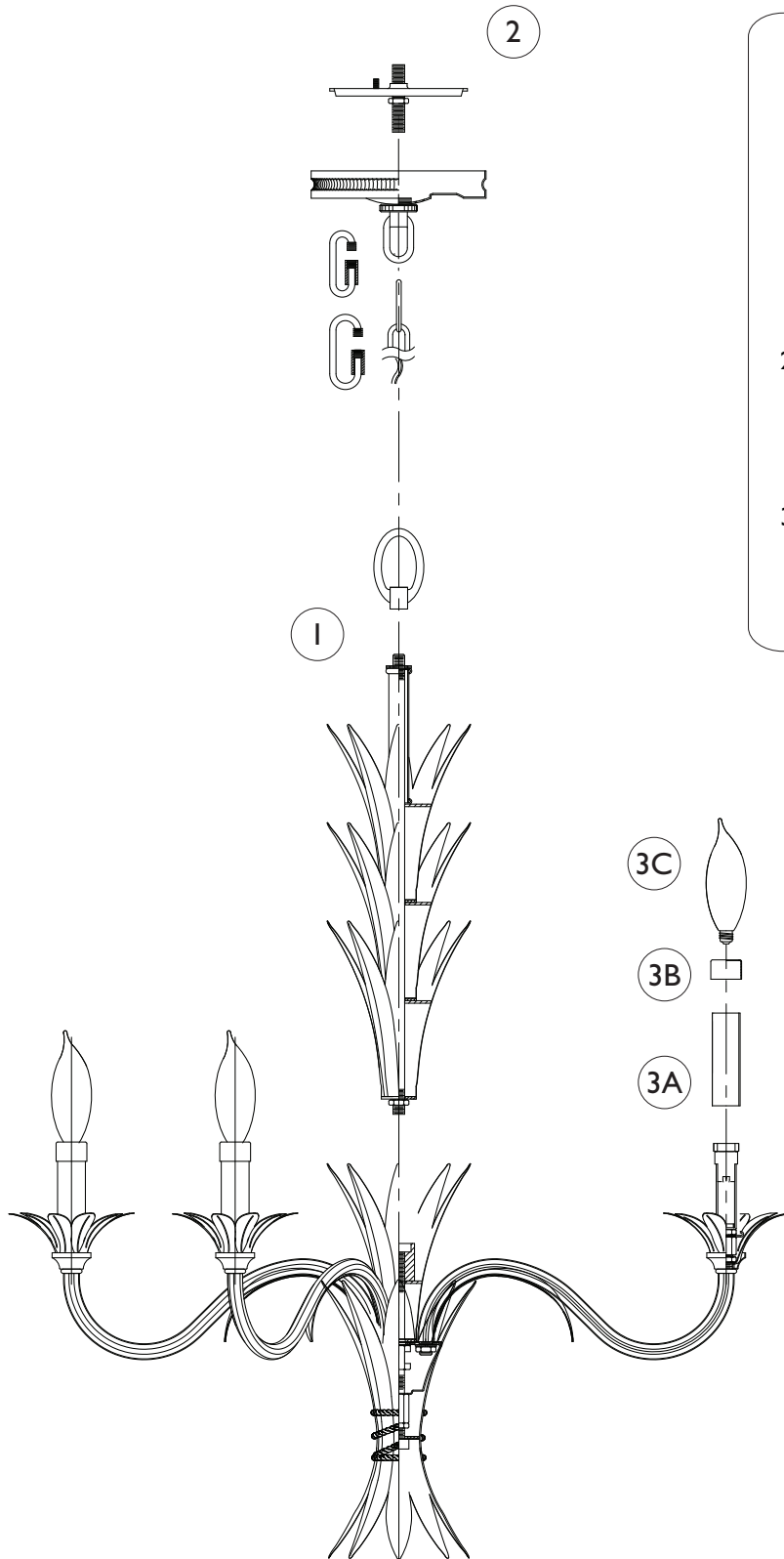

IMPORTANT
TURN OFF THE POWER AT THE MAIN FUSE
OR CIRCUIT BREAKER BOX
BEFORE STARTING INSTALLATION

Carefully unpack and identify all parts before assembly. Bulbs not included.

1. Install the fixture loop onto the top of the center column. Then install the center column onto the fixture body.
2. Follow enclosed supplement installation instructions for electrical and fixture installation onto house outlet box. If you do not have an outlet box at desired location to attach the fixture then hire a qualified electrician to create one.
3. A. Install candle tube by slipping through sockets.
B. Slip candle follower on top of candle tubes.
C. Install type-B, candelabra base, of 60 Watt maximum bulbs (not included).

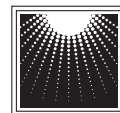

MURRAY
F E I S S

GENERATION
BRANDS™ 