

Assembly Instructions For

F2682/8+4 (E) 5/11

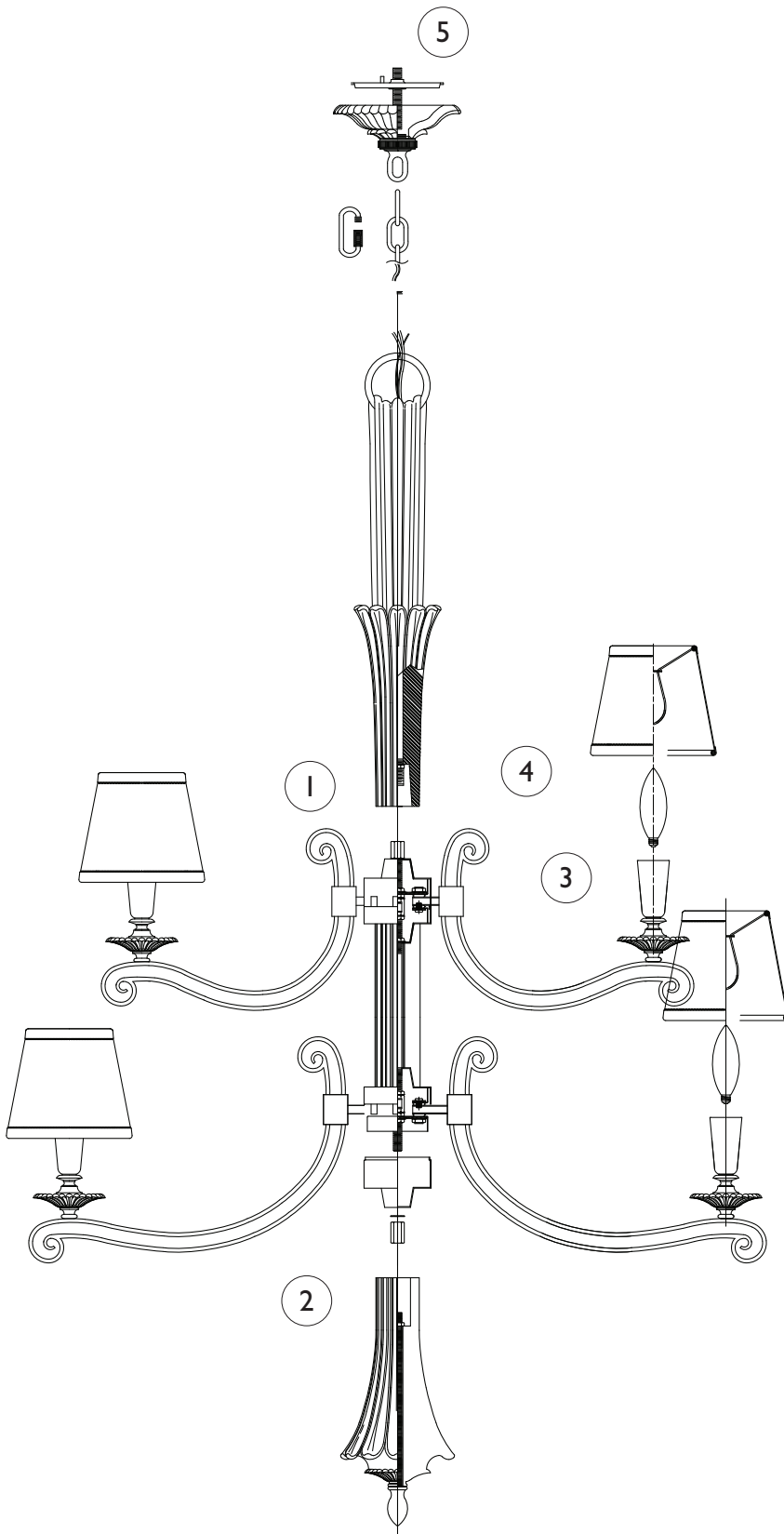

IMPORTANT
TURN OFF THE POWER AT THE MAIN
FUSE OR CIRCUIT BREAKER BOX
BEFORE STARTING INSTALLATION

Carefully unpack and identify all parts before assembly. Bulbs not included.

1. Install the center column onto the top of the fixture assembly.
2. Install the bottom notched cover and coupler onto the bottom of the fixture assembly. Then install the front onto the bottom notched cover.
3. Install light bulb (not included). See relamping label at socket area for type and maximum allowed wattage.
4. Install shade onto bulb.
5. Follow enclosed supplement installation instructions for electrical and fixture installation onto house outlet box. If you do not have an outlet box at desired location to attach the fixture then hire a qualified electrician to create one.

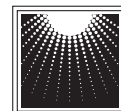

MURRAY
FEISS

GENERATION
BRANDS™