

Assembly Instructions For **F2680/5, F2681/6** (E) 4/11

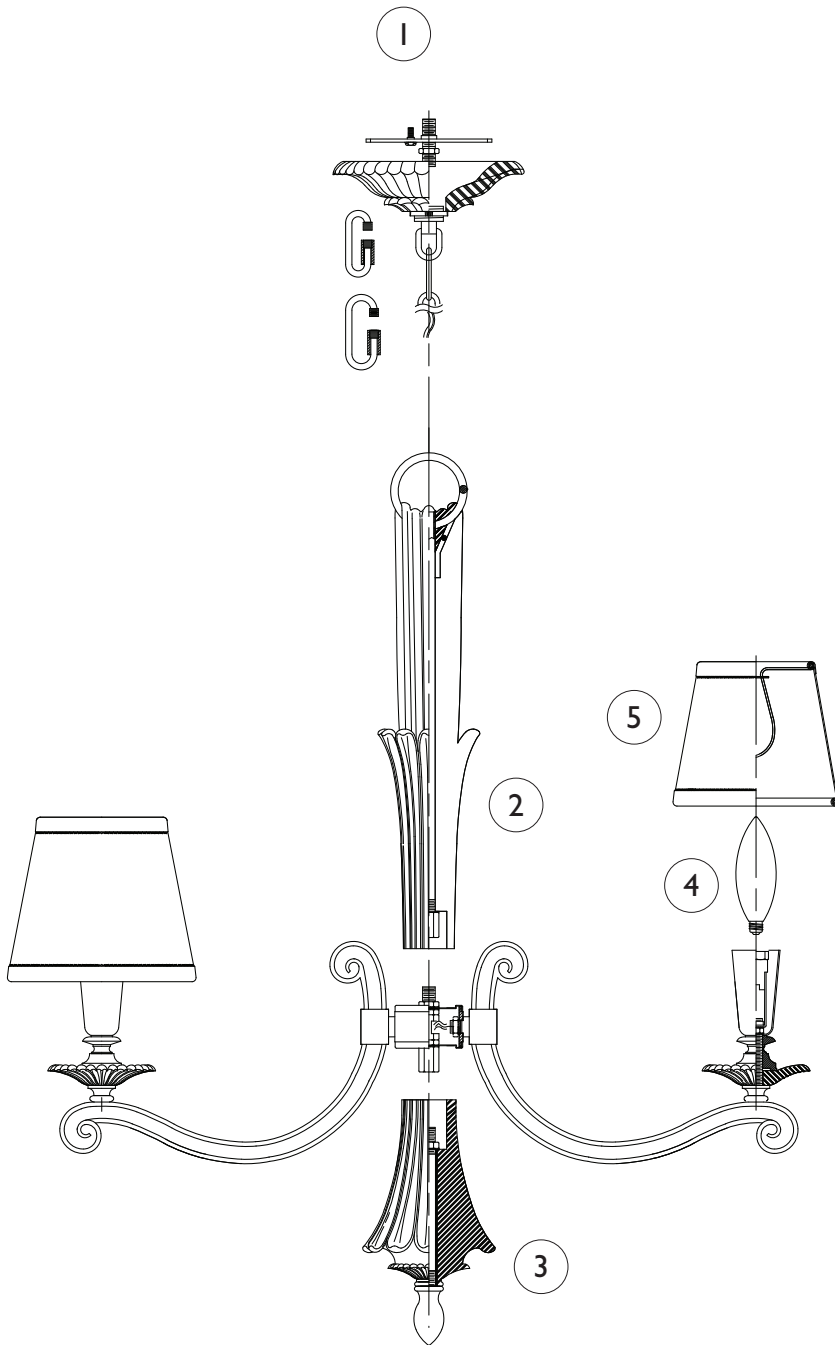

IMPORTANT TURN OFF THE POWER AT THE MAIN FUSE OR CIRCUIT BREAKER BOX BEFORE STARTING INSTALLATION

Carefully unpack and identify all parts before assembly. Bulbs not included.

1. Follow enclosed supplement installation instructions for electrical and fixture installation onto house outlet box. If you do not have an outlet box at desired location to attach the fixture then hire a qualified electrician to create one.
2. Install the center column onto the threaded pipe.
3. Install the font onto the bottom of the fixture.
4. Install light bulb (not included). See relamping label at socket area for type and maximum allowed wattage.
5. Install shade onto bulb.

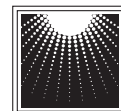

**MURRAY
FEISS**

GENERATION
BRANDS™