

Assembly Instructions For

F2675/3 (E) 5/11

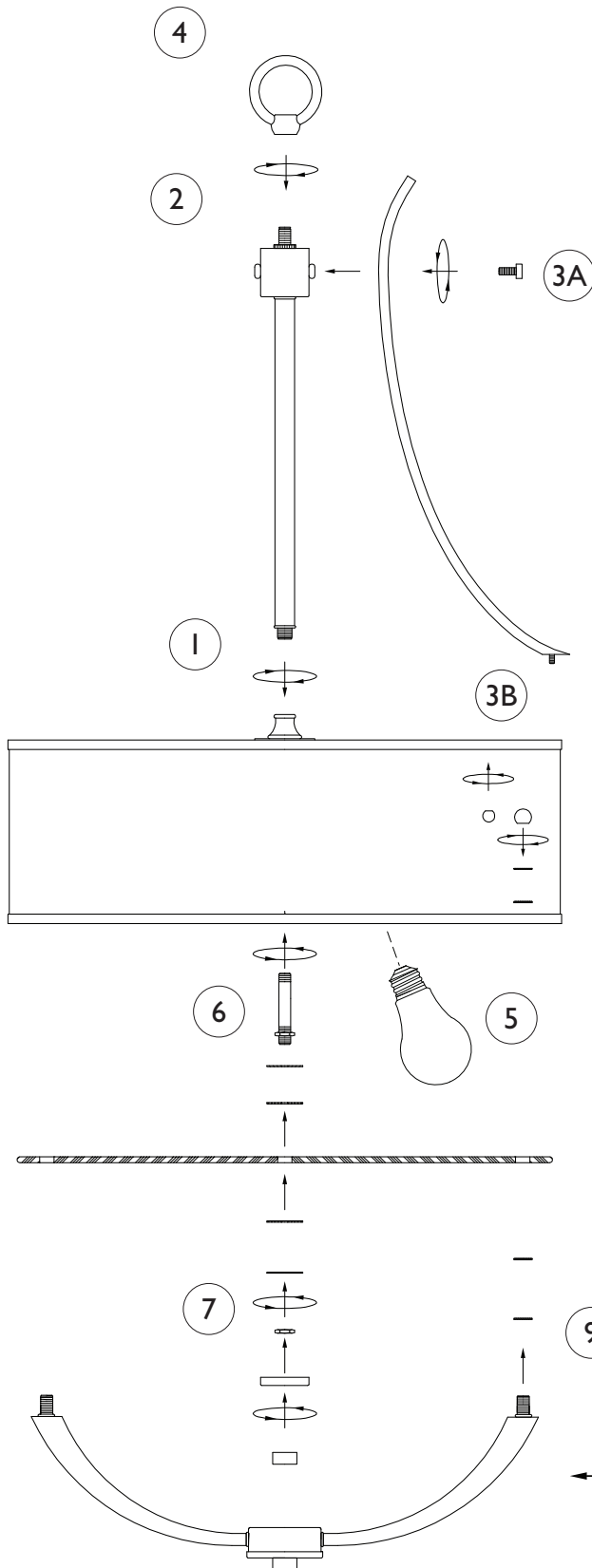

IMPORTANT TURN OFF THE POWER AT THE MAIN FUSE OR CIRCUIT BREAKER BOX BEFORE STARTING INSTALLATION

Carefully unpack and identify all parts before assembly. Bulbs not included.

1. Install the center column onto the top of the shade.
2. Install the fixture loop onto the center column.
3. A. Install the top of arm onto the center column with the thumb screw.
B. Install the bottom of the arm onto the shade with the cap nut.
4. Follow enclosed supplement installation instructions for electrical and fixture installation onto house outlet box. If you do not have an outlet box at desired location to attach the fixture then hire a qualified electrician to create one.
5. Install light bulb (not included). See relamping label at socket area for type and maximum allowed wattage.
6. Install the threaded pipe onto the bottom coupler.
7. Then install the glass plate onto the threaded pipe and secure using the hex nut, washers, cover and finial.
8. Unfold bottom assembly.
9. Install the bottom assembly onto the glass plate and secure with the cap nuts and washers.



**MURRAY
FEISS**

GENERATION
BRANDS™