

# Assembly Instructions For

# F2603/4 (E) 12/10

Extra PIN Qty.	PIN PART	PIN DESCRIPTION
1	8	S Hook

	
Required	X 1
Extra	1

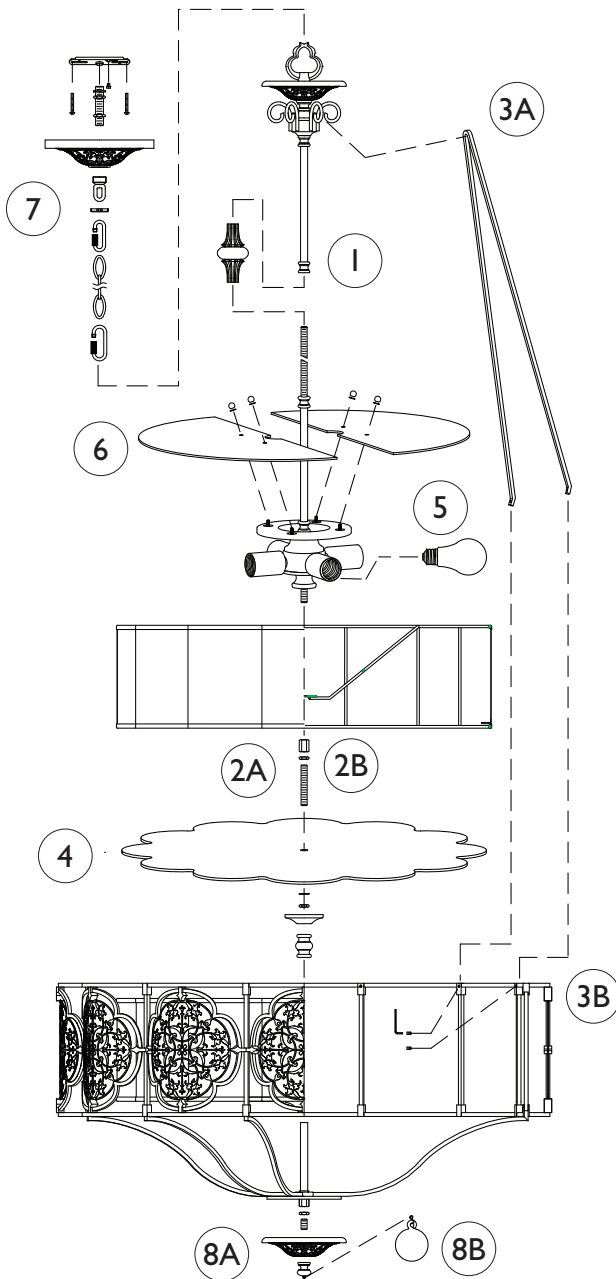

### IMPORTANT

### TURN OFF THE POWER AT THE MAIN FUSE OR CIRCUIT BREAKER BOX BEFORE STARTING INSTALLATION

Carefully unpack and identify all parts before assembly. Bulbs not included.

- Slip center column through fixture wires and then install by screwing on top of socket assembly.
- Install a hex nut onto one end of long threaded pipe leaving about 3/8" (10 mm) of thread exposed.
  - Install inner shade onto bottom of socket assembly by fastening with a lock washer and threaded pipe. Tighten hex nut.
- Hook top of arm onto center column.
  - Then install bottom ends of arm by fastening onto corresponding holes on top of main frame. Use enclosed hex key to tighten set screws.
  - Repeat other arms.
- Install glass plate onto bottom of inner shade by fastening with a round washer and lower column. **IMPORTANT: DO NOT OVERTIGHTEN.**
- Install light bulbs (not included). See relamping label located at socket area for type and maximum allowed wattage.
- Install two glass plates on top of socket assembly by placing holes in plates through four screw studs and securing with four cap nuts. **IMPORTANT: Do not over tighten.**
- Follow enclosed supplement installation instructions for electrical and fixture installation onto house outlet box. If you do not have an outlet box at desired location to attach the fixture then hire a qualified electrician to create one.
- Place cover against bottom of lower assembly, and then secure by fastening with finial.
  - Hang glass drop at bottom of finial.

**NOTE:** To replace broken drop or pin, extras are included in hardware bag. Replace by gently bending open pin, remove broken drop or pin, hook new one, then close back pin. Avoid bending pin into sharp angle.



**MURRAY**  
**FEISS**

GENERATION  
BRANDS