

Assembly Instructions For

OL7811 (E) 12/10

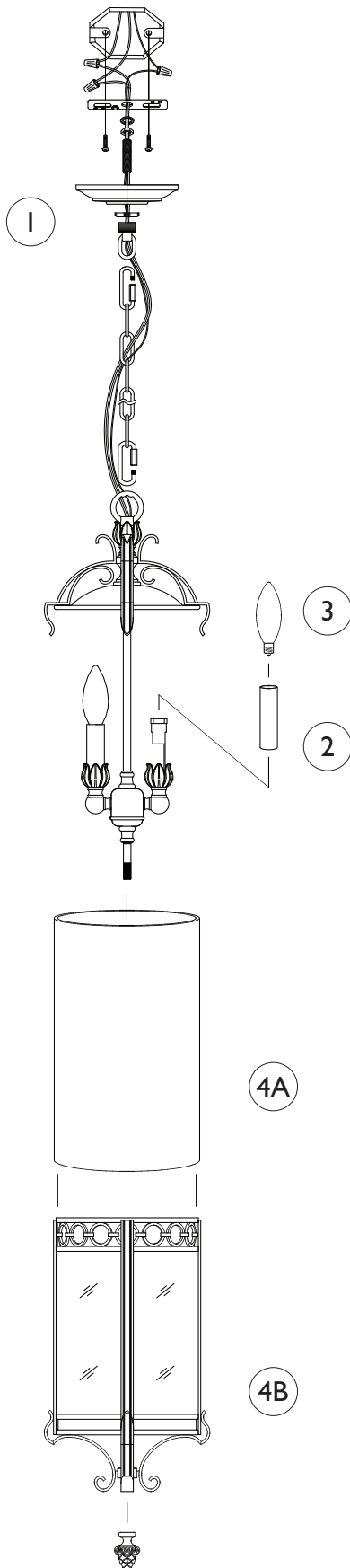

IMPORTANT
TURN OFF THE POWER AT THE MAIN FUSE OR
CIRCUIT BREAKER BOX
BEFORE STARTING INSTALLATION

Carefully unpack and identify all parts before assembly.
Bulbs not included.

1. Follow enclosed supplement installation instructions for electrical and fixture installation onto house outlet box. If you do not have an outlet box at desired location to attach the fixture than hire a qualified electrician to create one.
2. Slip candle tube onto sockets.
3. Install light bulb (not included). See relamping label at socket area for type and maximum allowed wattage.
4. A. Gently slip glass shade inside of main frame.
B. Slide the main frame up until it checks inside of main cover. Then lock them into position by fastening with finial.

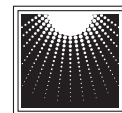

MURRAY
FEISS

GENERATION
BRANDS™ 