

Assembly Instructions For

SF293 (E) 12/10

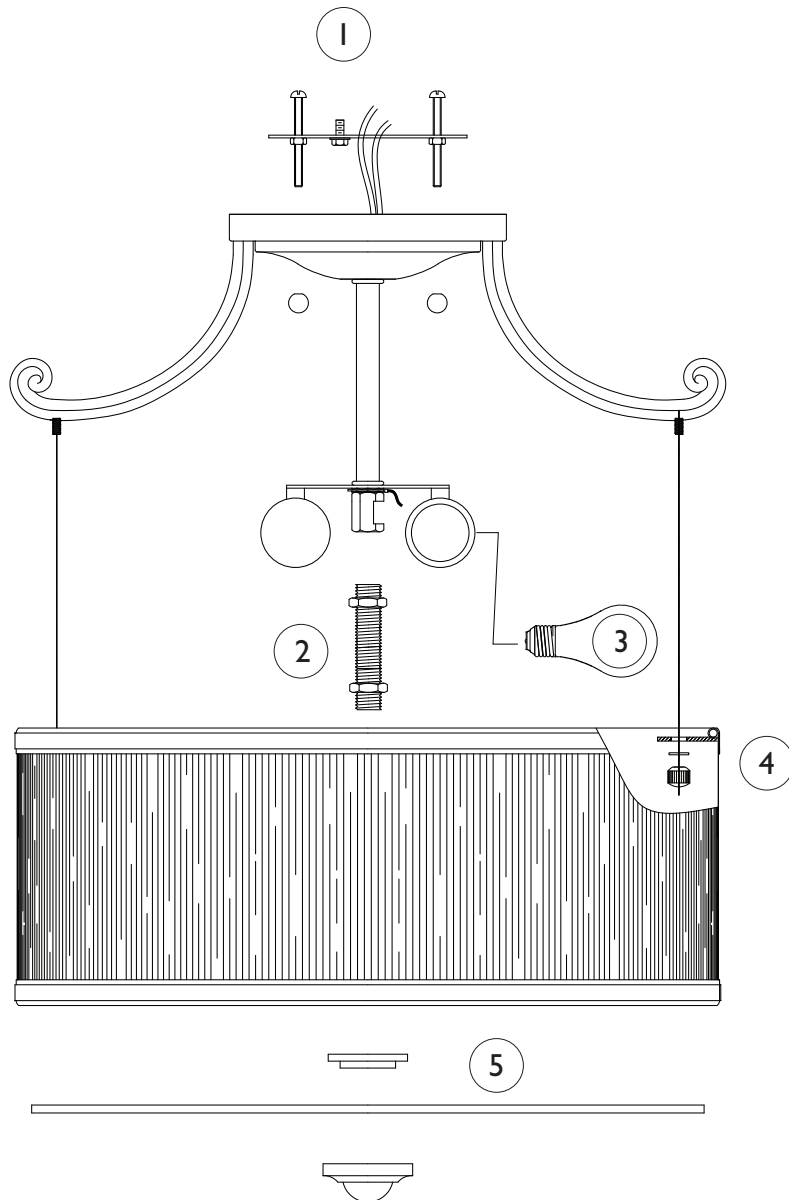

IMPORTANT
TURN OFF THE POWER AT THE MAIN
FUSE OR CIRCUIT BREAKER BOX
BEFORE STARTING INSTALLATION

Carefully unpack and identify all parts before assembly. Bulbs not included.

1. Follow enclosed supplement installation instructions for electrical and fixture installation onto house outlet box. If you do not have an outlet box at desired location to attach the fixture then hire a qualified electrician to create one.
2. Install long threaded pipe onto coupler.
3. Install light bulb (not included). See relamping label at socket area for type and maximum allowed wattage.
4. Install shade onto the fixture and secure with cap nuts and washers.
5. Slip glass plate through long threaded pipe until it securely checks into bottom of shade. Secure in position by fastening with a spacer and finial as shown.

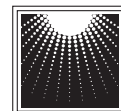

MURRAY
FEISS

GENERATION
BRANDS™