

Assembly Instructions For **WB1470** (E) 10/09

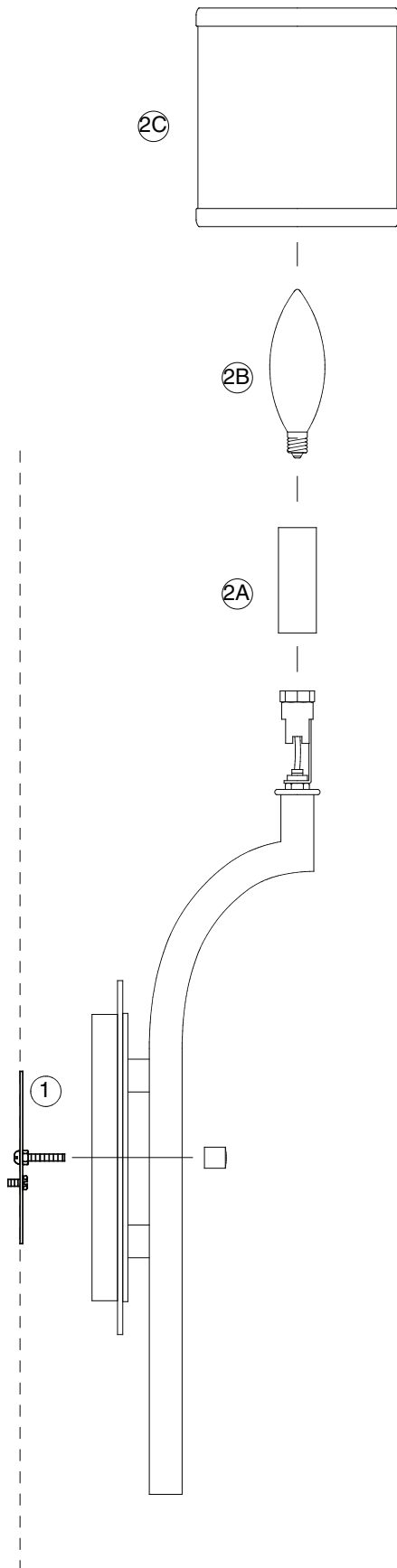

IMPORTANT
TURN OFF THE POWER AT THE MAIN FUSE OR
CIRCUIT BREAKER BOX
BEFORE STARTING INSTALLATION

Carefully unpack and identify all parts before assembly. Bulb not included.

1. Follow enclosed supplement installation instructions for electrical and fixture installation onto house outlet box. If you do not have an outlet box at desired location to attach the fixture then hire a qualified electrician to create one.
2. A. Slip candle tube onto socket.
B. Install bulb (type-B, candelabra base, 60 Watt maximum / not included) by screwing into socket.
C. Install fabric shade by snapping onto installed bulb.

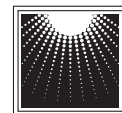

MURRAY
FEISS

GENERATION
BRANDS™ 