

Assembly Instructions For

WB1466 (E) 8/09

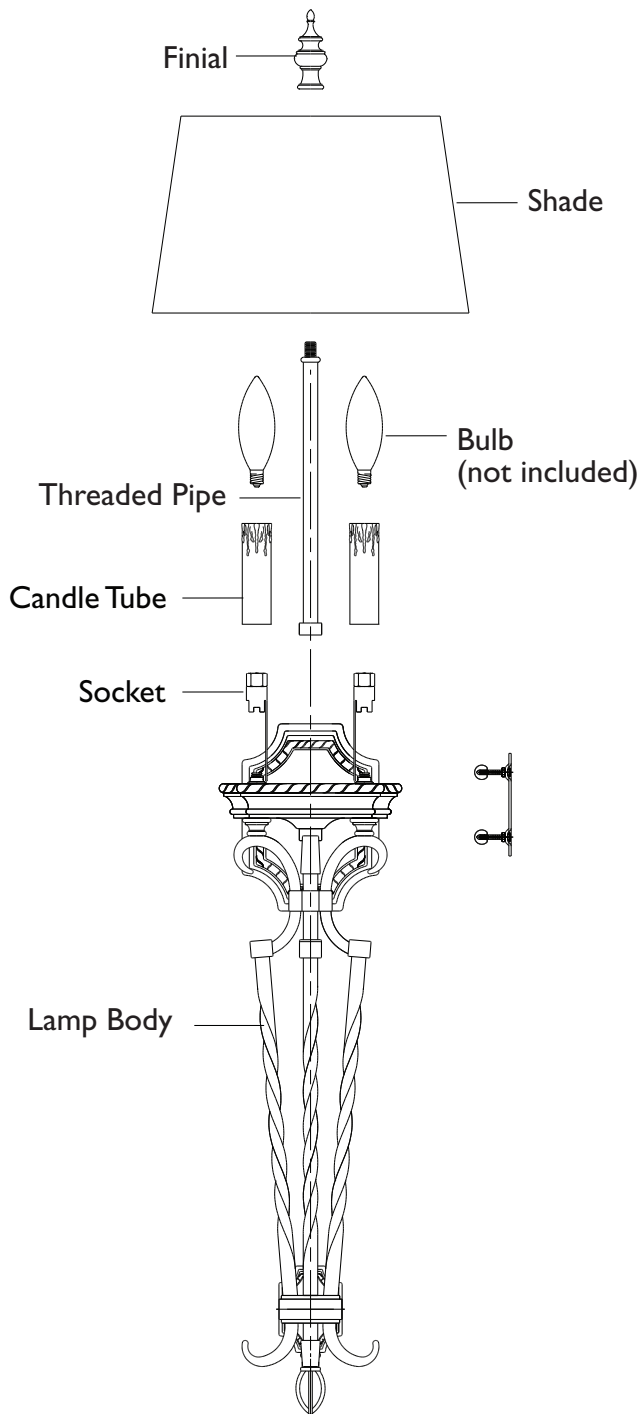

READ ALL INSTRUCTIONS BEFORE ASSEMBLING LAMP

Carefully unpack lamp parts onto carpeted surface or blanket and identify all parts.

1. Install candle tubes by slipping through sockets.
2. Install Type B, 60 Watt Max. Candelabra Base Bulbs (not included) into Sockets as noted on relamping label at Socket area.
3. Install Shade onto threaded pipe and screw finial onto short threaded pipe to secure shade.
4. Follow enclosed supplement installation instructions for electrical and fixture installation onto house outlet box. If you do not have an outlet box at desired location to attach the fixture than hire a qualified electrician to create one.

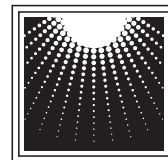

MURRAY
F E I S S

Generation Brands™