

WB1280, WB1281

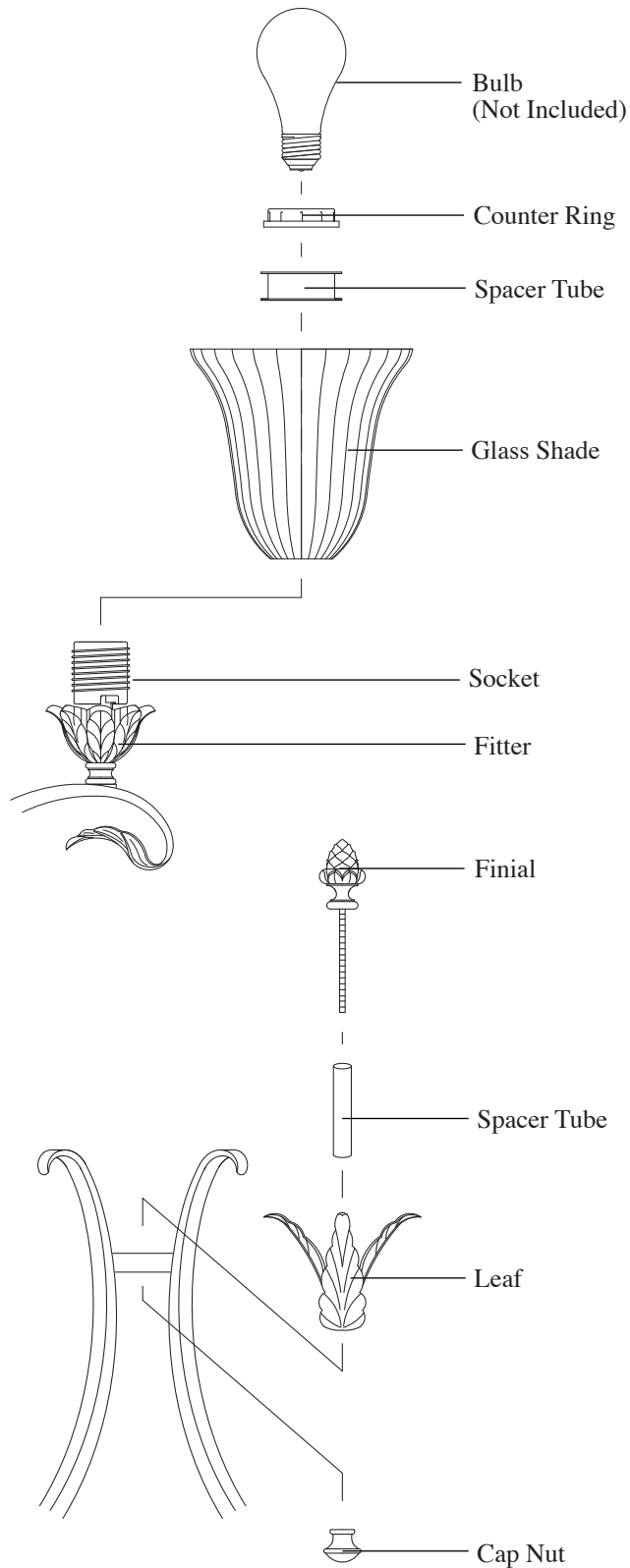

IMPORTANT:
TURN OFF THE POWER AT THE MAIN FUSE OR CIRCUIT BREAKER BOX BEFORE STARTING INSTALLATION

1. Carefully unpack and identify all parts before assembly. Bulbs are not included.
2. Before proceeding below instructions follow enclosed **“Multiple Standard Installation Instructions”** for electrical and fixture installation onto wall outlet box.
3. Remove counter ring and spacer tube from socket. Set them aside.
4. Install glass shade onto fitter and lock into position by installing the spacer tube and counter ring back onto the socket.
5. Install light bulb (not installed). See relamping label at socket area for type and maximum allowed wattage.
6. **WB1281 ONLY:** Install finial and leaf onto fixture as shown at illustration.

WB1281 ONLY