

IMPORTANT SAFETY INSTRUCTIONS

To reduce the risk of fire, electrical shock, exposure to excessive UV radiation, or injury to person:

- Be sure the electricity to the circuit you are working on is turned off; either the fuse removed or the circuit breaker set at off.
- This product is suitable only for dry locations only
- Do not look directly at the lighted lamp.
- Do not remain in light if skin feels warm.
- Risk of fire: Use only the type of lamp and maximum wattage indicated in this instruction manual.
- Never turn the fixture on and off by installing and removing the halogen lamp.
- Do not touch the fixture shades or lamp shield while the fixture is on. These surfaces may be HOT.
- To avoid glare, hang the fixture 18" above the table.
- If you are unclear as to how to proceed, contact a qualified electrician.
- Use of other manufacturers components will void warranty, listing, and create a potential safety hazard.
- This product must be used with the RTx low voltage lighting series by Sea Gull Lighting.
- Save these instructions.

HALOGEN LAMP GENERAL INFORMATION

A new halogen lamp may smoke slightly when it is used for the first time. This is perfectly normal; the protective coating is simply being vaporized.

TWO TIPS FOR PROLONGING HALOGEN LAMP LIFE

- First avoid touching the lamp with bare hands during installation. Any contaminant, even the oil from your hands can deteriorate the lamp. Rubbing alcohol can be used to remove any contaminant.
- Second, do not run the lamps at full power when you do not need to. However, if dimming the fixture for an extended period of time, occasionally bring the light up to full brightness for a few minutes to complete the halogen cycle.

Adjust The Fixture Height

1A

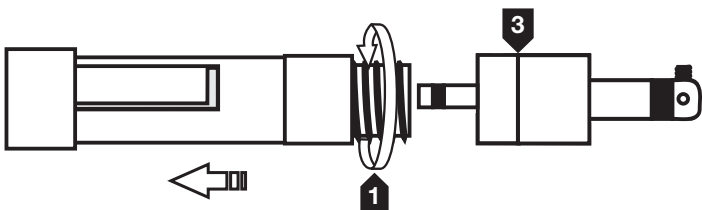

- 1 ➔ Unthread rail adapter (H) from male connector (D)

1B

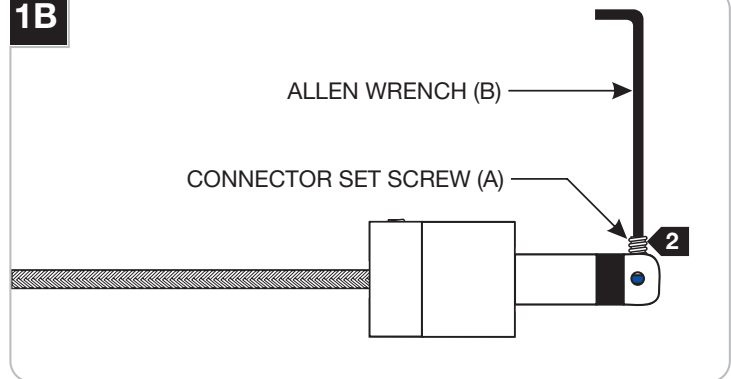

- 2 ➔ Back out (**DO NOT REMOVE**) the connector set screw (A) with the provided Allen wrench (B).

1C

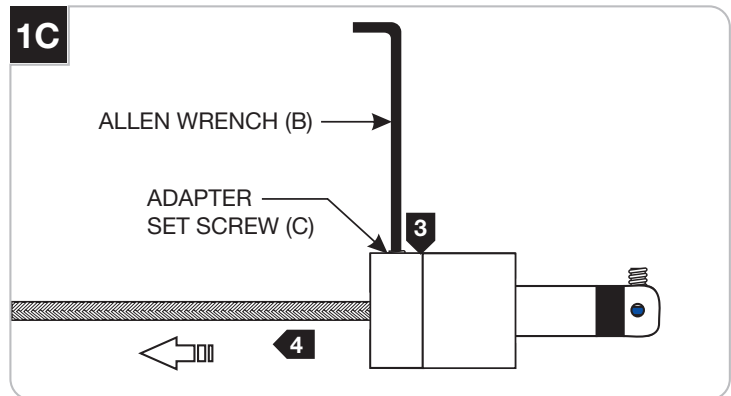

- 3 ➔ Back out (**DO NOT REMOVE**) the adapter set screw (C) on the cylindrical connector with the provided Allen wrench (B).

- 4 ➔ Pull the coaxial cable out.

1D

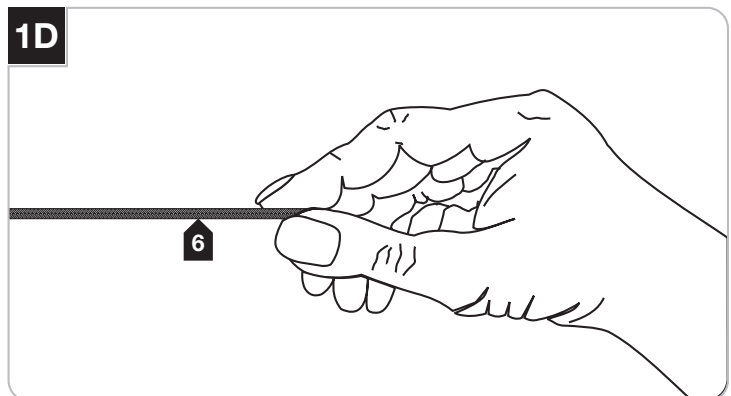

- 5 ➔ Cut the coaxial cable to the desired length.

- 6 ➔ Gently twist the end of the coaxial cable between thumb and forefinger.

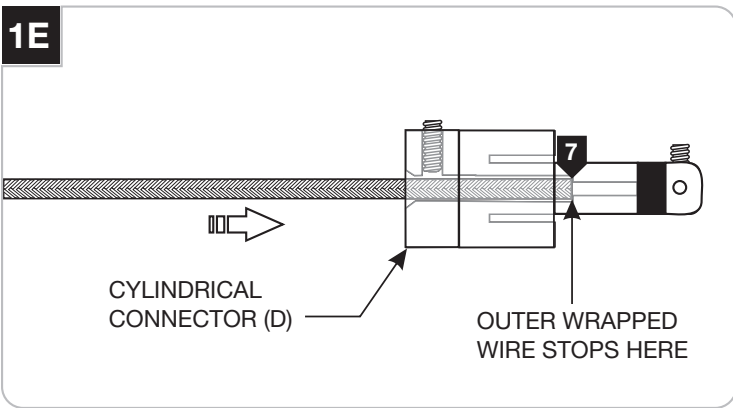

- 6** Strip 1/2" of plastic off of center conductor. Feed and push the coaxial cable into the cylindrical connector (D). The coaxial cable will come to a stop point after being inserted approximately 3/4" into the cylindrical connector (D).

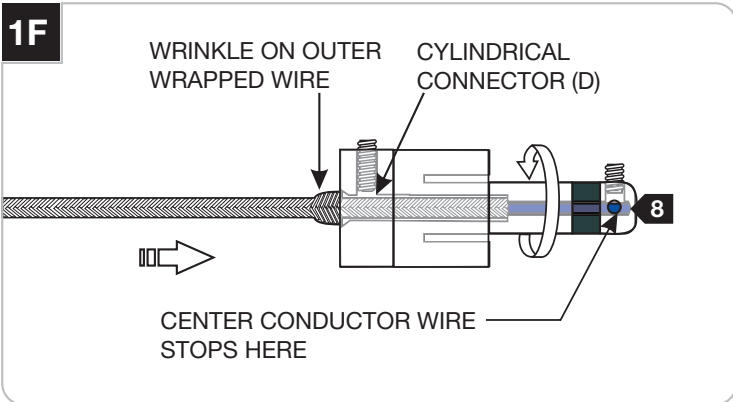

- 8** Keep pushing the coaxial cable into the connector (D) while rotating the connector to ease feeding the inner wire into the tip of the connector. The outer wrapped wire will start wrinkling while being inserted another 1/2" into the connector (D).

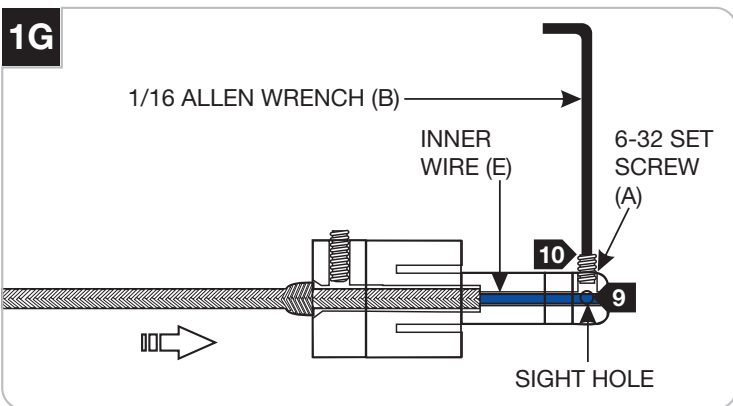

- 9** Look into the sight hole on the top of the connector (D) to make sure that the inner wire (E) is contacting the end of the connector (D).

- 10** Hold the coaxial cable in place and tighten the #6-32 set screw (A) on tip of the connector (D) with the provided 1/16 Allen wrench (B). **Make sure that this set screw connection is tight.**

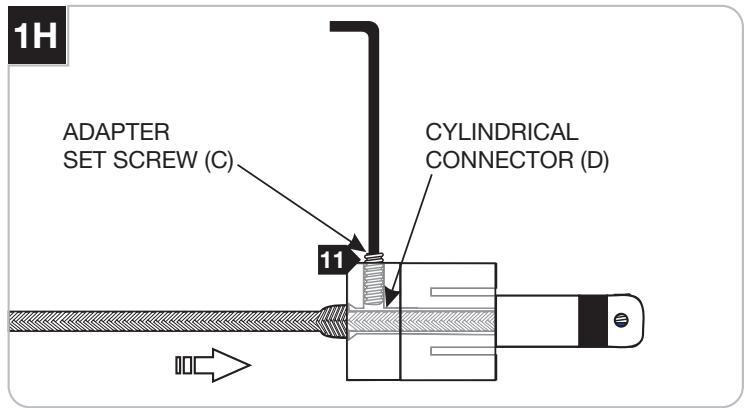

- 11** Tighten the adapter set screw (C) on the cylindrical (D) connector so adapter set screw makes contact with outer wrapping. **DO NOT OVER TIGHTEN.** Over tightening may cause a short in your RTx system.

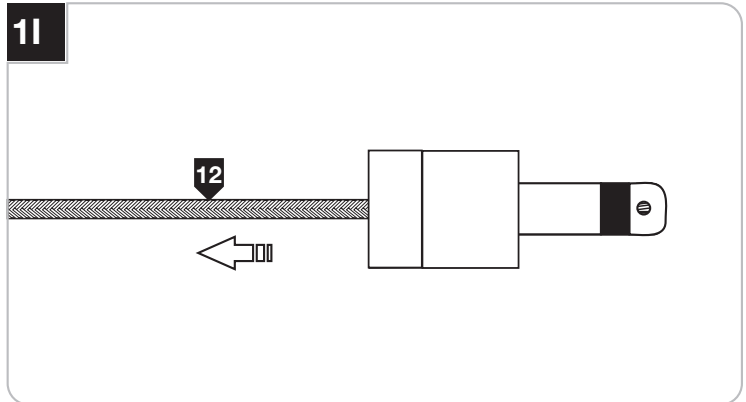

- 12** Pull the outer wrapping of the coaxial cable toward the fixture to smooth the wrinkles.

Installing the Rail Connector to the Rail

2A

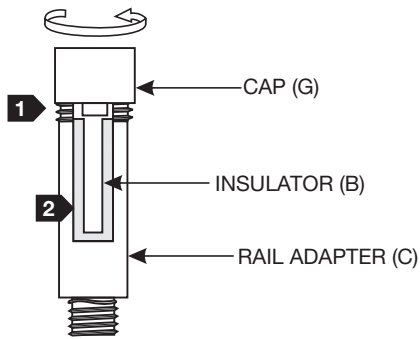

- 1 Remove the cap (A) from the rail adapter (C).
- 2 **DO NOT REMOVE** the insulator (B).

2B

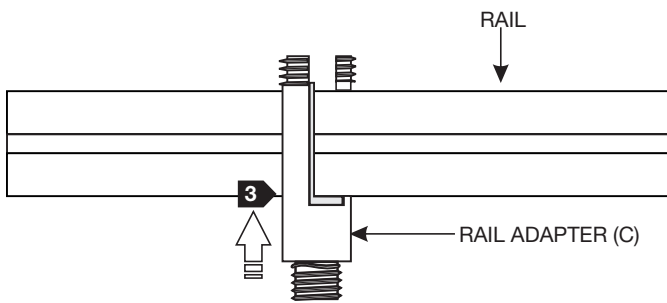

- 3 From bottom of the rail push the rail adapter (C) all the way onto the rail.

2C

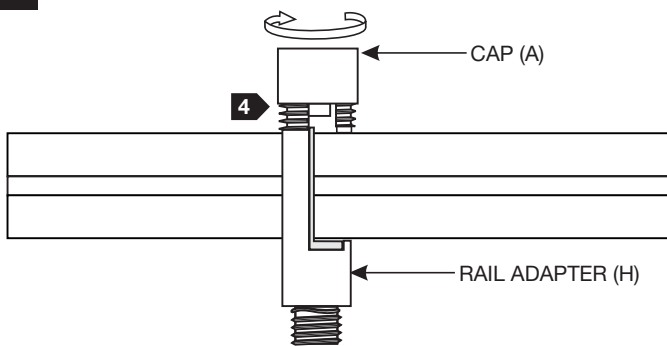

- 4 Replace and tighten the cap (A) to the rail adapter (C).

NOTE: In case of cross threading, unscrew the cap (A) from the rail adapter (C) and repeat step 4.

Connecting the Fixture to the Rail Connector

3A

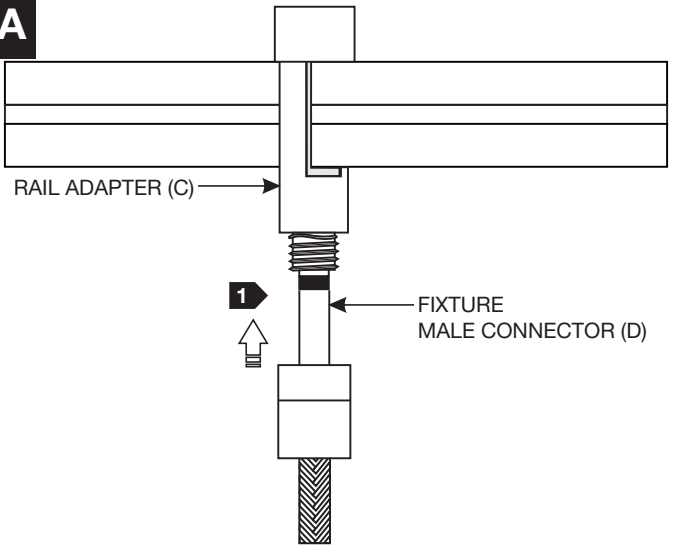

- 1 Push the fixture male connector (D) all the way into the rail adapter (C).

3B

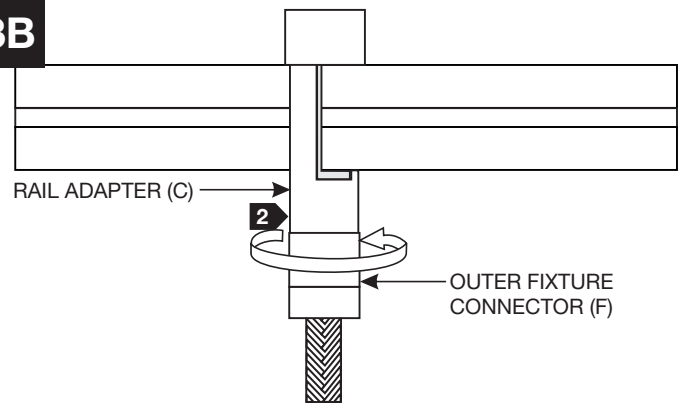

- 2 Tighten the outer fixture connector (F) to the rail adapter (C).

Connecting the Fixture to the Monopoint Canopy

4A

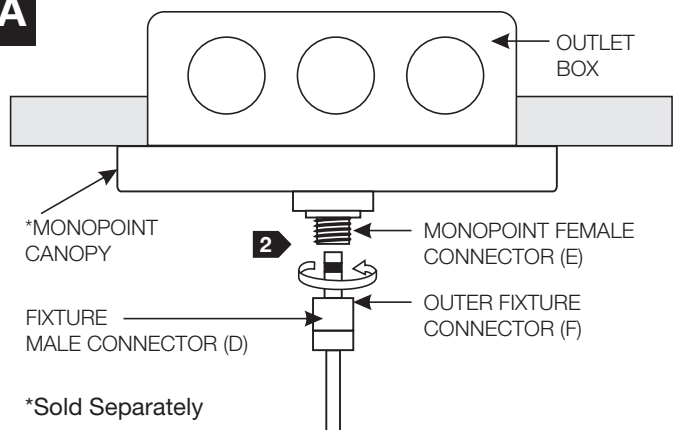

- 1 Insert fixture male connector (D) into monopoint female connector (E).
- 2 Thread the outer fixture connector (F) to the monopoint female connector (E) to secure.

Replacing the Lamp

CAUTION: To reduce the risk of a burn or electric shock during relamping, disconnect the power to the fixture.

5A

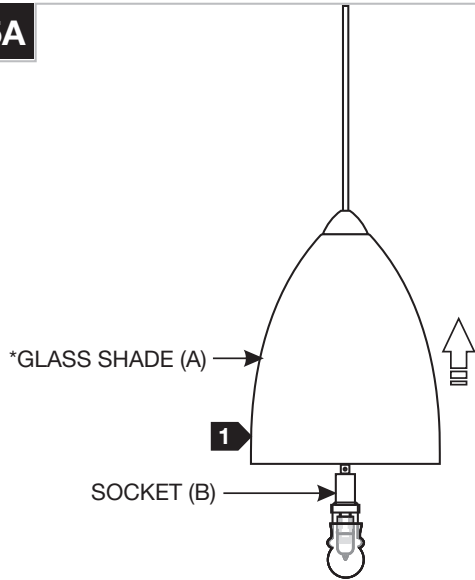

*not supplied

- 1** Lift the glass shade (A) (sold separately) up to expose the socket (B).

NOTE: Use only your fingers and a soft cloth to replace the lamp.

5B

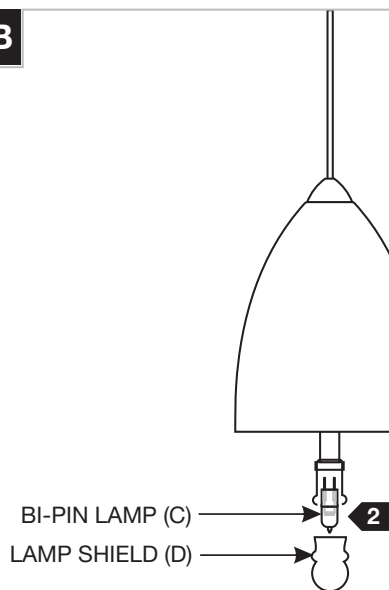

- 2** Remove the lamp shield (D) and the old lamp (C).

Use **MAX** 50 Watt, 12 volt Bi-Pin Halogen Lamp. 

5C

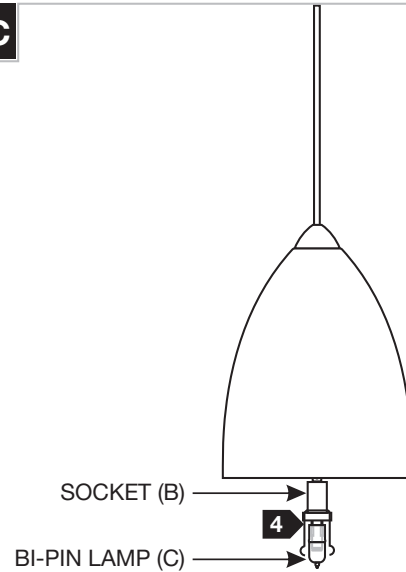

- 3** Handle the new replacement lamp (C) with a soft cloth to prevent the natural oils on the fingertips from collecting on the lamp (C). This will help extend the life of the lamp (C).

- 4** Gently insert the new lamp (C) into the socket (B).

5D

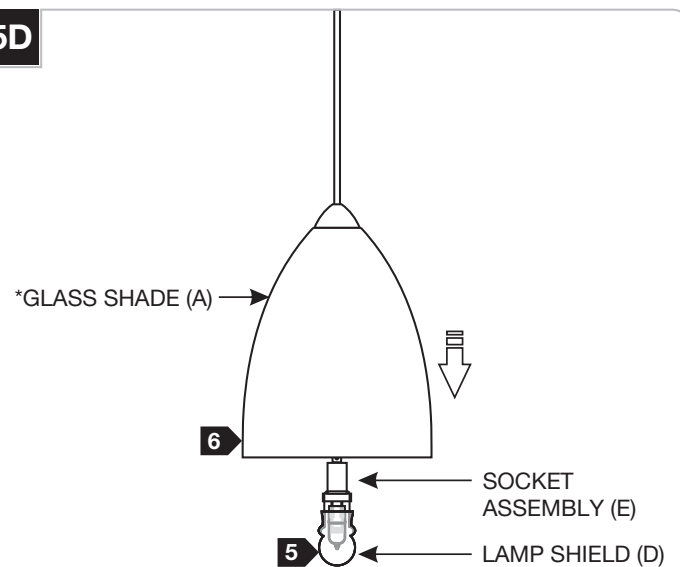

- 5** Push the lamp shield (D) onto the spring clip.

- 6** Lower the glass shade (A) onto the socket assembly.