

assembly & operating instructions



item # 13008

lifetime limited warranty

Your Drive brand product is warranted to be free of defects in materials and workmanship for the lifetime of the original consumer purchaser.

This device was built to exacting standards and carefully inspected prior to shipment. This Lifetime Limited Warranty is an expression of our confidence in the materials and workmanship of our products and our assurance to the consumer of years of dependable service.

In the event of a defect covered by this warranty, we will, at our option, repair or replace the device.

This warranty does not cover device failure due to owner misuse or negligence, or normal wear and tear. The warranty does not extend to non-durable components, such as rubber accessories, casters, and grips, which are subject to normal wear and need periodic replacement.

If you have a question about your Drive device or this warranty, please contact an authorized Drive dealer.



© 2005 Medical Depot, Inc. All rights reserved.
Drive is a trademark of Medical Depot, Inc.
Port Washington N.Y. 11050 USA Made in China

deluxe, tilt-top
overbed table

item # 13008

www.drivemedical.com

drive
MEDICAL DESIGN & MANUFACTURING

assembly instructions

- 1 Lay tabletop Assembly (#2 & #11) on flat surface with top bracket assembly facing up, as shown in Fig. 1.
- 2 Install column assembly into top bracket as shown with release handle facing away from table top edge (fig. 1). Insert shoulder bolt (#4) through top bracket and column assemblies. Fasten with locknut (#5)
- 3 Lay the base flat with holes facing up and insert a caster (#10) into each hole. (4 casters total)
- 4 Place the two bolts (#9) into the bolt plate (#8) and place through the base (#7). Hold base steady while hand tightening bolts (#9) into column (#6).
- 5 Align the base and top assembly by laying the table on its side, resting on the edge of the top and the black caster plugs. Tighten the bolts (#9) with a 9/16" wrench.
- 6 Stand the table up on its casters.
- 7 Remove black lock screw in the column and discard. Replace with the extra zinc plated screw shipped with unit, using a Phillips screwdriver.

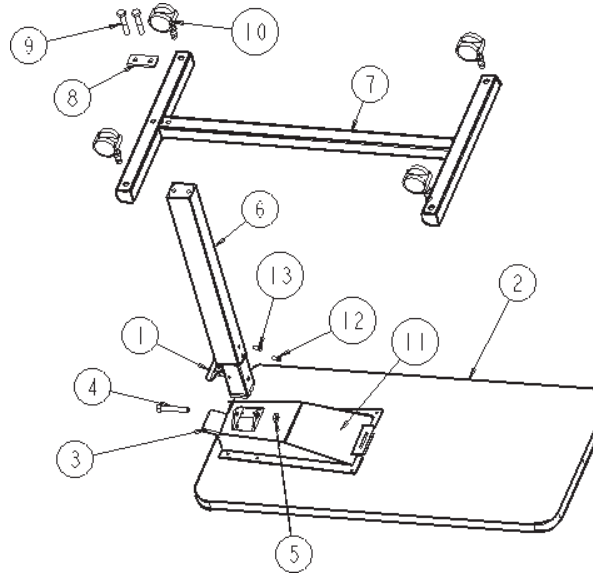

FIG. 1

operating instructions

- 1 Pull the release handle (#1) up to raise and lower the tabletop.
- 2 To tilt the tabletop in either direction, squeeze the tilt lock lever (#3) up and rotate the tabletop. Release Tilt Lever to lock the top into place.

parts list

1. Release Handle (101044)
2. 15 x 30 Table Top
3. Tilt Lock Lever (093025)
4. Shoulder Bolt (093011)
5. 3/8-16 Lock Nut (N06)
6. Column Assembly (95001)
7. Base with Caster Plugs
8. Bolt Plate (101023)
9. 3/8 -16 x 2 bolts (BT01)
10. Casters (CA02)
11. Top Bracket (093008)
12. Black Shipping Screw
13. Zinc Screw (do not remove)

TOOLS REQUIRED

Phillips Screwdriver
(2) 7/16" Wrenches
9/16" Wrench