



FIJI

Assembly Instructions | Instructions de Montage |
Montageanleitung | Instrucciones de Montaje | Istruzioni di
montaggio | Montagevoorschrift | Instruções de montagem



WWW.KETER.COM

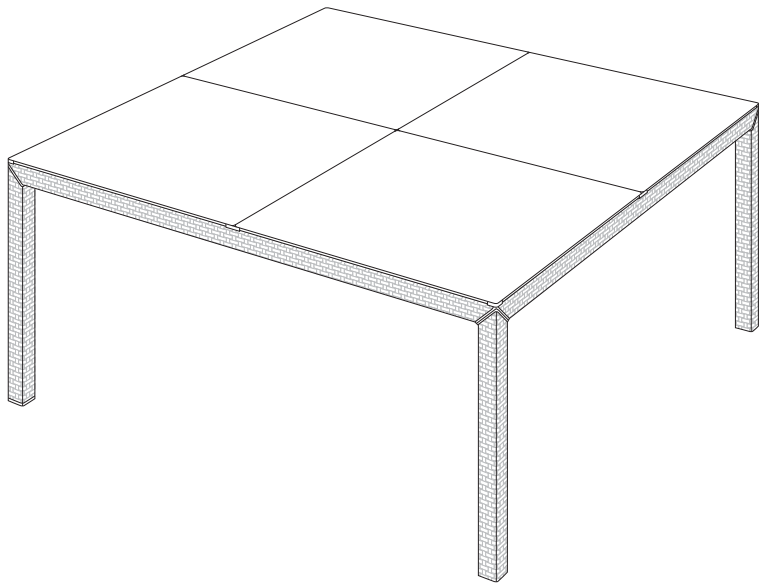

Notes and Warnings – Please Read Carefully Prior to Assembly
Notes et avertissements – Veuillez lire attentivement avant l'assemblage
Anmerkungen und Warnhinweise – Bitte sorgfältig vor der Montage lesen
Opmerkingen en waarschuwingen – Voor het monteren aandachtig doorlezen
Notas y advertencias: lea con atención antes de montar
Osservazioni e avvertimenti – Leggere attentamente prima dell'assemblaggio
Notas e Avisos – Leia cuidadosamente antes da montagem

- EN** • Please assemble the table on a flat surface.
• A dedicated Allen key is enclosed for assembly.
• Only a standard Philips screwdriver is required in addition to this wrench.
• The table should only be cleaned using soap, water and a soft cloth.
• The table is only intended for reasonable domestic or contract use.
- FR** • Veuillez assembler la table sur une surface plane.
• Une clef Allen spécialement prévue pour l'assemblage est incluse.
• Seul un tournevis cruciforme standard est nécessaire en plus de la clef.
• Pour nettoyer la table, utilisez un chiffon doux, de l'eau et du savon uniquement.
• La table est destinée à un usage domestique ou professionnel raisonnable.
- DE** • Bitte montieren Sie den Tisch auf einer ebenen Fläche.
• Ein zur Montage geeigneter Sechskantschlüssel ist beigelegt.
• Zusätzlich zu dem Sechskantschlüssel wird nur noch ein normaler Kreuzschraubendreher benötigt.
• Zur Reinigung des Tisches sind nur Seifenlauge, Wasser und ein weiches Tuch zu verwenden.
• Der Tisch ist nur zur angemessenen privaten oder kommerziellen Nutzung ausgelegt.
- NL** • Monteer de tafel op een egaal oppervlak.
• Voor montage is een passende stiftsleutel bijgesloten.
• Behalve deze sleutel is alleen een standaard phillips schroevendraaier nodig.
• De tafel mag alleen met water, zeep en een zachte doek worden gereinigd.
• De tafel is alleen voor redelijk huishoudelijk en commercieel gebruik bedoeld.
- ES** • Monte la mesa sobre una superficie plana.
• Se adjunta una exclusiva llave Allen para el montaje.
• Sólo se necesita un destornillador Philips estándar además de esta llave.
• La mesa sólo debe limpiarse utilizando jabón, agua y un paño suave.
• La mesa está diseñada sólo para uso doméstico o comercial razonable.
- IT** • Assemblare ogni componente su una superficie piana.
• Nel set è inclusa una chiave a brugola dedicata da utilizzare per l'assemblaggio.
• Oltre alla chiave, occorre soltanto un normale giravite a stella.
• Per la pulizia dei componenti del tavolo, utilizzare solo sapone, acqua e un panno pulito.
• Il tavolo è concepito per uso domestico o da ufficio.
- PT** • Monte cada peça da mesa numa superfície plana.
• Foi incluída uma chave hexagonal exclusiva para a montagem.
• Para além desta chave, é necessária apenas uma aparafusadora Philips.
• As peças da mesa devem ser limpas apenas com sabão, água e um pano macio.
• A mesa destina-se a um uso doméstico ou empresarial normal.

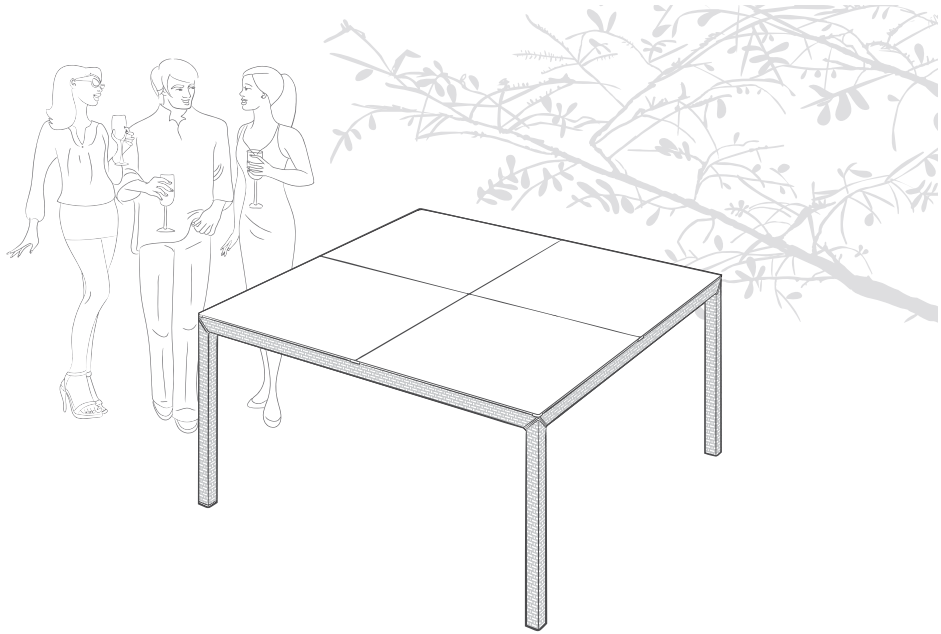

Contents • Contenu • Inhalt • Inhoud • Contenidos • Contenido • Conteúdo

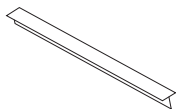

x2

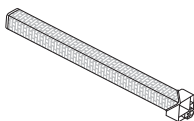

x4

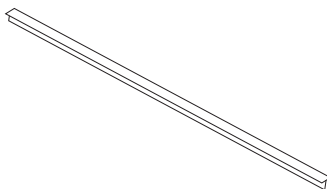

x1

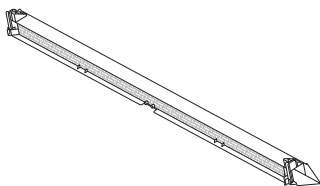

x4

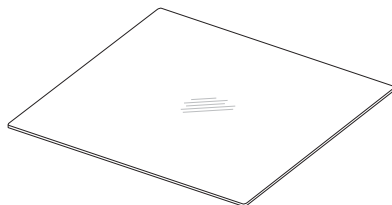

x4



GHx4



SDx4



CCx1



x4



x8



x4



x1

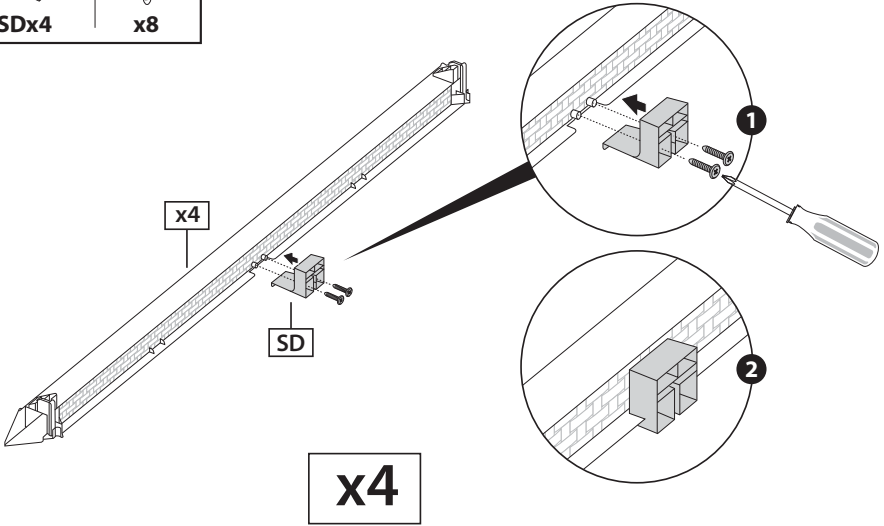
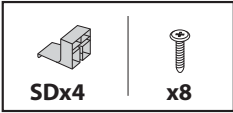

1

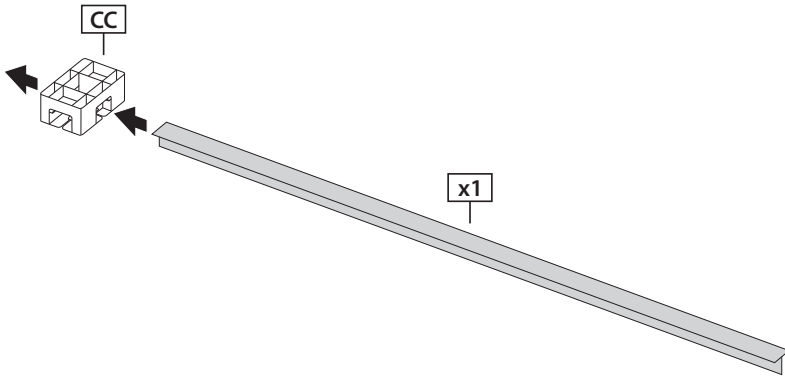
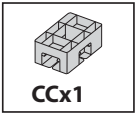

2

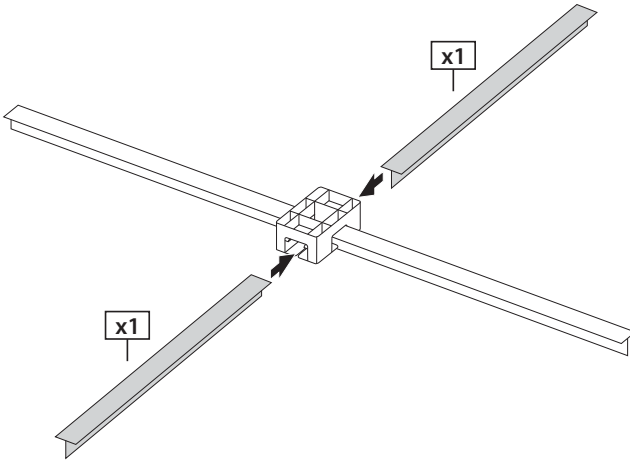
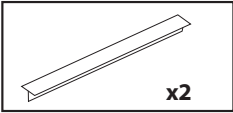

3

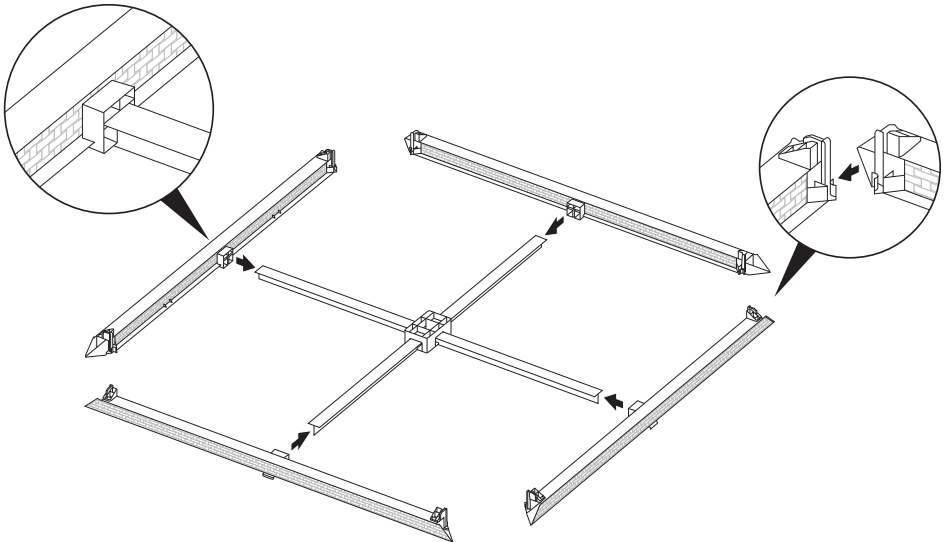

4

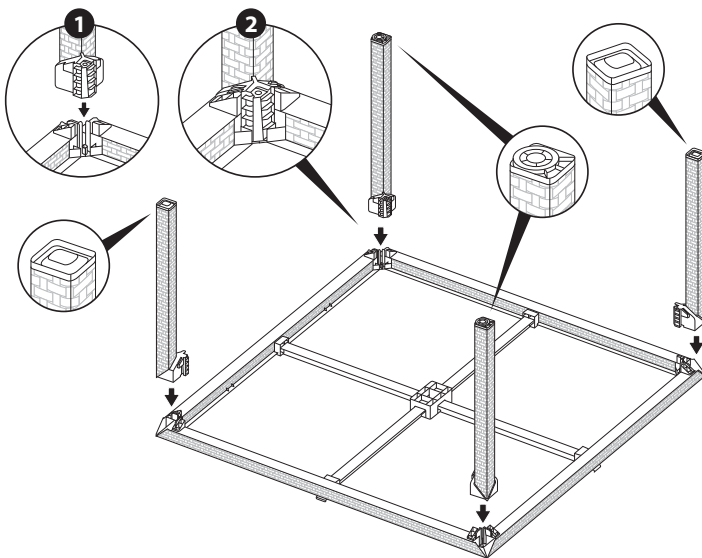

5

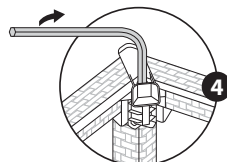
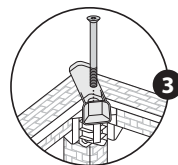
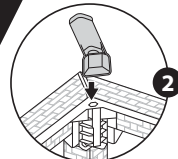
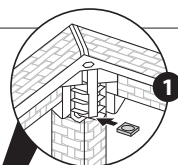
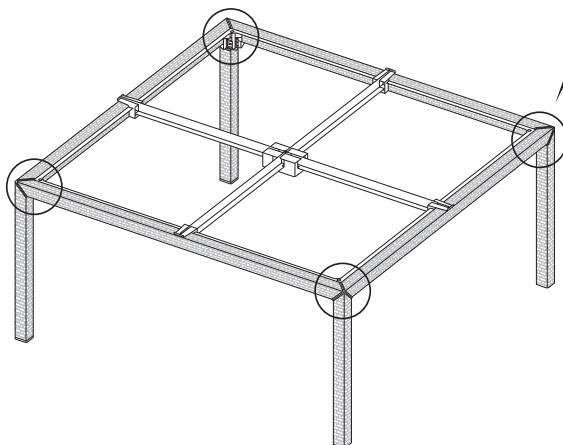
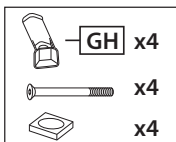
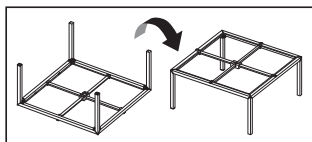

6

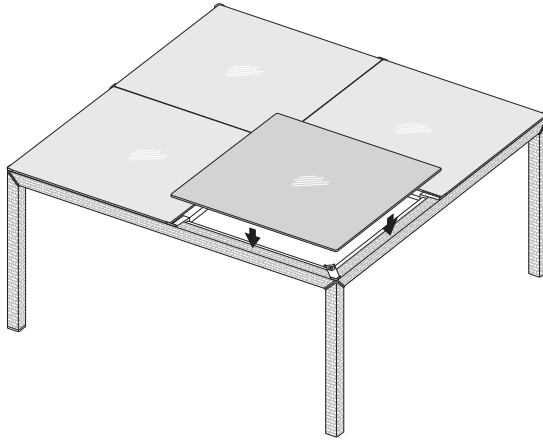

7

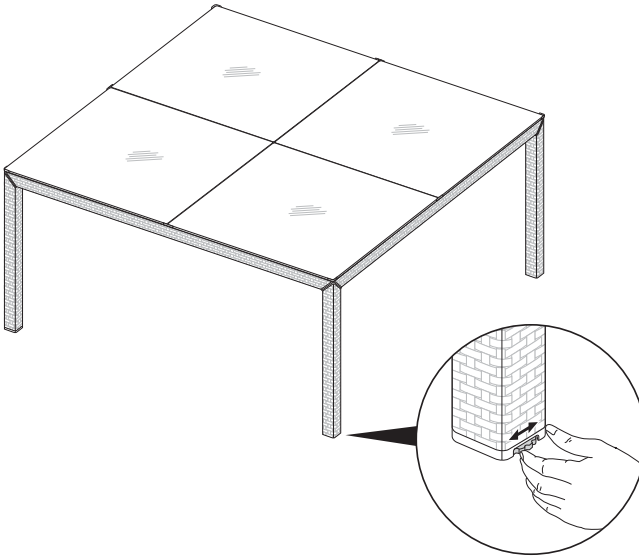

8
