

SPECIFICATIONS:

DESCRIPTION

Low Voltage, 50W swing-arm luminaire with handcrafted European glass. Arm rotates 130° and raises/lowers. Lamp holder pivots. Employs a Class 2 electronic low-voltage transformer and full-range rotary dimmer.

MOUNTING

Installs directly to a 4" octagonal outlet box.

LAMPING

50W Halogen 12V Bi-Pin GY6.35 low pressure lamp (included). 

DIFFUSER

Shade shall be handcrafted glass of various decors. Diameter of 3.25" and height of 3.0"

CONSTRUCTION

Fixture utilizes solid brass construction, with decorative metal finish. Two parallel 8mm arced tubes raise and lower on canopy pivot.

METAL FINISH

Fixture shall be finished in either Bronze or Satin Nickel.

CORD & PLUG KIT

See back page for optional cord and plug kit that allows the swing-arm to plug into a standard 120V receptacle.

LABELS

UL listed. Suitable for Damp Locations (interior use only).



1WW-514500-SN

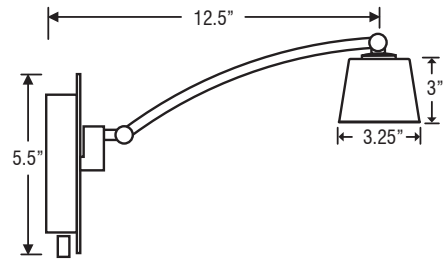

ORDERING:

1	W	W	-	-	-	-	-	-	-	-	-	-	-
Fixture Style	Shade			Metal Finish									
1WW Swing-arm	5145CF	Stone Copper Foil	BR Bronze										
	5145GF	Stone Gold Foil	SN Satin Nickel										
	5145OS	Opal Stone											
	5145SF	Stone Silver Foil											
	514500	Clear Stone											



Glass dimensions provided are nominal. Allowance must be made for dimensional tolerance in handcrafted glasses.

REVISED 10/08

Project Information:

12V Swing-Arm Luminaire: 1WW Additional Information



DAMP
INTERIOR

Mounting: Canopy Back Plate

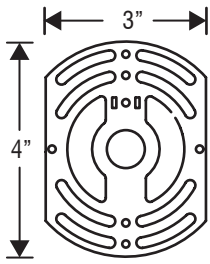

CORD/PLUG KIT ORDERING:

CORD & PLUG KIT (TO BE ORDERED SEPARATELY)

When no junction box is available, the T120 kit allows the swing-arm luminaire to plug into a standard 120V receptacle as a fully UL Listed "fixed portable". Includes a 6' cord and 18" cord cover.

Item	Metal Finish
T120-BR	Bronze
T120-SN	Satin Nickel

