



ASSEMBLY INSTRUCTIONS

# **Work Surface Support**

---

# Assembly Instructions Overview

Please read this brief overview before assembling your Hercke Series 7even system. What follows is an outline of the order in which your assembly process needs to occur.

1

A Phillips head NO. 2 screwdriver is the only tool required to assemble Hercke® Series 7even® products. Depending on your installation requirements, other tools that may be helpful include a level, power drill and drill bits.

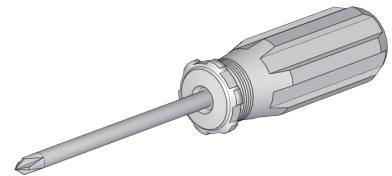

2

Assemble all platforms. Place platform in the desired location. Level each platform and make sure all platforms are level together.

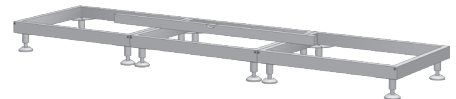

3

Pull platform out allowing yourself room to get behind the platform. Assemble cases. Stack cases and drawers on platforms in a single stack. Add Single E-Clips to the backside of cases and drawers. Slide the stack back into their final level position.

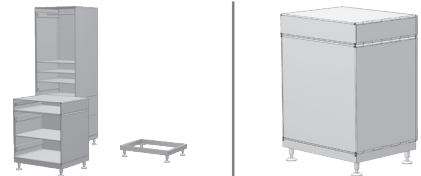

4

Assemble Overhead Storage Cases. Select overhead cabinet placement. Attach case using Wall Mount System or Channel Mount System.

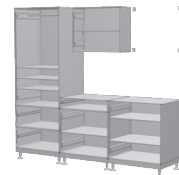

5

Fasten Single and Double E-Clips to adjoin cases and drawer modules.

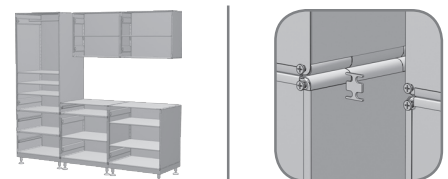

6

Snap door hinges to case hinge plates and adjust door positions.

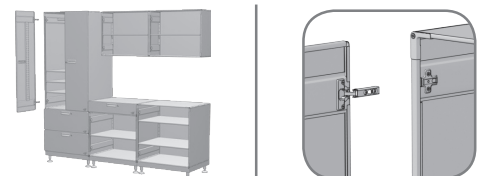

7

Attach work surface.

Chaos Defeated. Order Restored.



## PARTS

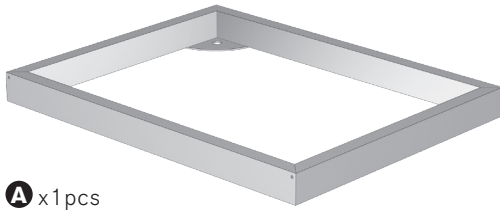

**A** x1 pcs  
Work Surface Support  
Frame



**B** x2 pcs  
Legs



**C** x3 pcs  
Screws  
#2 Phillips Pan Head  
Machine Screw

# 1

- A** Assemble legs **B**.
- B** Fasten legs **B** to pre-attached threaded studs on base of work surface support frame **A**.

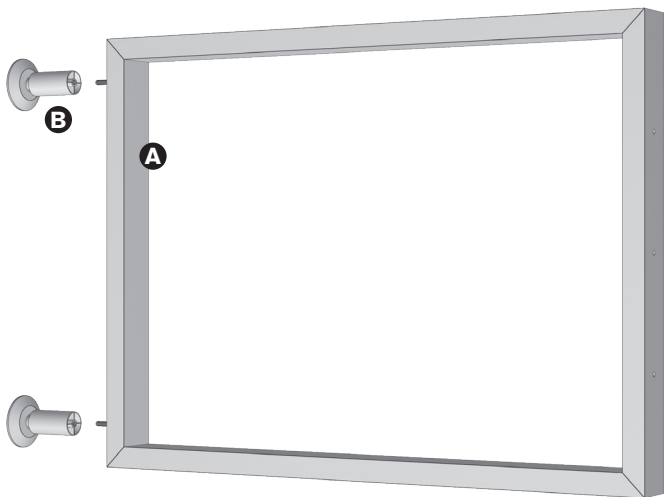
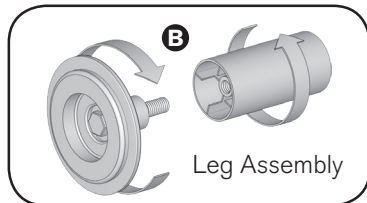

# 2

- A** Place work surface support in desired position under work surface.
- B** If necessary, flip work surface and work surface support upside down in order to drill pilot holes.
- C** Secure work surface support with provided screws **C** as illustrated below.

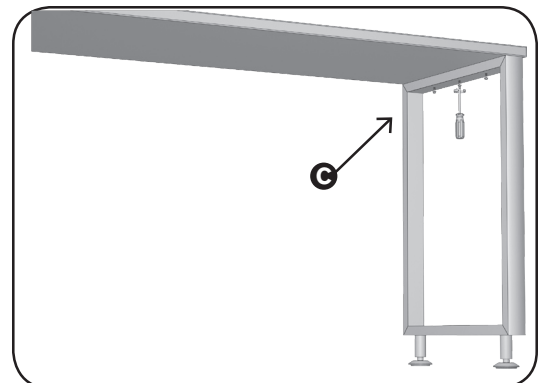
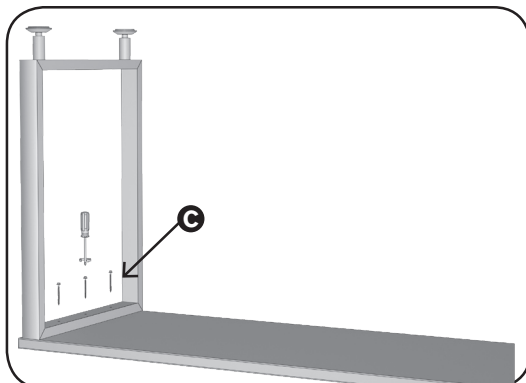

## CLEANING AND CARE

Clean stainless steel surfaces using dry soft cotton cloth and stainless steel polish, buffing vertically with the line finish of the stainless steel.

Clean painted surfaces and coated surfaces using a mild dish soap and warm water solution. **DO NOT** use abrasive cleaners, glass cleaners, solvent based cleaners or furniture polish.



**[www.hercke.com](http://www.hercke.com) | 866.767.3905 ext.16**

Please visit **[www.hercke.com](http://www.hercke.com)** to download these instructions in your preferred language.