

Family: Sorrento | Item No. 1421 AI

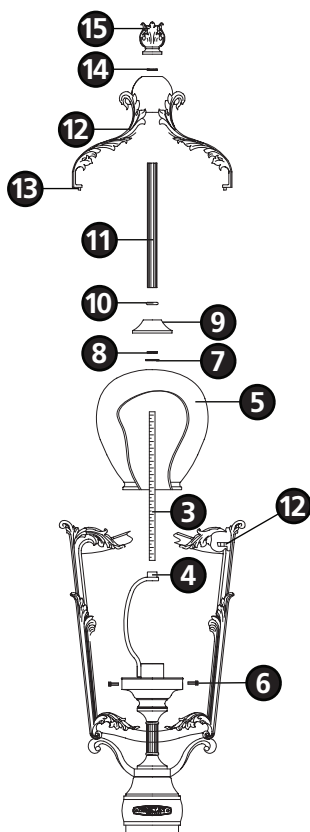

▼ start here

Drawing 1 - Fixture Assembly



Drawing 2 - Fixture Assembly

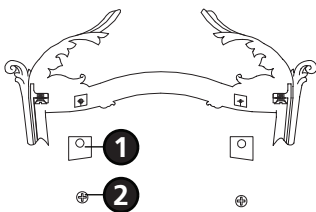

Drawing 2 - Fixture Mounting

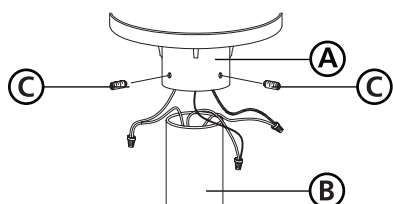

1

1. Find a clear area in which you can work.
2. Unpack fixture and glass from carton.
3. Carefully review instructions prior to assembly.

***** The construction of this fixture will be accomplished by first installing fixture glass, making all necessary electrical connections, mounting the fixture, lamping the fixture and then assembling fixture.**

2

1. To install glass, remove glass clips **(1)** by using a Philips screwdriver to remove screw **(2)** from inside the top edge of the cage - see **Drawings 2 and 1**.
2. Tilt glass panels at an angle and insert them through the panel opening on the side of the cage. Place bottom of glass behind the tab in the bottom of the cage.
3. After all panels are inserted replace the glass clips **(1)** removed earlier.

3

1. Fixture is mounted using 3 - 1/4-20 set screws.
2. Make all necessary electrical connections following wiring instructions below.

SAFETY WARNING: READ WIRING AND GROUNDING INSTRUCTIONS (I.S. 18) AND ANY ADDITIONAL DIRECTIONS. TURN POWER SUPPLY OFF DURING INSTALLATION. IF NEW WIRING IS REQUIRED, CONSULT A QUALIFIED ELECTRICIAN OR LOCAL AUTHORITIES FOR CODE REQUIREMENTS.

4

Make electrical connections from supply wire to fixture lead wires. Refer to instruction sheet **(I.S. 18)** and follow all instructions to make all necessary wiring connections. Then refer back to this sheet to continue installation of this fixture.

5

1. After wiring connections are complete, slip post fitter **(A)** over top of pre-installed post **(B)** making sure all wire connections are tucked inside the pole - see **Drawing 3**.
2. When fixture is slipped over pole make sure no wires are being pinched between the top edge of the pole and the inside of the post fitter.
3. Thread the 3 set screws **(C)** into pre-tapped holes in post fitter.
4. Tighten screws **(C)** to secure fixture to post.

6

1. Thread center stem **(3)** into top of harp **(4)** - see **Drawing 1**.
2. Slip interior glass globe **(5)** over harp and secure by using the small thumb screws **(6)** provided.
3. Slip washer **(7)** over center stem **(3)**.
4. Thread knurl nut **(8)** onto center stem **(3)** and hand-tighten.
5. Slip cap **(9)**, checking **(10)** (open side up) stem cover **(11)** over center stem **(3)**, making sure stem cover **(11)** fits into checking **(10)**.
6. Slip spider assembly **(12)** over center stem **(3)**, making sure corner pins **(13)** fit into corner holes in cage.
7. Thread knurl nut **(14)** onto center stem and tighten to secure spider assembly **(11)**.
8. Thread top finial **(15)** onto fixture and hand-tighten.

Note: Maximum wattage for 1421 fixture is 100 watts per bulb.

12.10.08