

Type _____
P88-ICAT

Catalog No.	Lamping	Dimensions (Inches)		
		A	B	C
P88-ICAT	(1) 18w Quad or Triple CF (4-pin)	7-7/8	10-3/4	7-1/2
		Ceiling Opening 6-7/8		

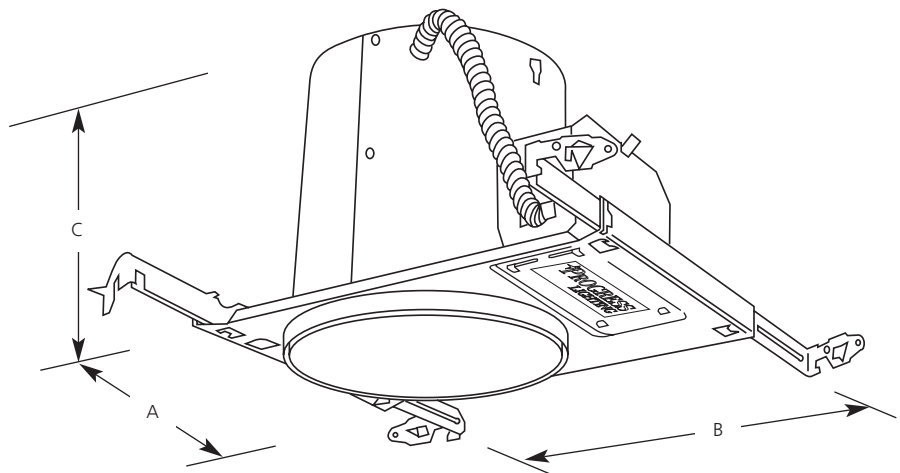

Specifications:

Wiring

- Universal junction box with snap-out sides
- Removable housing for field inspection of wiring
- Grounding pigtail
- Knockout free Romex clamps
- 1/2" & 3/4" Knock outs for rigid or BX fittings
- Electronic NPF 120-volt ballast (located inside junction box)

Construction

- Notched housing for chalkline alignment
- Overspray protection
- Full wrap-around plaster frame
- Removable K.O. for remodel use (P8607-01 plaster frame clips also required)
- Galvanized steel construction
- Housing adjusts from 1/2" to 2-1/2" thick ceilings

Bar Hangers

- Integral nailers for wood joist construction
- Integral T-bar mounting clamps
- Span 24" T-bar spacing
- Lock to secure housing
- Captive
- 90-degree mounting for tight spaces

Labeling

- UL-CUL listed for damp locations
- Not rated for through branch wiring, but can be daisy chained
- IC rated

Lamp/Trim

- Trim-Lok® action forces trim to fit snugly against the ceiling
- Single-lamp vertical 18w (4-pin) G24q-2 compact fluorescent