

JET[®]

Operating Instructions and Parts Manual Folding Hydraulic Crane

Model: JFHC-200X



WALTER MEIER (Manufacturing) Inc.
427 New Sanford Road
LaVergne, Tennessee 37086
Ph.: 800-274-6848
www.waltermeier.com

Part No. M-106203K
Revision G1 02/2012
Copyright © 2012 Walter Meier (Manufacturing) Inc.

1.0 Warranty and Service

Walter Meier (Manufacturing) Inc., warrants every product it sells. If one of our tools needs service or repair, one of our Authorized Service Centers located throughout the United States can give you quick service. In most cases, any of these Walter Meier Authorized Service Centers can authorize warranty repair, assist you in obtaining parts, or perform routine maintenance and major repair on your JET® tools. For the name of an Authorized Service Center in your area call 1-800-274-6848.

MORE INFORMATION

Walter Meier is consistently adding new products to the line. For complete, up-to-date product information, check with your local Walter Meier distributor, or visit waltermeier.com.

WARRANTY

JET products carry a limited warranty which varies in duration based upon the product (MW = Metalworking, WW = Woodworking).

90 DAY WARRANTY	1 YEAR WARRANTY	Body Repair Kits Bottle Jacks Cable Pullers Cold Saws Hoists-Air Hoists-Electric Metal forming Mill/Drills Milling Machines MW Bandsaws MW Drill Presses MW Finishing Equipment MW Lathes MW Precision Vises	2 YEAR WARRANTY	Palet Trucks Rigging Equip. Service Jacks Stackers Surface Grinders Tapping Trolleys-Air Trolleys-Electric Web Slings Winches-Electric	3 YEAR WARRANTY	WW Benchtop Tools	5 YEAR WARRANTY	Beam Clamps Chain Hoist-Manual Lever Hoists Pullers-JCH Models Scissor Lift Tables Screw Jacks Trolleys-Geared Trolleys-Plain Winches-Manual WW Air Filtration WW Bandsaws WW Buffers	WW Drill Presses WW Dust Collectors WW Dust Filters WW Dust Fittings WW Jointers WW Lathes WW Planers WW Sanders WW Shapers WW Tablesaws	LIFE LIFETIME WARRANTY	Fastening Tools Mechanics Hand Tools Striking Tools Vises (no -precision) Clamps
Warranty reverts to 1 Year Warranty if woodworking (WW) products listed above are used for industrial or educational purposes.											

WHAT IS COVERED?

This warranty covers any defects in workmanship or materials subject to the exceptions stated below. Cutting tools, abrasives and other consumables are excluded from warranty coverage.

WHO IS COVERED?

This warranty covers only the initial purchaser of the product.

WHAT IS THE PERIOD OF COVERAGE?

The general JET warranty lasts for the time period specified in the product literature of each product.

WHAT IS NOT COVERED?

Five Year Warranties do not cover woodworking (WW) products used for commercial, industrial or educational purposes. Woodworking products with Five Year Warranties that are used for commercial, industrial or education purposes revert to a One Year Warranty. This warranty does not cover defects due directly or indirectly to misuse, abuse, negligence or accidents, normal wear-and-tear, improper repair or alterations, or lack of maintenance.

HOW TO GET SERVICE

The product or part must be returned for examination, postage prepaid, to a location designated by us. For the name of the location nearest you, please call 1-800-274-6848.

You must provide proof of initial purchase date and an explanation of the complaint must accompany the merchandise. If our inspection discloses a defect, we will repair or replace the product, or refund the purchase price, at our option. We will return the repaired product or replacement at our expense unless it is determined by us that there is no defect, or that the defect resulted from causes not within the scope of our warranty in which case we will, at your direction, dispose of or return the product. In the event you choose to have the product returned, you will be responsible for the shipping and handling costs of the return.

HOW STATE LAW APPLIES

This warranty gives you specific legal rights; you may also have other rights which vary from state to state.

LIMITATIONS ON THIS WARRANTY

WALTER MEIER (MANUFACTURING) INC., LIMITS ALL IMPLIED WARRANTIES TO THE PERIOD OF THE LIMITED WARRANTY FOR EACH PRODUCT. EXCEPT AS STATED HEREIN, ANY IMPLIED WARRANTIES OR MERCHANTABILITY AND FITNESS ARE EXCLUDED. SOME STATES DO NOT ALLOW LIMITATIONS ON HOW LONG THE IMPLIED WARRANTY LASTS, SO THE ABOVE LIMITATION MAY NOT APPLY TO YOU.

WALTER MEIER SHALL IN NO EVENT BE LIABLE FOR DEATH, INJURIES TO PERSONS OR PROPERTY, OR FOR INCIDENTAL, CONTINGENT, SPECIAL, OR CONSEQUENTIAL DAMAGES ARISING FROM THE USE OF OUR PRODUCTS. SOME STATES DO NOT ALLOW THE EXCLUSION OR LIMITATION OF INCIDENTAL OR CONSEQUENTIAL DAMAGES, SO THE ABOVE LIMITATION OR EXCLUSION MAY NOT APPLY TO YOU.

Walter Meier sells through distributors only. The specifications in Walter Meier catalogs are given as general information and are not binding. Members of Walter Meier reserve the right to effect at any time, without prior notice, those alterations to parts, fittings, and accessory equipment which they may deem necessary for any reason whatsoever. JET® branded products are not sold in Canada by Walter Meier.

Warnings

1. Study and understand all operating instructions before operating crane.
2. Do not exceed the rated capacity of the crane (position 1, 1/2 ton; position 2, 1 ton; position 3, 1-1/2 ton; position 4, 2 ton).
3. Assure that the load is not allowed to drop suddenly or swing during transporting.
4. Make sure that boom is fully lowered before adding oil to unit reservoir.
5. This shop crane is designed for use only on hard, level surfaces capable of sustaining the load. Use on other than hard level surfaces can result in shop crane instability and possible loss of load.
6. Slowly lower boom and load to the lowest possible position before transporting load.
7. Assemble crane according to the owner's manual. Make sure all bolts and nuts are tight before placing crane into operation.
8. Do not use crane for any other purpose than for which it was designed and intended.
9. Boom extension hardware must be secure before attempting to lift any load.
10. Never place any part of the body under the load or crane while in use.
11. Never use the crane as the only means of support. Always move the load to a stable platform or work surface before attempting any work.
12. Keep others away from the area while the crane is in operation.
13. Boom must be in fully lowered position before raising legs. Legs must never be raised when crane is carrying load. Legs must be locked in place.
14. Before attempting to raise load, make sure it is securely fastened and safety latches are secure.
15. Do not operate crane with twisted or kinked chain.
16. Do not remove labels from crane.
17. Never use crane for lifting people or loads over people.
18. Do not remove ram and use separately for any purpose.
19. Never operate the crane under the influence of medication, drugs or alcohol.
20. Failure to comply with all of these warnings may result in loss of load, damage to the shop crane, and/or failure resulting in personal injury or property damage.

Familiarize yourself with the following safety notices used in this manual:

CAUTION This means that if precautions are not heeded, it may result in minor injury and/or possible machine damage.

WARNING This means that if precautions are not heeded, it may result in serious injury or possibly even death.

Specifications

Model Number..... JFHC-200X
 Stock Number 106203K

Capacity (tons)	Boom Height		Boom Length	Reach	Overall Height	Base Length		Base Width (Outside)		Length Inside Legs		Wheel Diameter	Chain Size	Net Weight
	Max	Min				Max	Min	Max	Min	Max	Min			
1/2 T Position 1	105-1/4"	3-5/8"	63-1/8"	47-7/8"	58"	68-1/2"	21-1/2"	38"	32"	51"	51"	3-1/2"	3/8 x 12	222 lbs
1 T Position 2	100-1/4"	9-3/4"	56"	40-3/4"	58"	68-1/2"	21-1/2"	38"	32"	51"	51"	3-1/2"	3/8 x 12	222 lbs
1-1/2 T Position 3	94-1/2"	15-3/4"	49"	33-3/4"	58"	68-1/2"	21-1/2"	38"	32"	51"	51"	3-1/2"	3/8 x 12	222 lbs
2 T Position 4	88-3/8"	22"	41-7/8"	26-1/2"	58"	68-1/2"	21-1/2"	38"	32"	51"	51"	3-1/2"	3/8 x 12	222 lbs

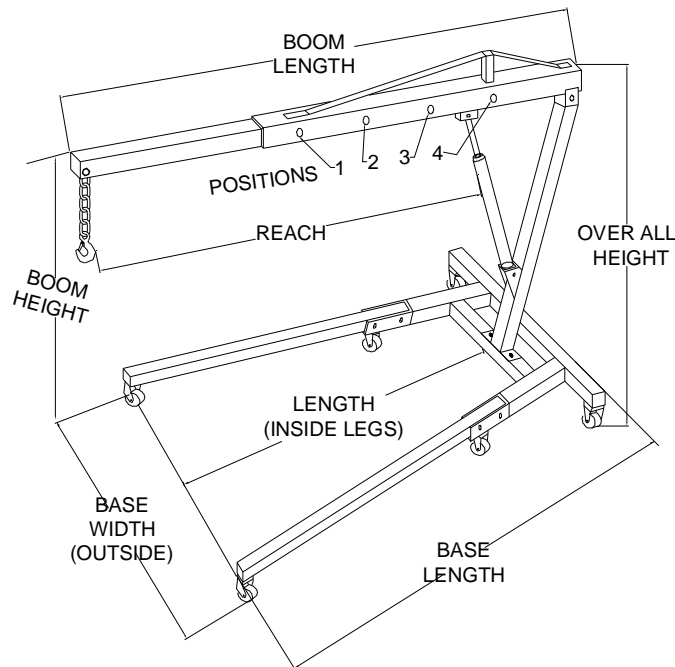

The specifications in this manual are given as general information and are not binding. Walter Meier (Manufacturing) Inc., reserves the right to effect, at any time and without prior notice, changes or alterations to parts, fittings, and accessory equipment deemed necessary for any reason whatsoever.

WARNING Read and understand the entire contents of this manual before attempting assembly or operation! Failure to comply may cause serious injury!

TEST CERTIFICATE

COMMODITY	Hydraulic Shop Crane
MODEL	JFHC-200X
SERIAL NO.	
CAPACITY	2 Ton
TEST LOAD	2 Ton
DATE OF INSPECTION	
JUDGEMENT	PASSED
INSPECTOR	

Assembly

Note: Refer to parts breakdown for index numbers found in parenthesis (#):

1. Attach Front Legs (2) to the Frame Base (1) using all four Hitch Pins (24), and Hitch Pin Clips (24A). On each leg, insert one pin through Frame Base and Front Leg at rear hole. The hitch pin serves as a pivot pin and remains in the hole permanently. Insert a second hitch pin in the forward hole through the Frame Base and Front Leg. This locks the legs in the down and/or up position.
2. Insert Hitch Pin Clips through Hitch Pins to secure in place.
3. Attach the Main Support Post (9) to the Frame Base using two Hex Cap Screws (18), two Flat Washers (26) and two nuts (23).
4. Attach Support Straps (5) to the top of the Main Support Post using Steer Handles (14) and Flat Washers (15).
5. Connect the Support Straps to the Frame Base using two Hex Cap Bolts (18), two Flat Washers (26) and two Hex Nuts (23).
6. Connect the bottom of the Hydraulic Ram Assembly (6) to the Main Support Post using a Hex Cap Screw (16), Flat Washer (15), and Hex Nut (22).
7. Connect the Boom (3) to the Main Support Post using a Hex Cap Screw (19), Flat Washer (30) and Hex Nut (21).
8. While another person supports the Boom up attach the top of Hydraulic Ram Assembly to the Boom with a Hex Cap Screw (17), Flat Washer (15), and Hex Nut (22).
9. Slide the Boom Extension (4) into the Boom with the slot for Hook and Chain Assembly (8) facing down.
10. Install Chain and Hook Assembly with a Hex Cap Screw (20), Flat Washer (26) and Hex Nut (23).
11. Insert Plastic End Caps (27 & 28) into the ends of legs, boom and boom extension.
12. Make sure all hardware is tight.

Operation

1. Load to be lifted must be securely attached with a sling or chain of adequate size and strength. Before lifting the load, be sure the load cannot twist or fall.
2. Move crane into position. Legs must be extended and lock pinned into place. Never use crane with legs in the upright position.

3. Close hydraulic valve at the base of ram by inserting handle groove onto valve and turning clockwise until tight.
4. Place sling or chain in center of hook and make sure safety latch is secured.
5. Slowly raise the load to desired height by inserting handle into ram and pumping handle.
6. Move load to desired location by rolling crane assembly. Use caution so that load does not swing or rotate.
7. Slowly lower load to desired location by inserting ram handle onto valve at base of the ram and slowly turning counter-clockwise. Do not lower too quickly. Make sure the load is secure once lowered fully.

Storage

To FOLD the crane:

1. Completely retract the boom (A).
2. Insert pin (B) to secure boom in this position. Secure pin with clip.
3. Lower the boom completely.
4. Locate the forward pins on the legs (C) that are directly over the mid-casters.
5. Beginning with one leg, remove the pin (C) and manually raise the leg.
6. On the other leg, remove the pin and manually raise the leg.
7. The legs will now rest on the handlebars, as shown in the inset below.

To UNFOLD the crane:

1. Lower one leg and insert pin (C). Secure pin with clip.
2. Repeat for the other leg.



Parts

Ordering Replacement Parts

To order parts or reach our service department, call 1-800-274-6848 Monday through Friday (see our website for business hours, www.walteremeier.com). Having the Model Number and Serial Number of your machine available when you call will allow us to serve you quickly and accurately.

Hydraulic Crane Assembly

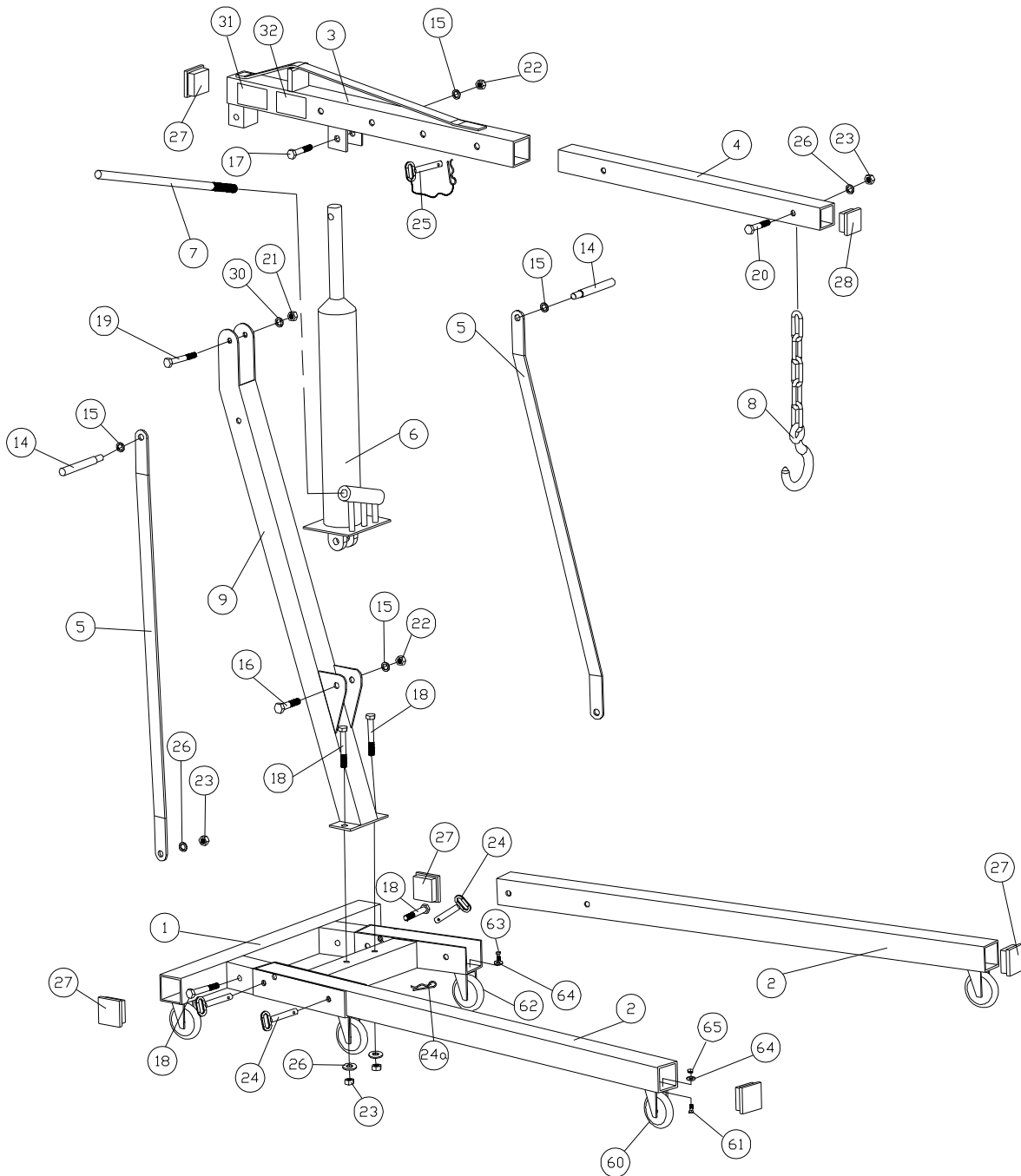

Hydraulic Crane Parts List

Index No.	Part No.	Description	Size	Qty
1	JFHC200C-1	Frame Base		1
2	JFHC200C-2	Front Leg		2
3	JFHC200C-3	Boom		1
4	JFHC200C-4	Boom Extension		1
5	JFHC200C-5	Support Strap		2
6	JFHC200X-6	Hydraulic Ram Assembly		1
7	JFHC200C-7	Pump Handle		1
8	JFHC200C-8	Hook & Chain Assembly		1
9	JFHC200C-9	Main Support Post		1
14	JFHC200X-14	Steer Handle		2
15	TS-155010	Flat Washer	M16	4
16	TS-149B15	Hex Cap Screw	M16x90	1
17	TS-149B12	Hex Cap Screw	M16x75	1
18	TS-149A15	Hex Cap Screw	M14x100	4
19	TS-149C18	Hex Cap Screw	M20x120	1
20	TS-149A12	Hex Cap Screw	M14x75	1
21	TS-1540121	Nut	M20	1
22	TS-1540101	Nut	M16	2
23	TS-154009	Nut	M14	5
24	JFHC200C-24	Hitch Pin		4
24a	JFHC200C-24a	Hitch Pin Clip		4
25	JFHC200X-25	Boom Hitch Pin w/Hitch Pin Clip		1
26	TS-155009	Flat Washer	M14	5
27	JHC200C-25	Plastic End Cap	2-3/4"	5
28	JHC200C-25A	Plastic End Cap (boom extension)	2-1/4"	1
30	TS-155011	Flat Washer	M20	1
31	JFHC200X-ID	I.D. Label		1
32	JFHC200X-WL	Warning Label		1
60	JFHC200C-60	Front & Back Caster	3-1/2"	4
61	TS-1490021	Cap Screw	M8x16	16
62	JFHC200C-62	Mid Caster	2-3/4"	2
63	TS-1490011	Cap Screw	M8x12	8
64	TS-1551061	Lock Washer	M8	24
65	TS-1540061	Hex Nut	M8	16

Hydraulic Ram Parts List

Index No.	Part No.	Description	Size	Qty
.....	JFHC200X-6	Hydraulic Ram Assembly.....		1
30	JFHC200X-30	Valve Body.....		1
31	JFHC200X-31	Copper Washer *	M46	1
32	JFHC200X-32	Cylinder.....		1
33	JFHC200X-33	O-ring *	M40x5.5	1
34	JFHC200X-34	O-ring Retainer *	M31.3x3.55	1
35	JFHC200X-35	Ram		1
36	JFHC200X-36	Top Nut	M48	1
37	JFHC200X-37	O-ring *	M33.5x3.55	1
38	JFHC200X-38	Gasket *	M70x1	1
39	JFHC200X-39	Oil Chamber.....		1
40	JFHC200X-40	Oil Plug *	M15x9.5	1
41	JFHC200X-41	Seal Ring *	M81x4	1
42	JFHC200X-42	Tube.....		1
43	SB-6MM	Steel Ball.....	M6	1
44	JFHC200X-44	Seal Ring *	M88x6	1
45	JFHC200X-45	Release Valve.....		1
46	SB-6MM	Steel Ball.....	M6	2
47	JFHC200X-47	Copper Washer *	M18	2
48	JFHC200X-48	Pump Cylinder		2
49	JFHC200X-49	O-ring *	M66x3	2
50	JFHC200X-50	Back-up Ring *	M12x7	2
51	JFHC200X-51	Plunger (<i>s/n 12020001 and higher</i>)		2
.....	JFHC200X-51A	Plunger (<i>previous to s/n 12020001</i>).....		1
52	JFHC200X-52	Link Pin.....		1
53	JFHC200X-53	Handle Socket		1
54	JFHC200X-54	Connecting Pin		3
55	JFHC200X-55	Cotter Pin.....		3
56	JFHC200X-56	Pin.....	M2x30	1
57	JFHC200X-57	Bolt.....	M14x45	1
.....	JFHC200X-RK	Ram Repair Kit (includes items with asterisk *).....		1

