

Installation Guide

For Glass, Wood and Stone Counters

Glass top and Above Counter Sink:

Step 1

Screw in the countertop spacers into the holes provided on top of the cabinet

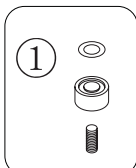

Step 2

Set your countertop on the spacers.

Step 3

Position your sink over the drain hole on the countertop.

Step 4

Install Drain

Place a generous portion of plumbers' putty under drain cap and insert whole drain body inside the bowl and through the countertop.

From under the drain, insert the thick rubber washer and screw on and tighten the metal nut. Remove excess plumbers' putty. Attach p-trap to tailpiece.

*There may be a small beveled rubber washer packaged with your drain, **please discard this and use plumbers' putty instead.**

For install WOOD top:

Chrome spacers (parts 1) may be used but are not necessary. Wood top may be placed on spacers or may be glued to leg supports by using silicone adhesives.

For installing STONE top:

Use silicone adhesive to secure top to leg support.

note: Stone top does not come with spacers.

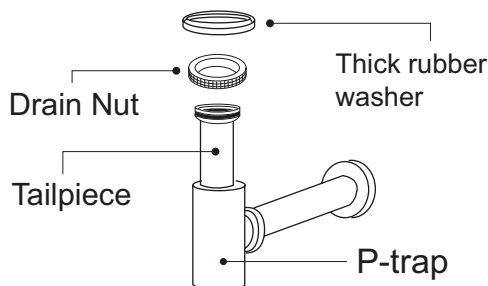
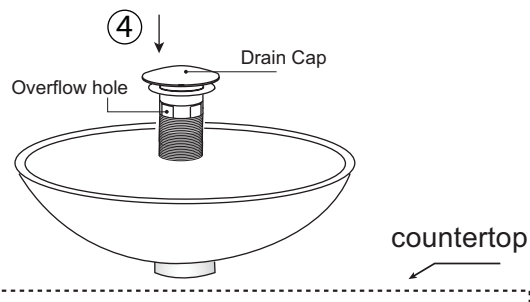
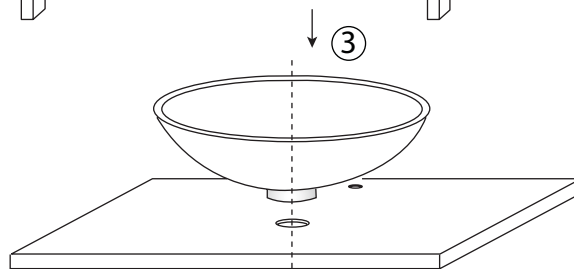
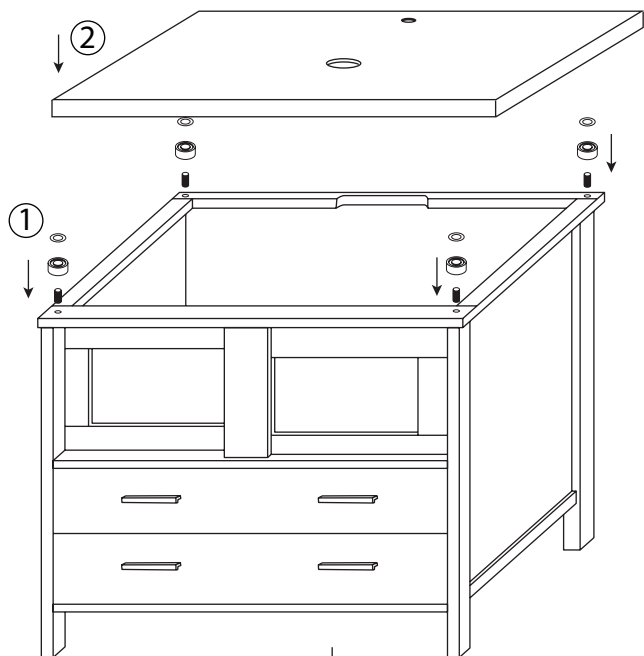

USE CAUTION when using adhesives with silicone. Once in place, silicone will be difficult to remove.