

# Cargo Solid

600CRGSS\_

1.4



## GENERAL PRODUCT INFORMATION:



This product can mount to either a 4" square electrical box with round plaster ring or an octagon electrical box.

This product is suitable for indoor damp locations.

This product can be dimmed with a standard incandescent dimmer.

This instruction shows a typical installation.



**CAUTION - RISK OF FIRE**  
 This product requires installation by a qualified electrician. Before installing be sure to read all instructions and **TURN THE POWER TO THE ELECTRICAL BOX OFF.**

**NOTE:** When the "Industrial Hang Straight" is used with the suspension fixture, refer to the instructions provided with the "Industrial Hang Straight" before continuing the following steps.

## Install the Fixture

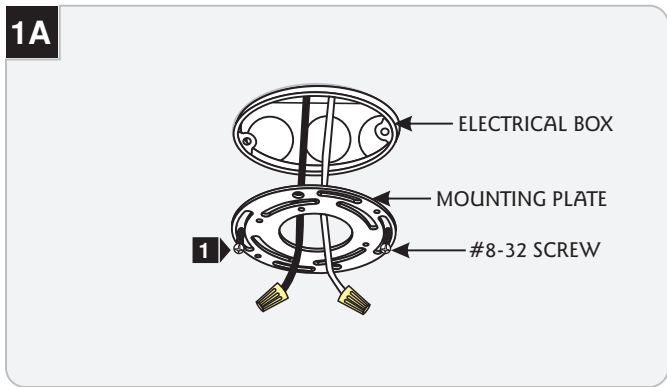

- 1** Install the mounting plate to the electrical box with the two #8-32 screws provided.
- 2** Make sure that the mounting plate is grounded in accordance with local electrical codes.

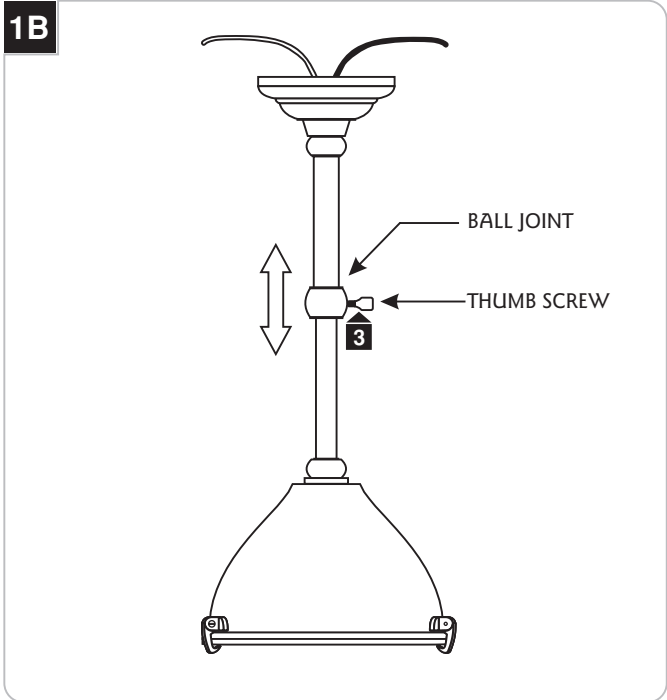

**NOTE:** Do not trim the excess fixture wires.

- 3** Loosen the thumb screw on ball joint and bring the Telescoping fixture to a full extension before installing it to the electrical box. Tighten the thumb screw. **Omit this step for Rigid suspension.**

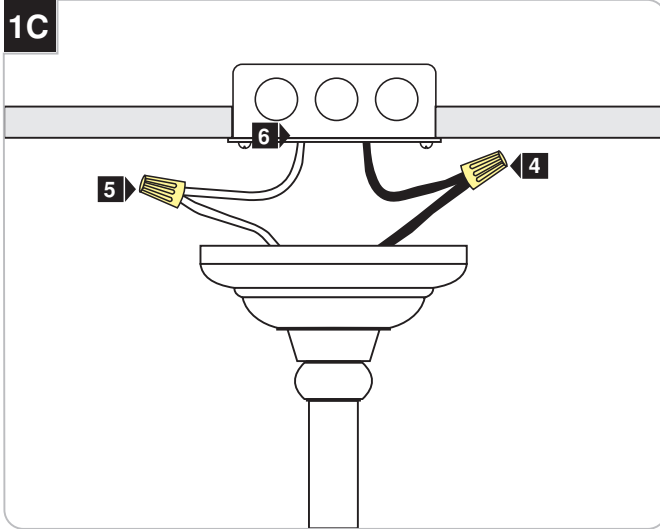

- 4 Connect the black fixture wire to the hot power line wire with a wire nut.
- 5 Connect the white fixture wire to the neutral power line wire with a wire nut.
- 6 Place all wires and wire nut connections inside the electrical box.

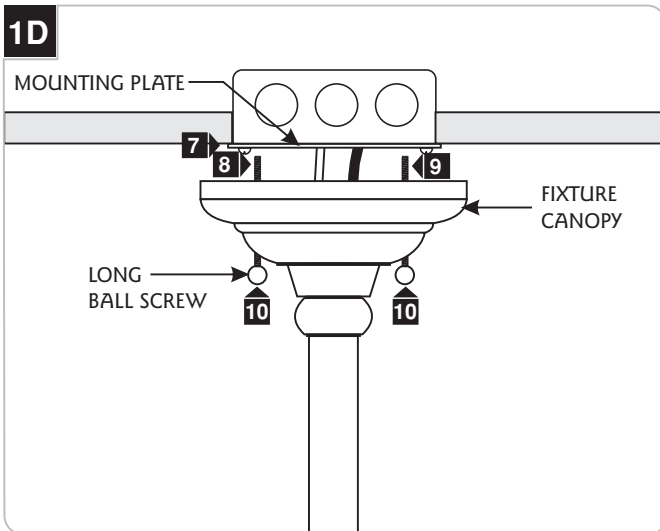

- 7 Locate two screw holes on the mounting plate that are 2-3/4" apart. This screw holes will be used to install the fixture canopy to the mounting plate.
- 8 Thread (**not completely**) a long ball screw through the canopy hole into one screw hole on the mounting plate.
- 9 Align and thread the second long ball screw through the other canopy hole into the other screw hole on the mounting plate.
- 10 Tighten the two long ball screws to secure the fixture in place.

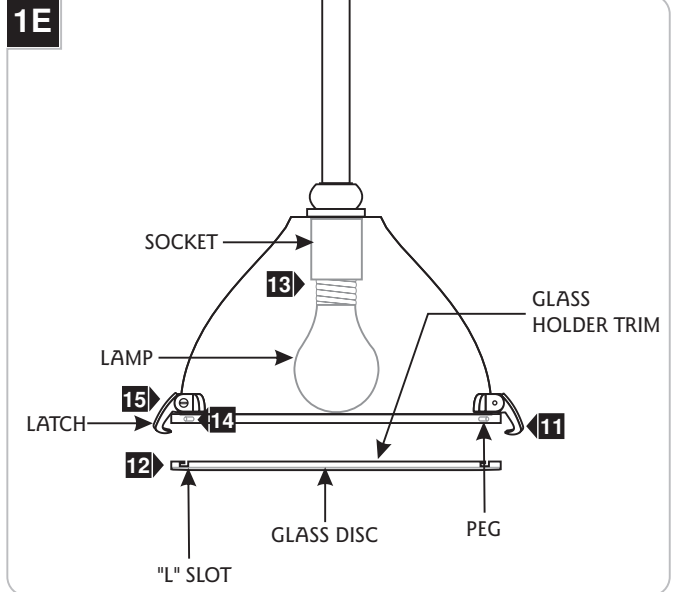

- 11 While supporting the glass holder trim, unhook the three latches.
- 12 Rotate the glass holder trim counter clockwise to remove it.

Use **MAX** 120 Volt, **100** Watt Type A19 Medium Base Lamp.

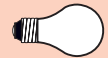

- 13 Screw the lamp completely into the socket.
- 14 Align the vertical portion of the "L" slots (on the glass holder trim) with the pegs and completely push them onto the pegs. Rotate the glass holder trim clockwise to lock it in place.
- 15 While holding the glass holder trim, clip all three latches onto the glass holder trim.

**NOTE:** To replace the lamp, follow steps 11 and 12. Remove the old lamp then follow steps 13 through 15.

- 16 For Telescoping fixture (see figure 1B on page 1), loosen (**Do Not Remove**) the thumb screw on ball joint to adjust the fixture height. After achieving the desired height tighten the thumb screw. **Omit this step for Rigid suspension.**

**SAVE THESE INSTRUCTIONS!**

WILMETTE LIGHTING  
COMPANY

7400 Linder Ave, Skokie, IL 60077  
847.410.4400

[www.wilmettelighting.com](http://www.wilmettelighting.com)

© 2008 Wilmette Lighting Company. All rights reserved. The "Wilmette Lighting Company" graphic is a registered trademark of Wilmette Lighting Company. Wilmette Lighting Company reserves the right to change specifications for product improvements without notification.

A Generation Brands Company