

Surface Transformer

SINGLE-FEED, 12 VOLTS 300 WATTS, MAGNETIC

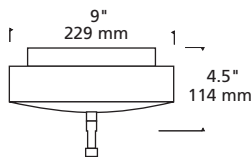

Shown approximately 25% actual size.



tiella_srt30d_spec.pdf

DESCRIPTION

This single-feed surface transformer converts standard 120 line voltage to 12 volts to provide the necessary voltage for powering a low-voltage lighting system. It can power lamps totaling up to 300 watts. The transformer is concealed inside a decorative housing with a single integral power feed and fast acting secondary circuit breaker that will safely turn the system off should a short occur. Once the short has been removed the breaker can be reset.

INSTALLATION

This product can mount to either 4" square electrical box with round plaster ring or an octagon electrical box (not included). Rail is installed through the power feed on the canopy to bring power to the run. The power connector can be mounted on top of the canopy or to its side.

DIMMING

Dimmable with a 600 watt low-voltage magnetic dimmer. The dimmer is placed on the line side of the transformer. (Consult dimmer manufacturer for specifics). The surface transformer includes a preinstalled debuzzing dimming coil to reduce audible noise when using a low-voltage system.

FINISH

Bronze, Satin Nickel.

COMPATIBLE RIGID STANDOFFS

The shortest rigid standoff that can be used with this surface transformer is the 4" rigid standoff (sold separately). If dropping the rail more than 4" below the ceiling, order the desired rigid standoff length and one compatible power extender (sold separately).

OPTIONS

This surface transformer may be plugged in with the addition of a Plug Option, a 16 foot cord with inline switch two feet from the plug (sold separately).

REQUIRED USAGE

12 volt transformers require the use of 12 volt lamps.

WEIGHT

1.67 lb./0.75 kg. ±

ORDERING INFORMATION

800RLSRT30E FINISH _____
 Z Bronze
 S Satin Nickel

800RLSRT30D _____

FIXTURE TYPE: _____

JOB NAME: _____

tiella
real light, real simple

7400 Linder Avenue T 847.410.4400
 Skokie, Illinois 60077 F 847.410.4500

www.tiella.com